

WELCOME TO ARCH 1121-HISTORY OF ARCHITECTURAL TECHNOLOGY

- 1.PLEASE TURN OFF CELL PHONES FOR ENTIRE DURATION OF CLASS
- 2.PLEASE TURN OFF ALL IPODS, WALKMANS, ETC.
- 3.PLEASE NO EATING OR DRINKING DURING CLASS
- 4.PLEASE BE CONSIDERATE OF OTHERS-RESPECT IS KEY TO YOUR PROFESSIONAL CAREERS & DAILY LIVES.

ARCH 1121 HISTORY OF ARCHITECTURAL TECHNOLOGY
PROF. BENARDETE FALL 2008



CLASS 1







ARCH 1121 HISTORY OF ARCHITECTURAL TECHNOLOGY
PROF. BENARDETE FALL 2008

CLASS 1

GARDNER-ART THROUGH THE AGES

c. 3000 B.C.	2800	2600	1800
CRETE NEOLITHIC PERIOD	EARLY MINOAN PERIOD (PRE-PALACE PERIOD)		MIDDLE MINOAN PERIOD (OLD PALACE PERIOD)
GREECE EARLY HELLADIC PERIOD		MIDDLE HELLADIC PERIOD	
		<p>Cycladic idol, Syros c. 2500-2000 B.C.</p> 	 <p>Kammos Ware c. 1800-1700 B.C.</p>
		 <p>Lyre Player, Knossos c. 2000 B.C.</p>	
		Linear A script developed	Introduction of potter's wheel

ARCH 1121 HISTORY OF ARCHITECTURAL TECHNOLOGY CLASS 1 GARDENER-ART THROUGH THE AGES
 PROF. BENAEDETE FALL 2008

1700	1600	1500	1400	1200	1000
		LATE MINOAN PERIOD (NEW PALACE PERIOD)		SUB-MINOAN PERIOD	
		LATE HELLADIC (MYCENAEAN) PERIOD			SUB-MYCENAEAN PERIOD
	 <p>Snake Goddess, Knossos c. 1800 B.C.</p>	 <p>The Vaphio Cups c. 1500 B.C.</p>	 <p>The Tomb of Peirata, Knossos c. 1500 B.C.</p>	 <p>Lion Gate, Mycenae c. 1300 B.C.</p>	
Construction of first palace c. 1700			Decline of new palaces c. 1400-1300		Decline of Greece c. 1200

ARCH 1121 HISTORY OF ARCHITECTURAL TECHNOLOGY CLASS 1 GARDENER-ART THROUGH THE AGES
 PROF. BENAEDETE FALL 2008

Crete: Island in southern Greece. Architecture references from Egypt. Little imagination, but loved color



Minoan Civilization 3000-1500BCE:

Lived on the Island of Crete

Rapid growth in population and the development of trade

Used bronze for tools and weapons

Named after King Minos (2600BCE)

Known for construction of Palaces

Peaceful with other civilizations – no outer wall of the city

Disappeared suddenly – huge earthquake and tsunami – 1500BCE



4-5 Palace of Knossos, c. 1500-1450 B.C. (photo from the web)

4-6 Plan of the palace of Knossos. (After J. H. St. John)

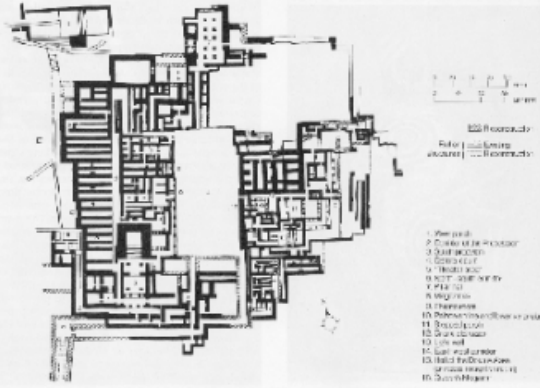

ARCH 1121 HISTORY OF ARCHITECTURAL TECHNOLOGY
PROF. BERNARDETE FALL 2008

CLASS 1

GARDENER-ART THROUGH THE AGES

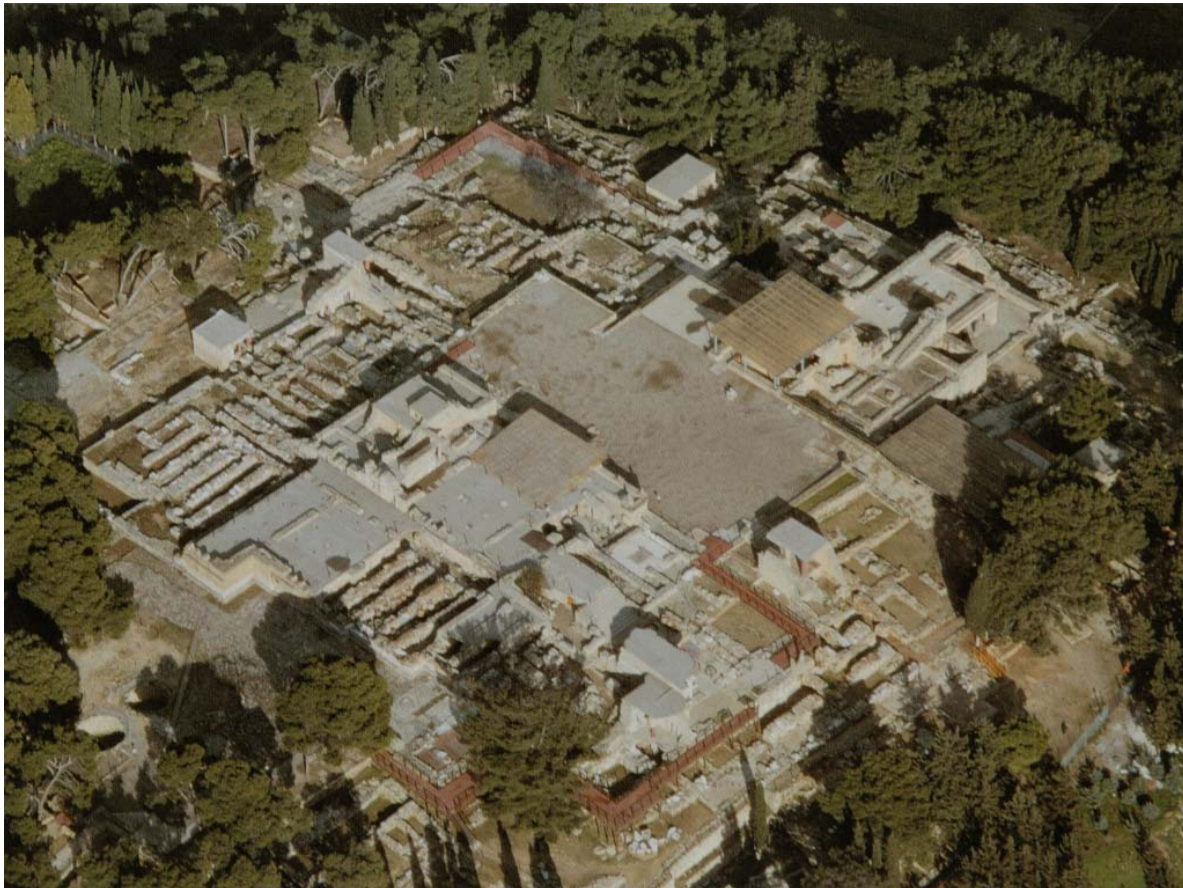

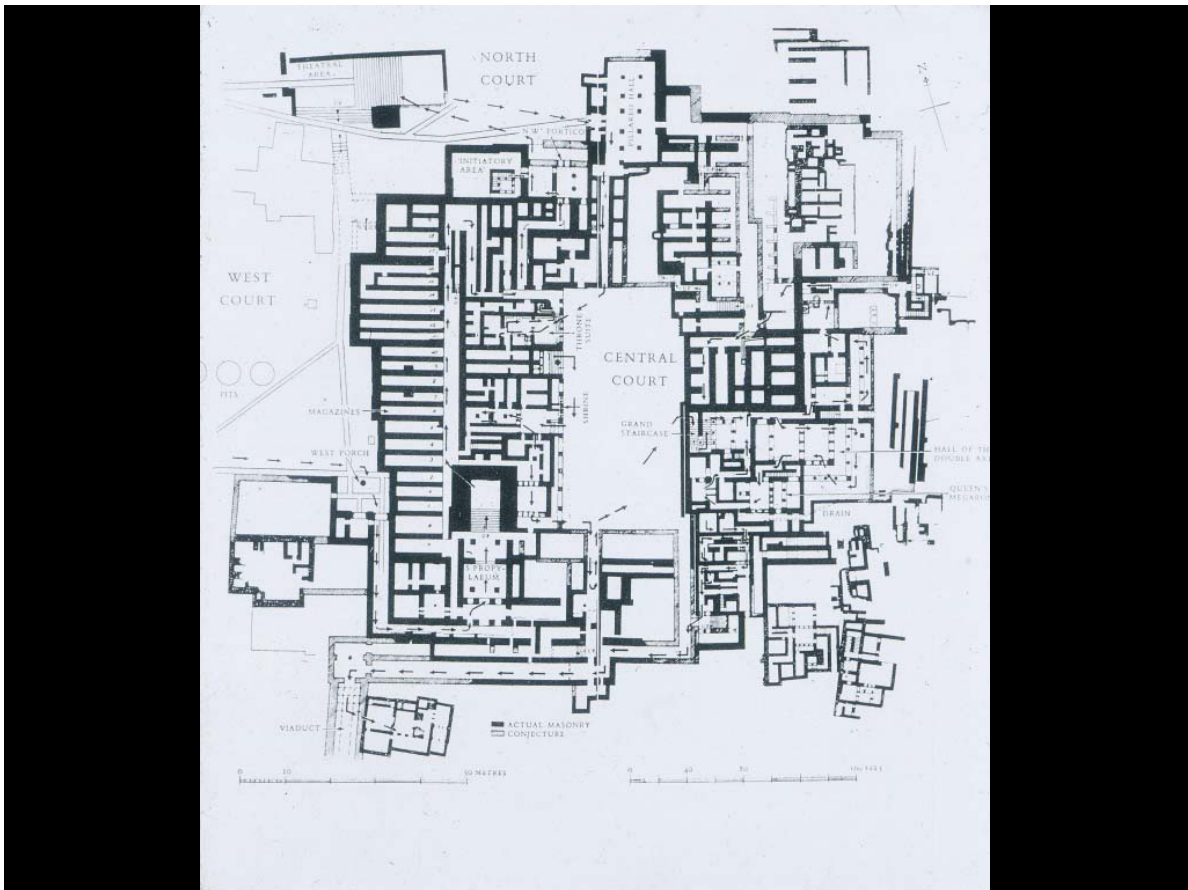

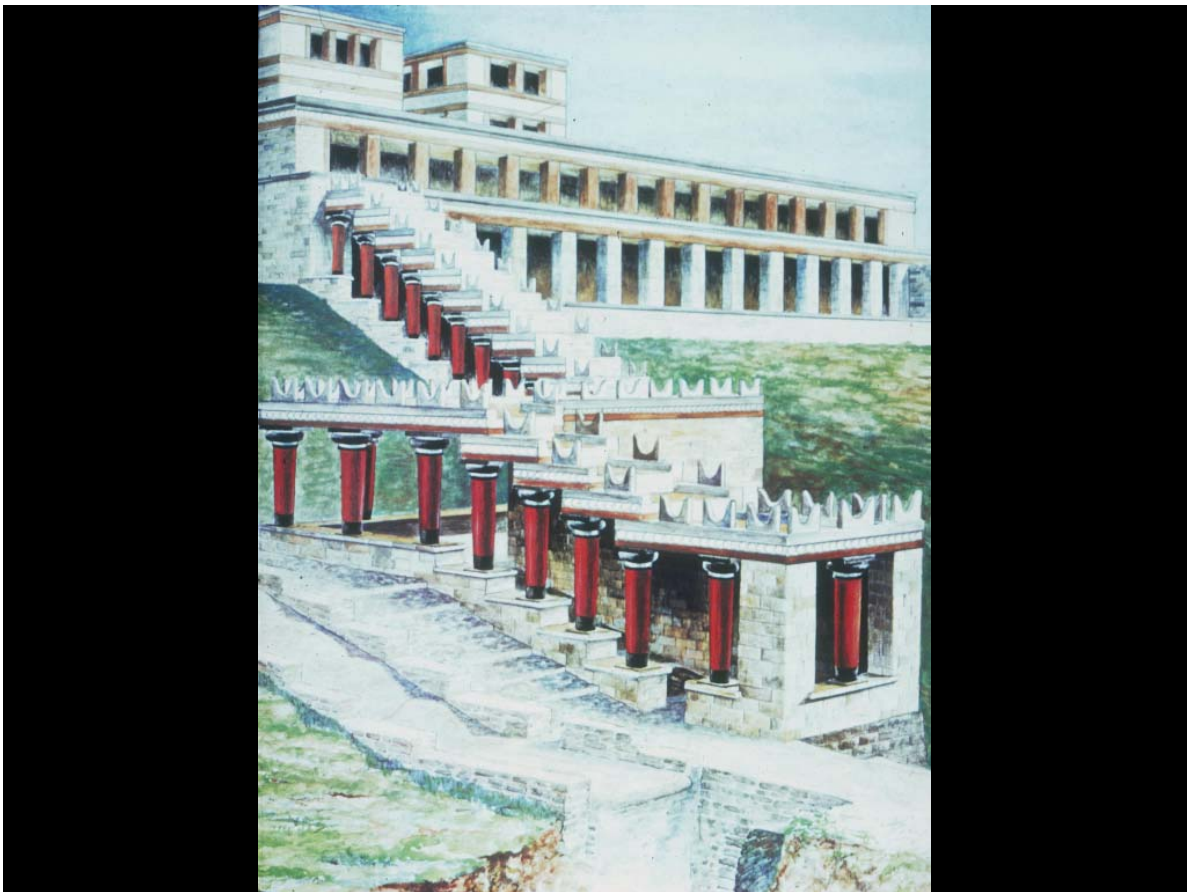







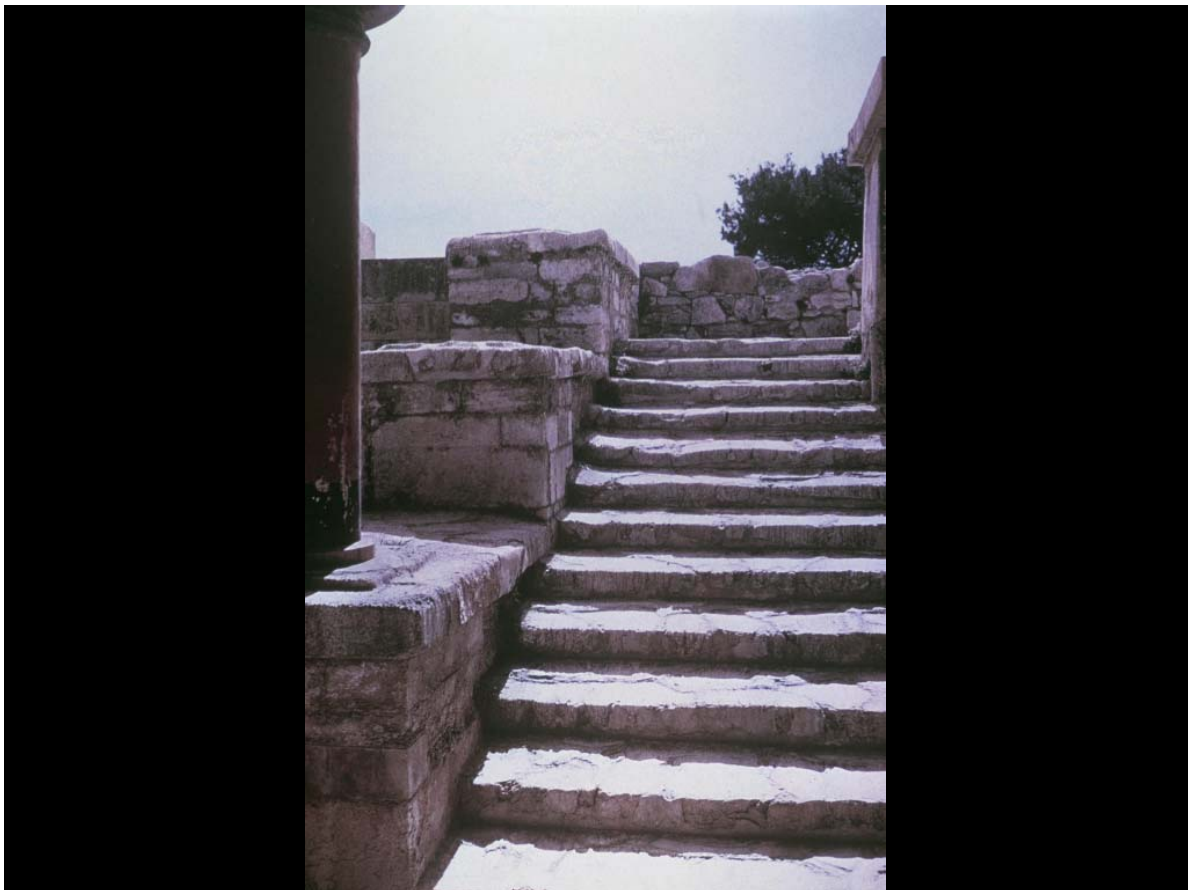
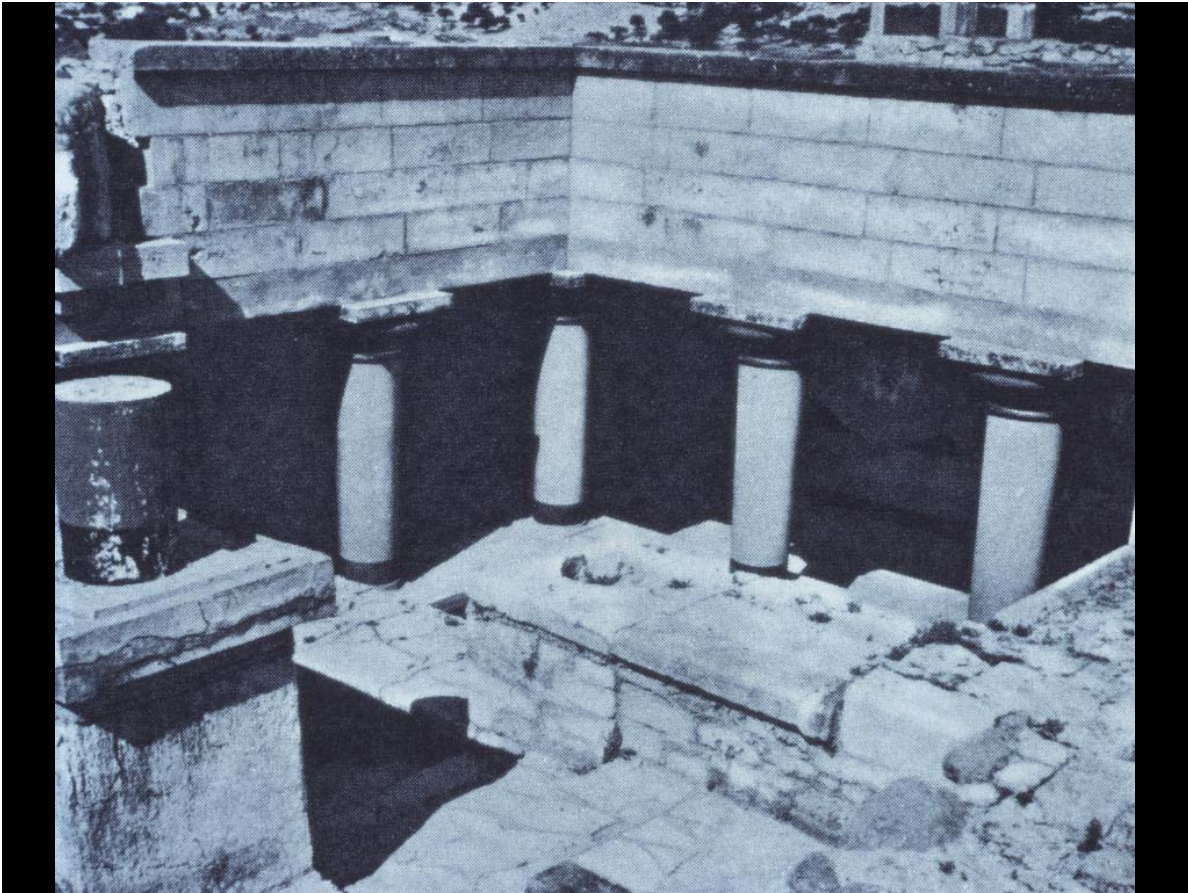



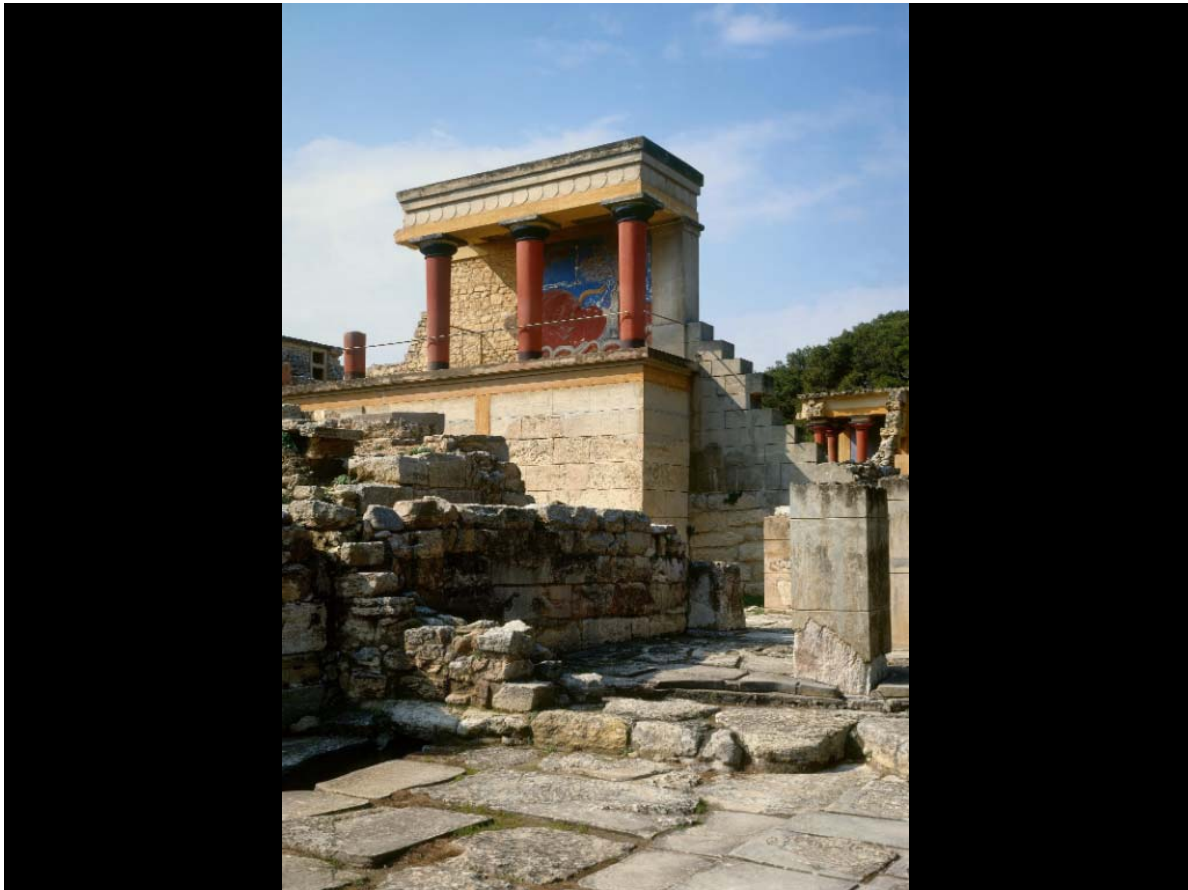

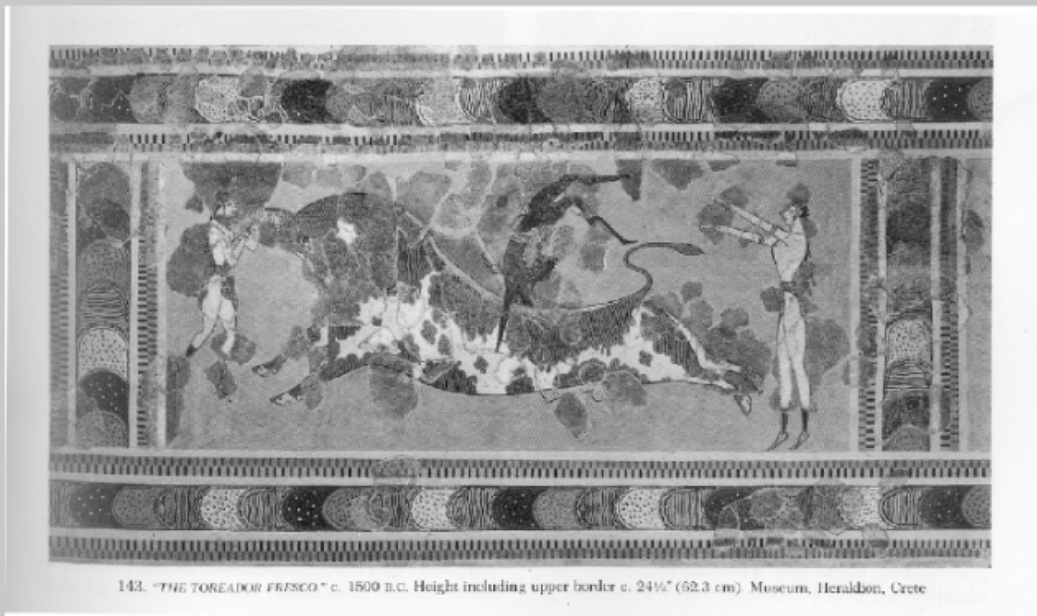

ARCH 1121 HISTORY OF ARCHITECTURAL TECHNOLOGY
PROF. BENARDETE FALL 2008

CLASS 1

JANSON-HISTORY OF ART



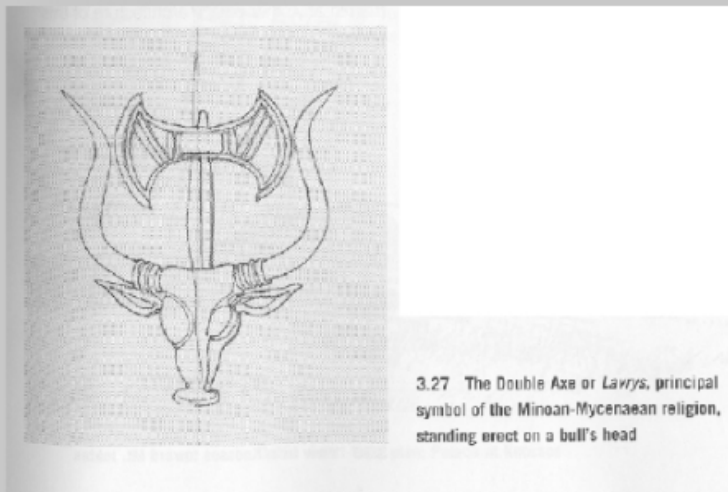

3.27 The Double Axe or *Labrys*, principal symbol of the Minoan-Mycenaean religion, standing erect on a bull's head

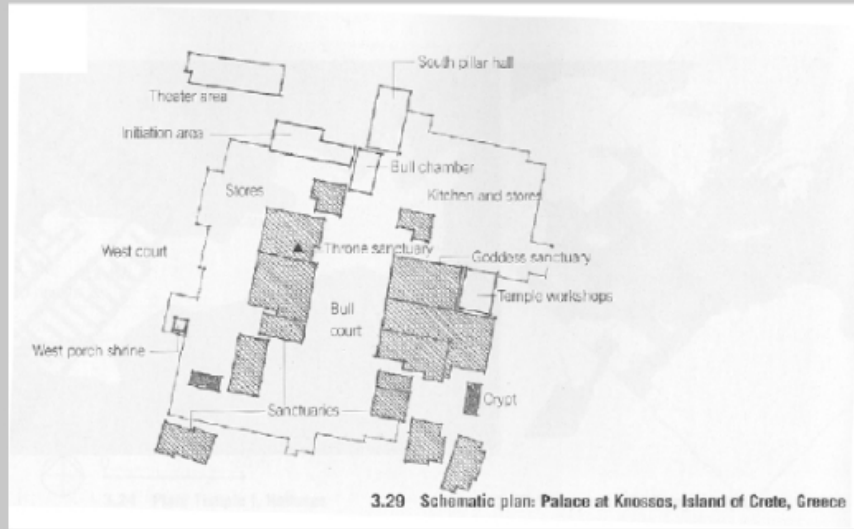

ARCH 1121 HISTORY OF ARCHITECTURAL TECHNOLOGY
PROF. BERNARDETE FALL 2008

CLASS 1 JARZOMBEC, CHING, & PRAKESH-A GLOBAL HISTORY OF ARCHITECTURE

Palace of Knossos: 1600BCE

Home to King Minos

Built as a labyrinth – 1500 rooms

Evolved organically around a central courtyard

Entrance with guard house

Living on upper level

Queens suite had a bathroom with sophisticated drainage system



ww
w.
uark
.edu

Palace of Knossos: 1600BCE



Palace of Knossos: 1600BCE



ww
w.
uark
.edu

Pottery for storage of food

Pottery for wine



ww
w.
uark
.edu

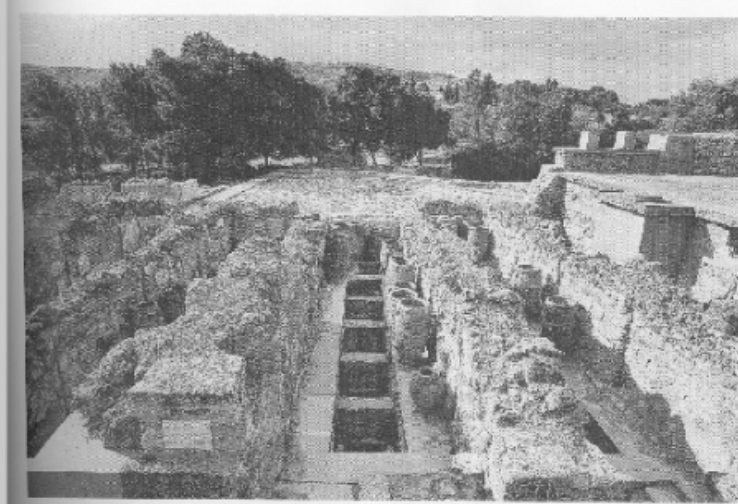

4-7 View of the magazine, west wing of the palace at Knossos, with large pit in situ

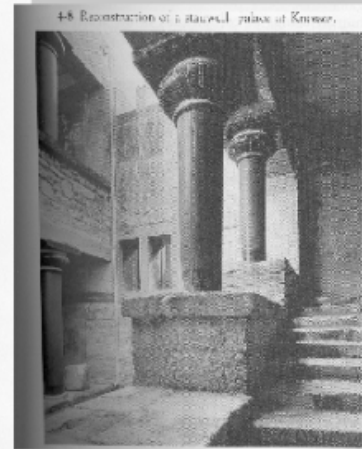

4-8 Reconstruction of a staircase, palace of Knossos.

ARCH 1121 HISTORY OF ARCHITECTURAL TECHNOLOGY
PROF. BERNARDETE FALL 2008

CLASS 1 GARDENER-ART THROUGH THE AGES





Mycenae: On the eastern shore of Peloponnese, Greece.
On the hilltop with a view of the sea and land.



Mycenaean Civilization: 1600-1200BCE:

Lived in the region of Mycenae

Thick walled city (20-25' thick)

Had good underground water supply

Elite group organized around a judicial and executive authority with various ranks and power

Great military

1200 BCE peasant rebellions and internal warfare destroyed most of the Mycenae palace and the civilization disappeared.

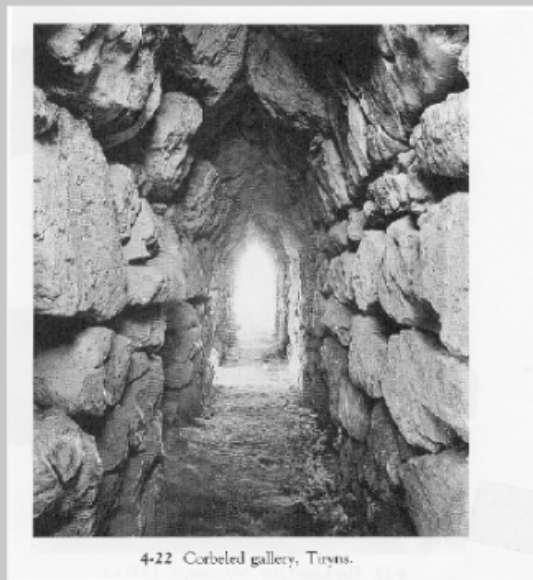
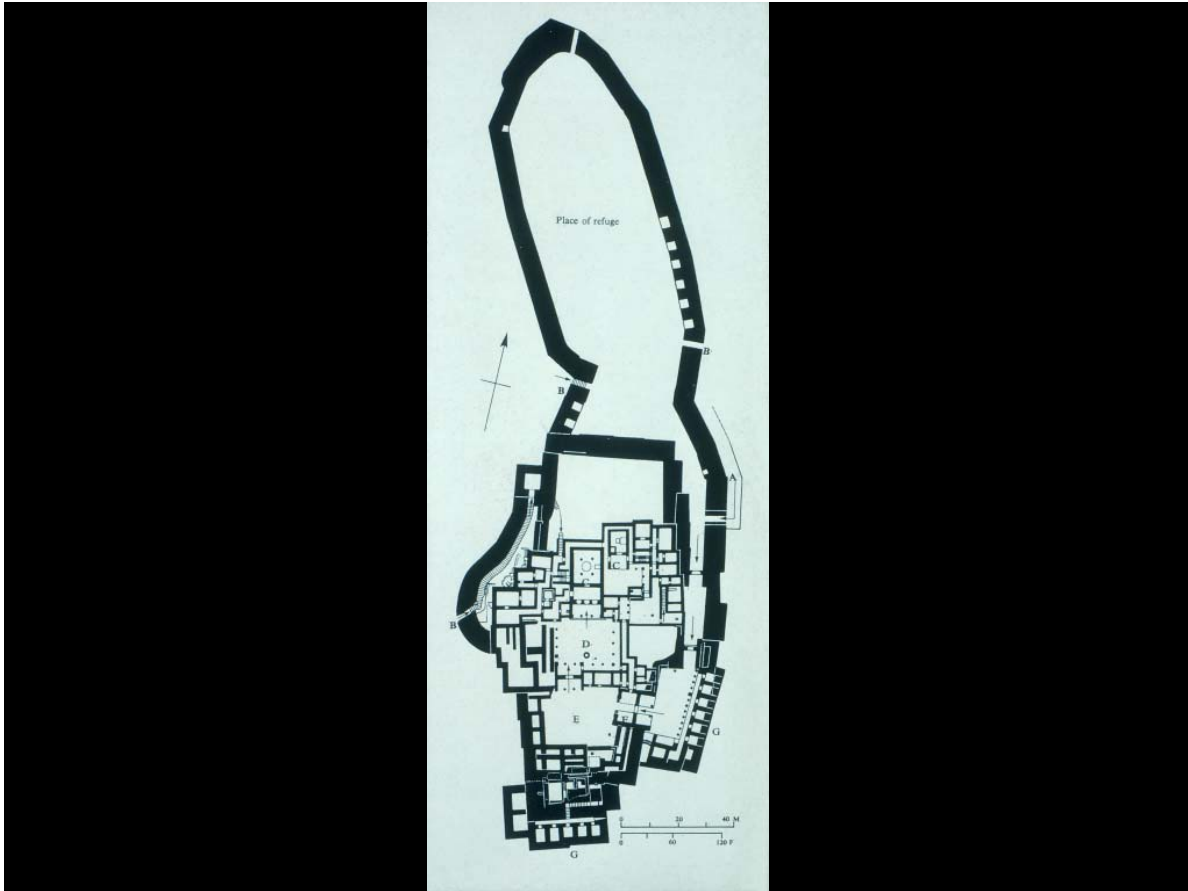

4-22 Corbeled gallery, Troyns.

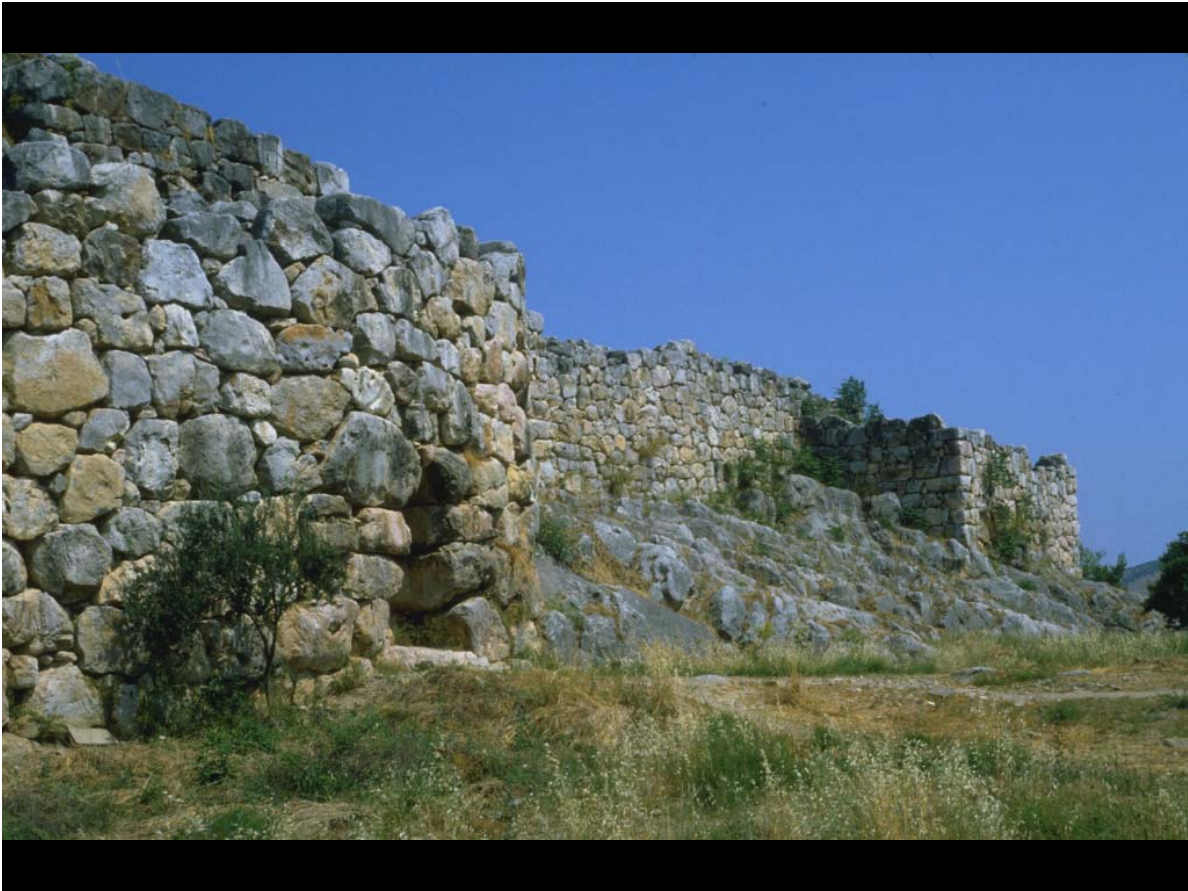

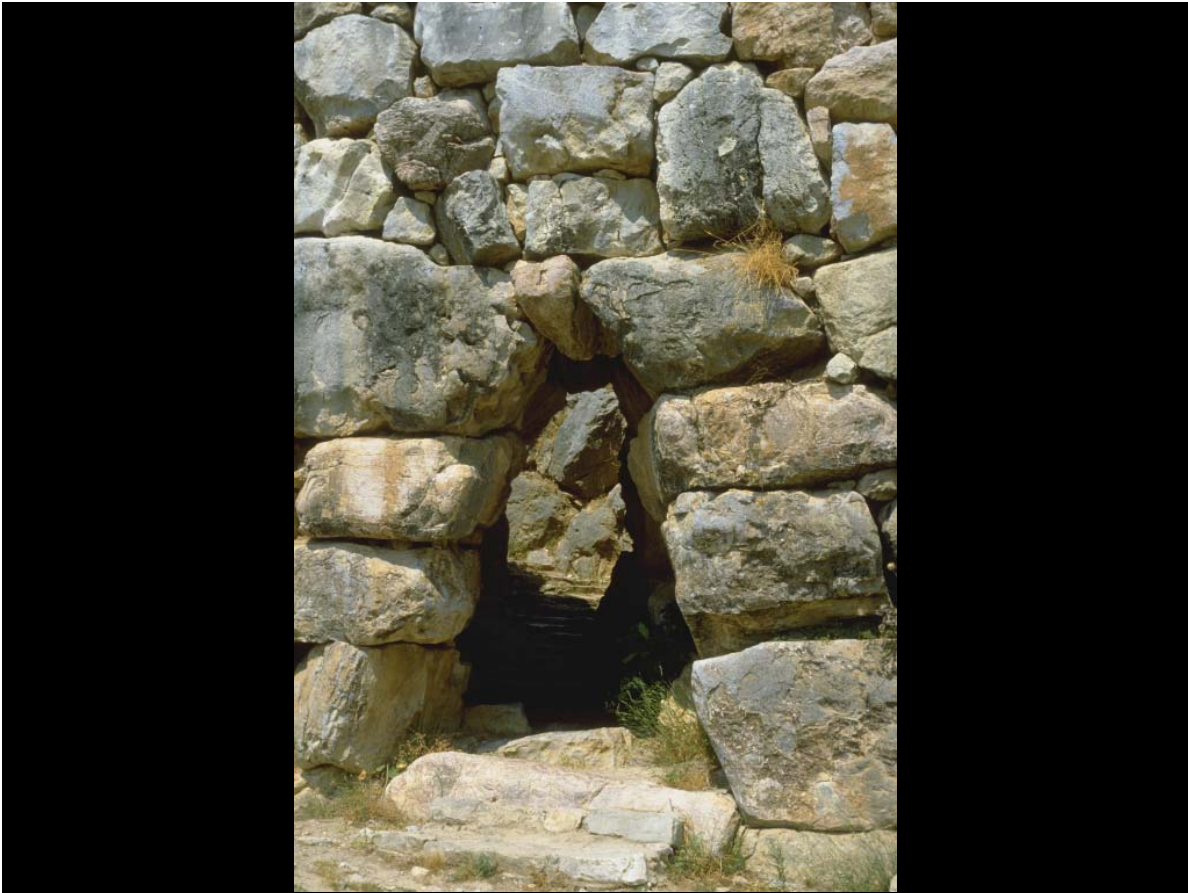

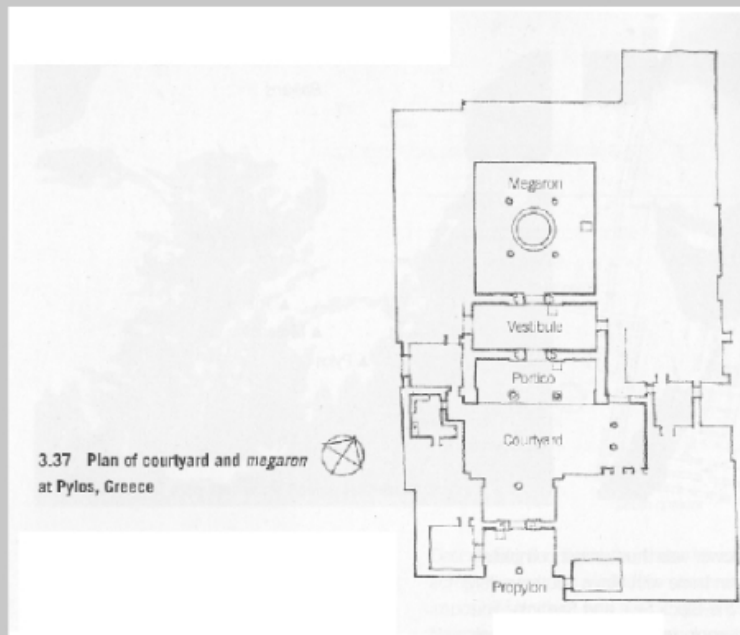
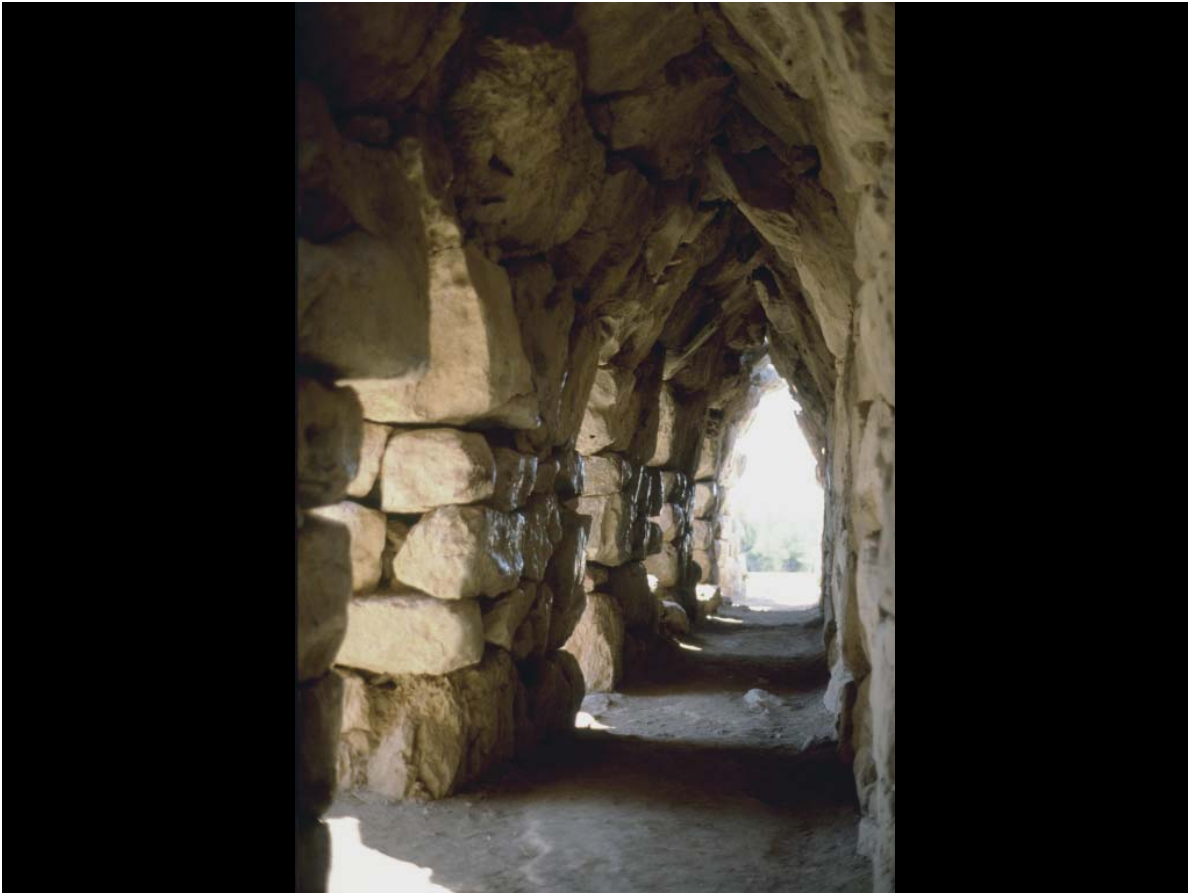

3.37 Plan of courtyard and megaron at Pylas, Greece







152. The Lion Gate, Mycenae, Greece. 1250 B.C.

ARCH 1121 HISTORY OF ARCHITECTURAL TECHNOLOGY
PROF. BENARDETE FALL 2008

CLASS 1

GARDENER-ART THROUGH THE AGES

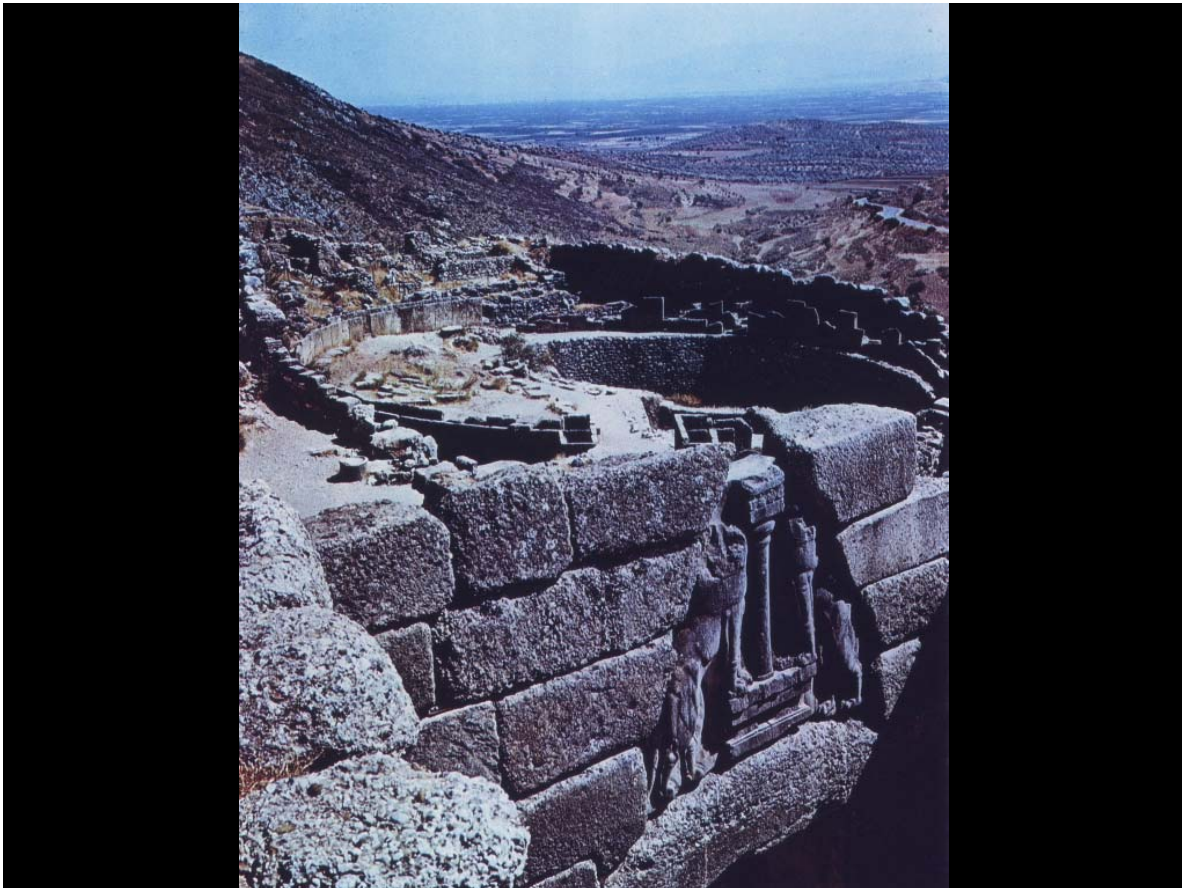

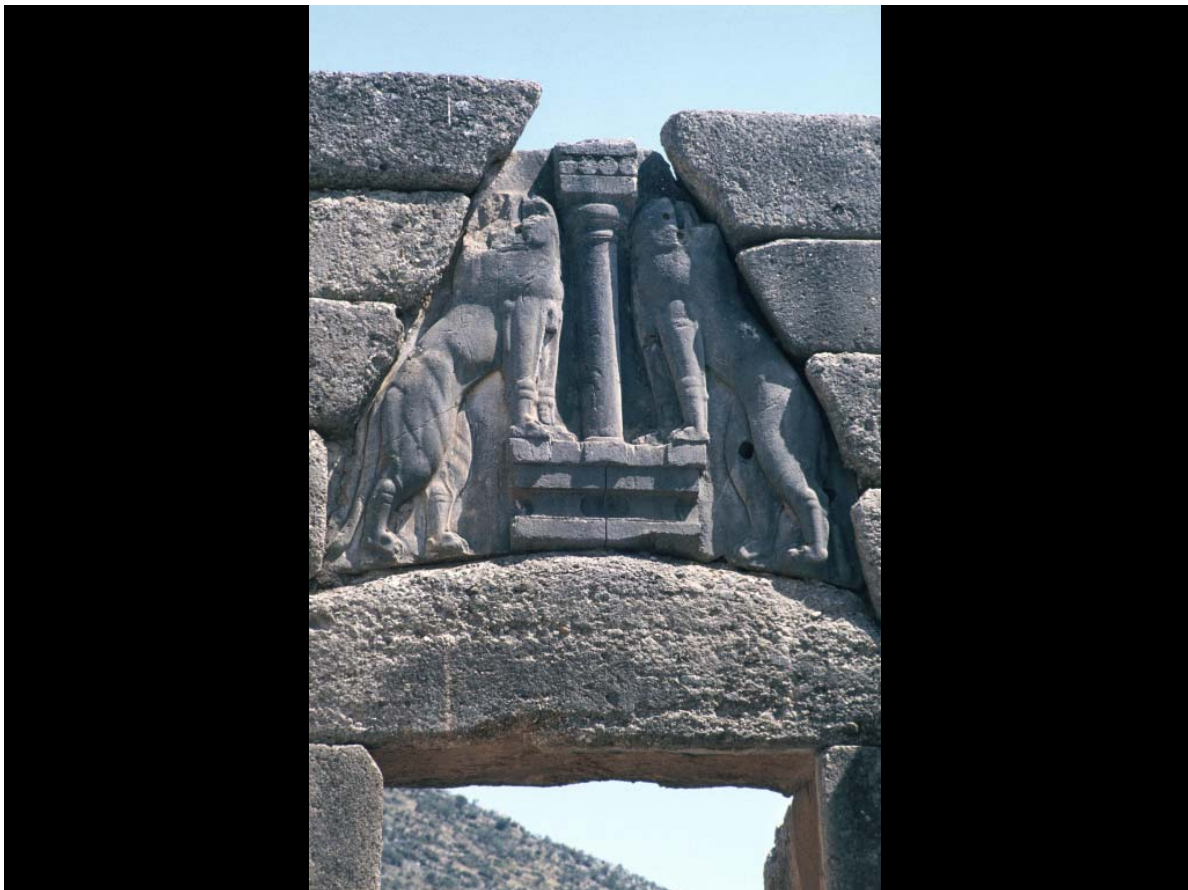

Treasury of Atreus: 1300BCE

Bee like structure

120' long and 20' wide

Cement floor

Doorway similar to Egyptian pylon



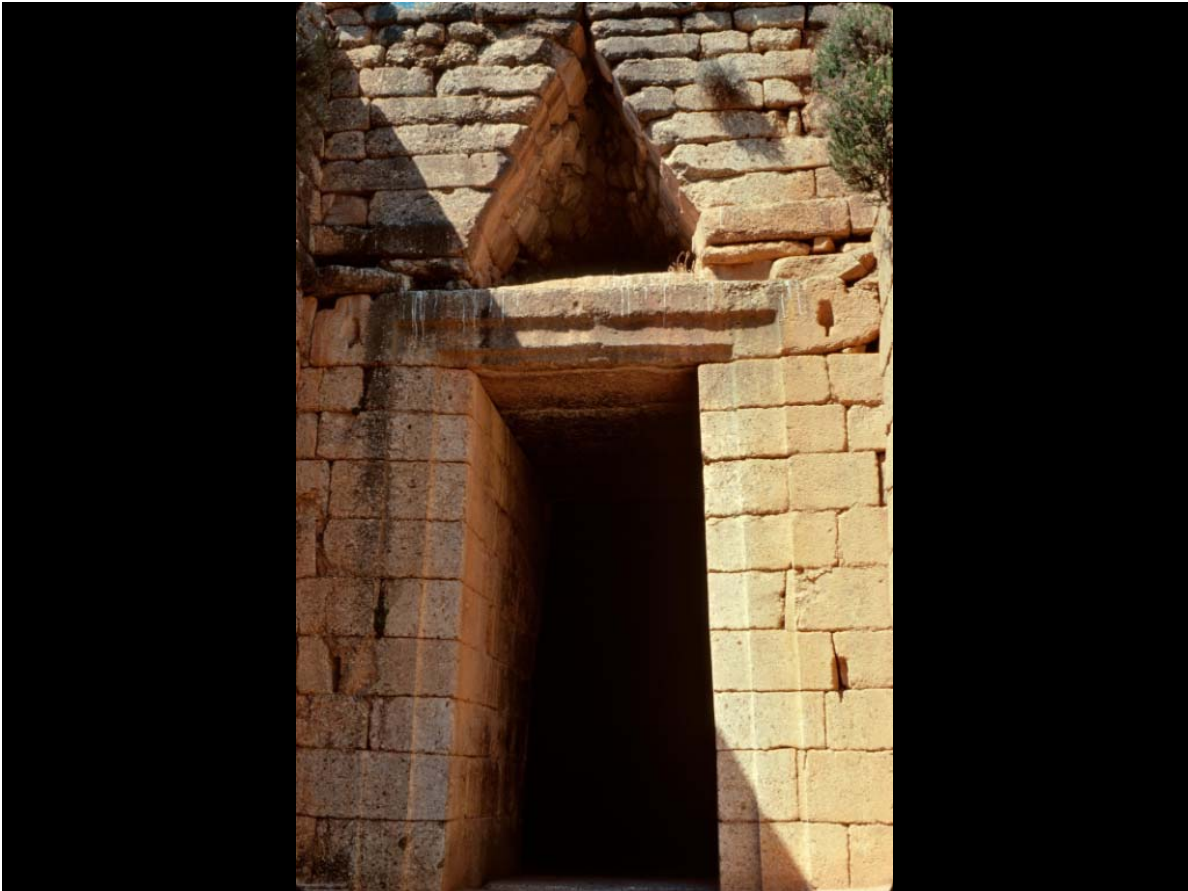

Treasury of Atreus: 1300BCE

44' high rotunda – masonry domed vault of 33 courses

Technical perfection

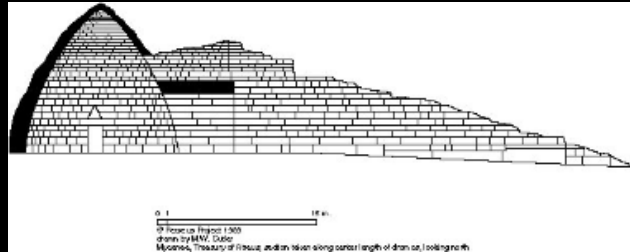

www.pers.us.tufts.edu

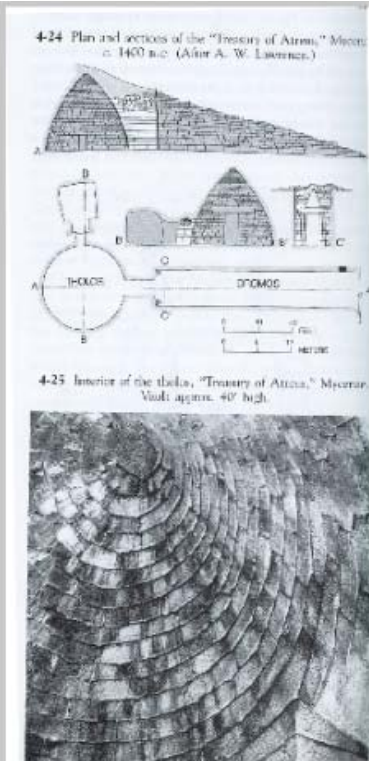
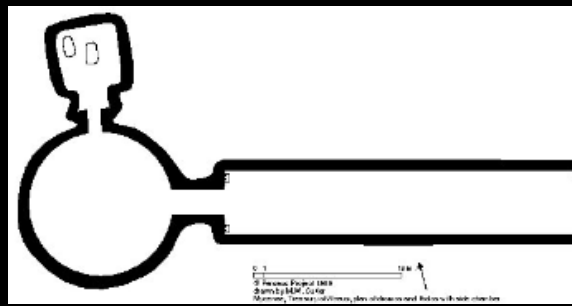

3.41 Section: Treasury of Atreus, near Mycenae, Greece

By the end of the twelfth century, the

3.42 Entrance facade, Treasury of Atreus

3.43 Plan: Treasury of Atreus

ARCH 1121 HISTORY OF ARCHITECTURAL TECHNOLOGY CLASS 1 JARZOMBEC, CHING, & PRAKESH-A GLOBAL HISTORY OF ARCHITECTURE
PROF. BERNARDETE FALL 2008

Treasury of Atreus: 1300BCE



www
enca
rta.
msn.
com



ARCH 1121 HISTORY OF ARCHITECTURAL TECHNOLOGY
PROF. BENAEDETE FALL 2008

CLASS 1

GARDENER-ART THROUGH THE AGES