

	Board #11 Residential Outdoor Space	p. 191
	Board #3 Residential Elevator Lobby	p. 59
	Board #4 Residential Corridor	p. 67
	Board #7 Warm Palette	p. 95
	Board #9 Cool Palette	p. 145
	Board #6 Residential Amenities	p. 85
	Board #5 Residential Elevator Cab	p. 77

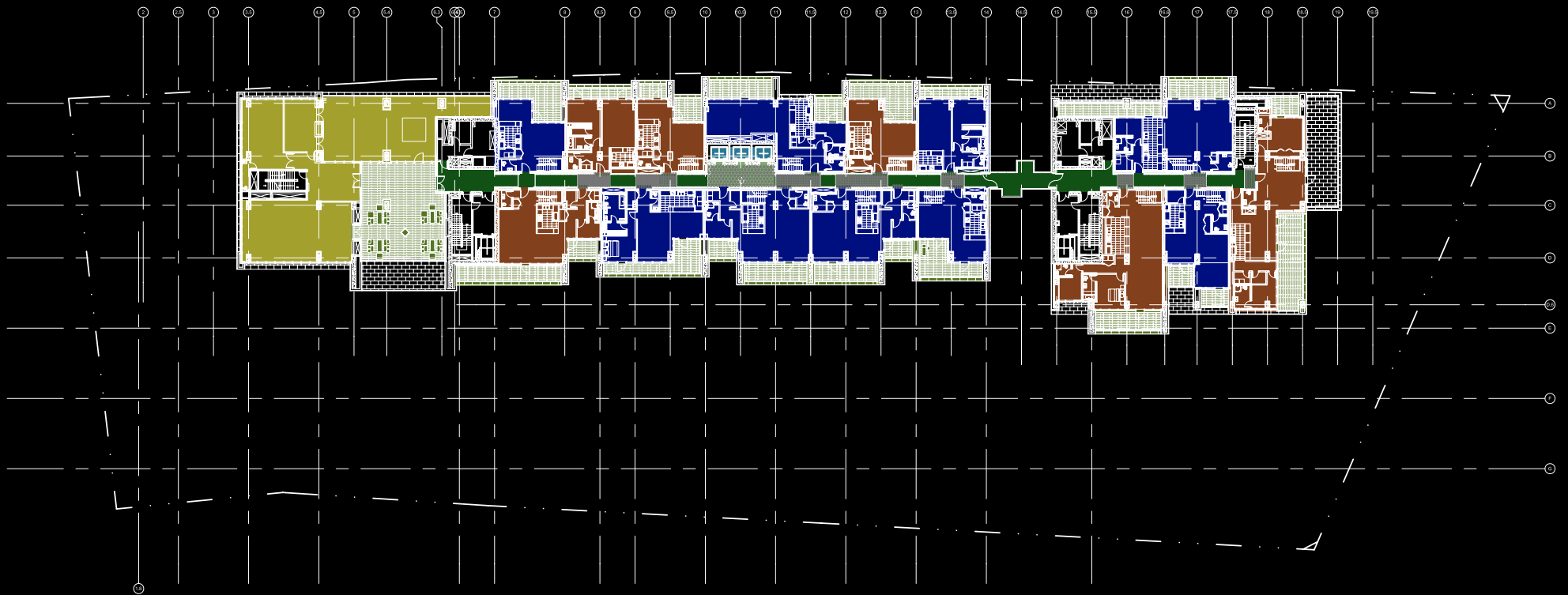

Level 8 Floor Plan
Not To Scale

APARTMENTS

COOL AND WARM PALETTE .

PARCEL/ BOARD NO	ROOM LOCATION	BOARD REFERENCE	MATERIAL CODE	Use Type	Material Type	Material / Product Name	Color	Finishes	Size	Source	Product Line	DATE	RIC / DRP MATERIAL REVIEW	DATE	REVISION 2-29 JUNE 2011	DATE	REVISION 2- 20 JUNE 2012
5.04/07	WARM PALETTE- LIVING ROOM, BEDROOMS & KITCHEN	(WF03)		Warm Palette- Living Room, Bedrooms & Kitchen Corridor Skirting	WOOD Engineered Wood Flooring	150 oak campagnard - aspect naturel / Linea 90 Oak Aspect Natural	Oak	Aspect Natural	plank Size: 14.5mm thick x 9 cm wide x 50 120 cm long	Liston Giordano by Faden	WOOD			27-6-2011	APPROVED (See page 38.1)		
5.04/07	WARM PALETTE- LIVING ROOM, BEDROOMS & KITCHEN			Warm Palette- Living Room, Bedrooms & Kitchen Counter top & Back Splash ST 13	ENGINEERED STONE	BIANCO NACARADO	BEIGE	Polished	20mm thick with a 40mm eased edge square profile	AL-MULHEM & AL-HEKMAA - COMPAC	ENGINEERED STONE				ONGOING	20-2-2012	APPROVED. (300 X 300)SAMPLE (See page 38.3)
5.04/07	WARM PALETTE- LIVING ROOM, BEDROOMS & KITCHEN	ST - 20		Warm Palette- Living Room, Bedrooms & Kitchen WARM PALETTE KITCHEN FLOOR	STONE Marble	BOTTICINO FIORITTO	Light Beige	Honed	REFER DWGS	MARBLE ART	MARBLE					20-2-2012	APPROVED. (600 X 300)SAMPLE (See page 38.4)
5.04/07	WARM PALETTE- LIVING ROOM, BEDROOMS & KITCHEN			Warm Palette-Living & Dining Room Floor	LIMESTONE	Cedar Stone	Light Brown	Honed	REFER DRAWINGS	MARBLE ART	LIMESTONE					24-05-12	APPROVED (600X600)SAMPLE SEE PAGE 38.5
5.04/07	WARM PALETTE- LIVING ROOM, BEDROOMS & KITCHEN	(P701)		Warm Palette-Living Room, Bedrooms & Kitchen Ceiling & Wall	Paint	Interior Latex Paint	COLOR:ROYY BASE 83/043 TREASURED MOMENT RAL-9003	EGGSHELL	n/a	www.gildden.com (800)454-3336(212) 966 3466 OR EQUAL APPROVED	PAINT	1-May-11	APPROVED SUBJECT TO COMMENT- COMMENT-CHANGE TO SPECIAL PAINT- CONSIDER AND PRESENT TO DRP		APPROVED. TO MOCK UP (PREVIOUS COMMENT INCORRECT)		
5.04/07	WARM PALETTE- LIVING ROOM, BEDROOMS & KITCHEN	(ST10)		Warm Palette-Living & Dining Room Floor	STONE-Marble	Marble (Intersect) Empressor Light Turkish Marble	Light brown (RAL N/A)	Honed	600 X 600 X 30 MM TBD	MARBLE ART	STONE	1-May-11	ONGOING		ONGOING		NOT USED (ITEM REPLACED WITH CEDAR STONE)
5.04/07	WARM PALETTE- LIVING ROOM, BEDROOMS & KITCHEN	(MTL11)		Warm Palette-Living room, Bedrooms & Kitchen Door, Fittings & Hardware	METAL Bronze	NA	Medium-Stainary-Stained BHMA 613	Clear-Organic-Coating- Vertical-Finished Oil-Rubbed Bronze	refer to drawings / N/A	by elevato manufacturer OR EQUAL APPROVED- By Hardware Manufacturer	METAL	1-May-11	APPROVED SUBJECT TO COMMENT- COMMENT-SUBSTITUTE TO BE CROSS ANNOTATED PER TO APPROVED AND APPROVED TO APPROVED CONSIDER AND PRESENT TO DRP		ONGOING		NOTE: ITEM IS BEING ADDRESSED IN HARDWARE PACKAGE.
5.04/07	WARM PALETTE- LIVING ROOM, BEDROOMS & KITCHEN	(WF03)		Warm Palette- Living Room, Bedrooms & Kitchen Corridor Skirting	WOOD Engineered Wood Flooring	Oak flooring Oak-Hempshire	NA	Aspect Natural	TBD	www.kahrs.com-(407)-260-9910x120-8800-8000 8243-35-OR-EQUAL-APPROVED	WOOD	1-May-11	APPROVED SUBJECT TO COMMENT- COMMENT-SUBSTITUTE TO BE CROSS ANNOTATED PER TO APPROVED AND APPROVED TO APPROVED CONSIDER AND PRESENT TO DRP		ITEM REPLACED AS BELOW		NOT USED (ITEM REPLACED WITH 150 OAK CAMPAGNARD - ASPECT NATUREL)
5.04/07	WARM PALETTE- LIVING ROOM, BEDROOMS & KITCHEN	(ST 13)		Warm Palette- Living Room, Bedrooms & Kitchen Counter top & Back Splash ST 13	STONE-Quartz	OH-White-Quartz-Stone- AZURE-PEARL-UNBLENDED	Off-White (RAL-N/A)	Polished	600 X 600 X 30 MM TBD available thickness 34"-to-1-3/4" 20mm thick with a 40mm eased edge square profile	www.ceresitstone.com-(714)745-0997-OR-EQUAL- APPROVED	QUARTZ	1-May-11	REJECTED, COMMENT-CHANGE TO MARBLE COMMENT-CHANGE TO APPROVED AND APPROVED CONSIDER AND PRESENT TO DRP		ITEM REPLACED AS BELOW		NOT USED (ITEM REPLACED WITH BIANCO NACARADO MARBLE)
5.04/07	WARM PALETTE- LIVING ROOM, BEDROOMS & KITCHEN	(CT05)		Warm Palette- Living Room, Bedrooms & Kitchen WARM PALETTE KITCHEN FLOOR	PORCELAIN	Porcelain tile Crema Eda Slate	Off-White	Honed	TBD	www.granitfandre.com (516) 800-8870/7065 info@granitfandre.com OR EQUAL APPROVED	PORCELAIN TILE	1-May-11	REJECTED, COMMENT-CHANGE TO MARBLE COMMENT-CHANGE TO APPROVED AND APPROVED CONSIDER AND PRESENT TO DRP		ONGOING		NOT USED (ITEM REPLACED WITH BOTTICINO FIORITTO)
5.04/07	WARM PALETTE- LIVING ROOM, BEDROOMS & KITCHEN	(WV03)		Warm Palette-Living Room, Bedrooms & Kitchen Kitchen Cabinet	WOOD Teak Wood	Teak Wood Veneer on Standard Veneer Core	Wood Veneer	TBD	TBD	LDA request assistance from SRG OR EQUAL APPROVED	WOOD	1-May-11	APPROVED SUBJECT TO COMMENT- COMMENT-SUBSTITUTE TO BE CROSS ANNOTATED PER TO APPROVED AND APPROVED TO APPROVED CONSIDER AND PRESENT TO DRP		ONGOING	20.2.2012	APPROVED (See Page 38.2)

BOARD #07
Warm Palette

OK
with
1.5.11

↙ possible larger sample

MTL11

WV03

ST13

ST10

CT05

WF03

PT01

No

+
↙

color only

PARCEL 5.04
SOM 2011

**PARCEL 5.04
SOM**

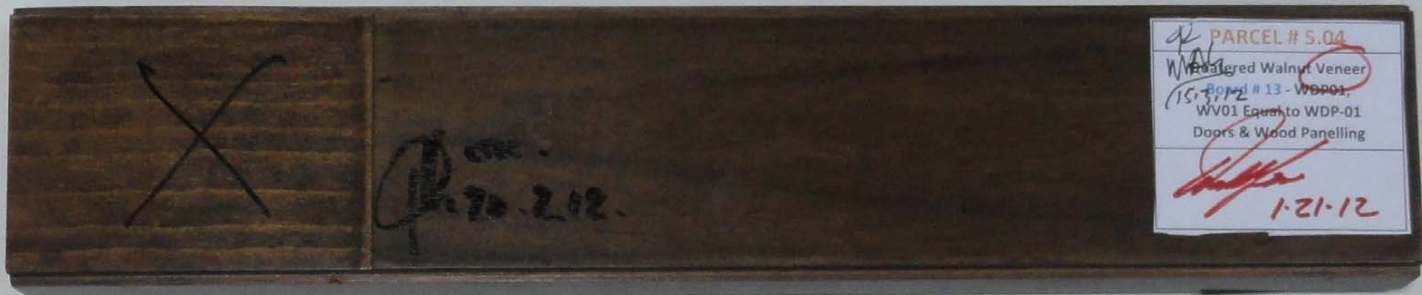

PARCEL # 5.04
 Red Walnut Veneer
 Board # 13 - WDP04
 WV01 Equiv to WDP-01
 Doors & Wood Panelling
 15.3.12
 1-21-12

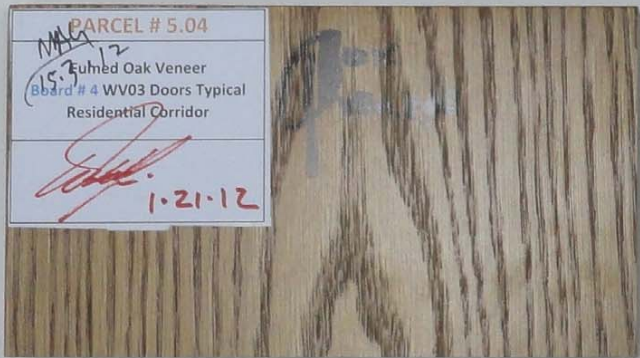

PARCEL # 5.04
 Eumed Oak Veneer
 Board # 4 WV03 Doors Typical
 Residential Corridor
 15.3.12
 1-21-12



FORMICA
F 7961 VEL SNOW
 20.2.12
 NOTE: WOODEN PAINTED FINISH PT02 RAL 7042 CHANGE
 TO FORMICA F 7961 VEL SELECTED BY THE LDA REFER
 TO # RFI 1110-504-REL-A-3458



PARCEL - 5.04.
 (WV-05)PLAIN SLICED RED OAK CLEAR.
 LOCATION: BEDROOM, STAIR
 A, CORRIDOR, STAIRB, ELEV. VESTIBULE, KITCHEN,
 BATHROOM, LAUNDRY, STAIR C, MECH, OFFICE
 OK NAC
 20.2.12

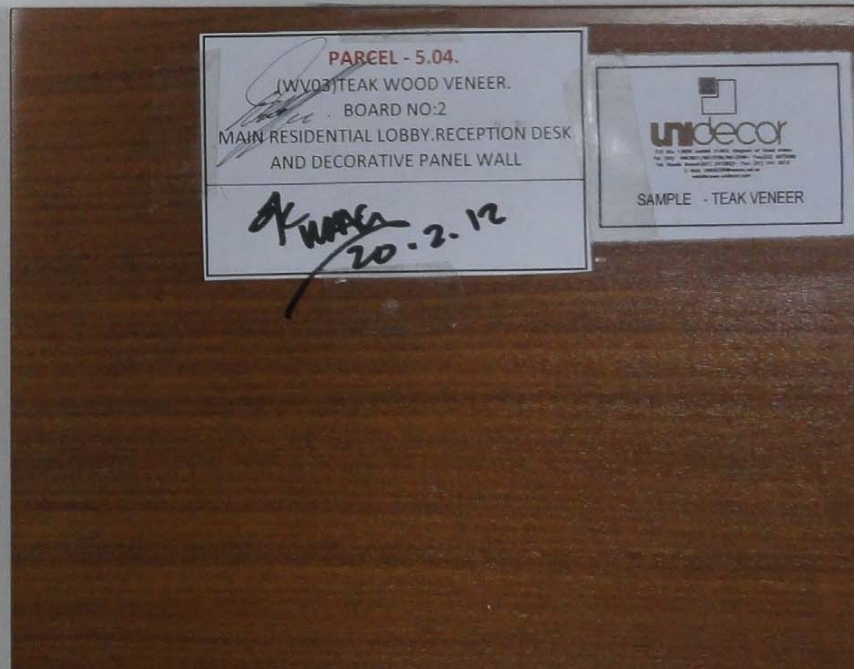

PARCEL - 5.04.
 (WV03) TEAK WOOD VENEER.
 BOARD NO: 2
 MAIN RESIDENTIAL LOBBY, RECEPTION DESK
 AND DECORATIVE PANEL WALL
 OK NAC
 20.2.12

Unidecor
 SAMPLE - TEAK VENEER

Privacy Panels





Typical 3 Bedroom Upper Level Plan (Warm Palette)



Typical 3 Bedroom Lower Level Plan (Warm Palette)

PARCEL/ BOARD NO	ROOM LOCATION	BOARD REFERENCE	MATERIAL CODE	Use Type	Material Type	Material / Product Name	Color	Finishes	Size	Source	Product Line	DATE	RIC / DRP MATERIAL REVIEW	DATE	REVISION 2-29 JUNE 2011	DATE	REVISION 2- 20 JUNE 2012
5.04/08	Warm Palette Bathroom	(CT1)		Warm Palette-Standard Bathroom-MASTER BATHROOM ACCENT AREA	Porcelain	Porcelain tile Marfil Select	Off-White (RAL N/A)	Honed	600X600X30	www.granitflandre.com (+39) 0536 85008/857065 info@granitflandre.it OR EQUAL APPROVED	PORCELAIN TILE	1-May-11	APPROVED SUBJECT TO COMMENT COMMENT: STANDARD BATHROOM ONLY NOT FOR MASTER BATHROOM-REVIEW DRAWING CONSIDER AND SUBMIT TO DRP		ITEM REPLACED AS BELOW		NOT USED (ITEM REPLACED WITH CREMA MARFIL MARBLE)
5.04/08	Warm Palette Bathroom	(ST10)		Warm Palette- Bathrooms Master Bathroom Wall & Floor- Sink Counter Powder room	LIMESTONE	Cedar Stone	REFER SAMPLE	Honed	REFER DRAWINGS	MARBLE ART	LIMESTONE					24-05-12	APPROVED (600X600)SAMPLE SEE PAGE 42.3
5.04/08	Warm Palette Bathroom	NO NUMBER		Warm Palette- Bathrooms All Plumbing Fixtures	SANITARY FIXTURES	Chrome	See Specs	Polished	See Specs	See Specs OR EQUAL APPROVED	METAL	1-May-11	APPROVED SUBJECT TO COMMENT. COMMENT: SUBJECT TO FURTHER REVIEW OR ALTERNATE REVISION: CONSIDER AND SUBMIT TO DRP		ONGOING		NOTE: ITEM IS BEING ADDRESSED IN SANITARY WARE PACKAGE.
5.04/08	Warm Palette Bathroom	(PT01)		Warm Palette- Bathrooms Powder room Ceiling	Paint	Interior Latex Paint	COLOR:ADY BASE 83/043 TREASURED MOMENT RAL-9003	EGGSHELL	n/a	www.gildden.com, (800)454- 3336(212) 966 3466 EQUAL APPROVED	PAINT	1-May-11	APPROVED SUBJECT TO COMMENT. COMMENT: CHANGE TO SPECIAL PAINT CONSIDER AND SUBMIT TO DRP		APPROVED. (PREVIOUS COMMENT IS INCORRECT)		
5.04/08	Warm Palette Bathroom	(ST10)		Warm Palette- Bathrooms Master Bathroom Wall & Floor- Sink Counter Powder room	STONE-Marble	Marble (interior) Empresson-Light Turkish-Marble	Light brown (RAL N/A)	Honed	13004600 600x600x10 (Floors) 600x600x20 (Walls)	MARBLE ART	STONE	1-May-11	APPROVED SUBJECT TO COMMENT COMMENT: TO BE RE-DESIGNED AS MARBLE EMPERSSON-LIGHT CONSIDER AND SUBMIT TO DRP		ONGOING		NOT USED (ITEM REPLACED WITH CEDAR STONE)
5.04/08	Warm Palette Bathroom	(CT07)		Warm Palette- Bathrooms Standard Bathroom Wall and Floor	Porcelain	Porcelain tile Silver Ground	Light grey (RAL N/A)	Honed	13004600 600x600x10 (Floors) 600x300x10 (Walls)	www.granitflandre.com (+39) 0536 85008/857065 info@granitflandre.it OR EQUAL APPROVED BY FADEN	PORCELAIN TILE	1-May-11	APPROVED SUBJECT TO COMMENT. COMMENT: STANDARD BATHROOM ONLY CONSIDER AND SUBMIT TO DRP		ONGOING NOTE: ADA TO SUBMIT DESIGN DRAWING SHOWING TRILING MODULE BEFORE 6/26/66 CAN BE CONFIRMED 1/20/11 NOT AVAILABLE FOR 600 X-600-6-WALL-600-X-300-ARE AVAILABLE.	12/9/2011	APPROVED SEE DOCUMENT SUBMITTAL NUMBER : DB16D23-DC-A-0086.
5.04/08	Warm Palette Bathroom	ST 22		Warm Palette-Standard Bathroom-MASTER BATHROOM ACCENT AREA	STONE	style	Crema marfil	Honed	600X600X30	APPROVED MANUFACTURER	STONE					20-10-12	APPROVED (600X600)SAMPLE SEE PAGE 42.4
5.04/08	Warm Palette Bathroom	(WV04)		Warm Palette- Bathrooms Sink Cabinetry	WOOD VENEER	Teak Wood Veneer on Standard Veneer Core	Wood Veneer Fumed Oak to match WF04	TBD	TBD	TBD	WOOD	1-May-11	APPROVED SUBJECT TO COMMENT COMMENT: ITEM TO BE RE-DESIGNED AS BIBER-SINK-TOP & TOILET CONSIDER AND SUBMIT TO DRP		ONGOING		APPROVED. (See page 42.2)
5.04/08	Warm Palette Bathroom	NO NUMBER		Warm Palette- Bathrooms Biber-Sink,Top & Toilet	PLUMBING FIXTURES	White Porcelain	White (RAL N/A)	White Alpin (See Specs)	See Specs	See Specs OR EQUAL APPROVED	PORCELAIN	1-May-11	APPROVED SUBJECT TO COMMENT COMMENT: SUBJECT TO DESIGN REVIEW CONSIDER AND SUBMIT TO DRP		ONGOING		NOTE: ITEM IS BEING ADDRESSED IN SANITARY WARE PACKAGE.

BOARD #08
Warm Palette Bathroom

OK
WAG
1.5.11

not for
master of powder

std only

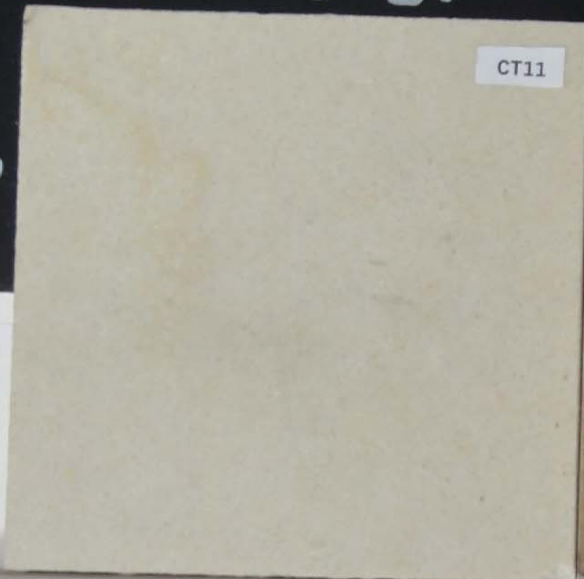

CT11

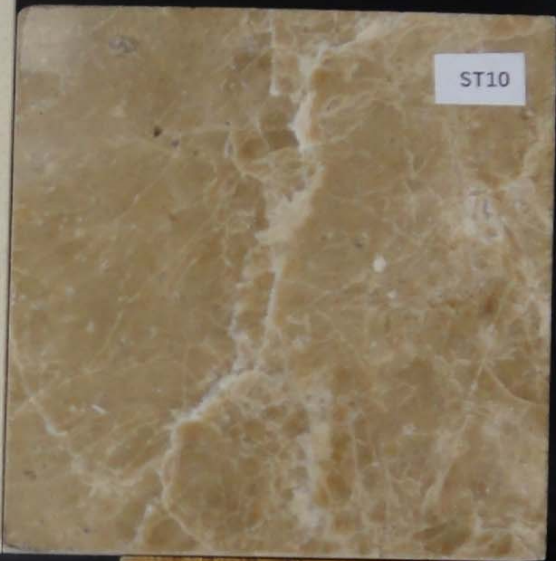

ST10

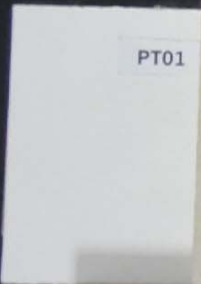

PT01



CT07



WV04

std only

colour only

PARCEL 5.04
SOM 2011

BOARD #08
Warm Palette Bathroom

OK
WAG
1.5.11

not for
master of powder

std only

Atlas concorde
style
crema
Marfil
5.04
B#8



PTC



std only

colour only

PARCEL 5.04
SOM 2011

42.1
REV 02

**PARCEL 5.04
SOM**



OK PARCEL # 5.04
 WVA
 15.3.12
 Registered Walnut Veneer
 Board # 13 - WDP04
 WV01 Equal to WDP-01
 Doors & Wood Panelling
 1-21-12

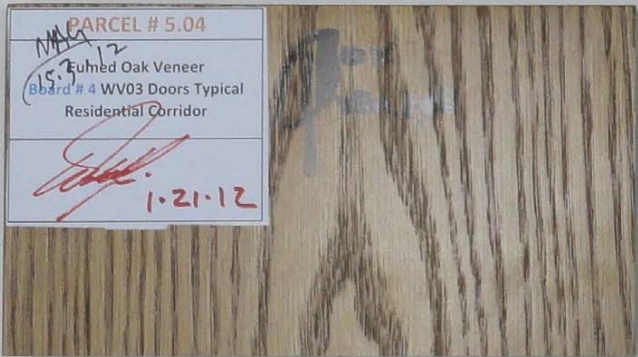

OK PARCEL # 5.04
 15.3.12
 Eumed Oak Veneer
 Board # 4 WV03 Doors Typical
 Residential Corridor
 1-21-12



FORMICA
F 7961 VEL SNOW
 20.2.12
 NOTE: WOODEN PAINTED FINISH PT02 RAL 7042 CHANGE
 TO FORMICA F 7961 VEL SELECTED BY THE LDA REFER
 TO # RFI 1110-504-REL-A-3458



OK PARCEL - 5.04.
 (WV-05) PLAIN SLICED RED OAK CLEAR.
 LOCATION: BEDROOM, STAIR
 A, CORRIDOR, STAIRB, ELEV. VESTIBULE, KITCHEN,
 BATHROOM, LAUNDRY, STAIR C, MECH, OFFICE
 20.2.12

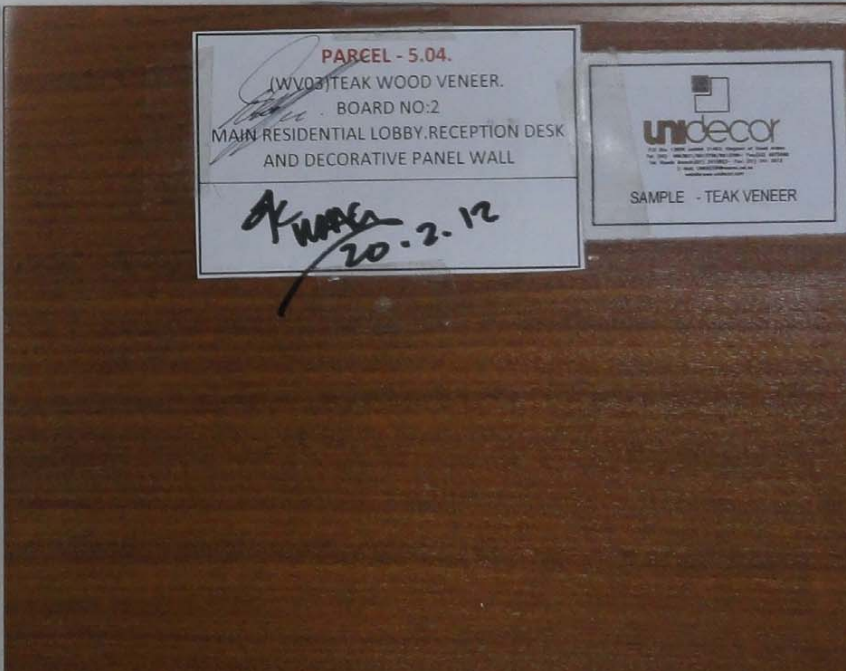

OK PARCEL - 5.04.
 (WV03) TEAK WOOD VENEER.
 BOARD NO:2
 MAIN RESIDENTIAL LOBBY, RECEPTION DESK
 AND DECORATIVE PANEL WALL
 20.2.12

Unidecor
 SAMPLE - TEAK VENEER



Kitchen Elevation 1

Typical 3 Bedroom Kitchen (Warm Palette)



Kitchen Elevation 2



Kitchen Elevation 3

Typical 3 Bedroom Kitchen (Warm Palette)



Kitchen Elevation 4

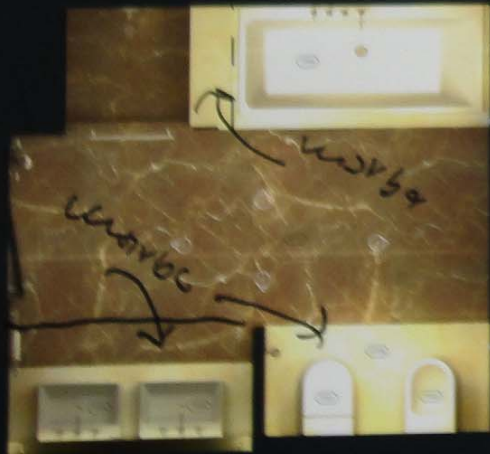

Typical Master Bathroom (Warm Palette)



Typical Standard Bathroom (Warm Palette)

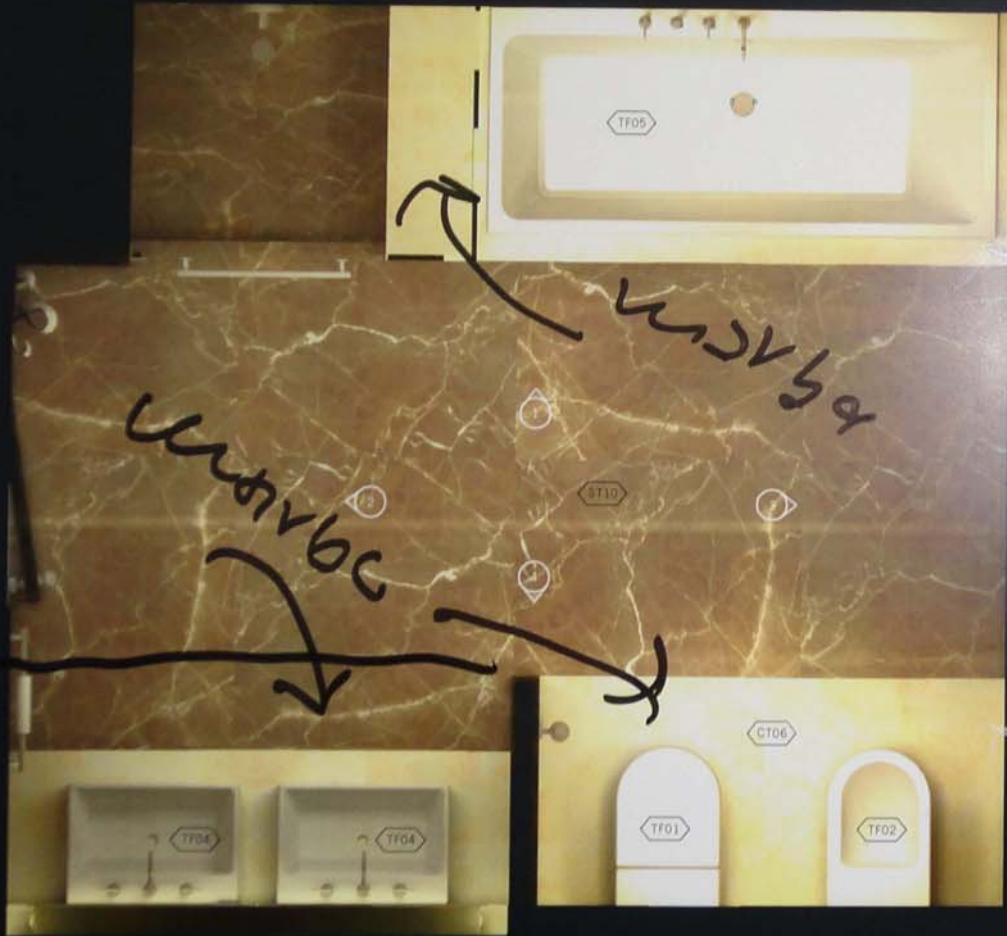

WARM

Plan

Typical Master Bathroom (Warm Palette)

440-30



Interior Elevation 1

Interior Elevation 2

Typical Master Bathroom (Warm Palette)



Interior Elevation 1
Scale 1/20



Interior Elevation 2
Scale 1/20



Typical Standard Bathroom (Warm Palette)

Marble tops
& shelves.

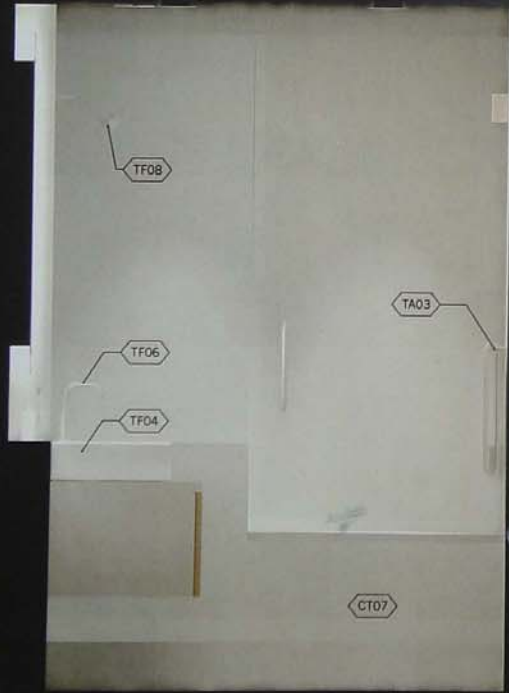

Interior Elevation 3
Scale 1:20

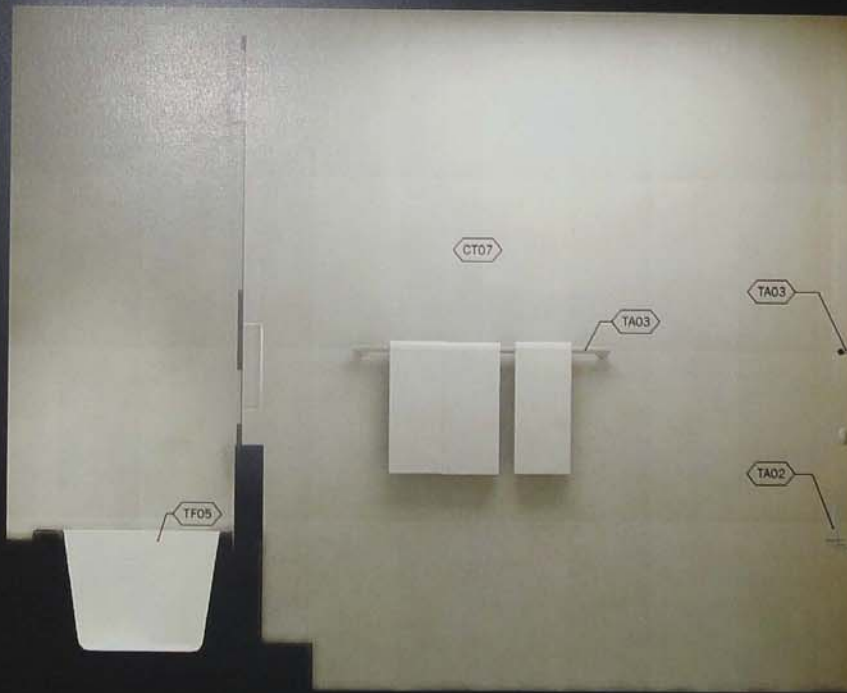

Interior Elevation 4
Scale 1:20

Typical Standard Bathroom (Warm Palette)



Interior Elevation 3

Typical Master Bathroom (Warm Palette)



Interior Elevation 4

KOHLER.

VAULT™

SELF-RIMMING/UNDERCOUNTER KITCHEN SINK K-3820

- Features**
- 18-gauge stainless steel
 - Self-rimming or undercounter
 - Includes installation hardware
 - Double (equal) compartment
 - 33" (83.8 cm) x 22" (55.9 cm)

- Codes/Standards Applicable**
- Specified model meets or exceeds the following:
- ASME A112.19.3/CSA B45.4

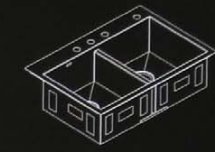

- Colors/Finishes**
- NA: None applicable
- Accessories**
- CP: Polished Chrome
 - NA: None applicable
 - Other: Refer to Price Book for additional colors/finishes

Specified Model

Model	Description	Colors/Finishes
K-3820-3	Self-rimming/Undercounter kitchen sink - 3-hole	J NA
K-3820-4	Self-rimming/Undercounter kitchen sink - 4-hole	J NA

Optional Accessories

Model	Description	J NA	J CP	J Other
K-8601	Dishrainer, sink strainer			
1131881	Hardware kit for countertops with a 2-1/2" (6.4 cm) thickness or less			

Product Specification

The kitchen sink shall be 33" (83.8 cm) in length, 22" (55.9 cm) in width. Sink shall be made of 18-gauge stainless steel. Sink shall be undercounter or self-rimming. Sink shall be double equal compartments. Sink shall include installation hardware. Sink shall be Kohler Model K-3820-NA.

KF1
Not in Node

Marble tops
& shelves.

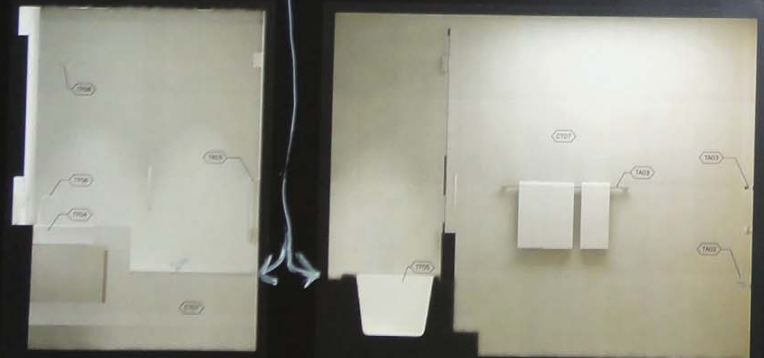

Interior Elevation 3
Scale: 1/8" = 1'-0"

Interior Elevation 4
Scale: 1/8" = 1'-0"

Typical Standard Bathroom (Warm Palette)

KOHLER FAUCETS

SIMPLICE®

PULL-DOWN KITCHEN SINK FAUCET K-596 ALSO K-597 ADA

- Features**
- Metal construction
 - One-piece, self-contained ceramic disc valve allows both volume and temperature control
 - Temperature memory allows faucet to be turned on and off at any temperature setting
 - Touch control for stream-to-spray water flow
 - Promotions technology with nylon hose and ball joint for easy operation
 - ADA compliant lever handle
 - Flexible connections for easy installation
 - Three-function sprayhead with spray, aerated stream, and pause settings
 - 360° spout rotation
 - Available with 8" (20.3 cm) or 6" (15.2 cm) swing spout reach
 - For single-hole or three-hole installation when included 10-1/2" (26.7 cm) escutcheon plate is used
 - 2.2 gallons (8.3 L) per minute maximum flow rate



- Codes/Standards Applicable**
- Specified model meets or exceeds the following at date of manufacture:
- ADA
 - ASME A112.18.1/CSA B125.1
 - ICC/ANSI A117.1
 - Energy Policy Act of 1992
 - NSF/ETL
 - All applicable US Federal and State material regulations

- Colors/Finishes**
- CP: Polished Chrome
 - VS: Stainless Steel

Specified Model

Model	Description	Colors/Finishes
K-596	Pull-down kitchen sink faucet - 8" (20.3 cm) swing spout reach (shown)	J CP J VS
K-597	Pull-down kitchen sink faucet - 6" (15.2 cm) swing spout reach	J CP J VS

NOTE: ADD 1.7GPM LOW FLOW AREATOR NO 1082533

Product Specification

The pull-down kitchen sink faucet with transitional styling shall be of metal construction. Product shall feature a 2.2 gallon (8.3 L) per minute maximum flow rate. Product shall feature a one-piece, self-contained ceramic disc valve, which allows both volume and temperature control. Product shall feature temperature memory, allowing the faucet to be turned on and off at any temperature setting. Product shall feature a touch control for stream-to-spray water flow and Promotions technology with nylon hose and ball joint for easy operation. Product shall feature an ADA compliant lever handle, 360° spout rotation, and flexible connections for easy installation. Product shall be available with a 3" (76.2 mm) or 4" (101.6 mm) swing spout reach. Product shall feature a three-function sprayhead with spray, aerated stream, and pause settings. Product shall be for single-hole or three-hole installation when included 10-1/2" (26.7 cm) escutcheon plate is used. Pull-down kitchen sink faucet shall be Kohler Model K-596.

KF2
Not in Node

Cooker hoods
DA 3160
DA 3180
DA 3190

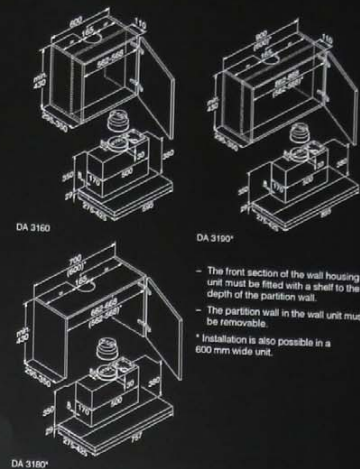

- The front section of the wall housing unit must be fitted with a shelf to the depth of the partition wall.
- The partition wall in the wall unit must be removable.
* Installation is also possible in a 600 mm wide unit.

www.miele.co.uk



Interior Elevation 1
Interior Elevation 2
Interior Elevation 3
Interior Elevation 4
Typical Powder Room (Warm Palero)

MIELE HOOD
DA 3160

SUB-ZERO

42" Built-In Side-by-Side

Model BI-425 offers convenient side-by-side refrigeration in a 42-inch width. Sub-Zero dual refrigeration along with two air purification and water filtration systems guard the freshness of your food and water like nothing before. Framed, meeting, flush front and stainless steel design options are available. The flush front installation option allows the unit to sit flush with surrounding cabinetry. Model BI-425 is ENERGY STAR® qualified.



Stainless steel model BI-425 shown with tubular handles.

- FEATURES**
- Dual refrigeration system ensures the freshest food and energy efficiency.
 - Electronic microprocessor constantly monitors entire unit to ensure proper food storage environment.
 - Air purification system reduces odors, bacteria, viruses and allergens gas.
 - Micro-impregnated water filtration system filters bacteria, viruses and sediment, but not fluoride.
 - Removable touch control panel.
 - Bright interior lighting throughout, including storage drawer area.
 - Adjustable spill-proof glass shelves, door shelves and dairy compartment.
 - Soft-close hinges and door drawers form a level temperature storage shelf for proteins and meats.
 - Easy-access flip-up grille.
 - Electronic freshness vents.
 - Max ice storage increases production for a 24-hour period.

MODEL OPTIONS

	BI-425O	BI-425S/TH	BI-425S/PH
Design	Overlay/Framed/Flush front	Stainless	Stainless
Grille	Panel	Stainless	Stainless
Handle	-	Tubular	Pro

*Handle not included in price for design flexibility.

INTERIOR FEATURES

- Refrigerator: 16.0 cu ft Capacity
- Air Purification System
- Adjustable Glass Shelves
- 1 Stain-Free Glass Shelf
- High-Capacity Drawer with Divider
- Storage Drawers with Divider
- 3 Adjustable Door Shelves
- 2 Storage Door Shelves
- Adjustable Dairy Compartment

ACCESSORIES

- Grilles for 83" or 88" finished height (84" in standard).
- Framed front panels in white and stainless steel.
- Flush front panels in stainless steel with tubular or pro handles.
- Side panel in white and stainless steel.
- Stainless steel kickplate.
- Framed grille insert and full-length handles.
- Stainless steel tubular and pro handles.
- Drawer egg container.
- Replacement air purification cartridge and water filter.
- Handle kit for 600 series panels.
- 92" door stop.

Accessories are available through your Sub-Zero dealer. For local dealer information, visit the Web at www.subzero.com.



Flip-up grille
Air purification system



Board #7
Warm Palero
Cue Sheets

MIELE HOOD
DA 3180

SUB-ZERO 42" Built-In Side-by-Side

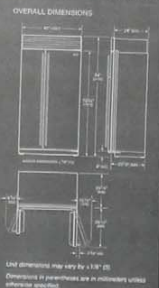

OVERALL DIMENSIONS

Unit dimensions may vary by 1/8" (2). Dimensions in parentheses are in millimeters unless otherwise specified.

SPECIFICATIONS

Overall Dimensions	42" W x 64" H x 24" D
Door Clearance	Standard: 20 1/2"
	Flush front: 20 1/2"
Opening Width	41 1/2"
Flush front Width	44"
Opening Height	63 1/2"
Flush front Height	64"
Opening Depth	24"
Flush front Depth	25 1/2"
Electrical Requirements	115 V AC, 60 Hz
	15 amp circuit
Flanking Requirements	1/2" COU top/bottom
	32-100 psi
Shipping Weight	82 lbs

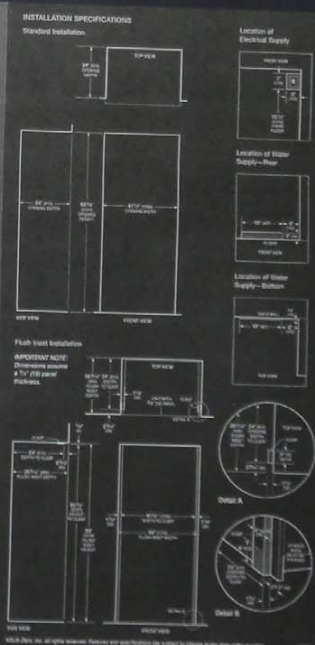

INSTALLATION NOTES

Built-in models may be used in a standard installation or in a flush front installation which allows the unit to be flush with surrounding cabinetry.

Complete installation specifications, including panel sizes, can be found on our website, www.subzero.com/specs.



Interior Elevation 1



Interior Elevation 2

Typical 3 bedroom Kitchen (Cool Palette)

150

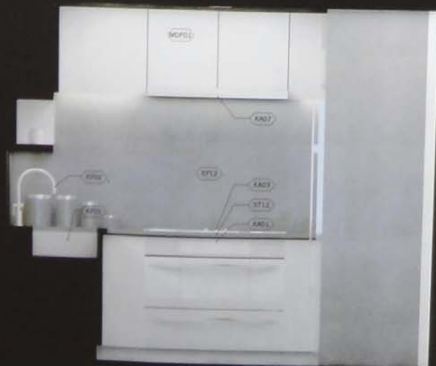

Interior Elevation 3



Interior Elevation 4



sample

privacy

ST12

MDF01



Cooker hoods
DA 3160
DA 3180
DA 3190

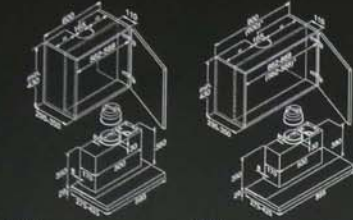

DA 3160

DA 3190*

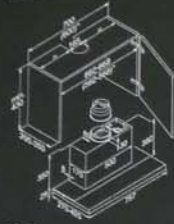

DA 3180*

- The front section of the wall housing unit must be fitted with a shelf to the depth of the partition wall.
- The partition wall in the wall unit must be removable.
- * Installation is also possible in a 600 mm wide unit.

45" Built-In Side-by-Side

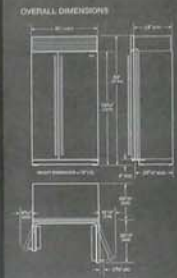

SPECIFICATIONS

Overall Dimensions	42" W x 81" H x 24" D
Door Clearance	Standard: 29 1/2" H Flush Inset: 28 1/2" H
Opening Width	41 1/2"
Flush Inset Width	44"
Opening Height	85 1/2"
Flush Inset Height	84"
Opening Depth	24"
Flush Inset Depth	26 1/2"
Electrical Requirements	115 V AC, 60 Hz 15 amp circuit
Plumbing Requirements	1/2" OD copper line 30-100 psi
Shipping Weight	582 lbs

INSTALLATION NOTES
Built-in models may be used in a standard cabinet or in a flush inset installation which allows the unit to be flush with surrounding cabinetry.
Complete installation specifications, including panel sizes, can be found on our website.

INSTALLATION SPECIFICATIONS

Standard Installation

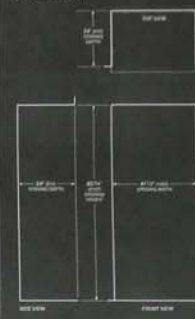

Flush Inset Installation



IMPORTANT NOTE:
Dimensional tolerance is +/- 1/8" (3.2 mm) maximum.

Location of Electrical Supply



Location of Water Supply - Flush



Location of Water Supply - Bottom



Detail A



Detail B



SIMPLICE[®]
PULL-DOWN KITCHEN SINK FAUCET

K-596
ALSO K-597
ADA

Features

- Metal construction
- One-piece, self-contained ceramic disc valve allows both volume and temperature control
- Temperature memory allows faucet to be turned on and off at any temperature setting
- Touch control for stream-to-spray water flow
- Promotive[™] technology with nylon hose and ball joint for easy operation
- ADA compliant lever handle
- Flexible connections for easy installation
- Three-function sprayhead with spray, aerated stream, and pause settings
- 360° spout rotation
- Available with 9" (22.9 cm) or 8" (20.3 cm) swing spout reach
- For single-hole or three-hole installation when included 10-1/2" (26.7 cm) escutcheon plate is used
- 2.2 gallons (8.3 L) per minute maximum flow rate

Colors/Finishes

- CP: Polished Chrome
- VS: Stainless Steel

Codes/Standards Applicable

- Specified model meets or exceeds the following at date of manufacture:
 - ADA
 - ASME A112.18.1/CSA B125.1
 - ICC-ANSI A117.1
 - Energy Policy Act of 1992
 - NSF 41
 - All applicable US Federal and State material regulations

Specified Model

Model	Description	Colors/Finishes
K-596	Pull-down kitchen sink faucet - 9" (22.9 cm) swing spout reach (chromium)	CP, VS
K-597	Pull-down kitchen sink faucet - 8" (20.3 cm) swing spout reach (chromium)	CP, VS

NOTE: ADD 1.7 GPM LOW FLOW AERATOR NO. 1002533

Product Specification

The pull-down kitchen sink faucet with transitional styling shall be of metal construction. Product shall feature a 2.2 gallon (8.3 L) per minute maximum flow rate. Product shall feature a one-piece, self-contained ceramic disc valve, which allows both volume and temperature control. Product shall feature temperature memory, allowing the faucet to be turned on and off at any temperature setting. Product shall feature a touch control for stream-to-spray water flow and Promotive[™] technology with nylon hose and ball joint for easy operation. Product shall feature an ADA compliant lever handle, 360° spout rotation, and flexible connections for easy installation. Product shall feature a 9" (22.9 cm) or 8" (20.3 cm) swing spout reach. Product shall feature a three-function sprayhead with spray, aerated stream, and pause settings. Product shall be for single-hole or three-hole installation when included 10-1/2" (26.7 cm) escutcheon plate is used. Pull-down kitchen sink faucet shall be Kohler Model K-596.



45" Built-In Side-by-Side

Model BI-425 offers convenient side-by-side refrigeration in a 45-inch width. Sub-Zero dual refrigeration along with new air purification and water filtration systems guard the freshness of your food and water. Ice making feature, framed overlay, flush inset and stainless steel design options are available. The flush inset installation system allows the unit to sit flush with surrounding cabinetry. Model BI-425 is ENERGY STAR[®] qualified.

FEATURES

- Dual refrigeration system ensures the freshest food and energy efficiency.
- Electronic compressor constantly monitors noise and to ensure proper food storage environment.
- Air purification system reduces odors, bacteria, viruses and ethylene gas.
- Microbiological water filtration system filters bacteria, viruses and sediment, but not fluoride.
- Illuminated touch control panel.
- Bright interior lighting throughout, including through drawer area.
- Adjustable spill-proof glass shelves, door shelves and dairy compartment.
- Soft-close onliner and full drawers form a lower temperature zone ideal for produce and meats.
- Easy access flip-up grille.
- Informational freshness cards.
- Max ice feature increases production for a 24-hour period.



Stainless steel model BI-425 shown with framed overlay.

MODEL OPTIONS

	BI-425/O	BI-425/TH	BI-425/PH
Design	Overlay-Framed/Flush Inset	Stainless	Stainless
Grille	Panel	Stainless	Stainless
Handle		Tubular	Pro

INTERIOR FEATURES

- Refrigerator: 16.0 cu ft Capacity
- Air Purification System
- 1 Adjustable Glass Shelf
- 1 Stationary Glass Shelf
- 1 High-Humidity Drawer with Divider
- 2 Storage Drawers with Divider
- 3 Adjustable Door Shelves
- 2 Secondary Door Shelves
- Adjustable Dairy Compartment
- Freezer: 8.0 cu ft Capacity
- Water Filtration System
- Automatic Ice Maker
- 3 Adjustable Wire Shelves
- 1 Stationary Glass Shelf
- 3 Storage Drawers
- 3 Adjustable Door Shelves

ACCESSORIES

- Grille for 82" or 88" finished height (84" is standard).
- Framed front panels in white and stainless steel.
- Flush inset panels in stainless steel with tubular or pro handles.
- Side panel in white and stainless steel.
- Stainless steel kickplate.
- Framed grille insert and full-length handles.
- Stainless steel tubular and pro handles.
- Down egg container.
- Replacement air purification cartridge and water filter.
- Handle kit for 600 series panels.
- 90° door stop.

Accessories are available through your Sub-Zero dealer. For local dealer information, visit the list or a subsection section of our website, subzero.com.

KM 5956

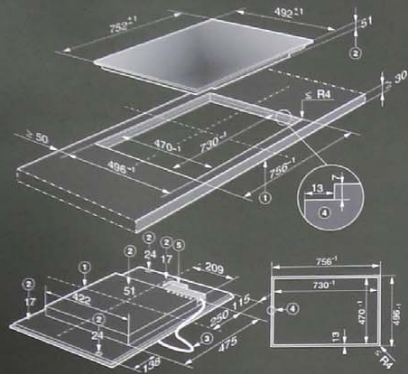

- ① Front
- ② Casing depth
- ③ Mains connection cable, L = 1440 mm
- ④ Stepped cut-out for granite or marble worktops
- ⑤ Connection for Miele@home

Cut-out dimensions for granite or marble worktops. Please take careful note of the inset diagram.

MIELE BURNER
Net to table

157

Steam ovens

Combi steam ovens

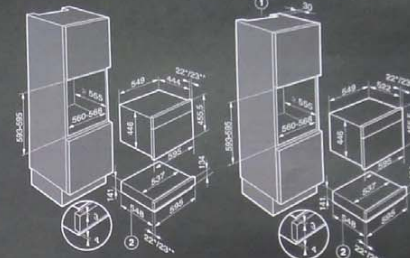

- * Appliances with glass front
- ** Appliances with metal front

① Ventilation cut-out required when combined with a combi steam oven

MIELE WARMING DRAWER
Net to table

160

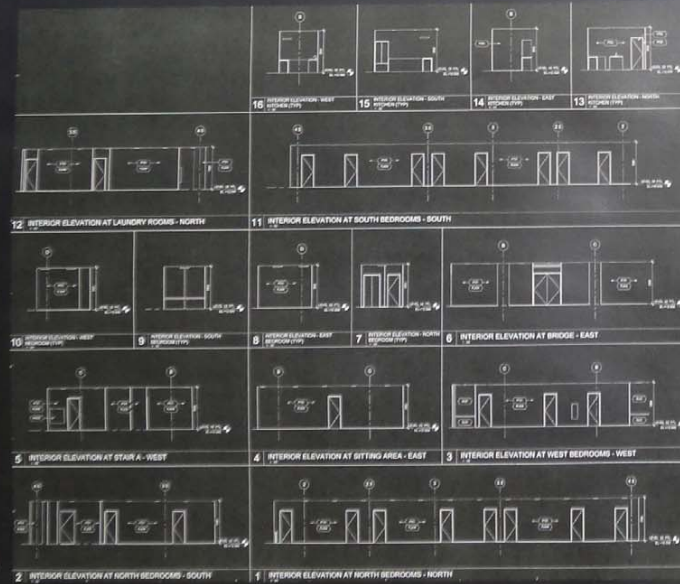

Elevation
Net to table
Refer to Panel Design Submission
dated January 11 for additional
information.

162

H 5451 B

Installation in a base unit

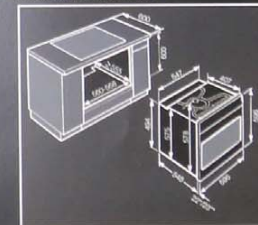

Installation in a tall unit

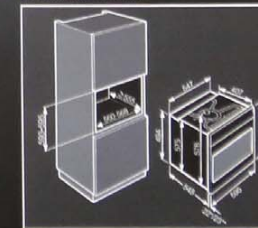

- * Appliances with glass front
- ** Appliances with metal front

MIELE OVEN
Net to table

163

