

The Zig Zag chair was designed by Gerrit Thomas in 1932. The chair was designed to look like a zig zag hence its name. It is made with for flat wooden tiles, two wedges and screws and nuts. Two of the wooden flat faces is carved at their ends like teeth so they could fit into the other. Then the end of one side is cut at an angle and the drilled with holes, which will be used for the screws and nuts. The other two wooden flat faces are then also drilled with holes and placed next to each other. Finally, using a wedge to keep the angles together and tight thw wedge also has holes for the screws in order to keep the chair together and steady.

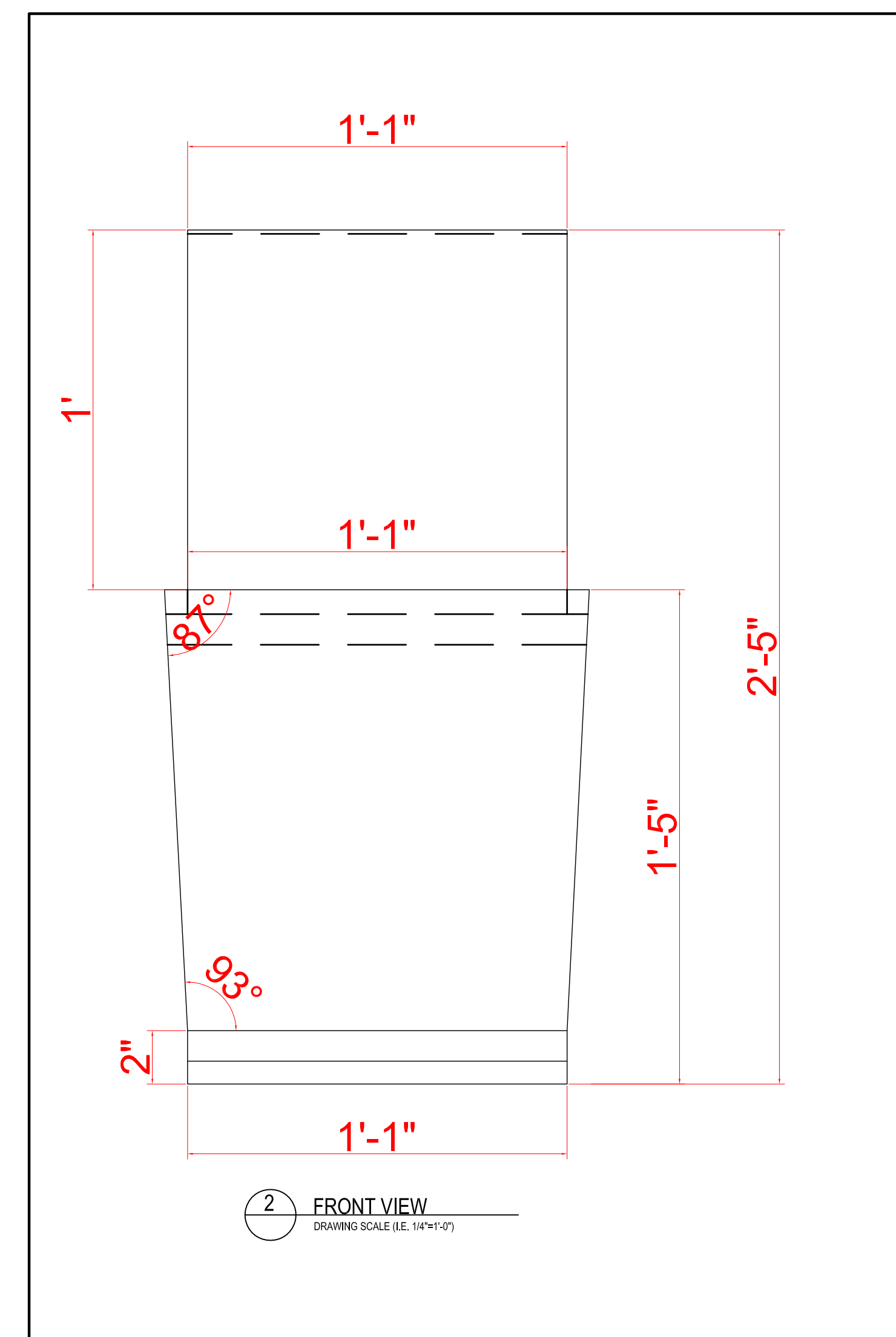
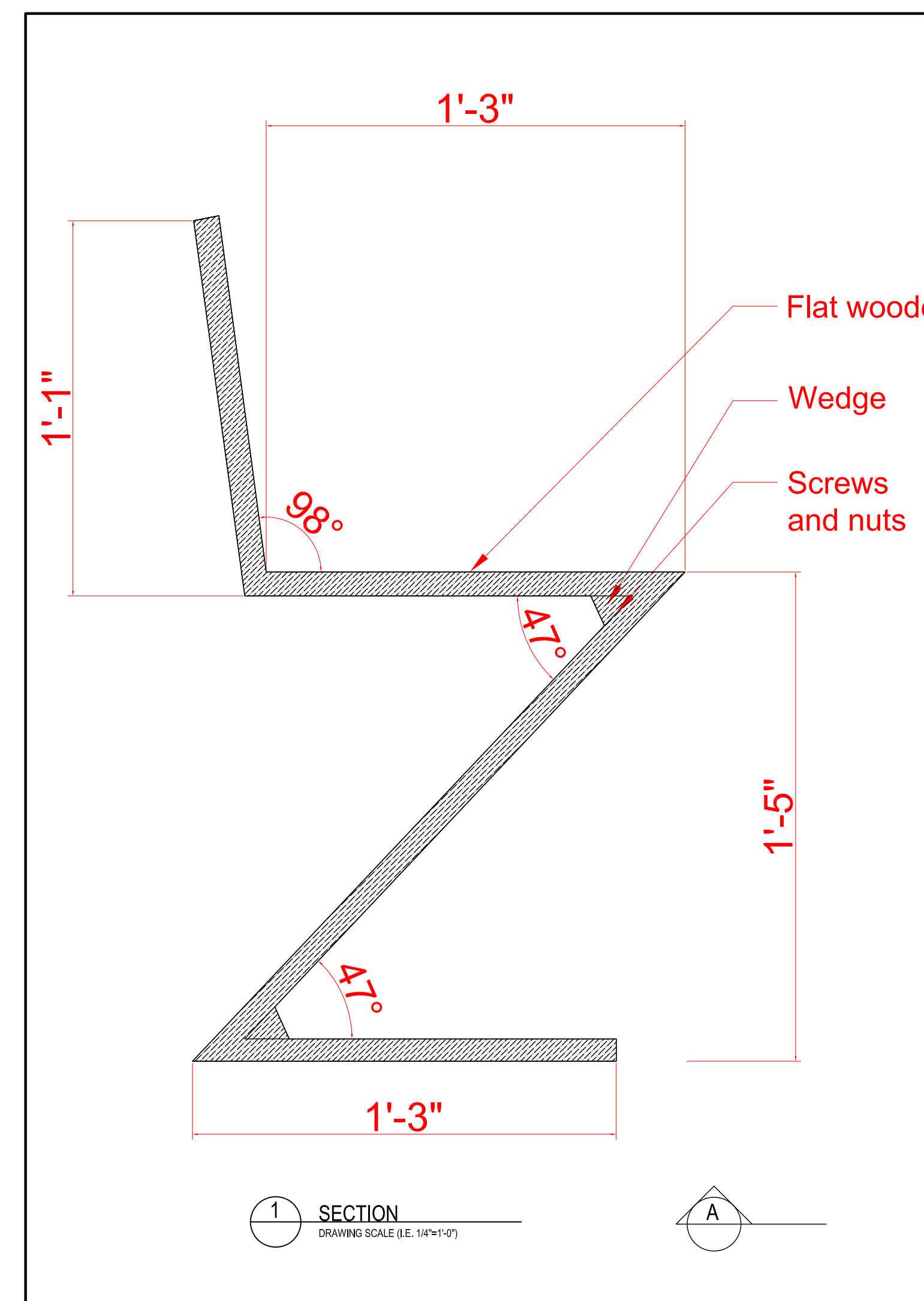

PROJECT:	
ARCH 1230	
CITYTECH / INSTRUCTOR T.WU / 2015 FALL	
DWG TITLE:	
ASSIGNMENT A	
ZIG ZAG CHAIR	
SEAL & SIGNATURE	DATE: 2015 09 09
	PROJECT NO. 1230_A
	DRAWING BY: REYAS KARIM
	CHK BY: T W
	DWG NO: A-100.00
CADD FILE NO: arch1230_wu_2015_fall_list name_first_name_assign A_01	PAGE: 1 of 1