

3 Top View of Flat D,E,F

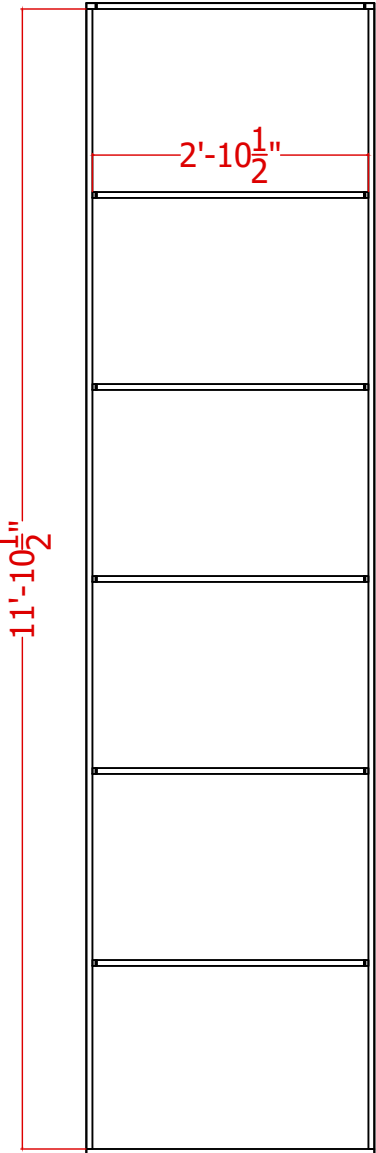

2 Back View of Flat D,E,F

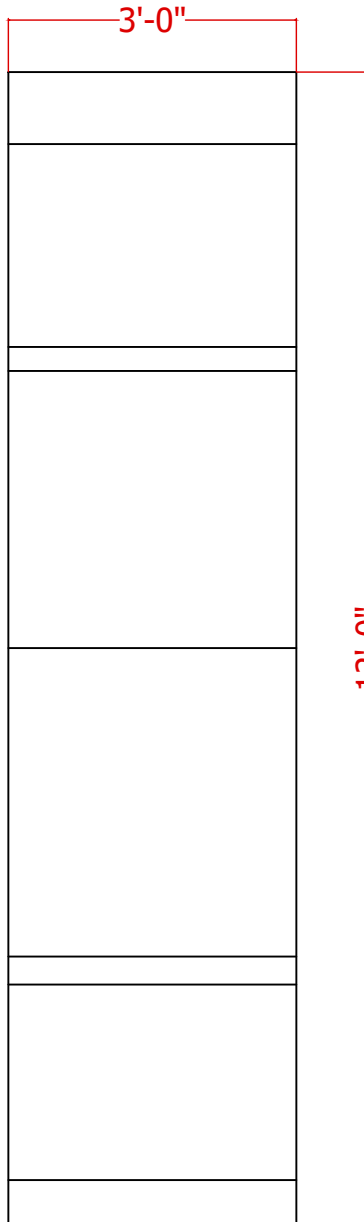

Front View for Flat D,E,F

Notes:

- 1 $\frac{3}{4}$ " Ply Wood for Framing Members
- Apply Lauan Facecover for framing lid.
- For insertion of pickpoints, use a $\frac{3}{16}$ " drillbit.
- Use foam core board for crown moulding.

NYC COLLEGE OF TECHNOLOGY	
ENT 4410 - Technical Direction	
Problem 3 Flat D,E,F	PLATE NO.
DRAWING PRACTICE WORKSHEET	
SCALE:	1/2" = 1'-0"
DATE:	April 13th, 2023
DRAFTER:	Tristen Weber
	4
	OF: 4