

3 Top View of Flat C

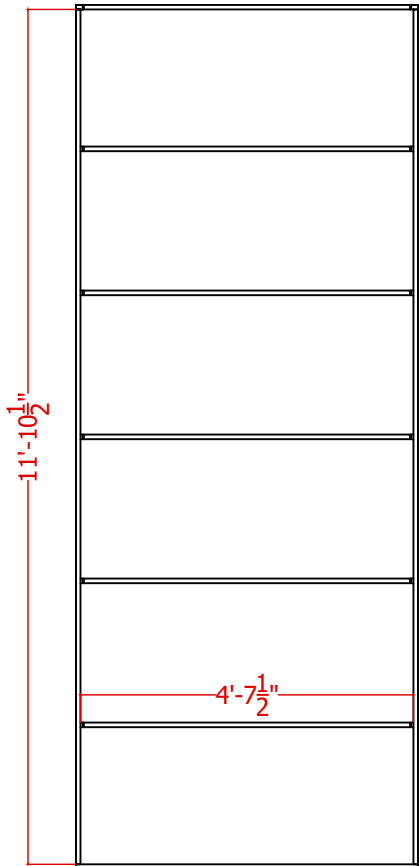

2 Back View of Flat C

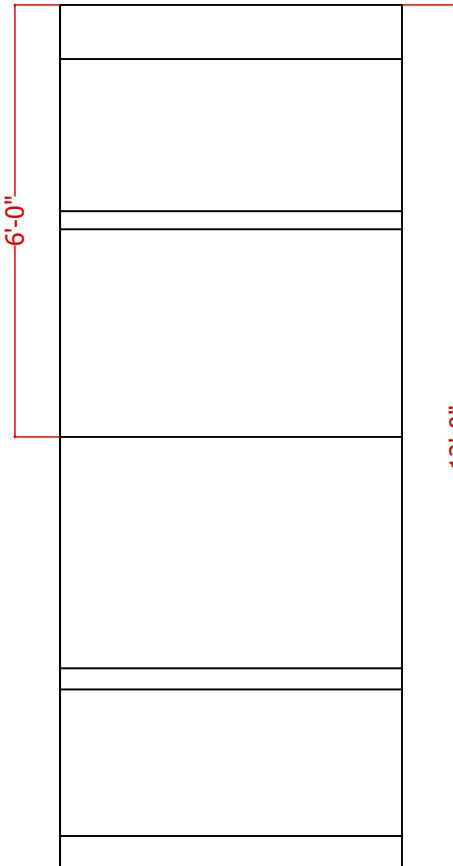

1

Front View for Flat C

Notes:

3/4" Ply Wood for Framing Members

Apply Lauan Facecover for framing lid.

For insertion of pickpoints, use a 3/16" drillbit.

Use foam core board for crown moulding.

NYC COLLEGE OF TECHNOLOGY	
ENT 4410 - Technical Direction	
Problem 3 Flat C	PLATE NO.
DRAWING PRACTICE WORKSHEET	
SCALE:	3/8" = 1'-0"
DATE:	April 13th, 2023
DRAFTER:	Tristen Weber
	3
	OF: 4