

SITE

Three major site are Sun, wind, and rain.

Cool Region

- minimum surface area of solar radiation
- Reduce radiant and heat loss
- It gives protection

Temperate Region

- Minimize the east and west exposure
- protect against the wind in cold weather

Hot Arid Region

- promote by evaporation using water features
- solar shading for window and out door.

Hot Humid Region

- Reduce solar heat
- provide solar shading in out door.

Passive solar heating by using solar energy to heat by interior space.

- Direct Gain \Rightarrow heat collect directly.
- Indirect Gain \Rightarrow heat gain exterior skin.
- Sunspace = It's medium heat. and separated.
- Roof Pond \Rightarrow mass absorbs and storing
- Isolated Gain \Rightarrow pulled from thermal storage.

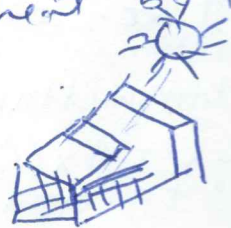

Shading is important part, over hang. The most shading that help is naturally there is Trees.

Daylight savings

- don't have use 24 hour electricity

Precipitation

- own secondary if over flooding
- naturally comes from the slope.
- Steave slope is easier to get snow.
- problem can be erosion
- surface can be changed to help the water pour off.