

SHAFT WALL WITH STEEL STUD
FIRE RATING. GYPSUM BOARD APPLIED
VERTICALLY ATTACHED TO STUDS
WITH 1" LONG TYPE S-1/2 SCREWS
SPACED 8" OC ALONG THE EDGES
AND 12" IN OC OF THE BOARD.

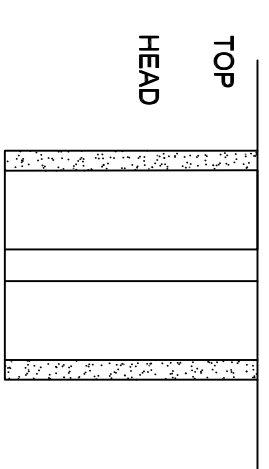

CHASE WALL WITH STEEL STUD
(NON-LOADBEARING) AND ONE HOUR
FIRE RATING.

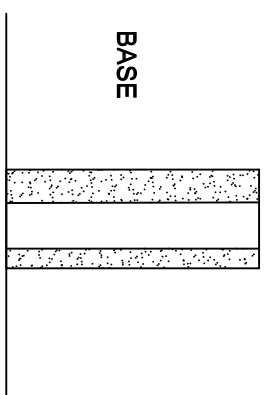
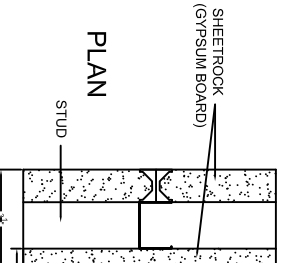
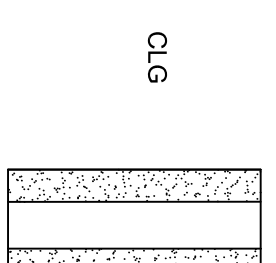
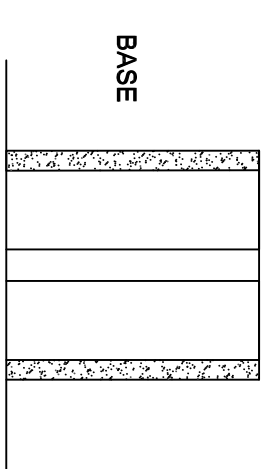
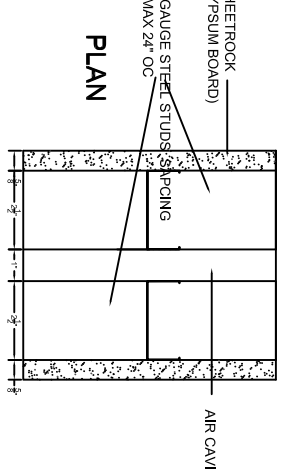
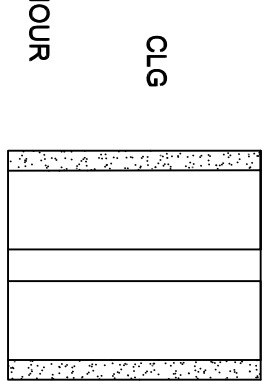

FURRED MASONRY - CMU WALL:
Concrete Block - Min. 7-5/8 in. depth concrete blocks with UL Classification
mark D-2 (2 hour fire rating), Gypsum Board - 1/2 in. thick, 4 ft. wide board
attached one side to resilient or furring channels; Furring Channels - 7/8 in.
deep min. 29 gauge galv. steel furring channel, 1-3/8 in. wide on top and
1-3/8 in. wide on bottom @ approximately 3 in. above floor and 3 in. below
ceiling. Clearance between vertical and horizontal channels 1/2 in.

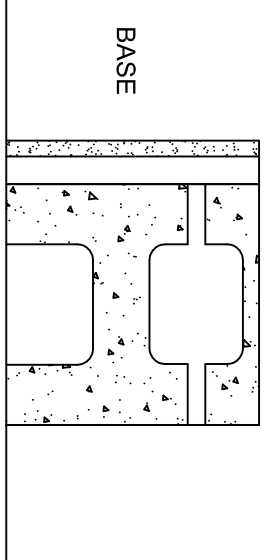
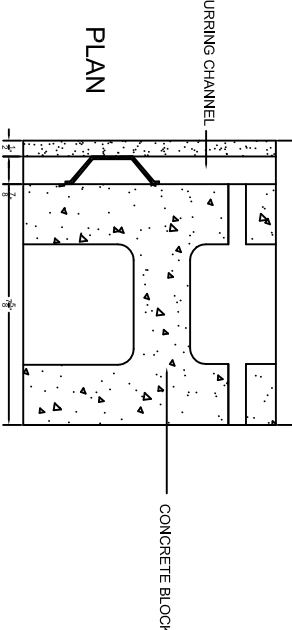
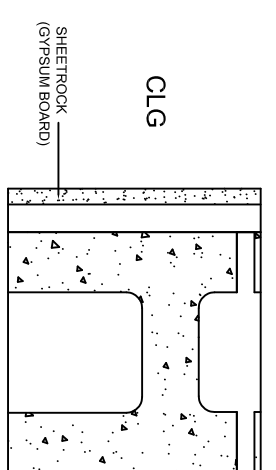
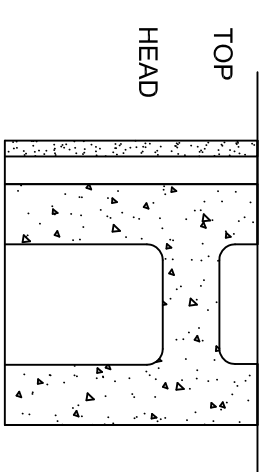

CONCRETE BLOCK WALL:
Concrete Block - Min. 7-5/8 in. depth concrete blocks (1 hour fire rating).

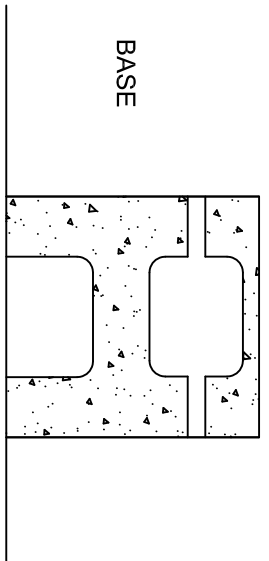
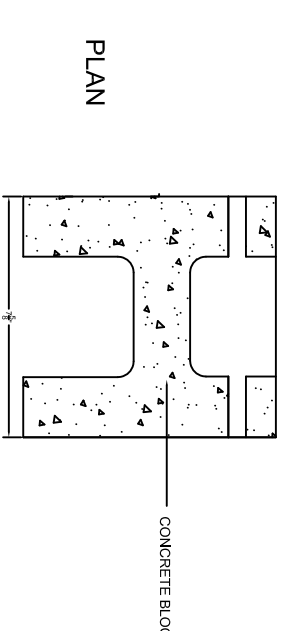
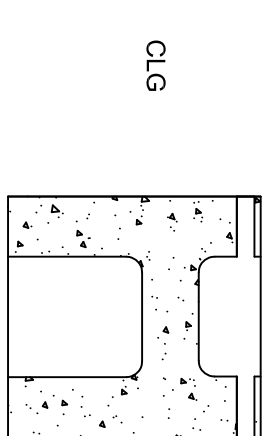
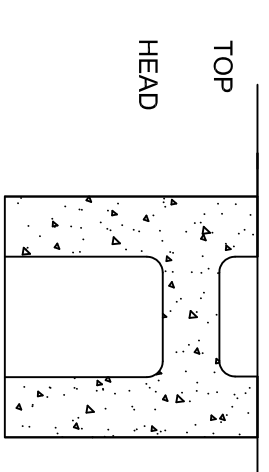

1 4 WALL TYPES
A-100.00

PROJECT:
ARCH 1230
CITYTECH / PROFESSOR KING / 2014 SPRING

DWG TITLE:
ASSIGNMENT 4
4 WALL TYPES: 1 OF 2

DATE: 2014 02/18
PROJECT NO: 1230_A
DRAWING BY: SILVANA MASTROIOLA
CHK BY: PK

DWG NO: **A-100.00**
CAD FILE NO:
PAGE: 1 of 1