

# SEATTLE PUBLIC LIBRARY/ SEATTLE, WASHINGTON / OMA



The Library is located on Fourth Avenue in downtown Seattle, Washington, United States.

The Seattle Public Library was opened in May 2004. The design of the architect's career clinched Rem Koolhaas because it is an impressive building that combines futuristic lines with the functionality of a library. Library has 11 levels, land area is 33.723 m2.

Exterior facade of the building is made of large glass and, straight lines that intersect. It is articulated by large blocks at different levels corresponding to the library premises. It is a building that is in harmony with the skyline of Seattle and the townscape of the city.

The main feature of the interior is its large public spaces and leisure reading, illuminated with natural light coming through the glass walls. Also consisting of a ramp that goes over 4 floors. All Areas bind with brightly colored escalators (except collections), and the furniture and objects are modern and colorful design.

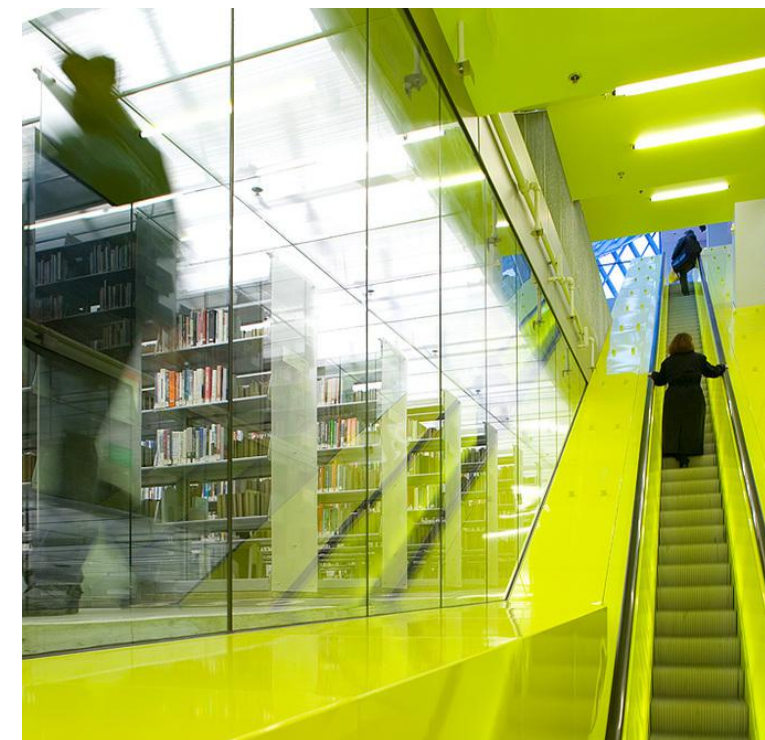
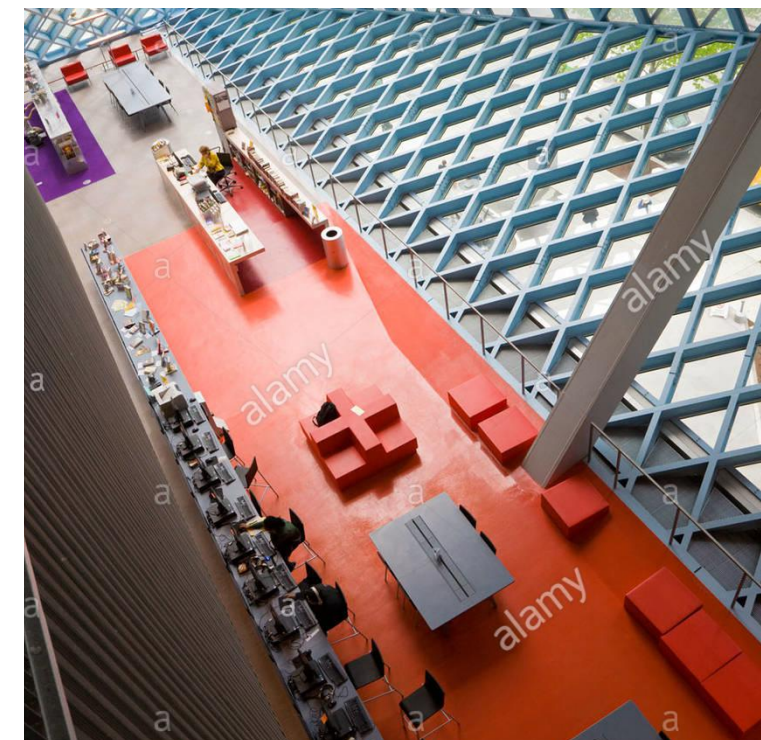

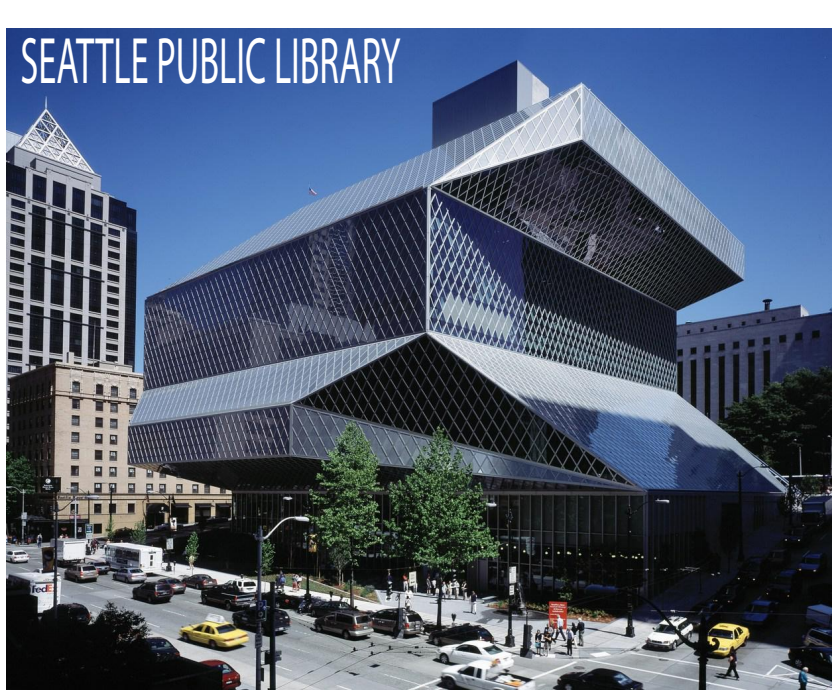

## PARTI

The concept of the library is to create social interaction for users and providing interior open space using zig zag ramps

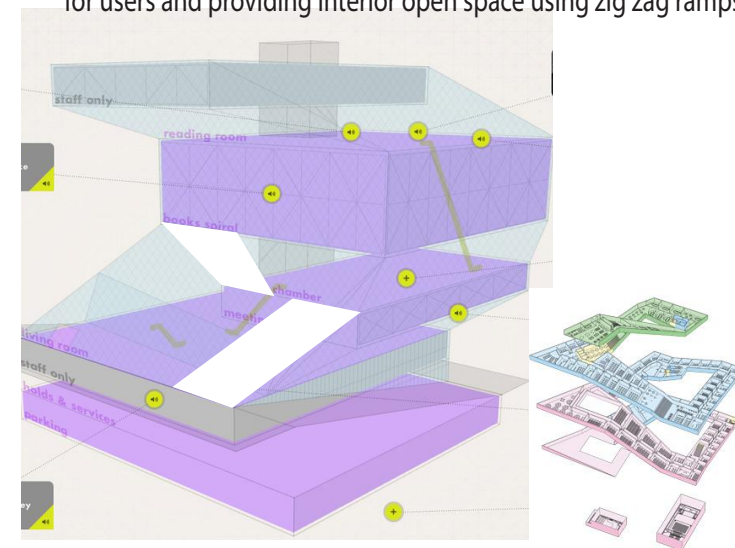

## MASSING

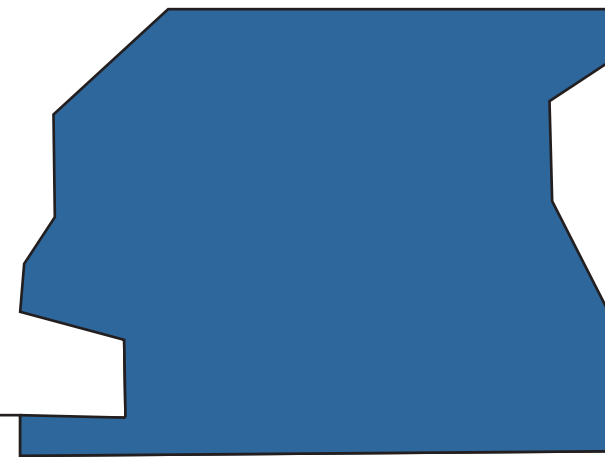

## SYMMETRY

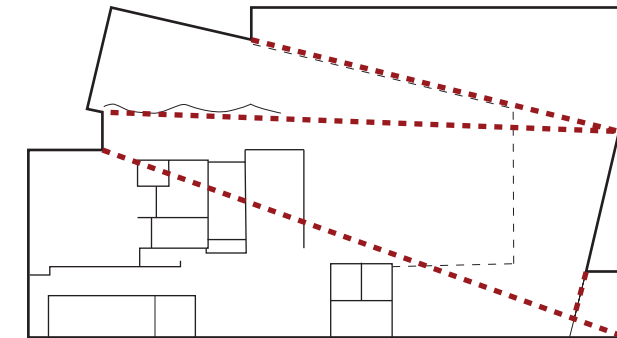

## HIERARCHY

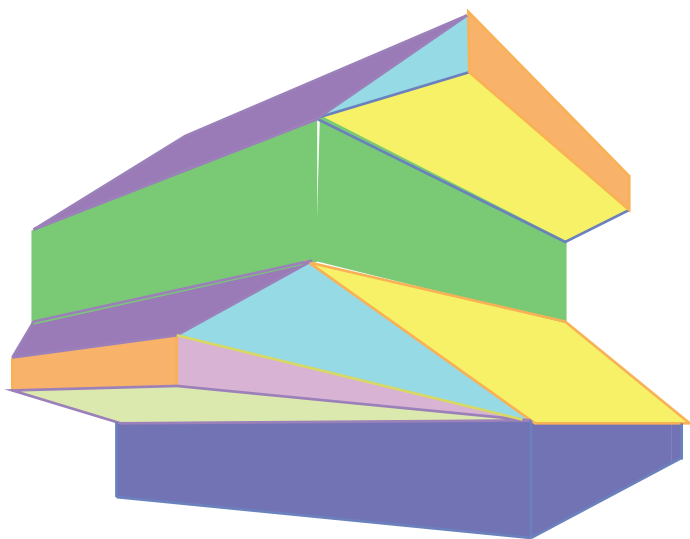

## GEOMETRY

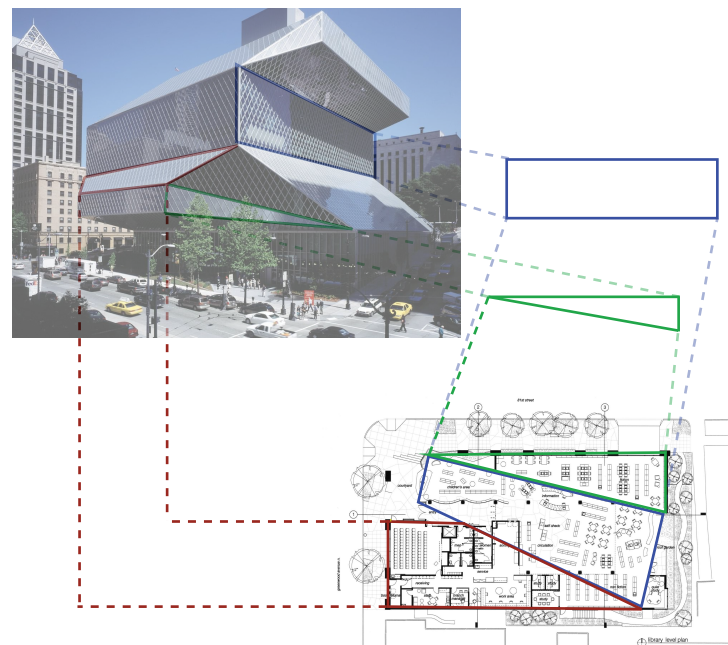

## NATURAL LIGHT

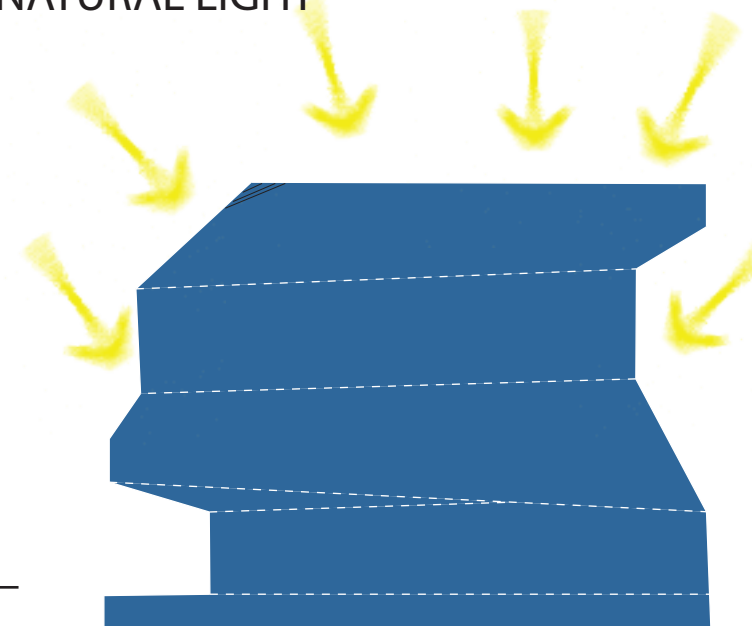

## STRUCTURE

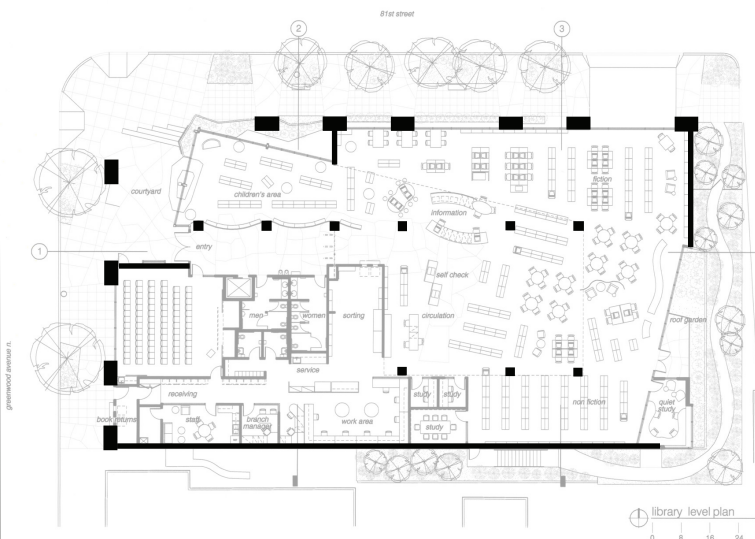

## APPROACH CIRCULATION



## PUBLIC vs PRIVATE

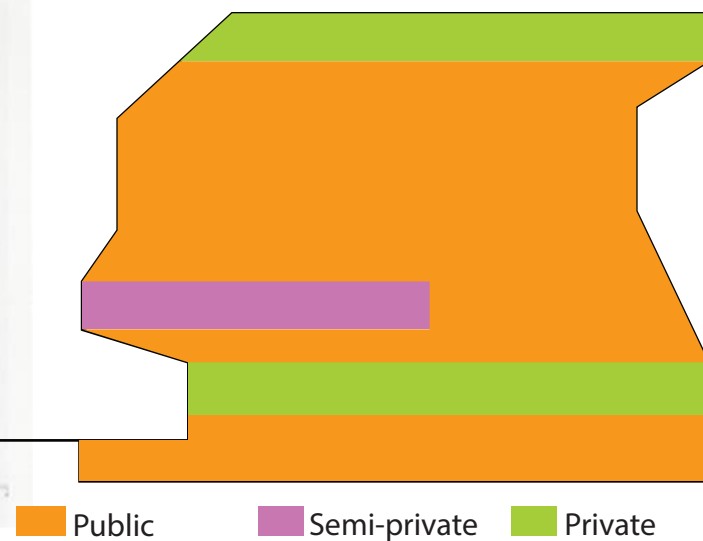

## SPACE ORGANIZATION

