



Kicking It With KISI

Intern Meets Innovation

KISI is a mobile security system.

The company's industry overall is technology but to be more specific they fall into many subcategories such as the Internet of things.



The KISI app

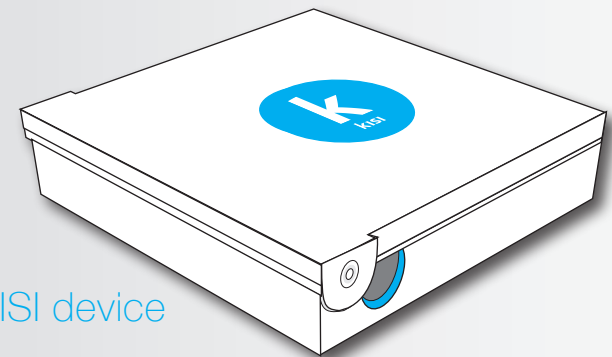

The KISI device

Simplicity Is Key

One of the most important lessons I have learned throughout this experience is "Simplicity is Key."
- Bernhard Mehl

This one simple tool changed the way I approach most of my graphics. A simple life lesson when applied to design will allow you to see form a different and clearer perspective.

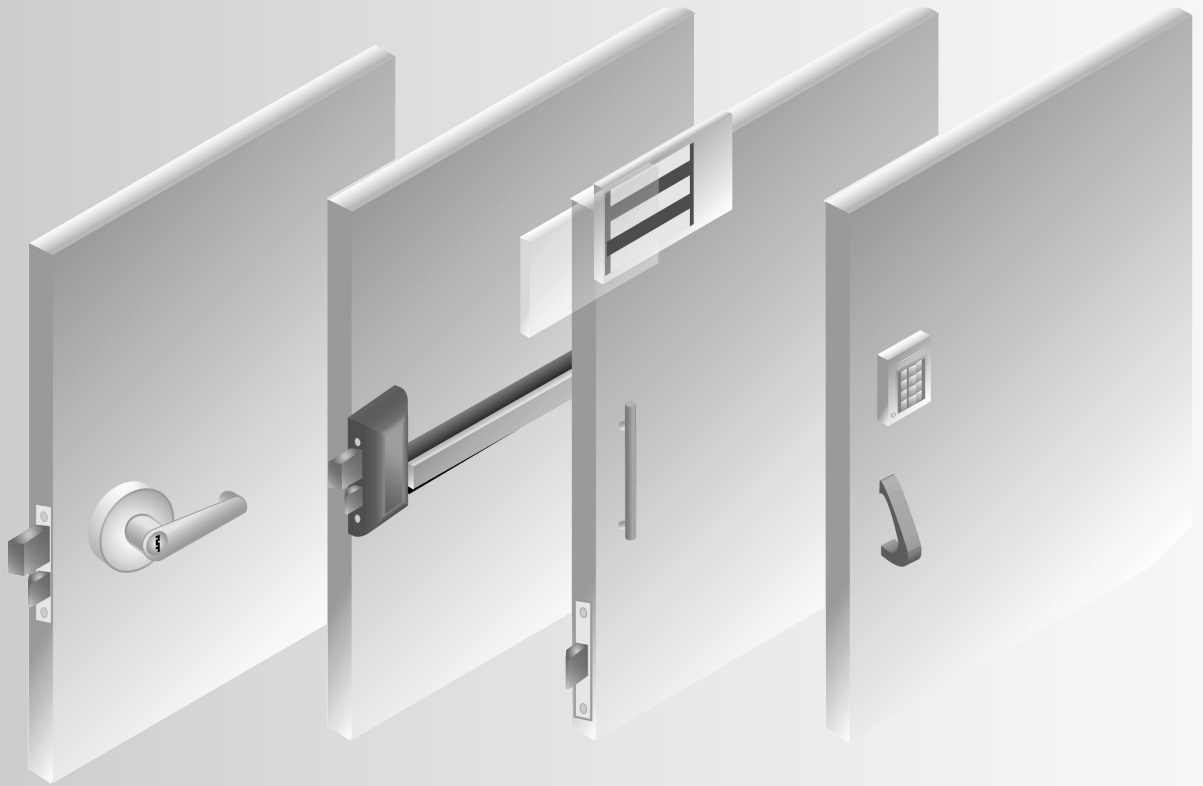

Three Audiences

KISI's visual aids target
3 main Audiences.

The Admin,
The Installer,
and The User/s



The Installer



The Admin



The Users

Mastering The Manual

When I first began at KISI, my main project was to design a detailed Instruction Manual.

As KISI continues to grow and enhance their products, the manuals change as well.

The icons serve as visual aids to the instructions. In addition, each instruction is accompanied by a useful tip to aid in the setup of the device.

SET UP YOUR KISI DEVICE

I Account Setup

1



Download the KISI App.

Apple devices use iTunes app store.
Android devices use Google Play app store.

2

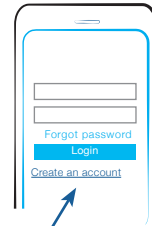

Setup a new Admin KISI account.

Some managers may use general email addresses. eg. operations@... or it@...

3



Confirm account through email.

Email may be in Spam folder. Check just in case.

4

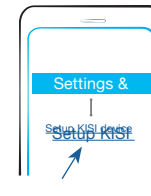

In the KISI App, under Settings & Setup, select **Setup KISI device**.

Settings & Setup is located on the bottom right of the **iPhone**, and on the top left of the **Android**.

5

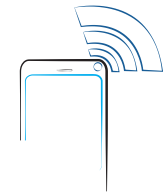

Choose wifi network.

... or enter credentials under **Other Network** (wifi has to be 2.4GHz)

6

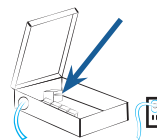

Open KISI device and connect to power source.

You should see a blinking light.

7

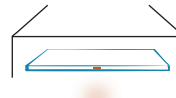

The wifi chip should be blinking.

This step may need to be repeated ... see [video](https://www.getkisi.com/installation) [getkisi.com/installation](https://www.getkisi.com/installation)

8

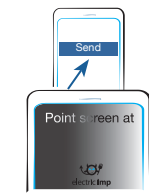

Now select **Send BlinkUp** on your smart-phone

Electric Imp will momentarily takeover your screen ... proceed with instructions

9

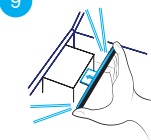

When the countdown starts, hold the phone up to the blinking chip and wait till BlinkUp is done

Phone screen and white chip should be as close as possible during active BlinkUp

10



It may take a while to update the device. Light might blink red, orange, or stay green for a while.

Problem? See light code diagnosis



Installation Spec Sheet

In order to properly install the KISI device, installers need a product spec sheet.

This design required me to depend heavily on the perspective grid tool, which I had never used before. The details and information needed to be done this way to ensure that the specifications could easily be understood.

kisi

Model: k-4000

Contact
sales@getkisi.com
www.getkisi.com
347 - 709 - 4429

KISI Device / Hardware

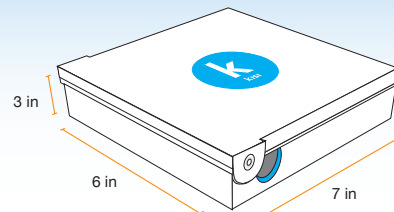

- Universal mounting pattern
- Outer mounting holes for proper gasket seal
- Enclosure is rain tight when mounted vertically
- Enclosure can be secured with a padlock

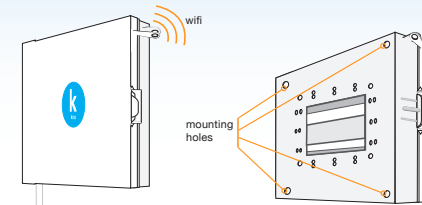

KISI Device / Electronics

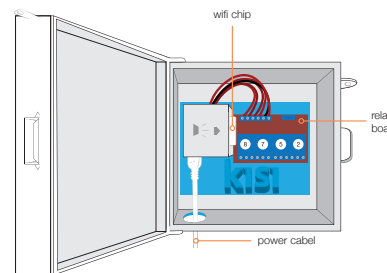

Capabilities

- Compatible with existing access control panel
- Capable of 4 access points per device using dry contact
- Wireless Wifi configuration
- 4G and Ethernet connectivity optional
- Including USB power adapter with US plug (5V, 1A)

Technology & Performance

Release Speed	21ms
Re-connect to Wifi time	3.7 sec
Unlocks / minute	120
Embedded software update	2 min
Uptime Monitoring	Real Time
Material	3D printed PLA

KISI Device / Wiring

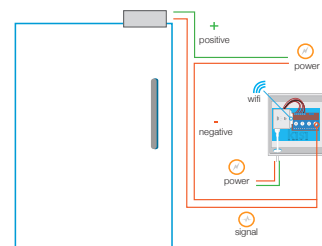

Magnetic Lock: Wire the signal normally closed.

Electric Strike: Wire the signal normally open.

1 Your existing keycard/intercom system still works!

April 2015

Engineered in the USA



Access Stickers

The promotional stickers I have designed are for pre and post entry into a KISI secured space, as well as a box sticker for technical support.

These promotional stickers serve as a visual aid for the clients and their staff to utilize the KISI App.



A Different Perspective of Design

While at KISI, I've learned how to think differently.

As designers, we sometimes get over consumed with just visual appearance than functionality.

I learned how to think as a designer, a client and a consumer.



My Future with KISI

I've never been the type on intern that admits to not knowing how to do something.

I WILL FIGURE IT OUT

Just like KISI, I am all about innovation, and plan on continuing my experience here.



O'Nysha, Bernhard, and Compton

Get KISI

To find out more about KISI,
go to getkisi.com

KISI is located at
20 JAY ST, Brooklyn, NY

or you can call KISI at
(347)-709-4429

