

GENERAL NOTES:  
 ORIGINAL STRUCTURE  
 BUILT ENTIRELY OF MASONRY. OFFICE  
 PARTITIONS, COUNTERS, WOOD FLOORS, ETC.,  
 ARE OF LATER DATE.  
 DOORS MARKED "A" - 2-2 1/2" x 8-1/2" - 1 1/4" CAST IRON.  
 "B" - 3-4" x 8-1/2" - 1 1/4" CAST IRON.  
 "C" - 2-4 1/2" x 10-1/2" - 3" CAST IRON.  
 ALL OTHER DOORS NOT ORIGINAL.  
 ALL WINDOWS - 5-8" x 10-8" CAST IRON NOT ORIGINAL.

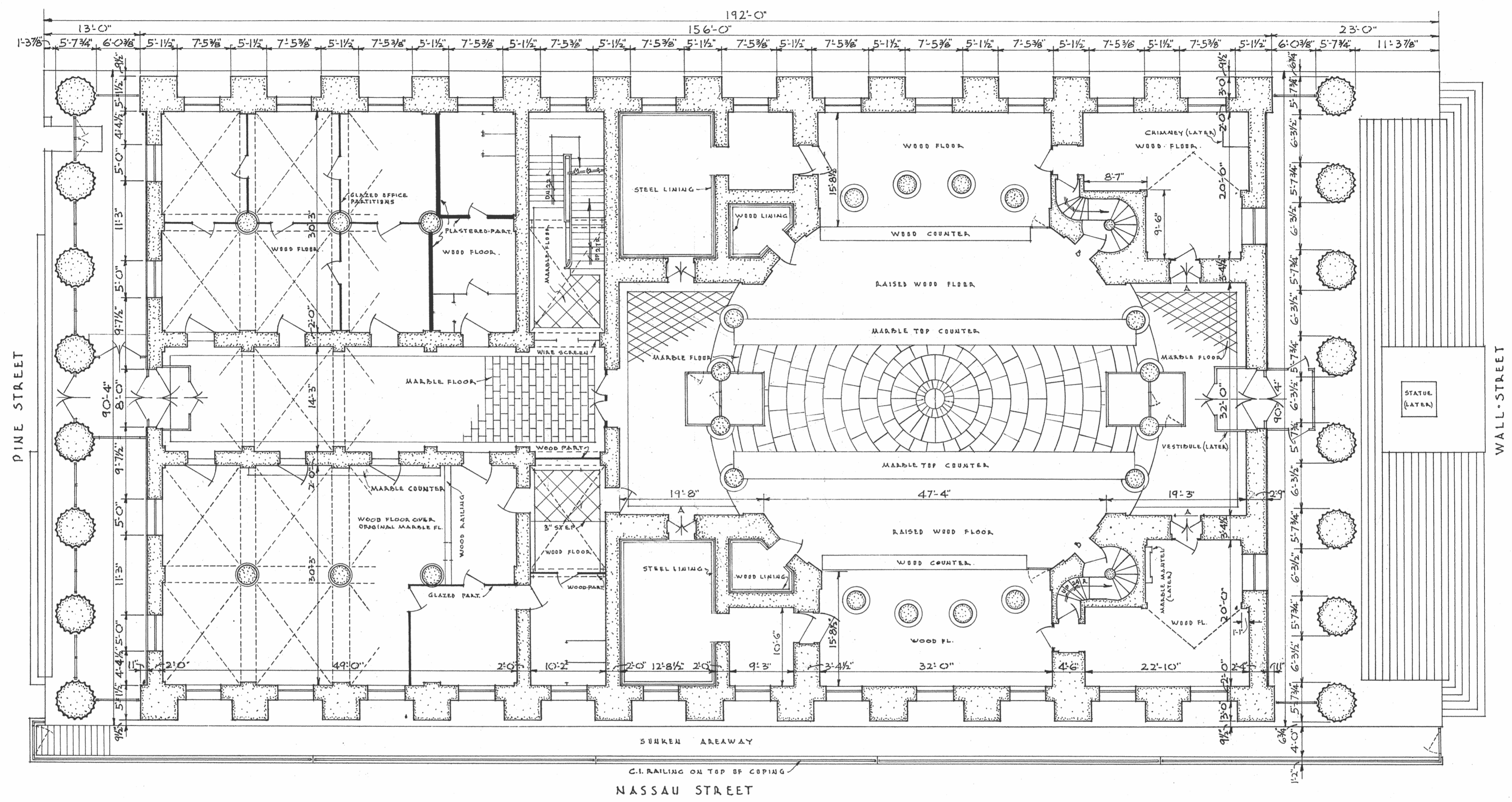

FIRST FLOOR PLAN  
 SCALE 3/32" = 1'-0"

TARQUIN M. RACHELLE, DEL.

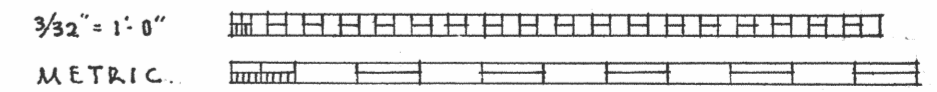

1940 PUBLIC WORKS ADMINISTRATION PROGRAM FEDERAL PROJECT 498-A UNDER DIRECTION OF UNITED STATES DEPARTMENT OF THE INTERIOR NATIONAL PARK SERVICE, BRANCH OF PLANS AND DESIGN	NAME OF STRUCTURE <b>UNITED - STATES - SUB - TREASURY</b> NEW YORK	SURVEY NO. <b>NY-470</b>	HISTORIC AMERICAN BUILDINGS SURVEY SHEET 3 OF 15 SHEETS	LIBRARY OF CONGRESS INDEX NUMBER
---	--	-----------------------------	---	-------------------------------------