

# Structural Sealant Glazing &

Ribbed Surface Bush  
Hammered Panel

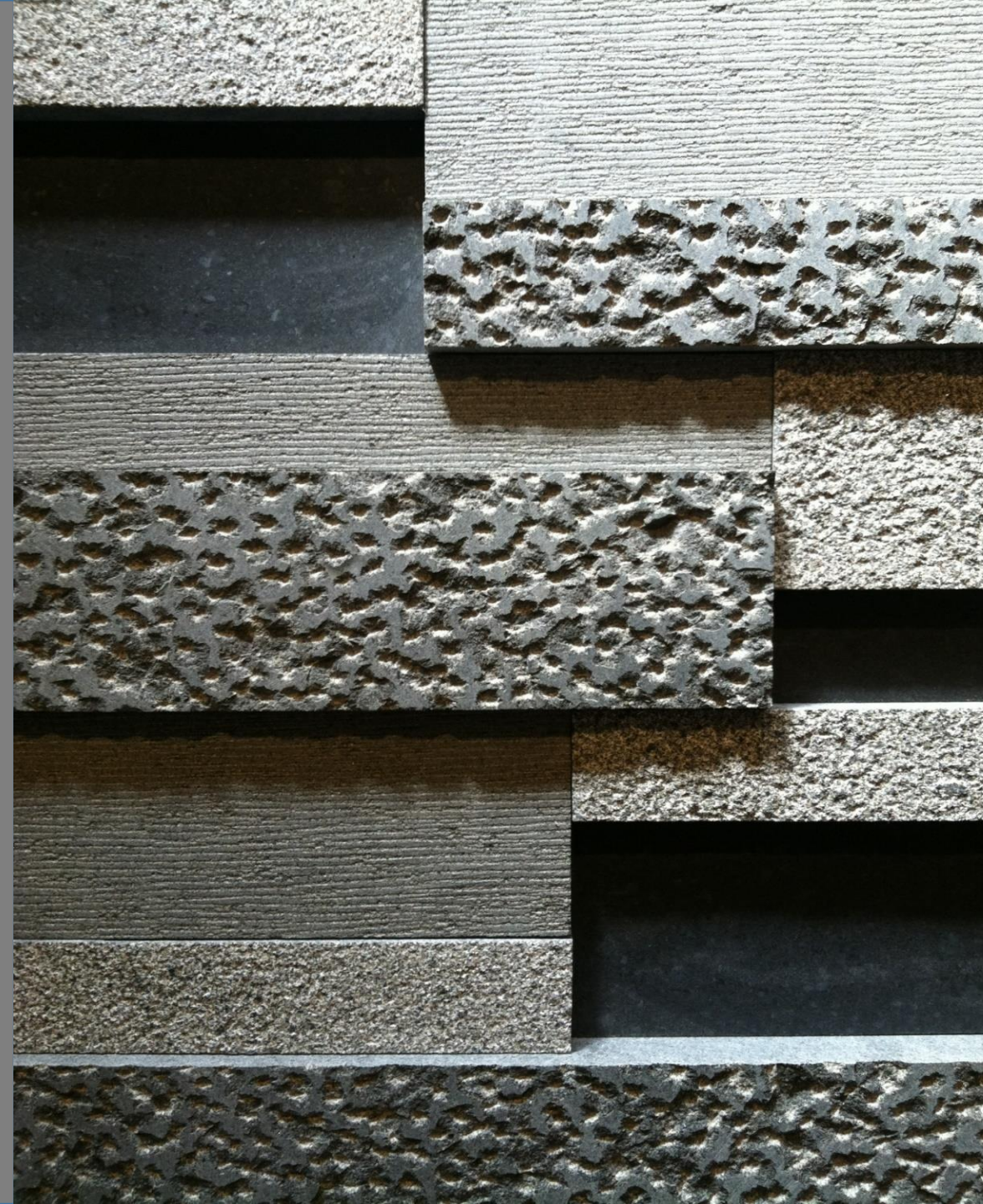



# Curtain wall: Structural sealant glazing

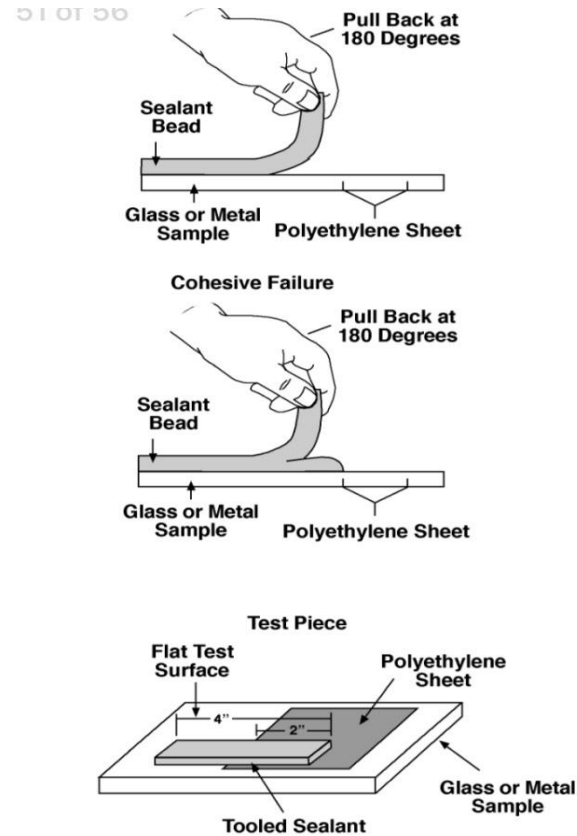
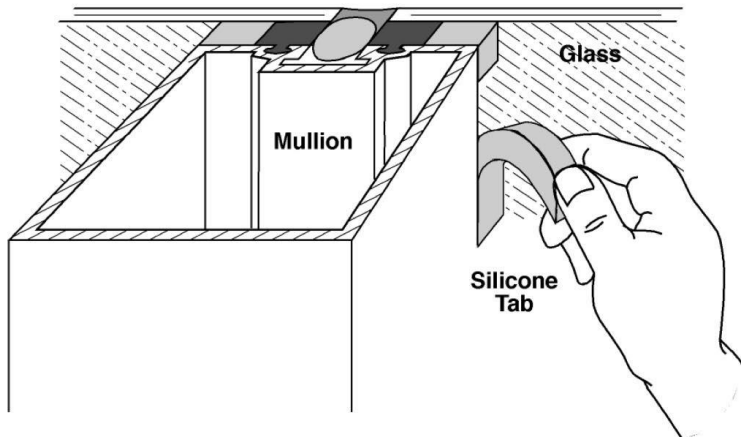

- The structural glazing consist of a silicone sealant, which is meant to support the framing members, as well as thermal break.
- It reduces material usage





Sketches:

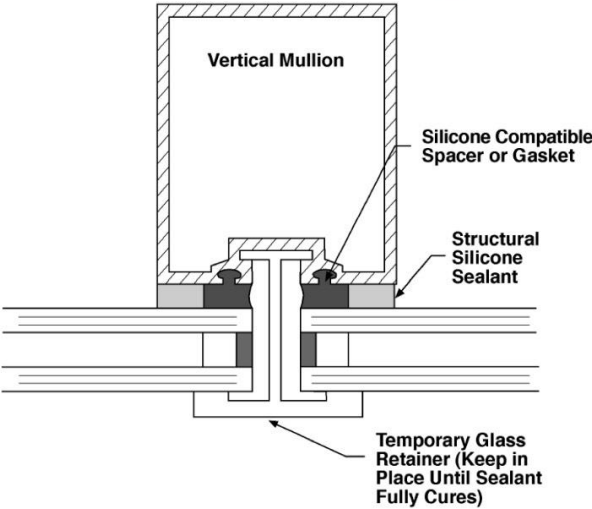
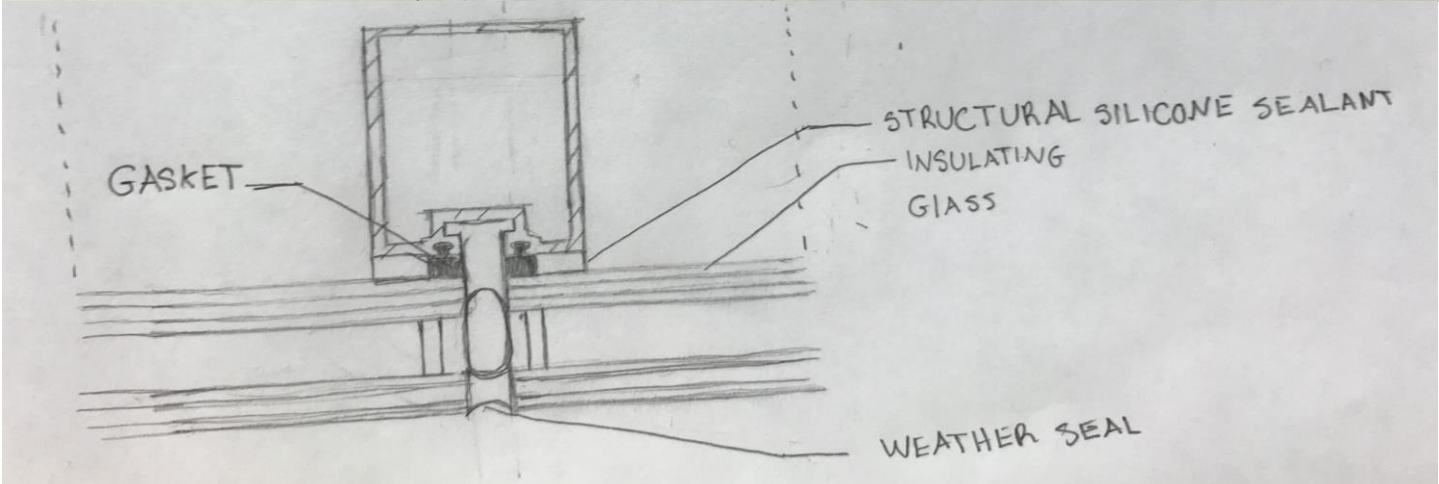
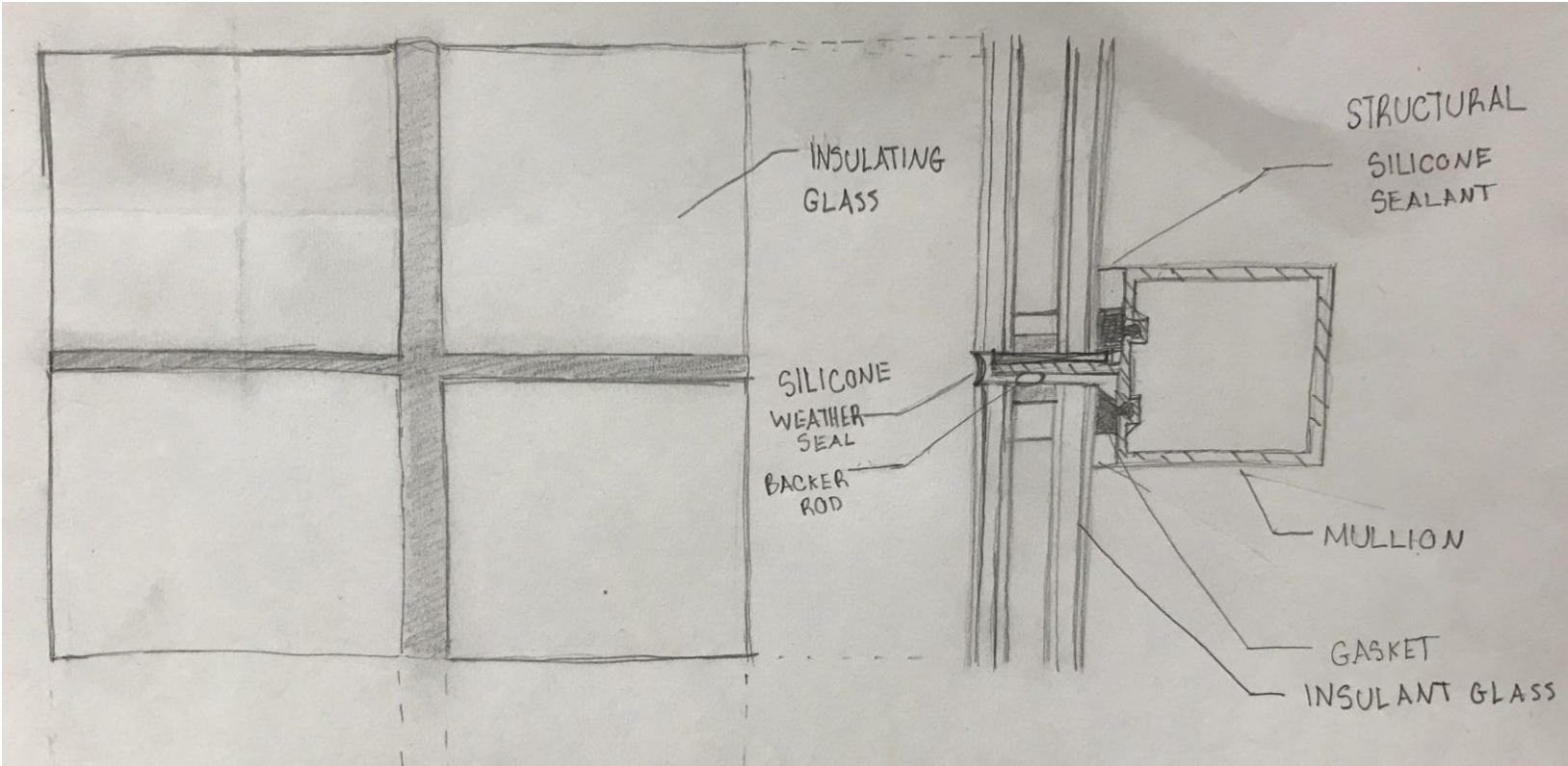



# Site Cast in Place Concrete: Ribbed Surface Bush Hammered

- These concrete Panels are done on site, which becomes less of time to wait for construction.
- These Panels are Physically created by a Bush Hammer.



Bush Hammered

Ribbed

Precast Panel



# Drawings

