

Spring 2011

Phase 3 Stage 1: DEVELOPING THE CURTAIN WALL

Overview: Creation of the Curtain wall starts with the use of the "curtain wall" wall type which defines the plane of the curtain. Next we define the grid spacing of both vertical and horizontal mullions and then we define doors and other panels.

Atrium Roof: From an Elevation View (South) create a new level for the Atrium Roof at 35'-0"

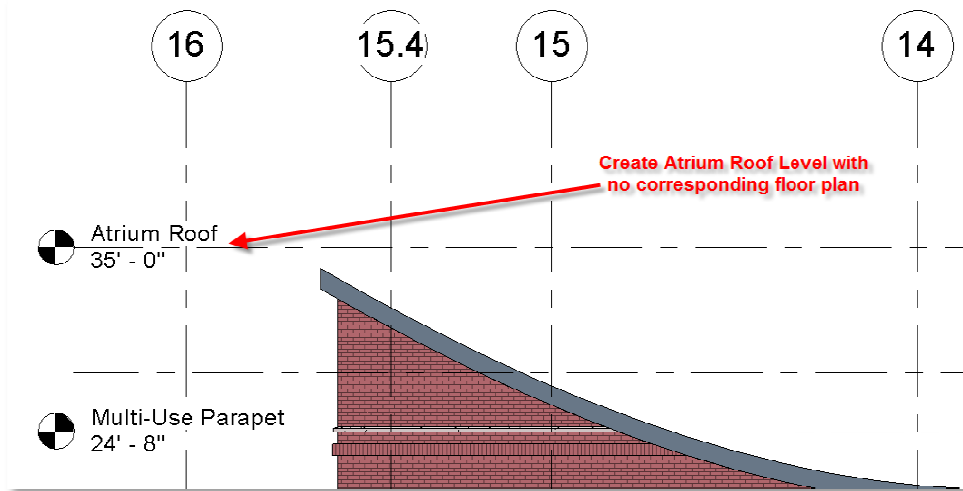

Add Curtain Wall: Home > Wall > Curtain Wall - Curtain Wall 1
Height up to Atrium Roof, Offset 1'6"

Draw using Rectangle Tool from grid intersections **F & 16** to **A & 10**

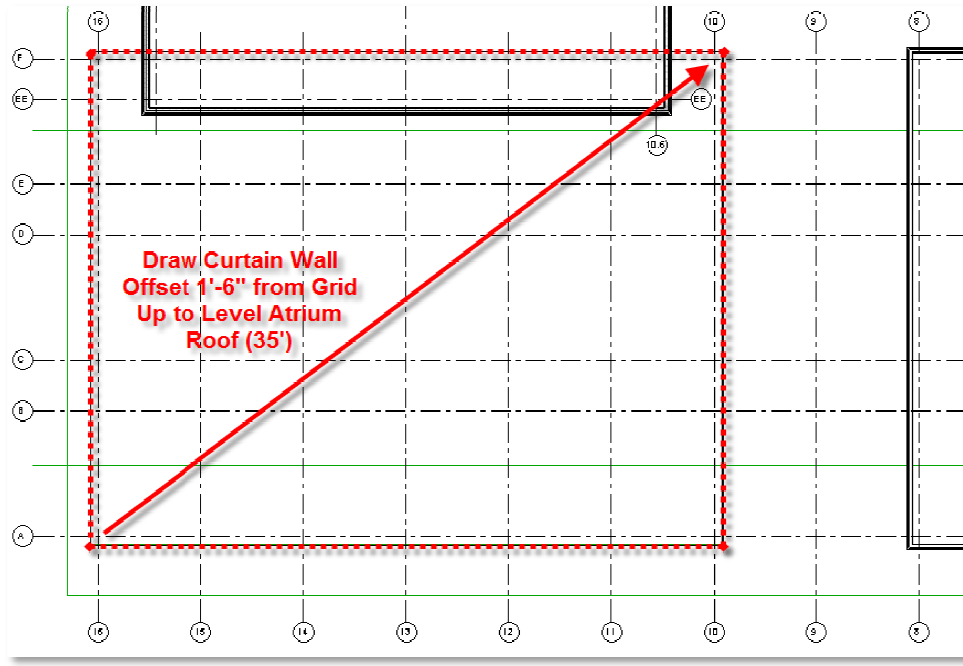

Spring 2011

Add Guidelines: Add Guidelines 13'-11" from column grids A & F for the curtain wall entry

Add Curtain Wall: Home > Wall > Curtain Wall - Curtain Wall 1
Height up to Level 3, No Offset

Draw using Rectangle Tool from grid intersections **F & 16 to A & 10**

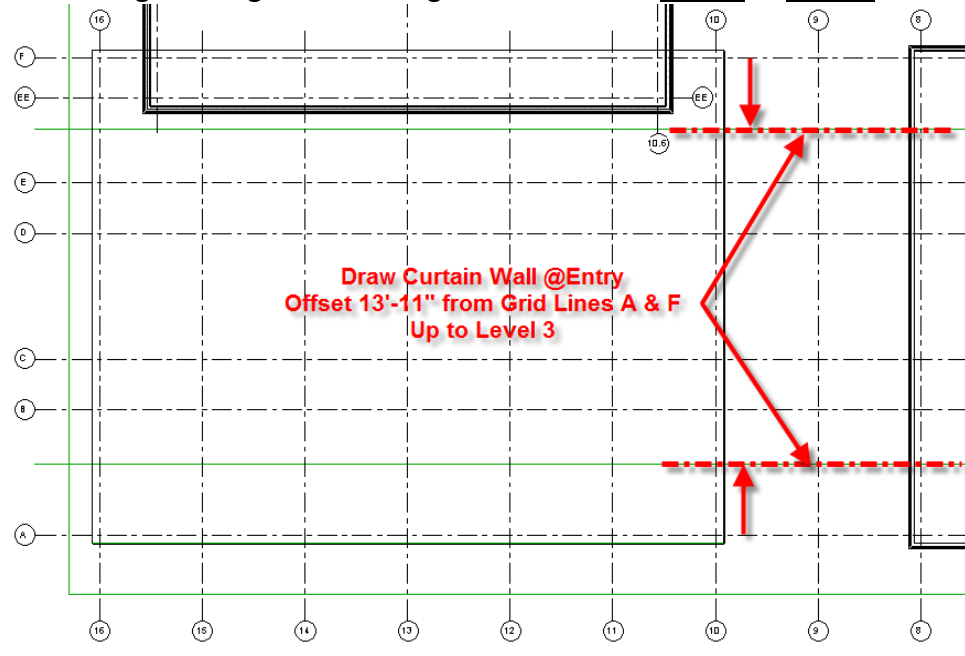

Your model should show an Atrium Curtain Wall Plane and the Entry Space

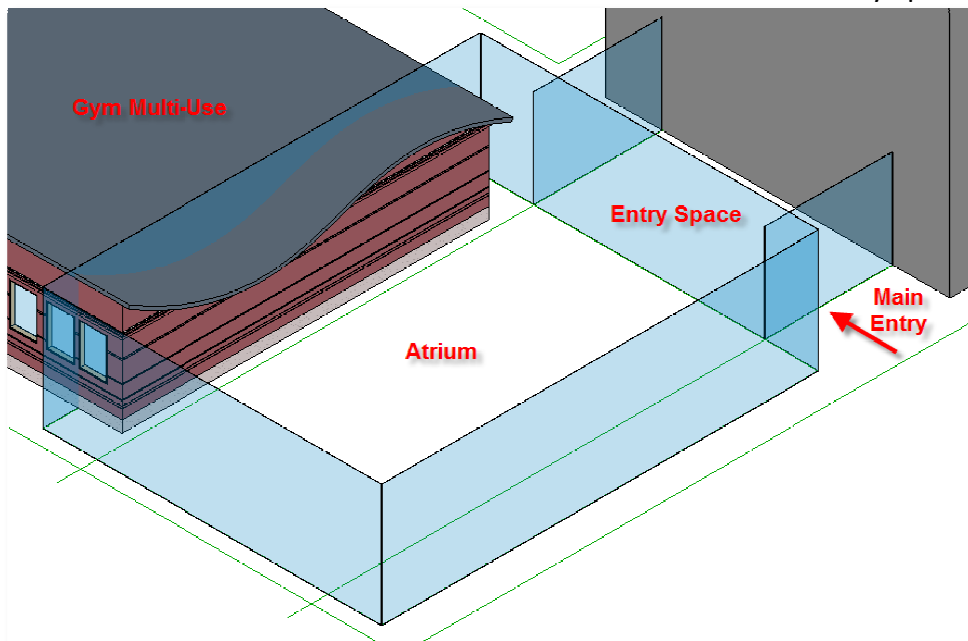

Spring 2011

Add Curtain Grid: Home > Curtain Grid

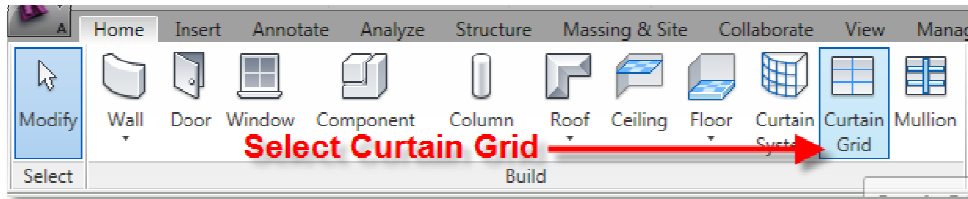

On the Main Atrium: 3 grid lines @1'-0" down from the Atrium Roof
 3 grid lines @1'-0" down from Level 3
 3 grid lines @1'-0" up from Level 2
 3 grid lines @1'-0" up from Level 1

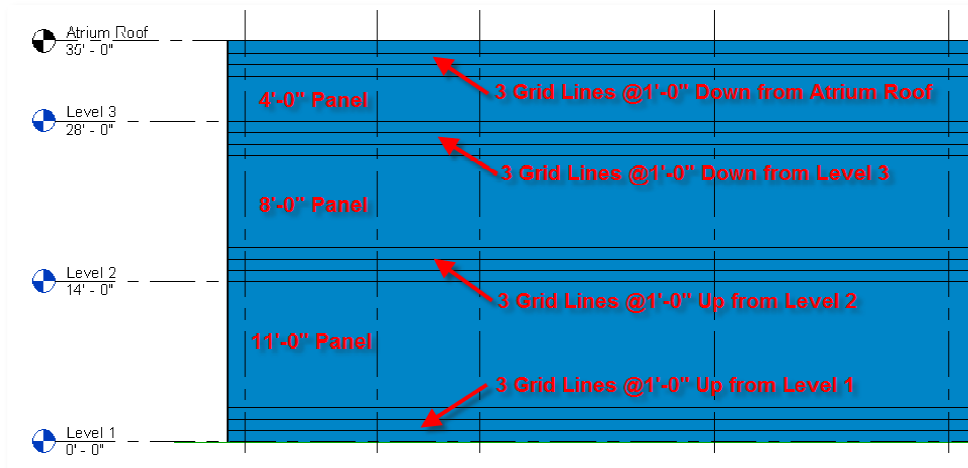

At the Atrium Entry: 3 grid lines @1'-0" down from Level 3
 3 grid lines @1'-0" up from Level 2
 3 grid lines @1'-0" up from Level 1

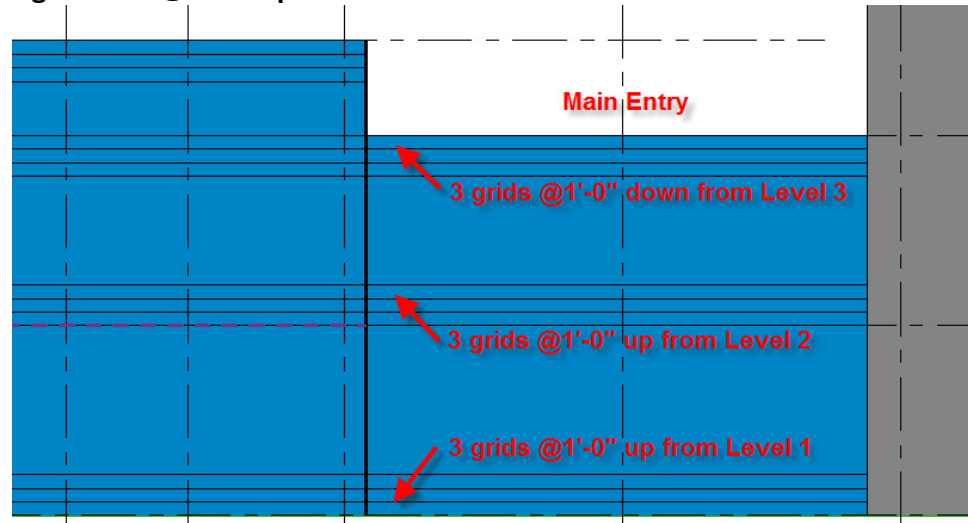

Spring 2011

Complete the grids: Complete the horizontal grid by working your way around the building from the corners snapping to the first set of grid lines.

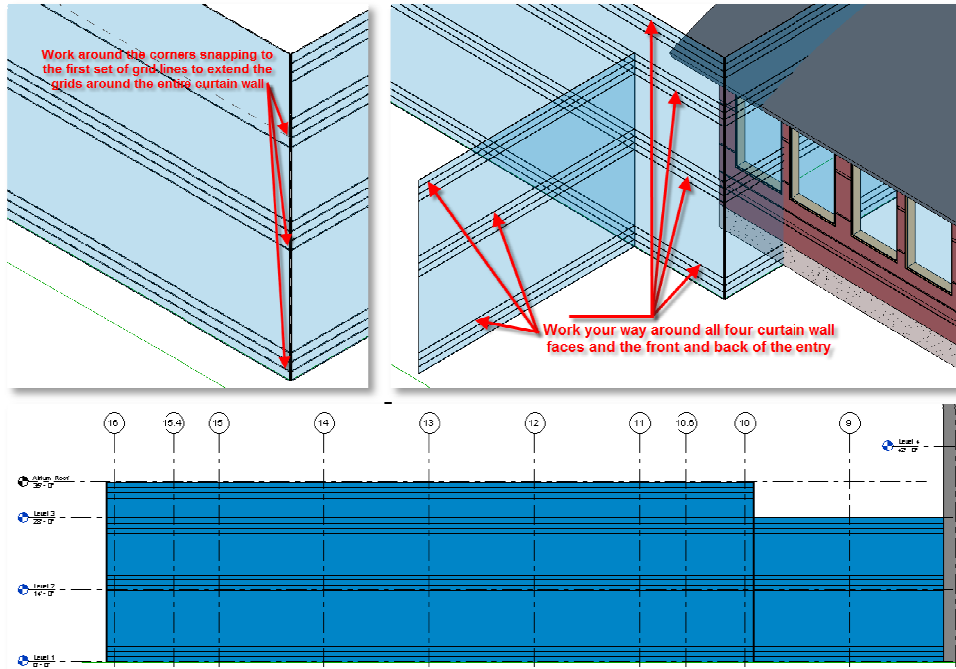

On the South Facade: Hide any vertical column grid lines that show on the curtain wall facade then Create Vertical grid lines at each column grid and then divide each column space into four (4) equal sections at 5'-1 1/2" each.

Start by creating the grid in the middle at 10'-3" from the column grids
 Next divide the 10'-3" panel in half at 5'-1 1/2"

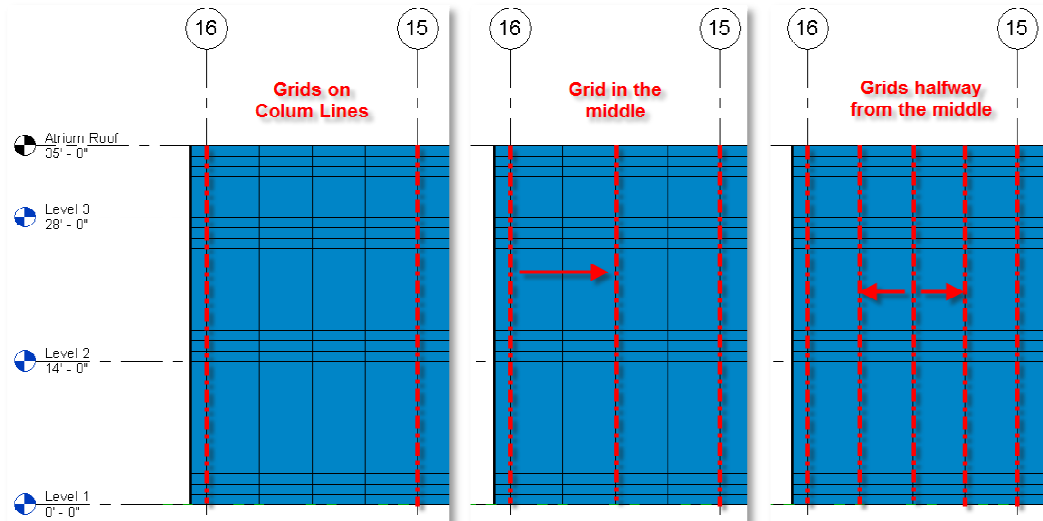

Spring 2011

Mirror the Grids: Select the Vertical Grid Lines on the Curtain Wall Facade and Mirror them across the center of the Atrium. Use Filter and check the count - it should be 25.

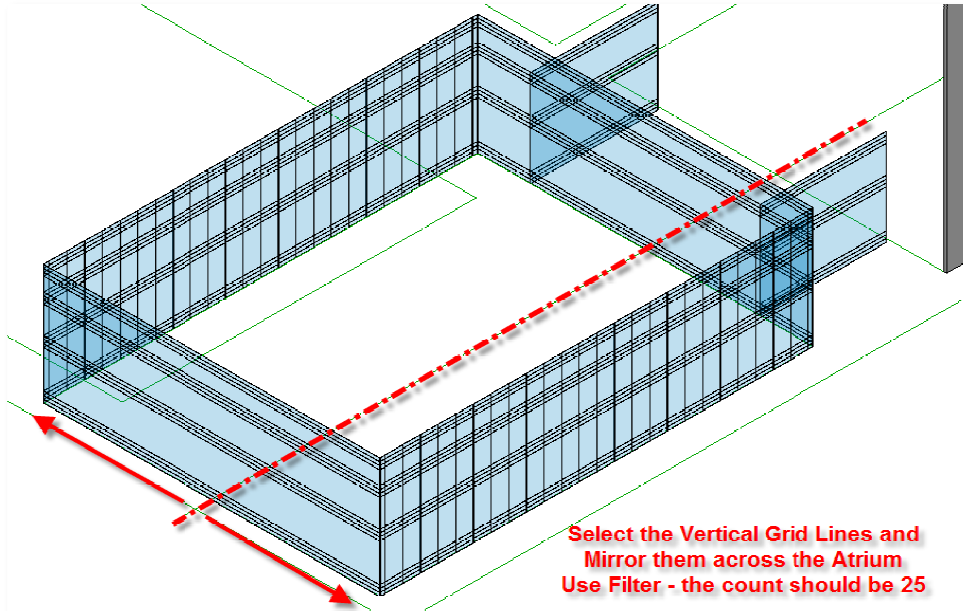

On the West Facade: Start by creating Vertical Grid Lines on each of the column grids

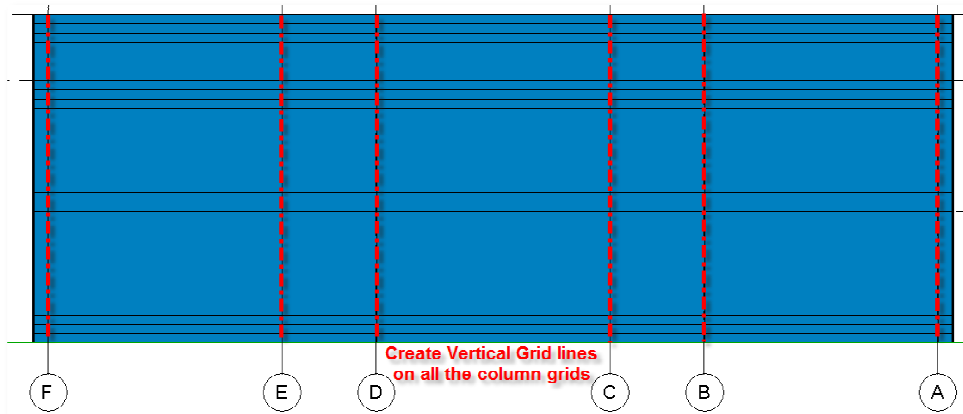

Next divide the 24'-10" panels in half to create two 12'-5" panels

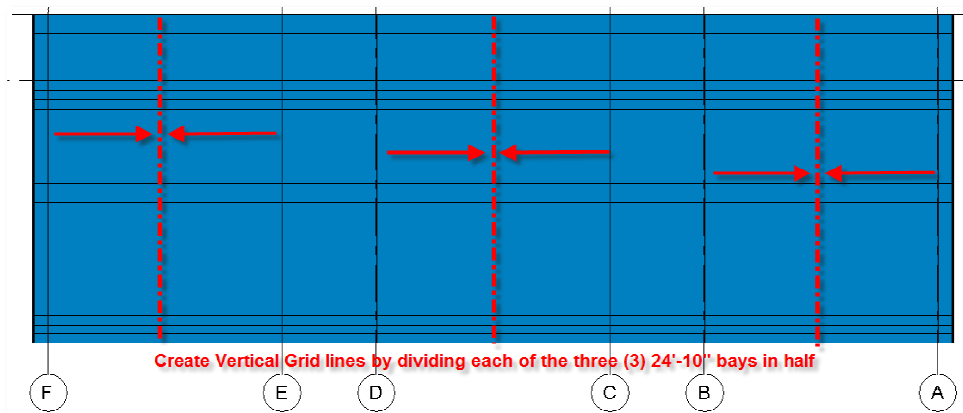

Spring 2011

Next divide the 24'-10" panels in half to create two 12'-5" panels

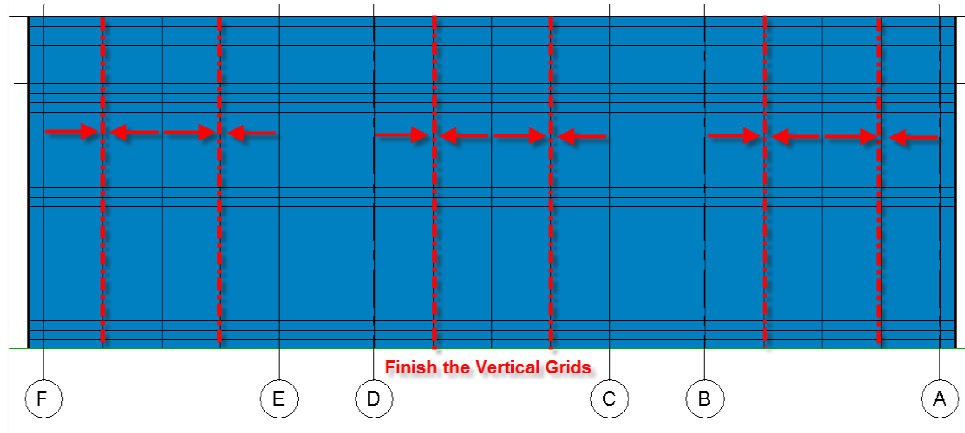

Mirror the Grid Lines: Mirror the Grid Lines across the centerline of the Atrium Space- Count of 15

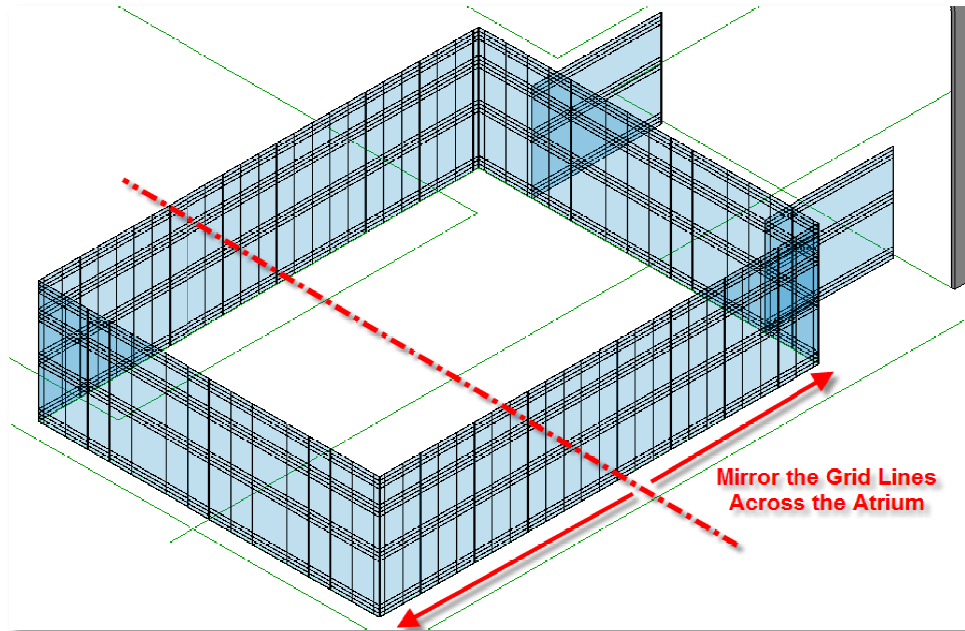

Main Entry: Next we will work on the vertical mullions of the entry

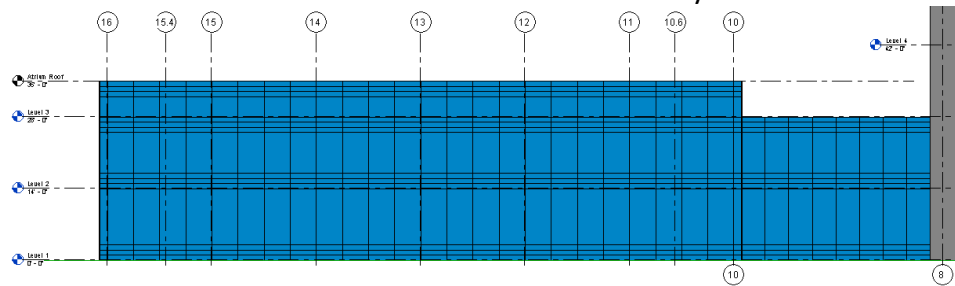

Spring 2011

Main Entry: First Divide the Main Entry in half

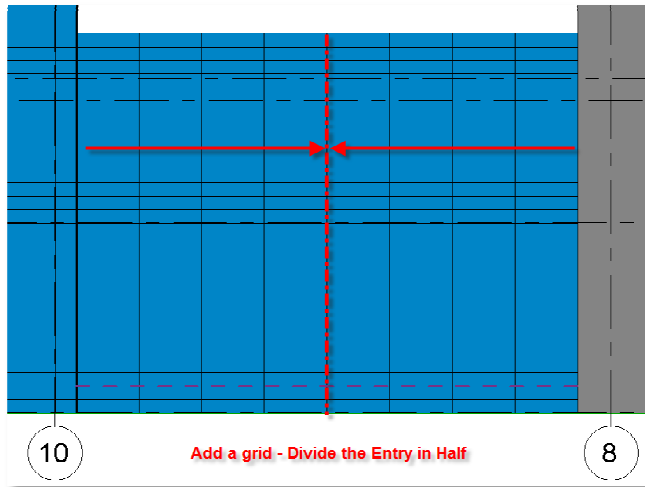

Next Divide the two panels in half again

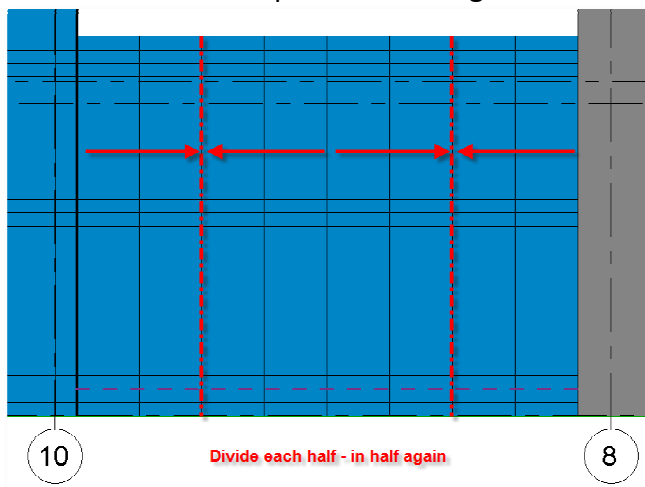

Next Divide the four panels in half again to create 8 equal panels

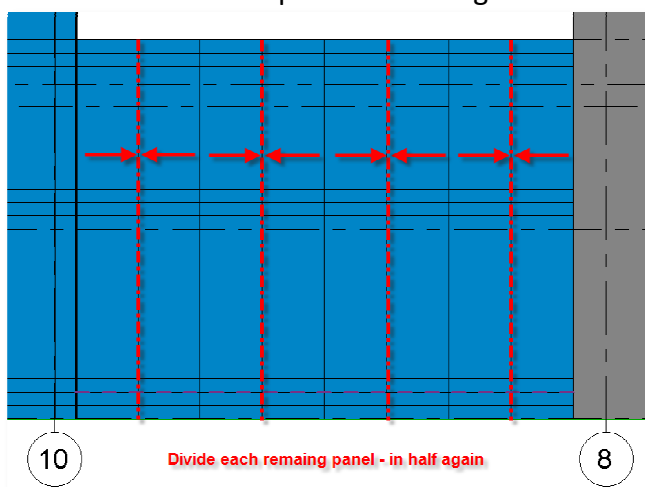

Spring 2011

Mirror the Grid: Finish by mirroring the grid lines of the entry space

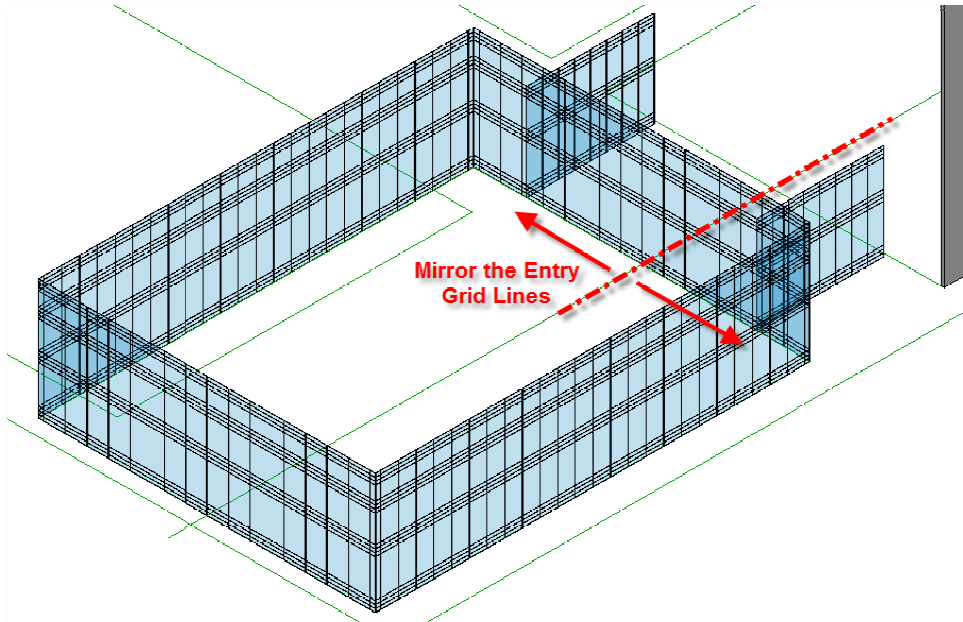

Add the Mullions: Home > Mullion > All Grid Lines

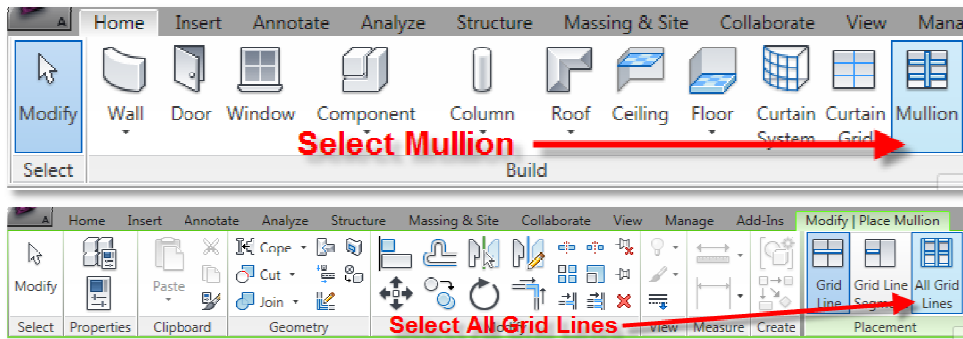

Select each curtain wall plane to create the mullions

