

Spring 2011

Phase 1 Stage 8: ADDITION OF COLUMNS AND COLUMN ENCLOSURES

(WEEK 4B)

Add Columns: Home > Columns > Structural Columns > Select At Grids

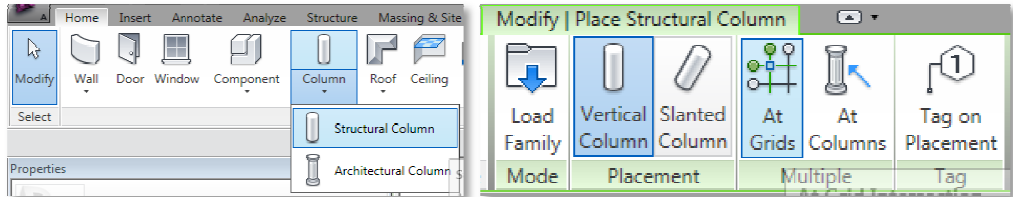

Select across the entire plan

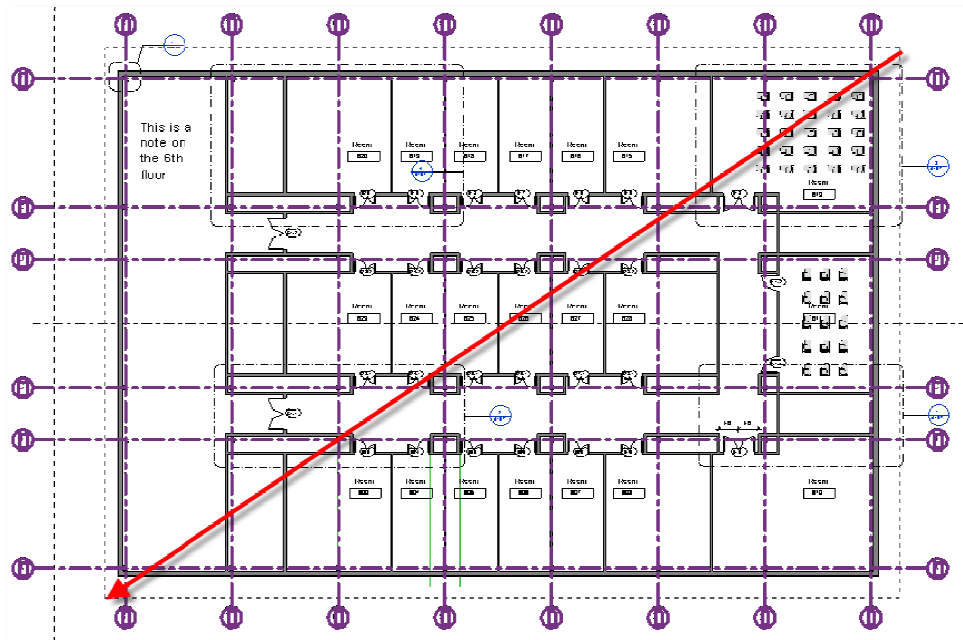

When you are done select Finish to create the columns

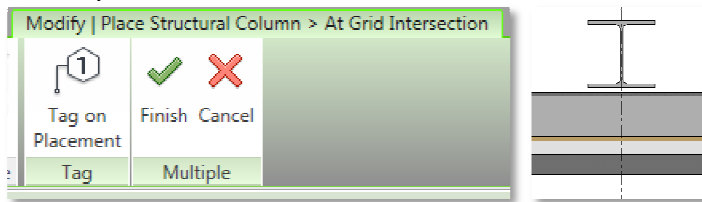

Plan Cleanup: There will be several instances where columns now intersect walls. Lets cleanup.

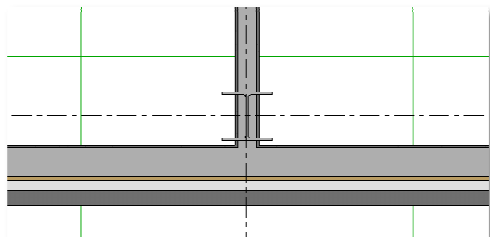

Spring 2011

**New Wall Type:** Home > Wall > Basic Wall Interior - 4 7/8" Partition 1-hr

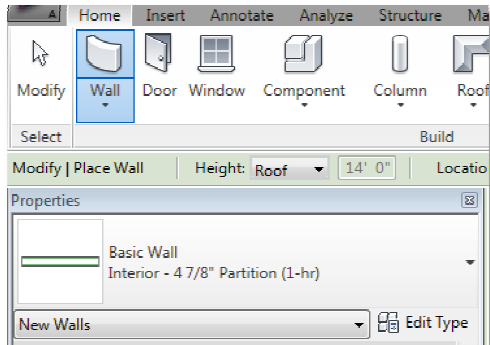

Select Edit Type

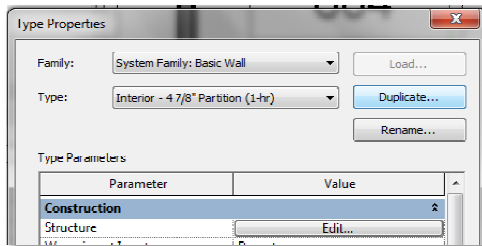

Select Duplicate

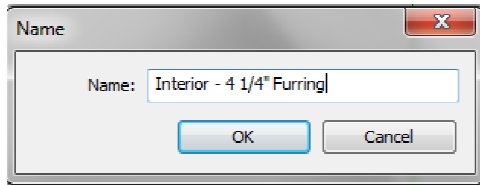

Change Name to Interior - 4 1/4" Furring

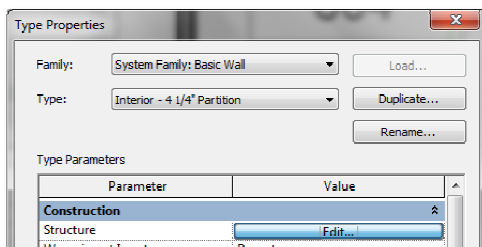

Select Edit to Change the Wall Details

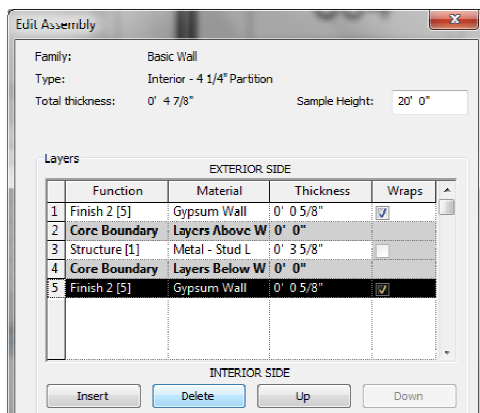

Select Layer 5 (5/8" GWB) and Delete

Spring 2011

**Draw New Walls:** Use the Furring to enclose all the columns

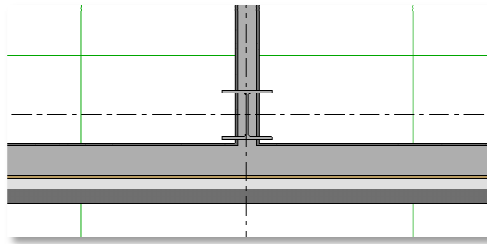

Draw guidelines for the walls

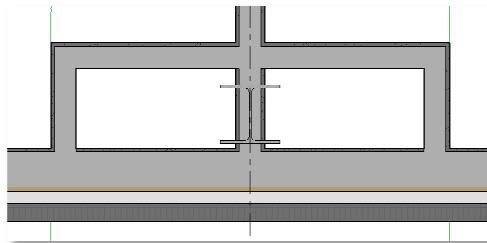

Now remove the wall through the column

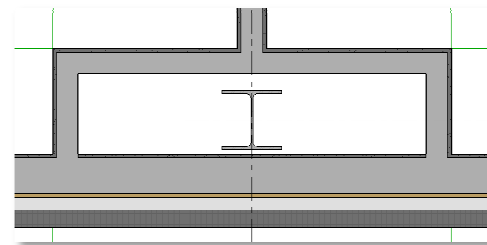

The cleaned up column enclosure

**Copy the Enclosure:** The first enclosure aligns with the enclosure in the corridor

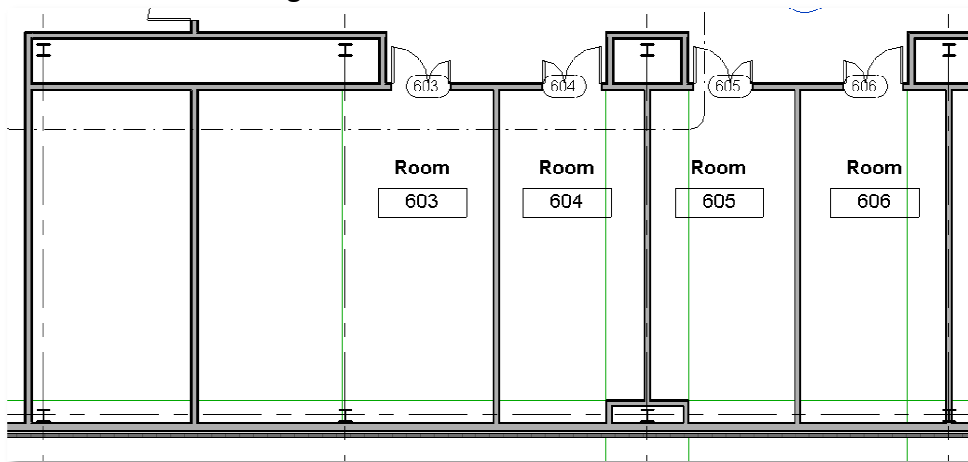

Copy the enclosure across the exterior wall

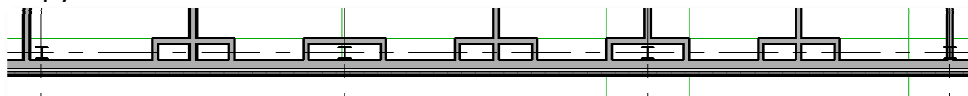

Cleanup walls that are not needed

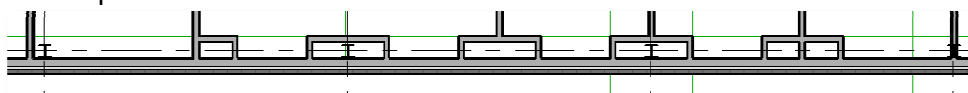

Spring 2011

**Corner Cleanup:** Continue the cleanup into the corner and then up the right side exterior

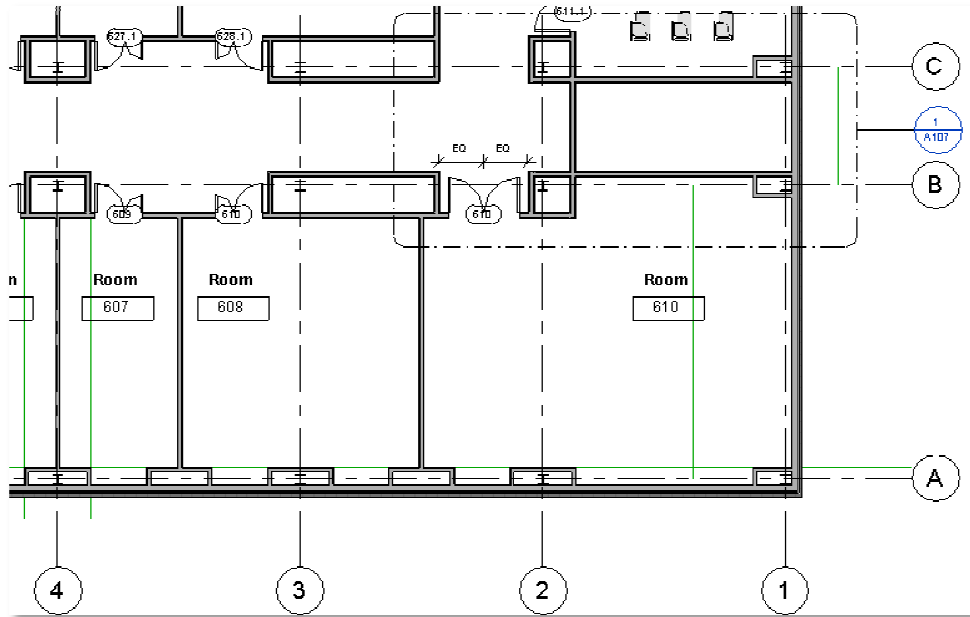

**Mirror the walls:** Mirror the new column enclosures across the central axis,

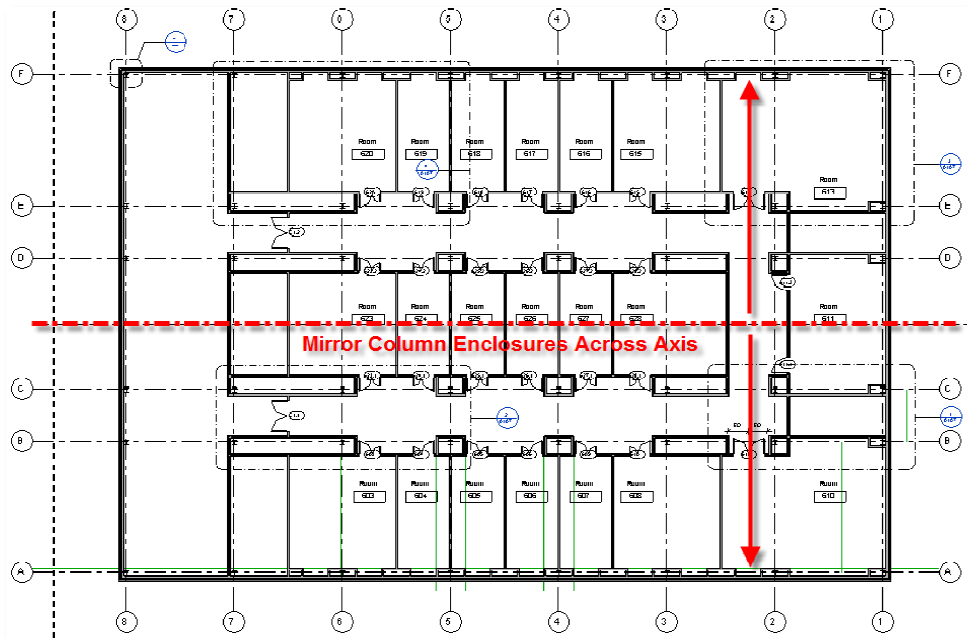

**Final Cleanup:** Follow the interior wall and clean up the entire building.