

Spring 2011

Phase 1 Stage 7: SHEET LAYOUT AND VIEWS

(WEEK 4A)

Overview: There are two areas of focus that need to be developed in parallel. The first is the model itself of our building and the second is the convention of documenting the building in drawing form. While some basic rules apply to all sets of drawings and their organization the layout of a specific set of sheets is dependent upon the specific building you are looking to document. In all cases the goal is to represent information in a clear, complete and concise manner.

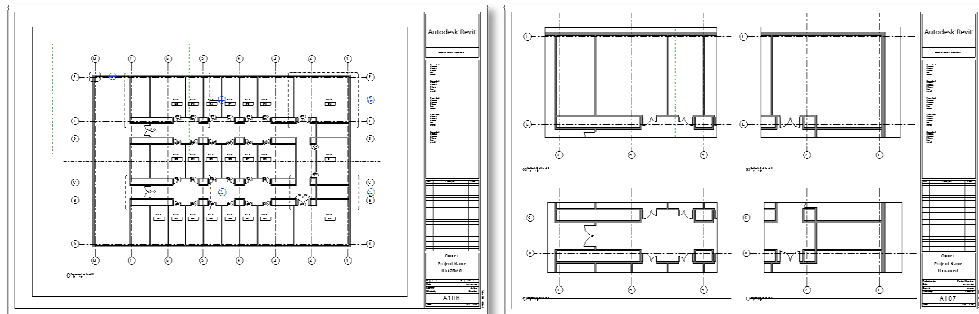

Typical Lab Floor Plan

Enlarged Part Plans

Appropriate Scale: While different types of drawing each have appropriate scales the scope of a project may require a modification to the standard approach. Floor Plans are typically drawn at 1/8" with enlarged plans at 1/4", exterior elevations and building sections typically match the scale of the floor plans, interior elevations are often 1/4" to 1/2" in order to show more detail, wall sections are drawn at 3/4" or 1 1/2" and details are often at 1 1/2" or 3"=1'. Scale must be large enough to show all the relevant detail and provide room for additional notes.

Extra Complexity: While different types of drawing each have appropriate scales the scope of a project may require modification to the standard approach. In the case of our project we will find that we cannot fit a first floor plan that shows all three buildings at 1/8" so we will need to use 1/16". This scale however is too small to show needed detail and so we will need to find a way to accommodate the extra detail. If this method produces three different level 1 floor plans how do we number the sheets if we cannot repeat numbers?

Team Assignment: Each team will be responsible to determine the appropriate drawings, scales, details, numbering and keying system for the project. Each team will be responsible for presenting this to the class in the form of an office manual.

Sheet Size: All teams will work with an 22 x 34 horizontal sheet. Titleblock can run either along the bottom or down the right hand side. Final submissions will include a full set of drawings printed at 50% of full size on 11 x 17" sheets.

Spring 2011

Duplicate Views: Each view exists at only 1 scale and each view can only appear once on any sheet. To show the same floor plan at different scales or to include it on more than one sheet you will need to create duplicate views.

Select an existing view in the project browser and then select Duplicate, Duplicate with Detailing or Duplicate as a dependent.

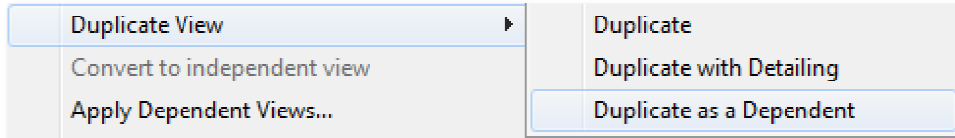

Duplicate: A **duplicate view** is identical to the original but does not include annotation elements from the original view. Can be a **different scale** than the original.

Duplicate: with Detailing: A **view with detailing** is identical to the original that includes details annotation elements from the original view. Can be a **different scale** than the original.

Duplicate: as a dependant: A **dependant view** uses the original view as a parent and includes all details and annotation is the **same scale as the original**. Use this type of view to crop a drawing and split it across two or more sheets with match lines.

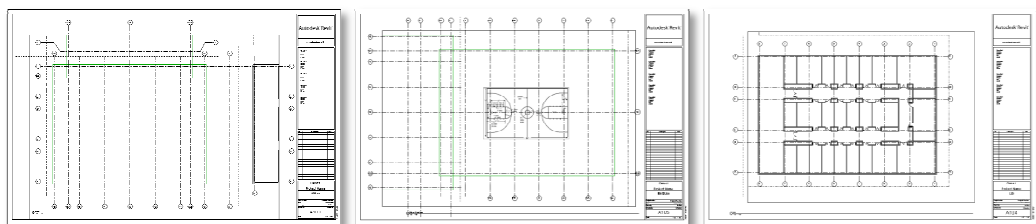

Level 1 Atrium Plan

Level 1 Multi-Use Plan

Level 1 Lab Plan

Callout Views: A callout view keys an enlarged partial plan or detail to a parent view.

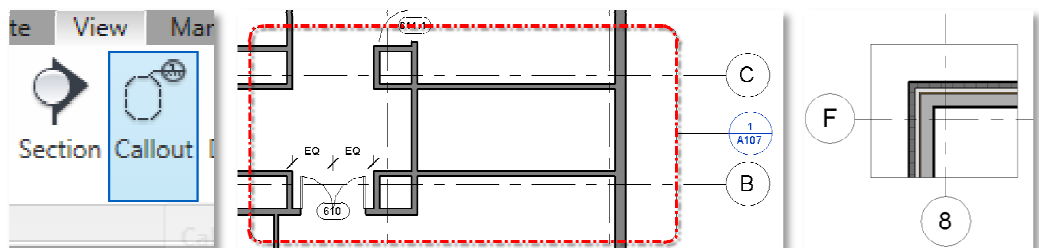

Spring 2011

Duplicate:
as a dependant: **Right Click > Activate the view** and crop the limited to create a partial floor plan.

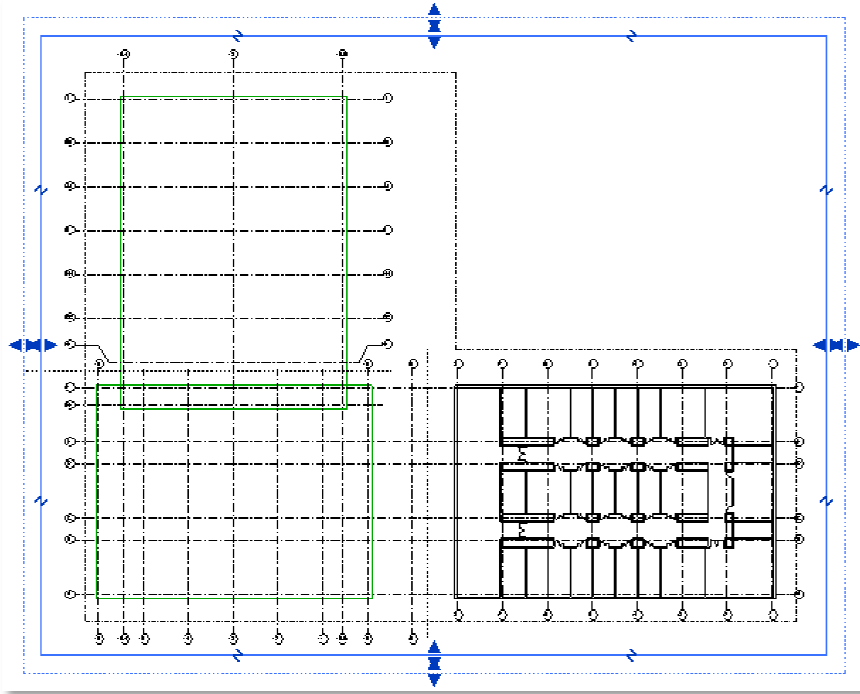

Graphics Limit: The inner rectangle controls the display of plan graphics and grid lines.

Annotation Limit: The outer rectangle controls the limits of the display of annotations.

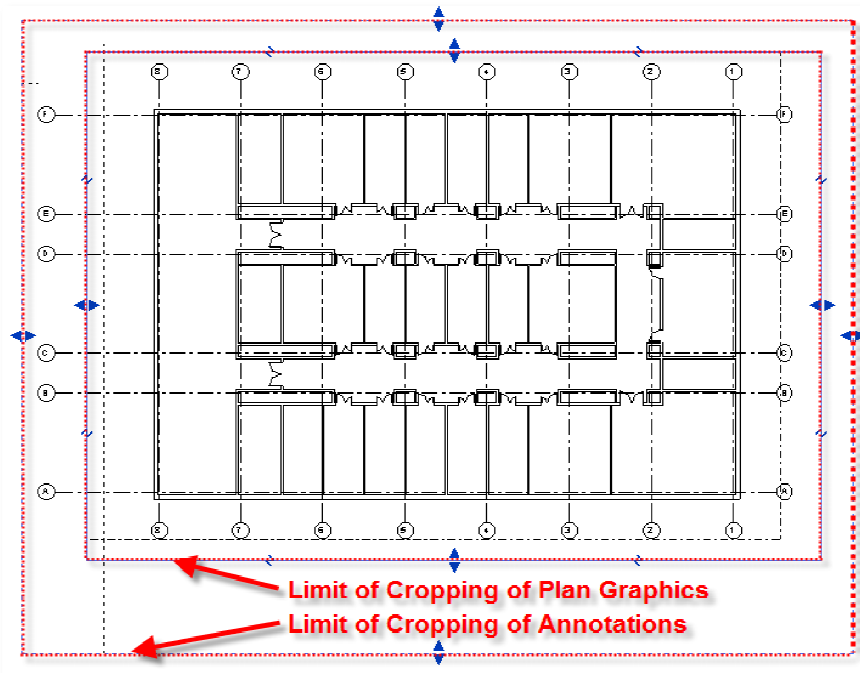

Spring 2011

**Vertical:
 View Break:** An example of a dependent view using a Vertical View Break.

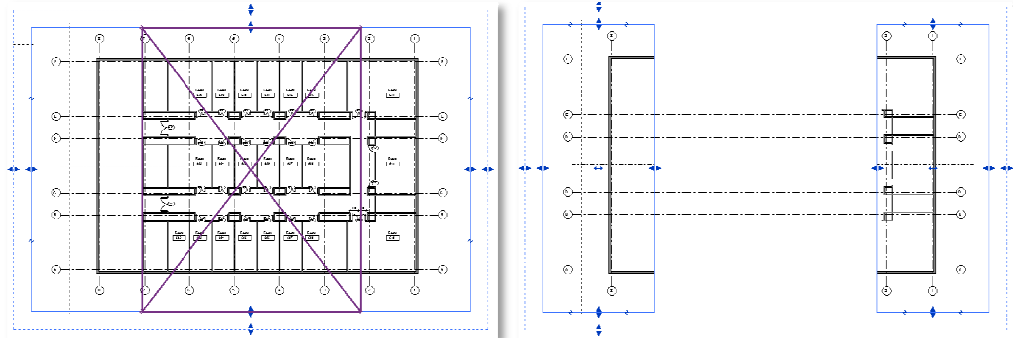

**Horizontal:
 View Break:** An example of a dependent view using a Horizontal View Break.

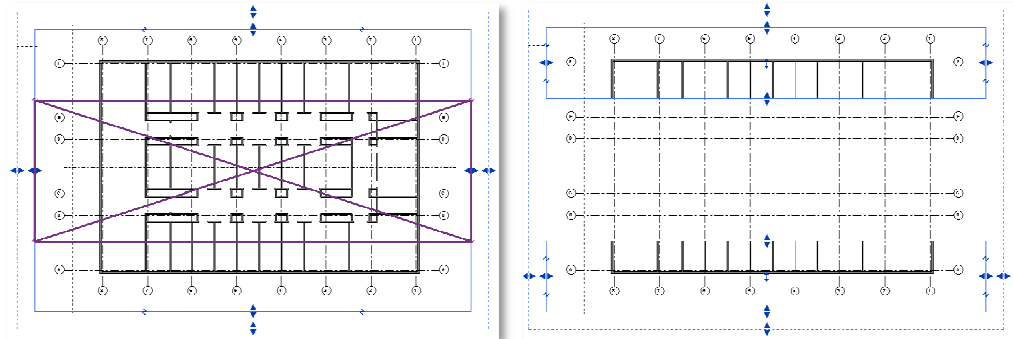

Project Browser: Pay attention to the way that your duplicate and callout views are named in the project browser and develop a naming system that keeps things organized.

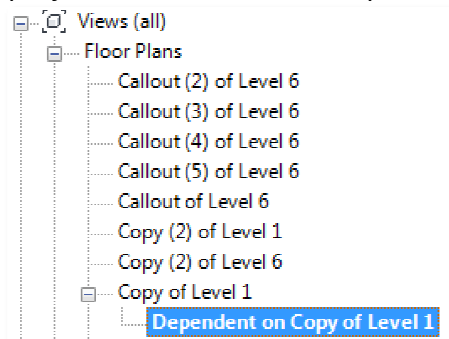

Detail Name: By default the name that appears on a sheet is the same as the view name. You can independently control the **Title on Sheet** value.

Identity Data	
View Name	Dependent on Level 6 with detailing
Dependency	Dependent on Level 6 with detailing
Title on Sheet	My Sheet can have a different Title