

Spring 2011

Phase 1 Stage 4: ADDITION OF CORE & DOORS- MODULAR LAB BUILDING

(WEEK 2B)

Overview: For the second phase of work on the typical lab floor plan we will layout core spaces (elevators, bathrooms, fire stairs) and will add doors to the plan. We will first create the lower corridor and then mirror this to create the upper corridor. We will then complete the remaining vertical corridor and the core spaces.

Door Types: Door types must be rated to maintain the fire enclosure created by rated walls.

Justification: As with walls we will need to pay attention to how we locate doors.

1: Add Guideline: Home > Model Lines > Pick Lines > Offset = 10'-3"
Draw a guideline between gridlines 6 & 7 as a guide for creating a core wall.

2: Add Core Wall: Home > Wall > Basic Wall Interior 6 1/8" (2 Hour)
Height = Roof Location = Wall Centerline

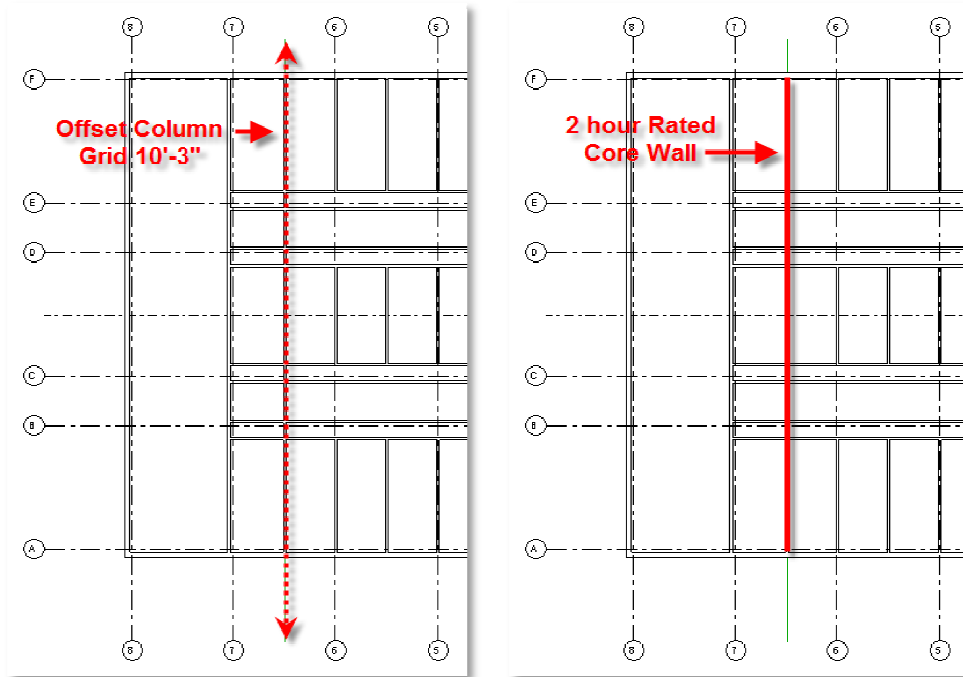

3: Lower Corridor: As seen below we will focus on the lower corridor working across from left to right and finishing with the stair door. When done we will mirror this up.

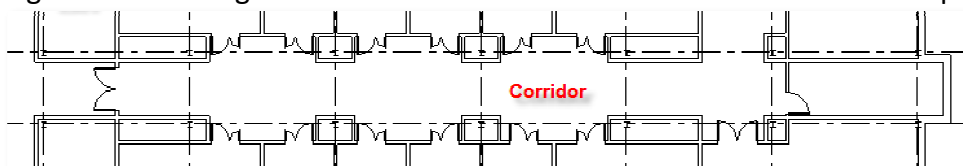

Spring 2011

4: Entry Area: Remove the wall at the end of the corridor by using Split, then Drag, then Align.



5: Entry Area

Add First Door Home > Door

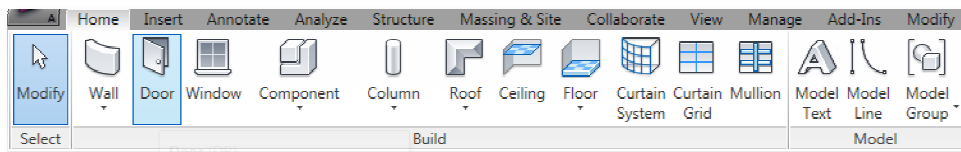

Load Door Type

If you need to load the library file Edit-Type > Load > double-flush.rfa
Change the size to 72 x 84.

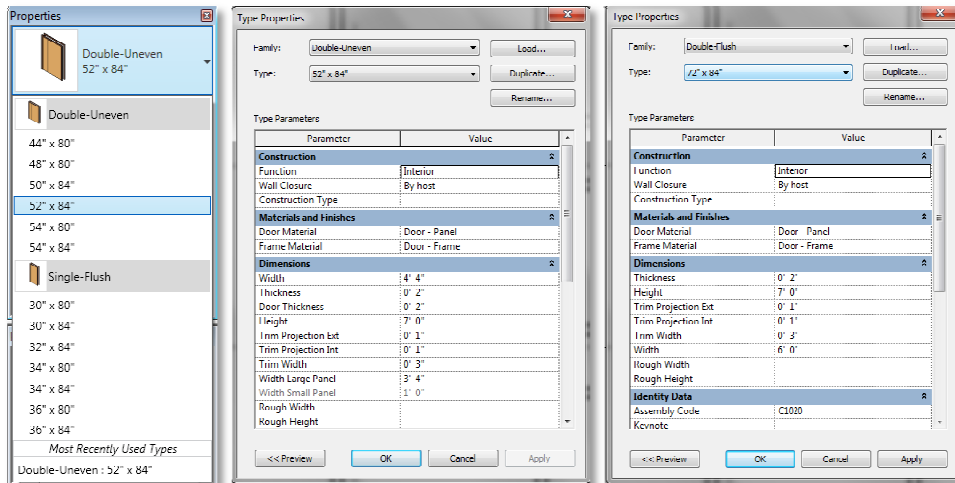

Add Door

Remove chase walls then place door centered on wall swinging toward lobby

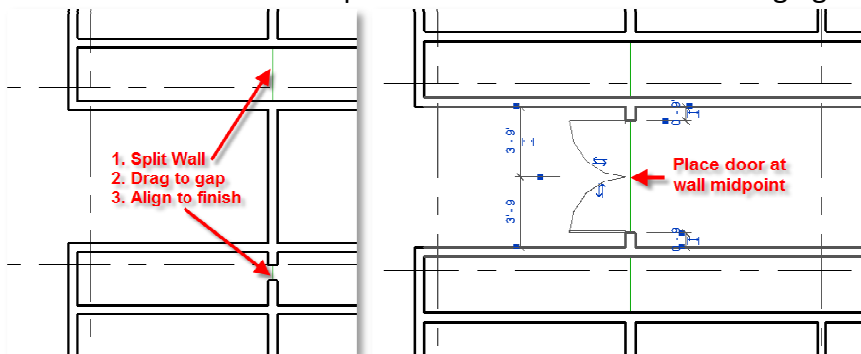

Spring 2011

6a: Guidelines: Home > Model Lines > Pick Lines (Set the offset to 2'-9 1/2")

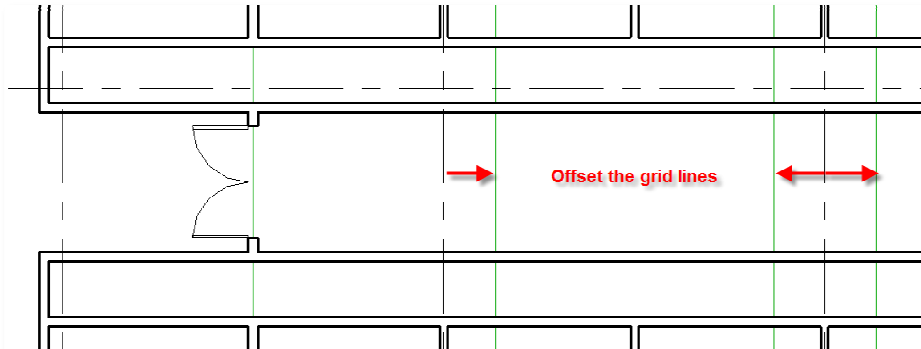

6b: Add Walls: Home > Wall > Basic Wall Interior 6 1/8" (2 Hour) Use **Finish Face Interior**

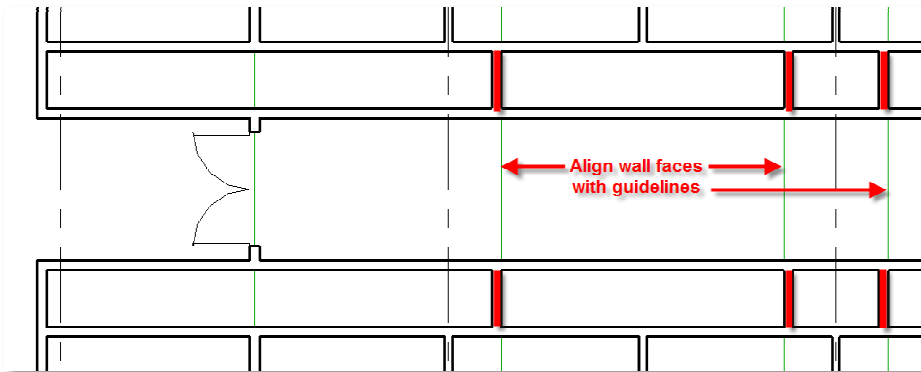

6c: Split and Gap: Split and drag the walls to create a gap

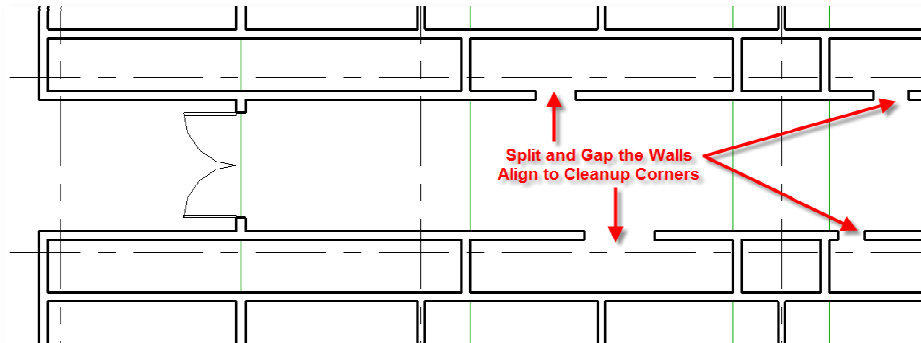

6d: Cleanup: Use align to complete the cleanup

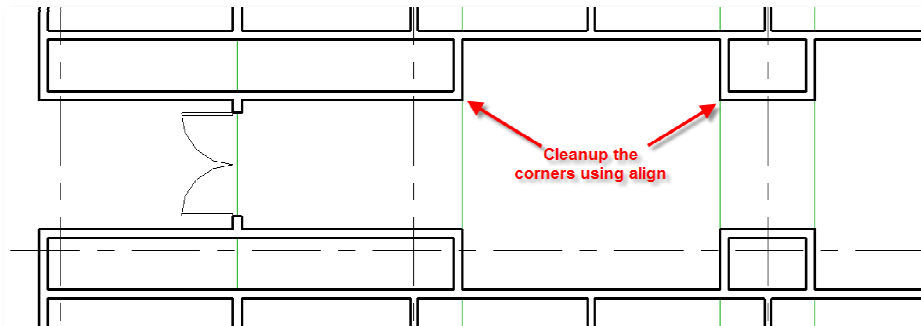

Spring 2011

- 7a: **Guidelines:** Add guidelines 4" from the walls and locate the center of the bay
 7b: **Add 1 Door:** Home > Doors > Double-Uneven 48 x 80. We will adjust location and direction

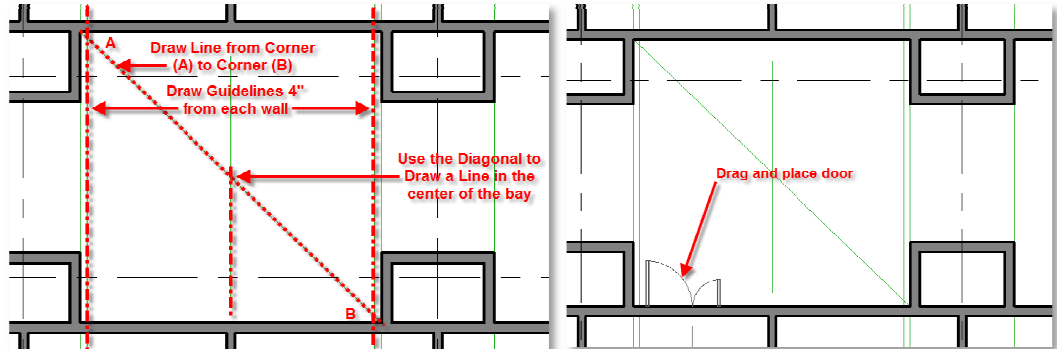

- 7c: **Align Door:** Align the door with the 4" guideline.

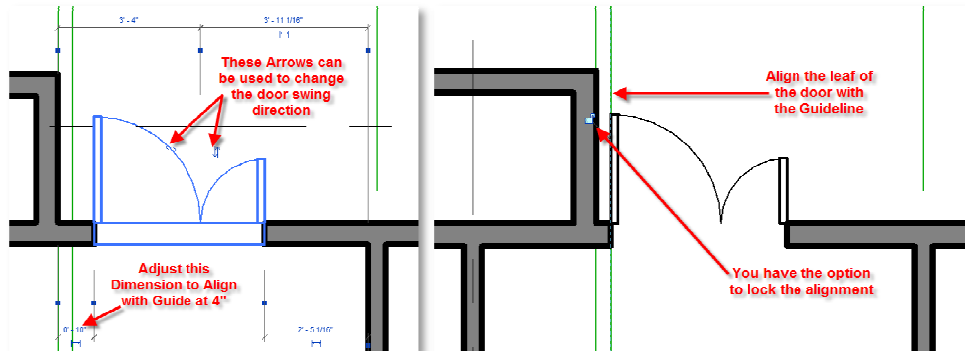

- 7d: **Mirror Door:** Mirror door 1 across the middle of the bay and then the pair across the corridor

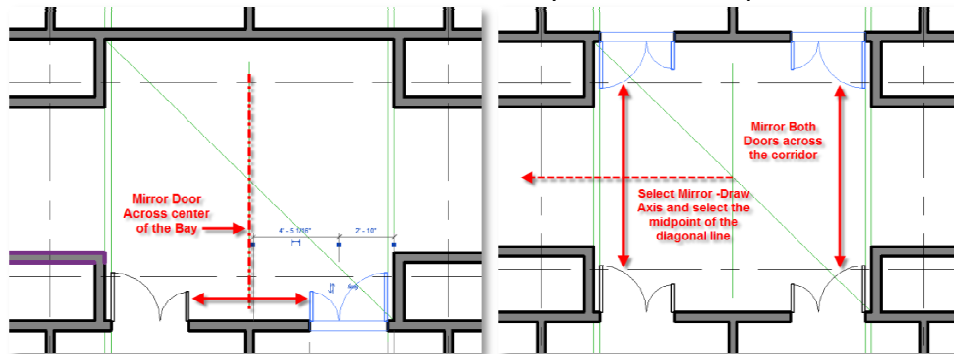

- 8a: **Delete Walls:** Delete the remaining corridor walls

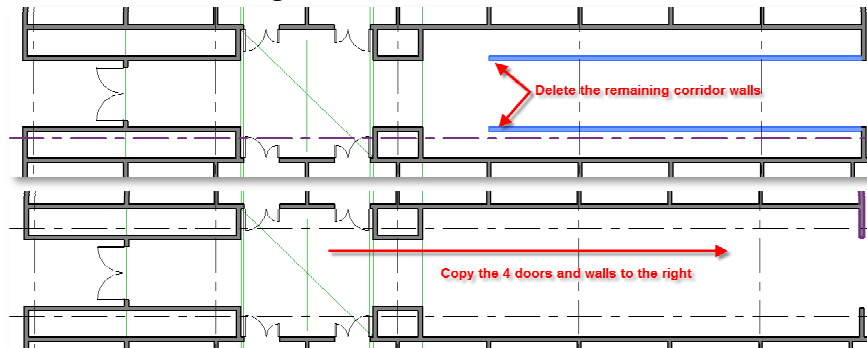

Spring 2011

8b: Select

Select the doors and walls

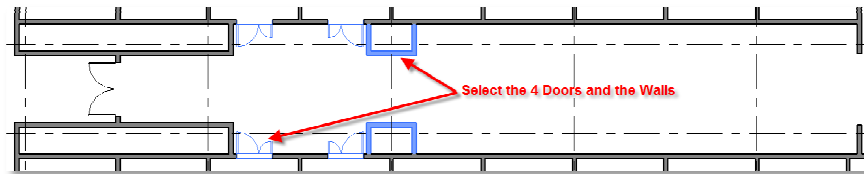

8c: Copy 1st Bay

Copy the first set the distance from the grid to the next grid

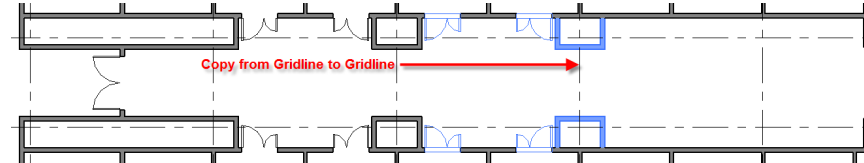

8d: Copy 2nd Bay

Copy the second set the distance from the grid to the next grid

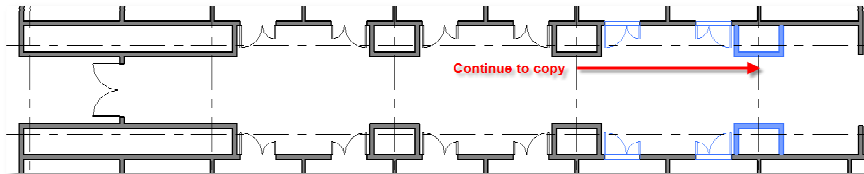

8c: Cleanup

Cleanup the end of the corridor. Delete and then extend walls.

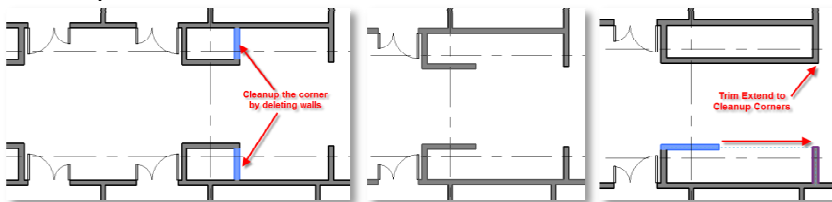

9a: Delete Walls

Delete the walls in the upper corridor

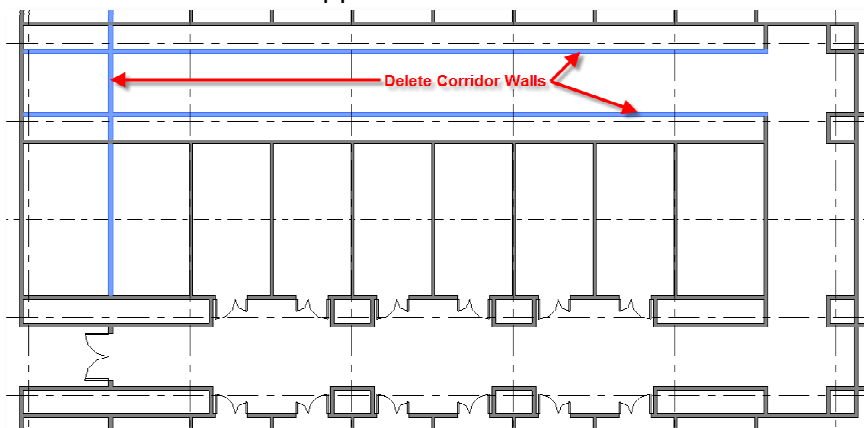

9b: Select

Select the walls and doors that we want to mirror

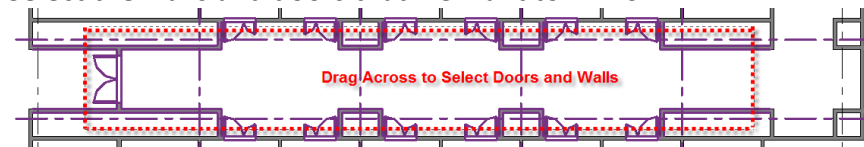

Use filter to remove the gridlines from the selection.
You should have only walls and doors selected.

Spring 2011

9c: Mirror

Mirror across the building centerline

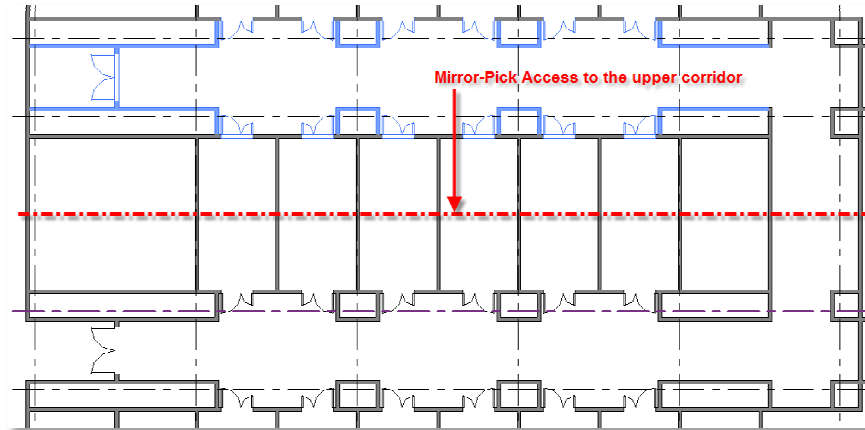

10a: Add Door

Home > Doors > Double-Flush 72 x 84. We can adjust location and direction. Select the door and then select the dimensions to make the permanent. Next in the properties box select Equality Display > EQ

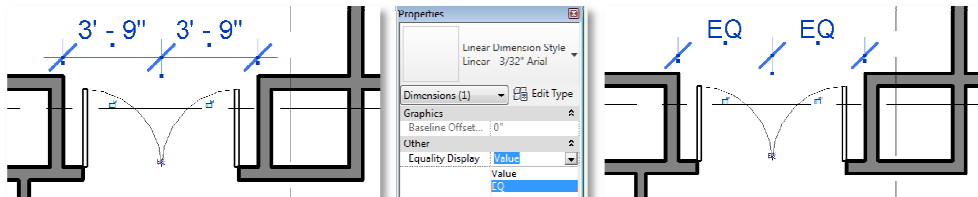

10b: Add Door

Home > Doors > Single-Flush 36 x 84. We can adjust location and direction. Flip the door swing and align the door 4\"/>

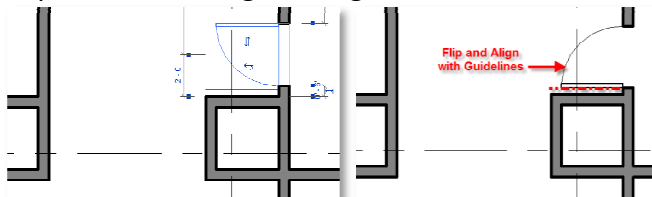

11: Mirror Doors

Mirror the two doors selecting the building centerline

