



# ARCHITECTURE PORTFOLIO 2017

---

Hanan Chikhmoussa

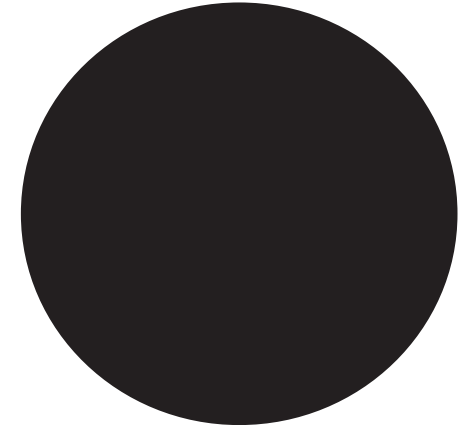

TABLE OF CONTENTS

1

PROJECT 1 ORIGAMI

2

PROJECT 2 BRIDGING SURFACES

3

PROJECT 3 VERTICAL STAGE

4

PROJECT 4 SURFACE, SPACE AND THRESHOLD

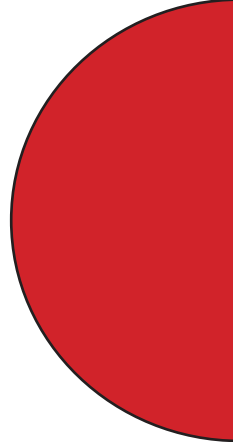
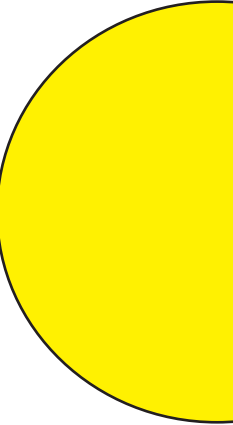
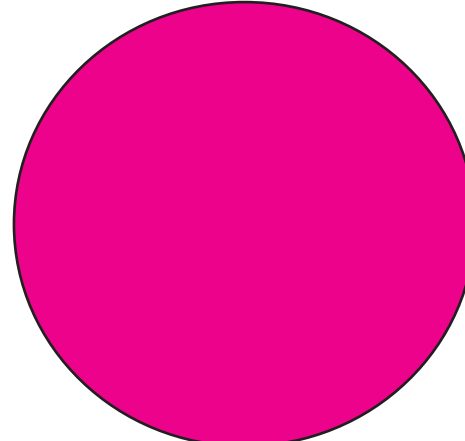
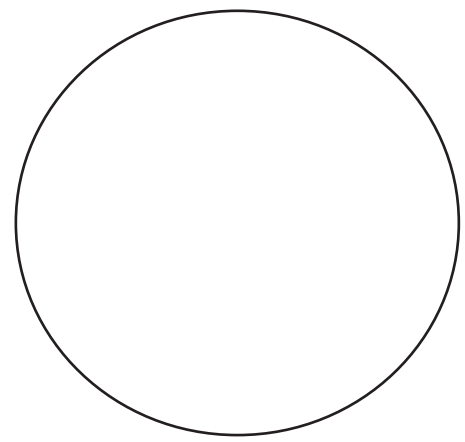

Hanan Chikhmoussa  
Hanan.Chikhmoussa@mail.citytech.cun.edu  
Education :  
New York City College of Technology  
300 Jay street, Brooklyn, NY 11201  
(718)-260-5500  
-Bachelor degree in architiectural technology

Skills :  
-Photoshop  
-Indesign  
-Illustrator  
-Autocad  
-Rhino



ORIGAMI

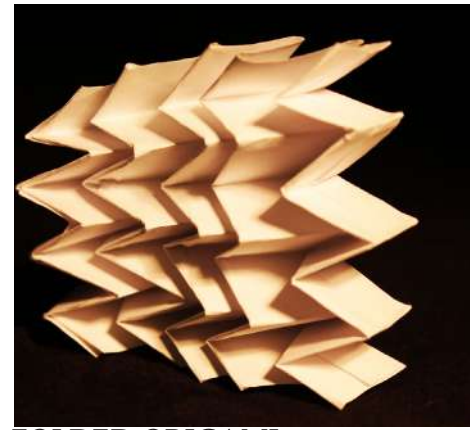
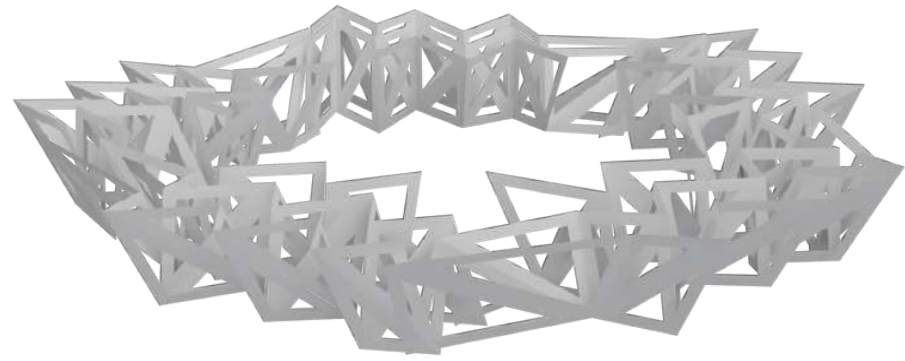

FOLDED ORIGAMI

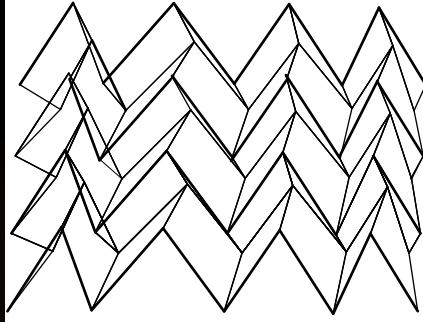

DIGITIZED POINTS

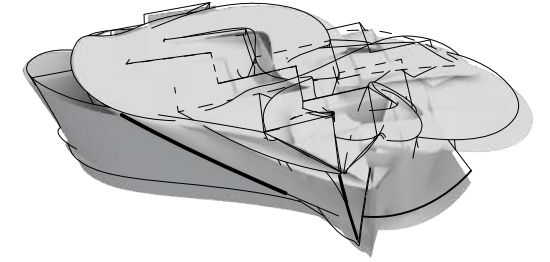
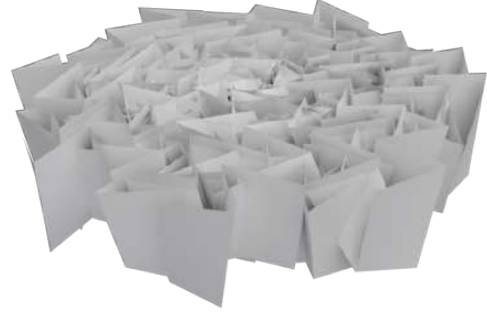
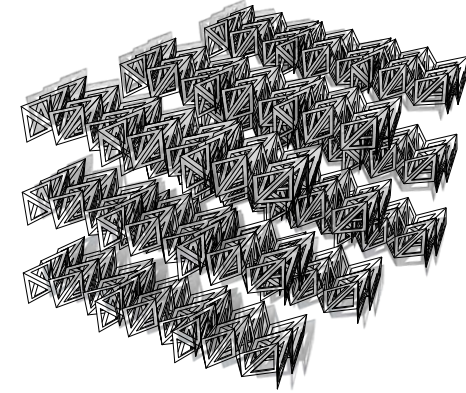

FREE FORM ITERATIONS

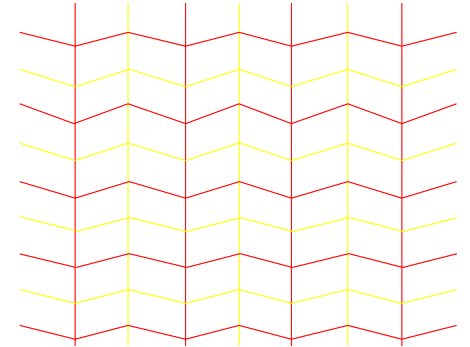

ALIGNED GEOMETRY

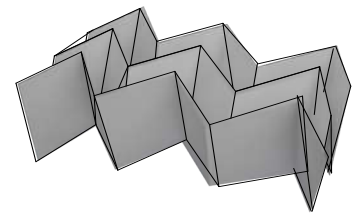

DIGITAL ORIGAMI

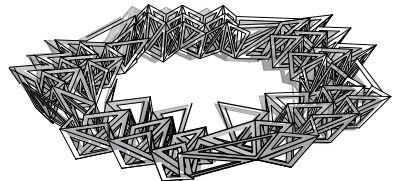
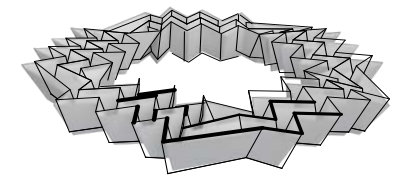
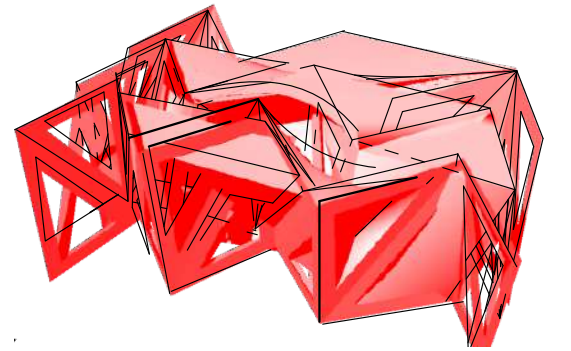
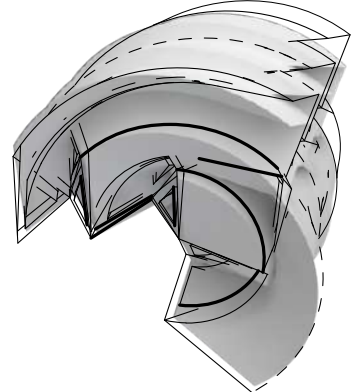
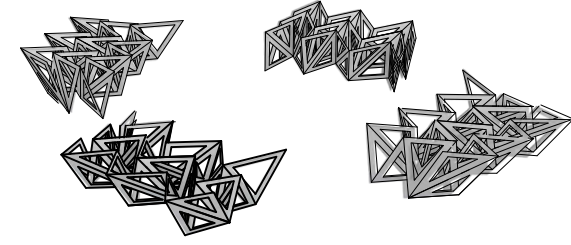

MODIFIED ORIGAMI

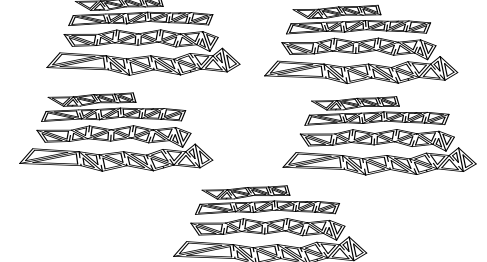

NESTING LAYOUT

OFFSET

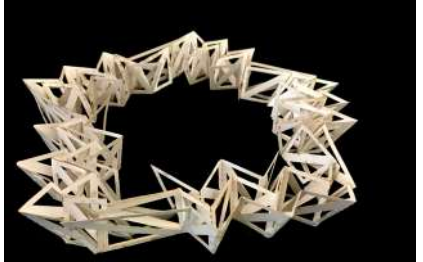

FINAL PHYSICAL MODEL

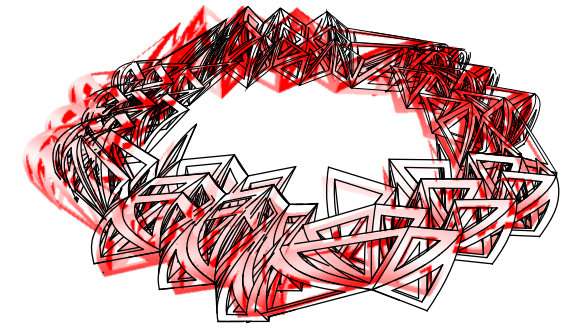
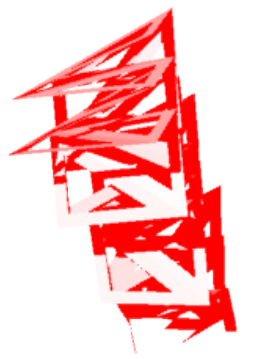
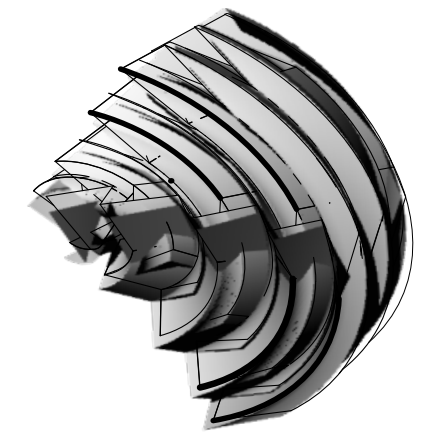
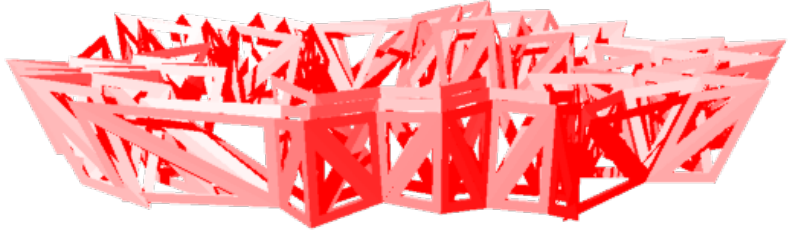

## BRIDGING SURFACES



I combined the three languages into one developed model which integrates linear, planar and volumetric language to create the spatial conditions in the sequence generated in my collage. I used 1/4 scale to build my bridge. I used the idea of rotation from my collage to give my model a design. My bridge has two floors that connect in multiple directions. The planes have slopes. They are going up and down. Also there are lines around the bridge and two squares on both sides. There is a lounge in the middle of the bridge. Some sides are closed to focus more on the view from the other sides.

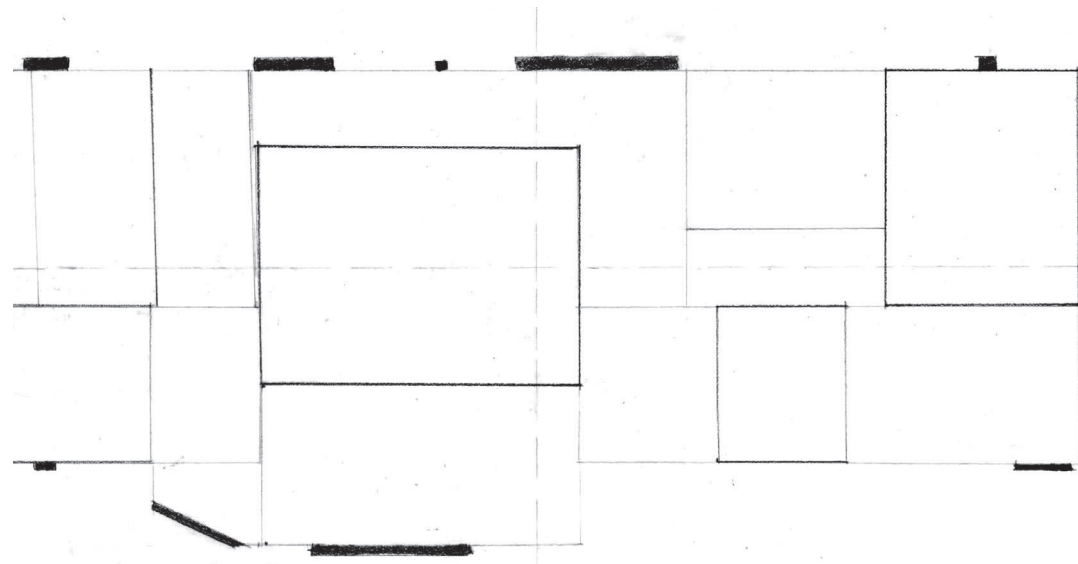

PLAN

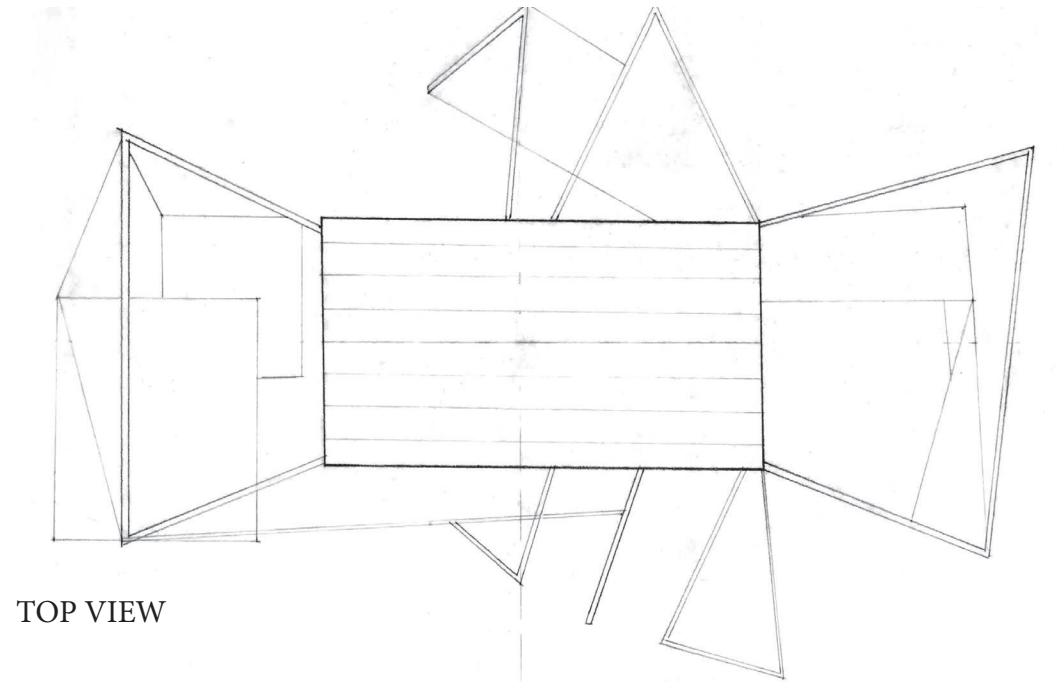

TOP VIEW

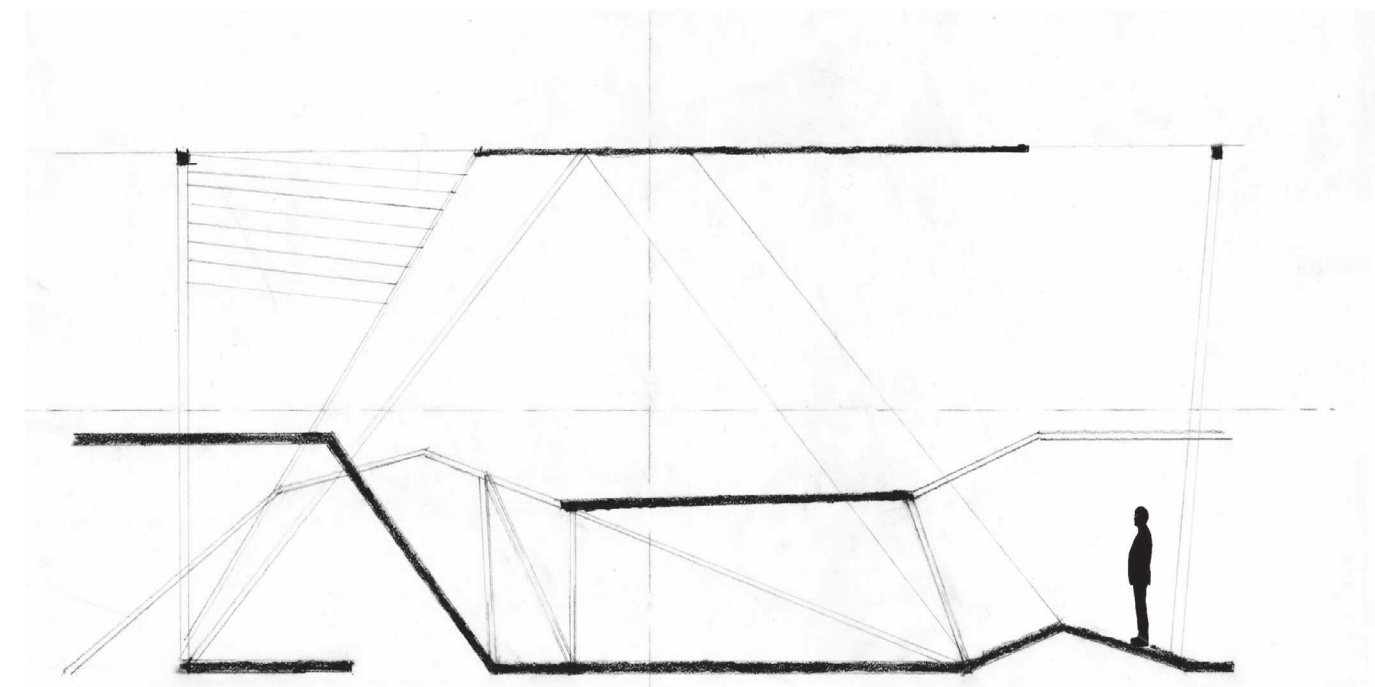

SECTION

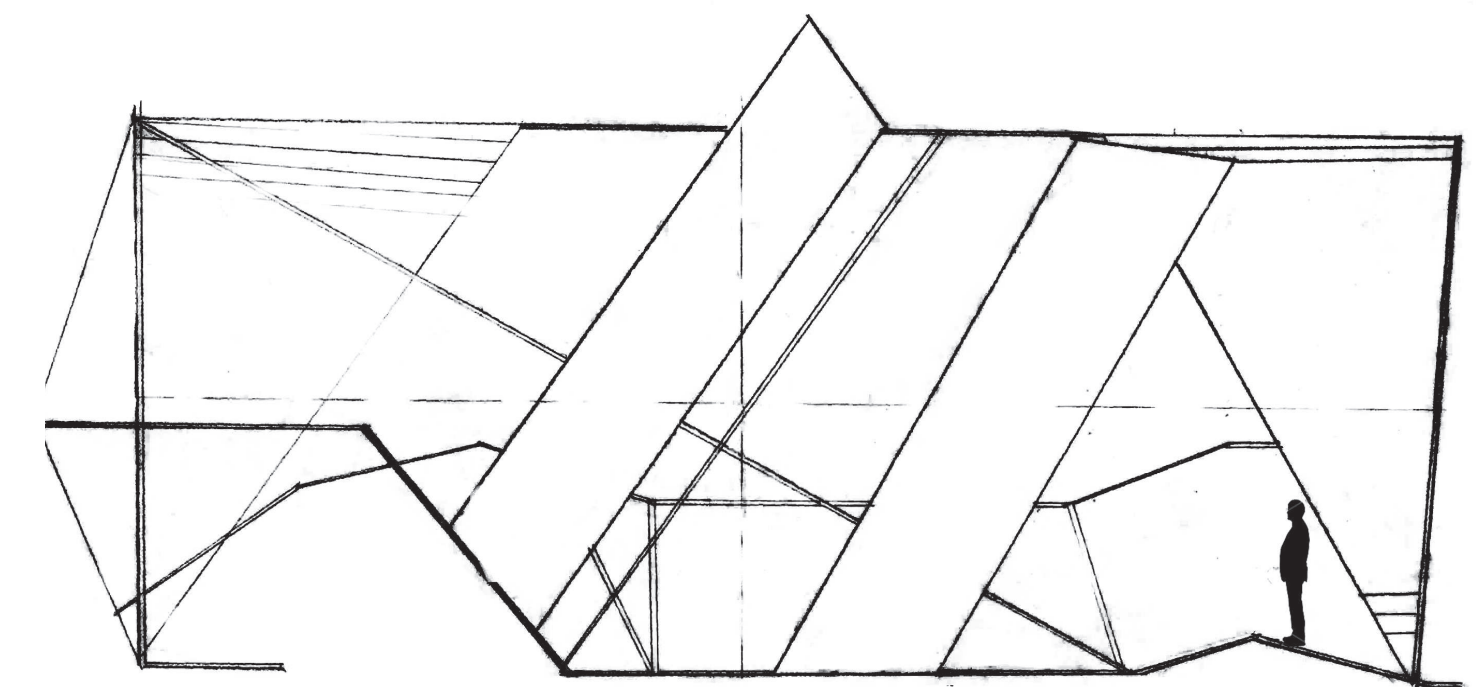

ELEVATION

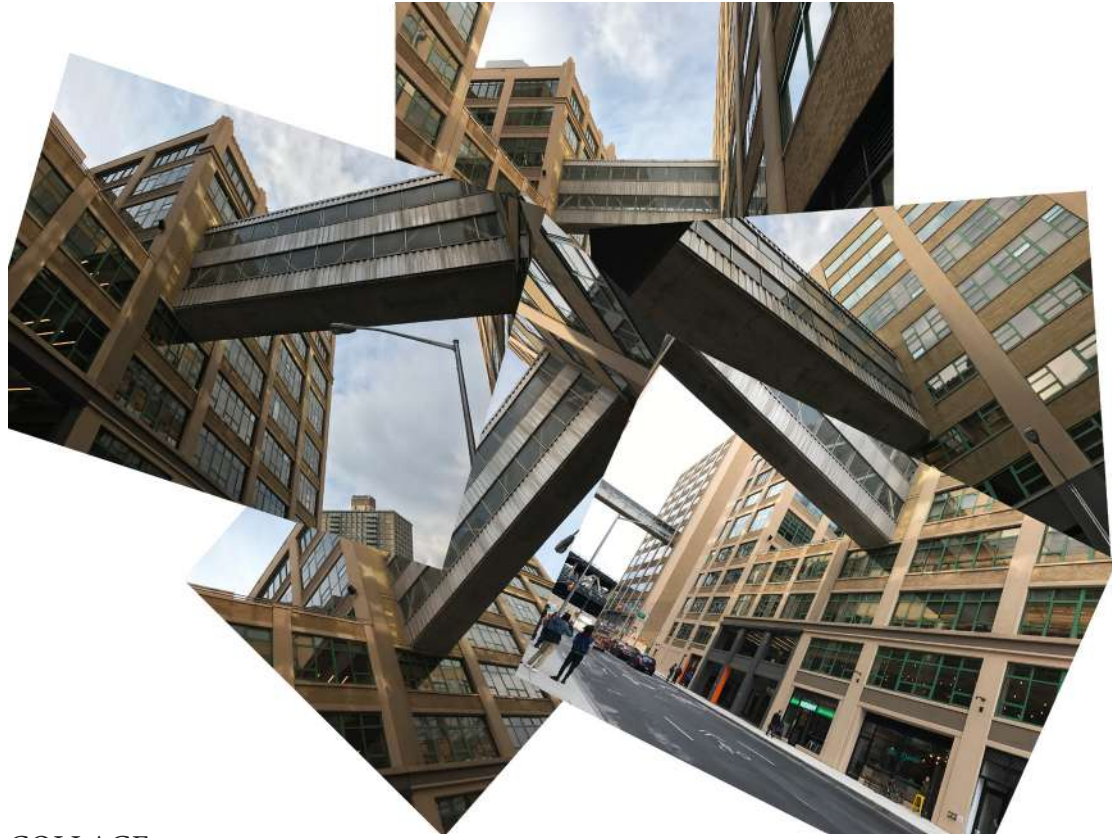

COLLAGE



LINES

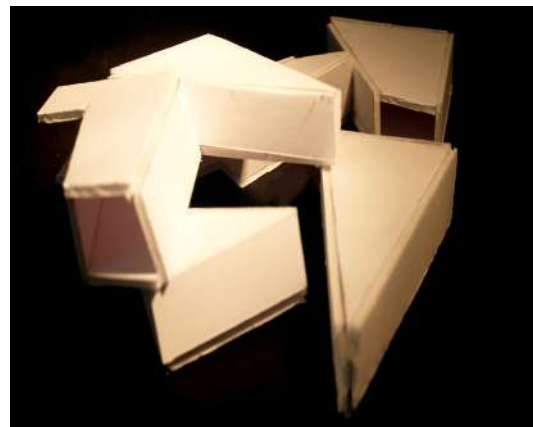

VOLUME

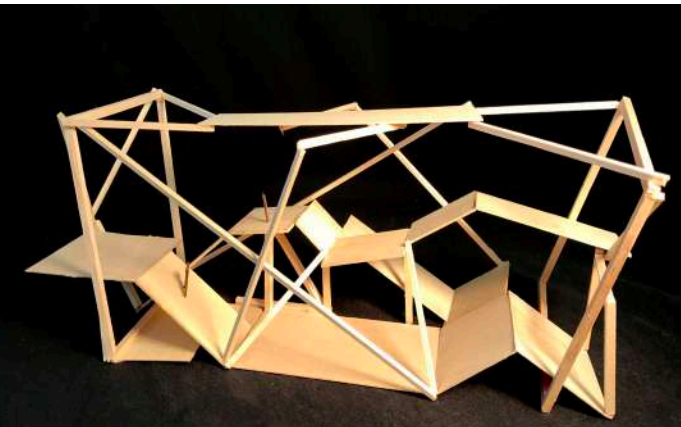

BRIDG STUDY MODEL

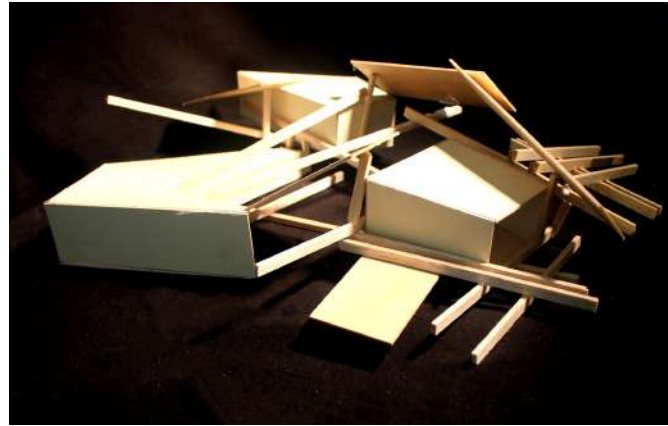

ABSTRACT STUDY MODEL

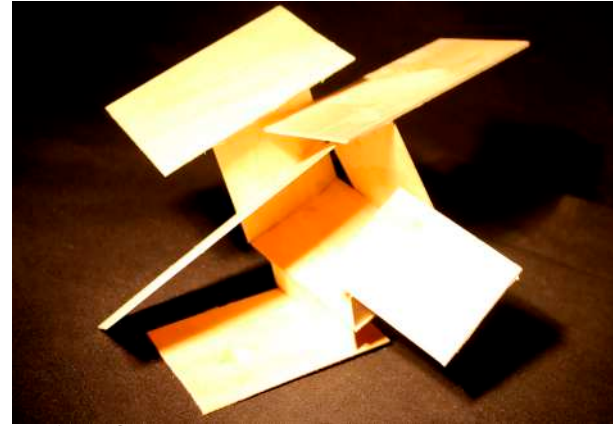

PLANES

PROCESS



PHOTOMONTAGE

VERTICAL STAGE

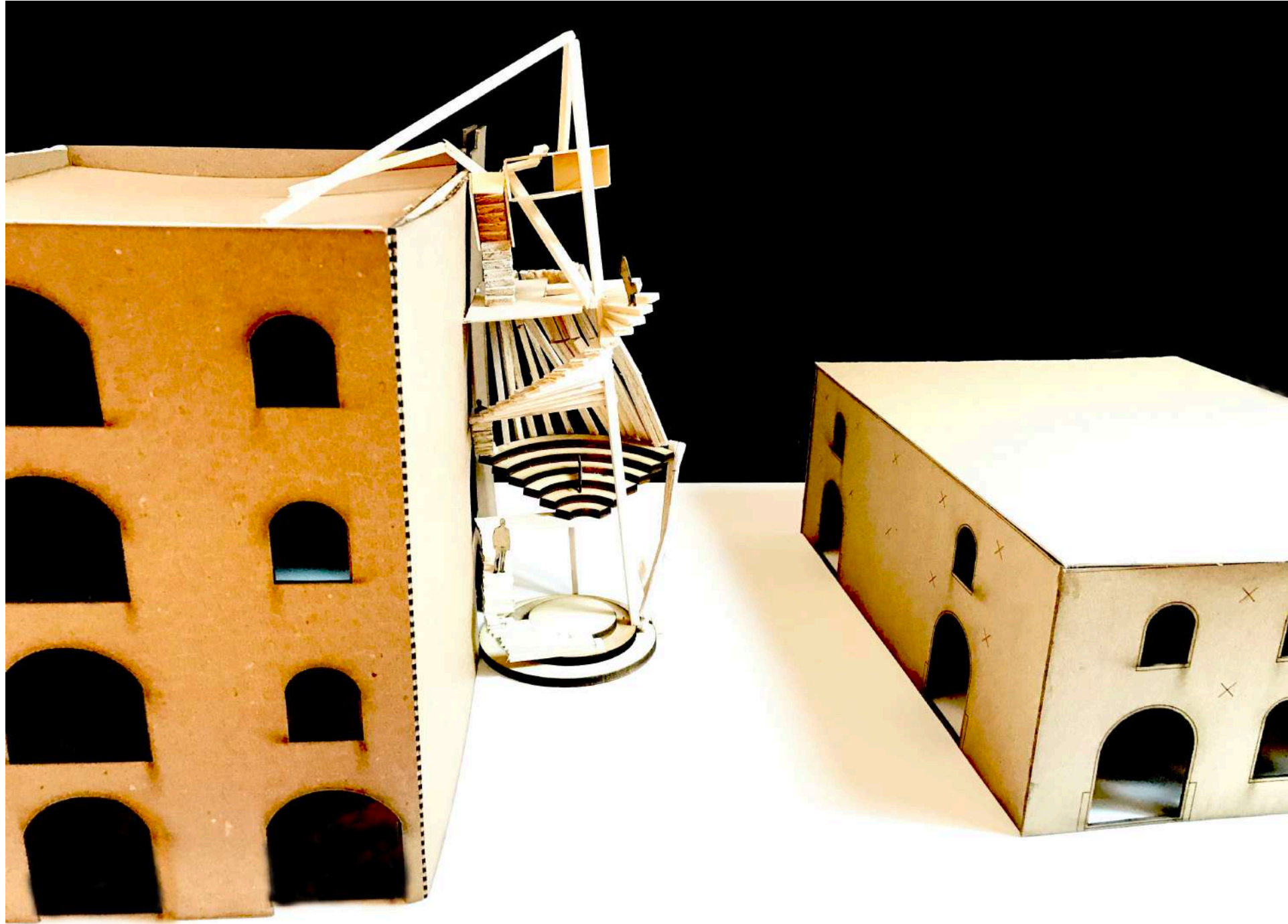

Vertical stage connecting the Brooklyn Bridge Park, an interior public space and a public roof garden at the former Empire store warehouse located in DUMBO, Brooklyn ,NY.

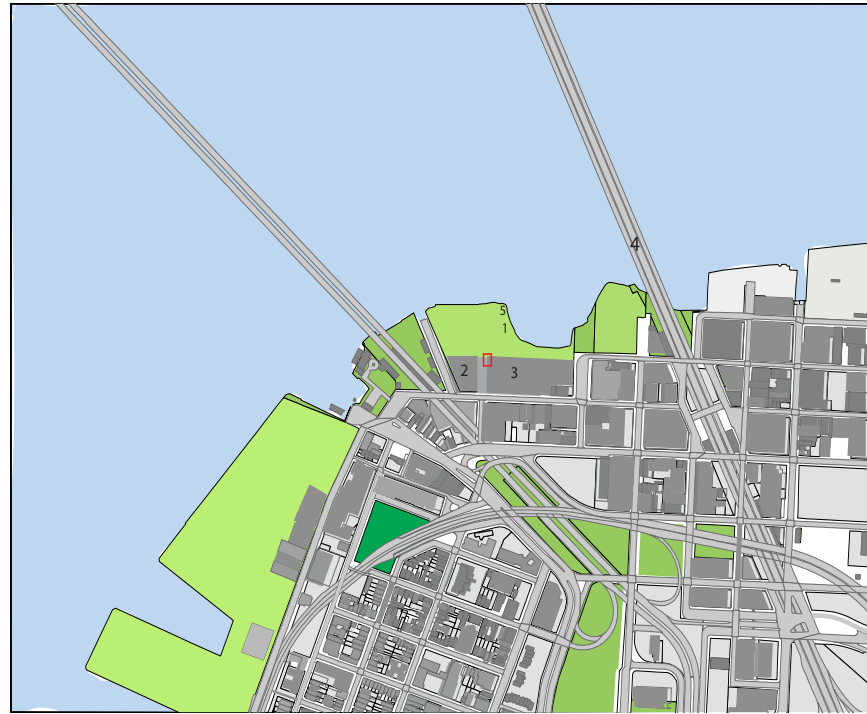

Site View



- Water
- Grass
- Building

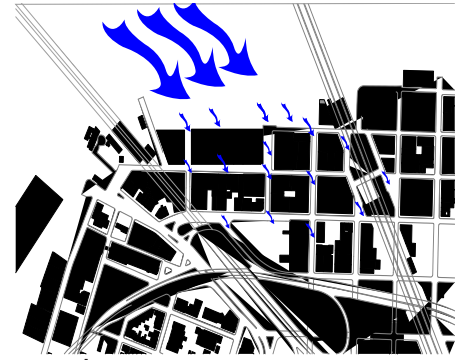

Wind



Noises

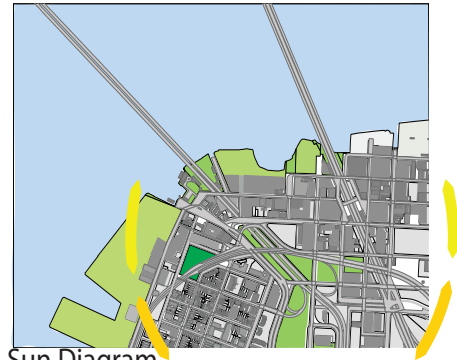

Sun Diagram

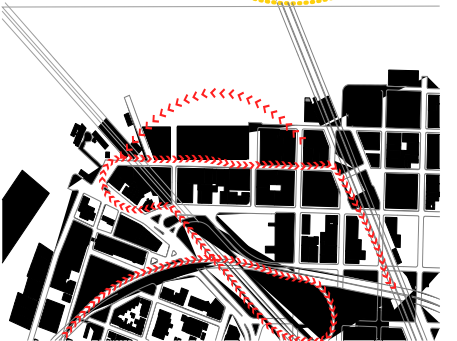

Circulation



SITE ANALYSIS

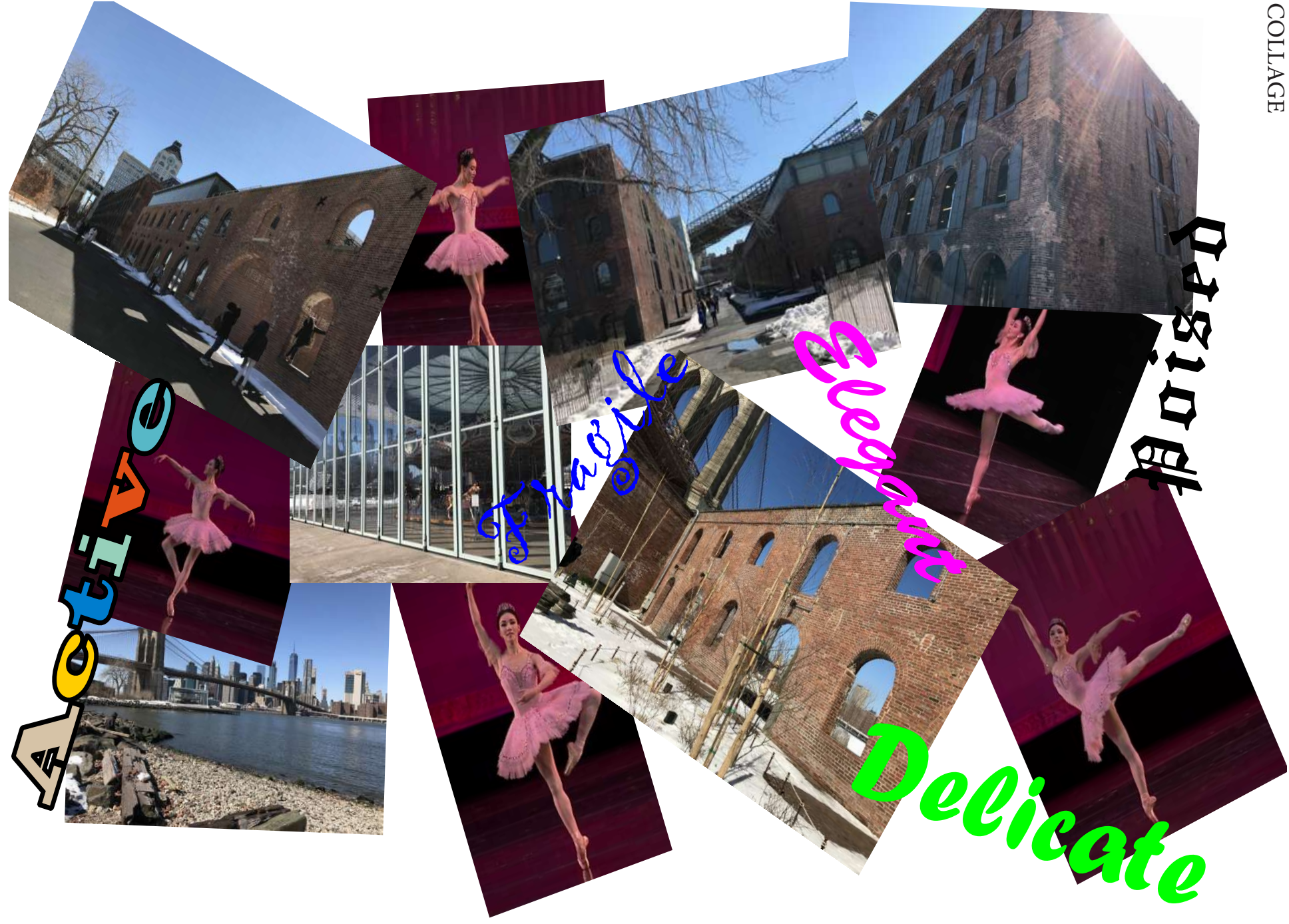

COLLAGE



VERTICAL STAGE  
DRAWING

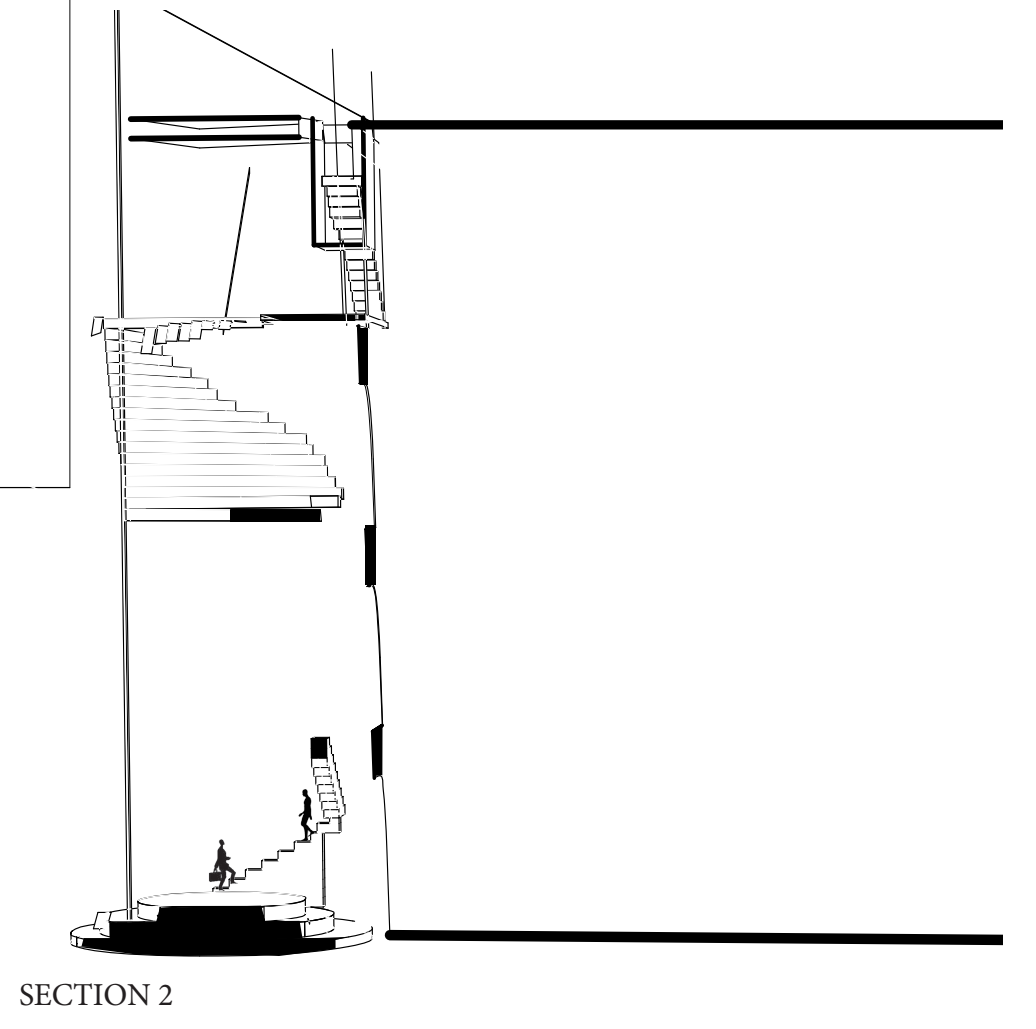
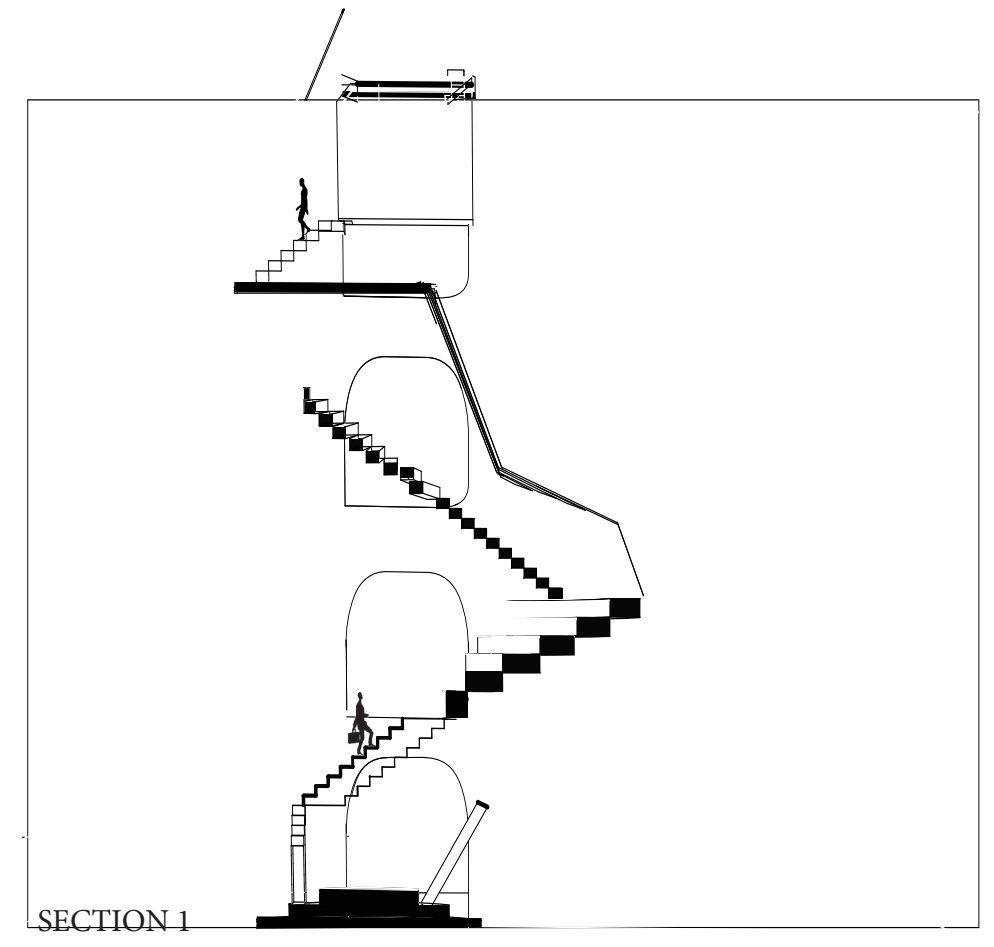
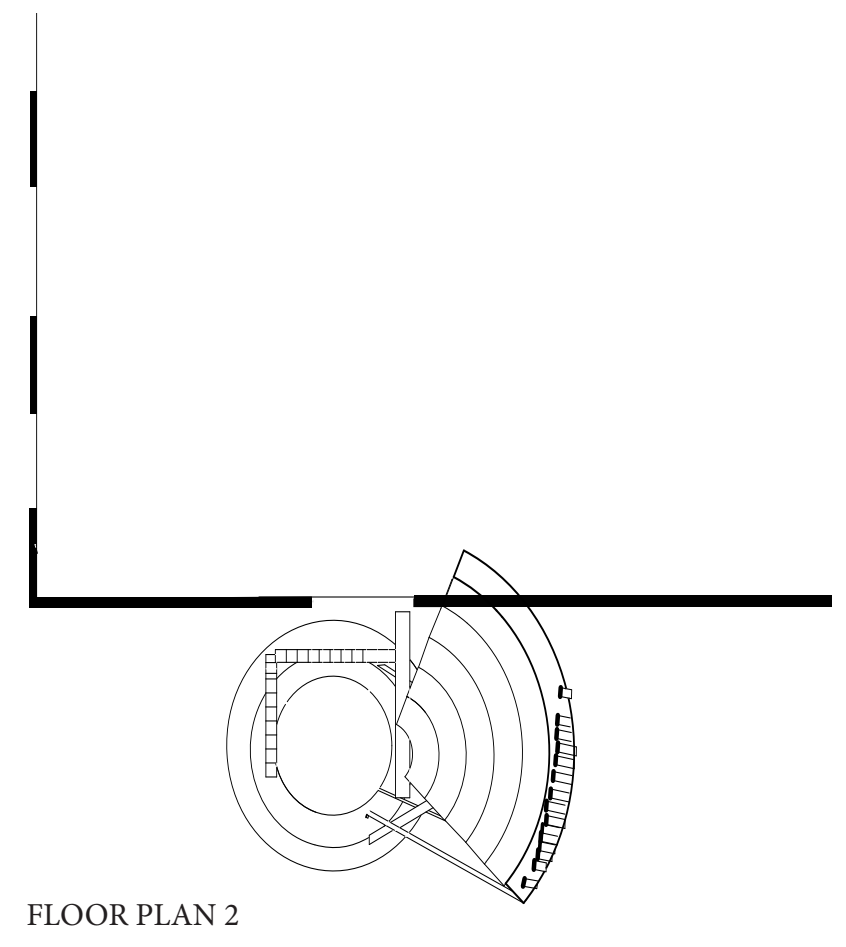
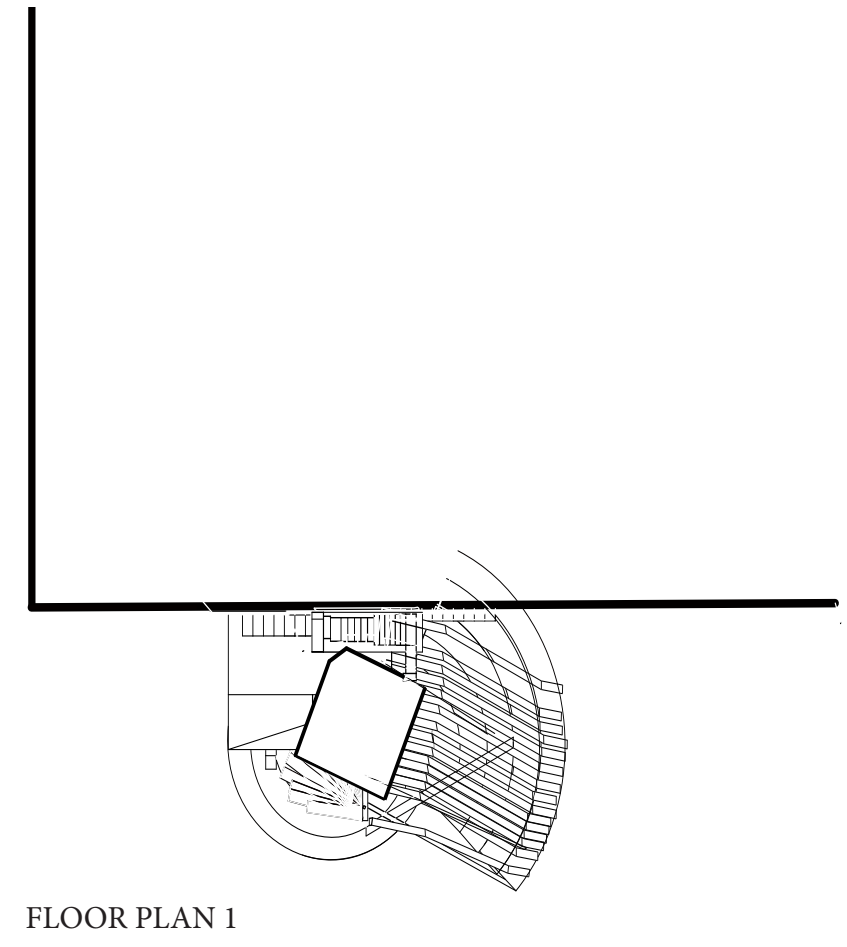

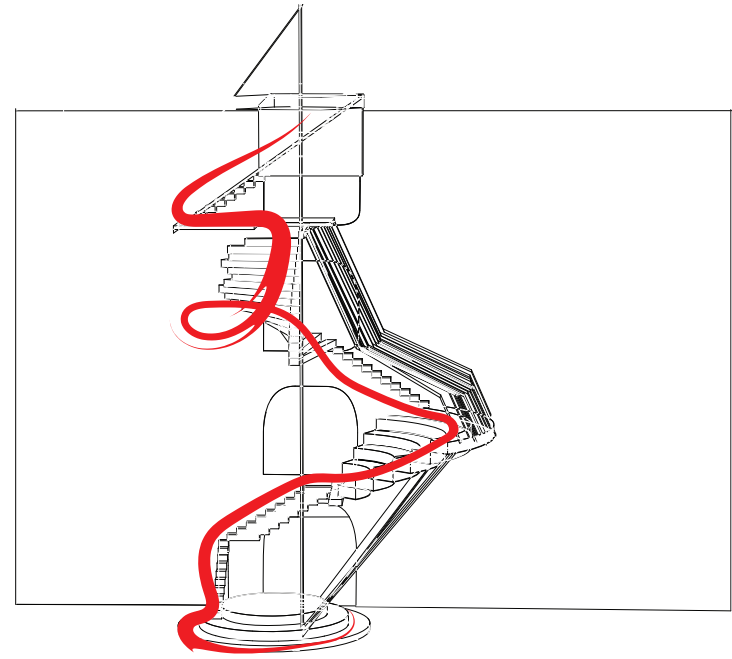

CIRCULATION

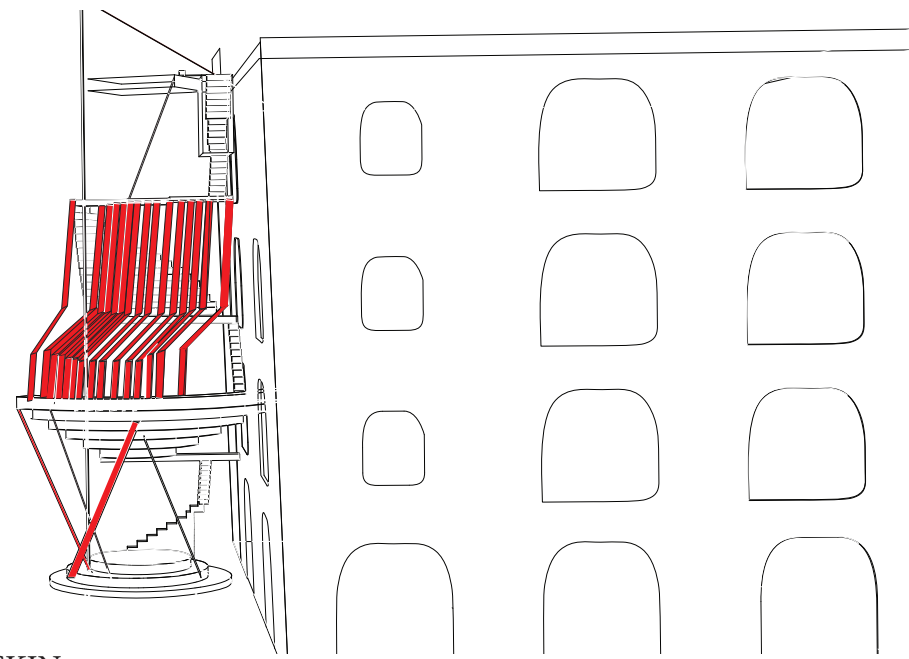

SKIN

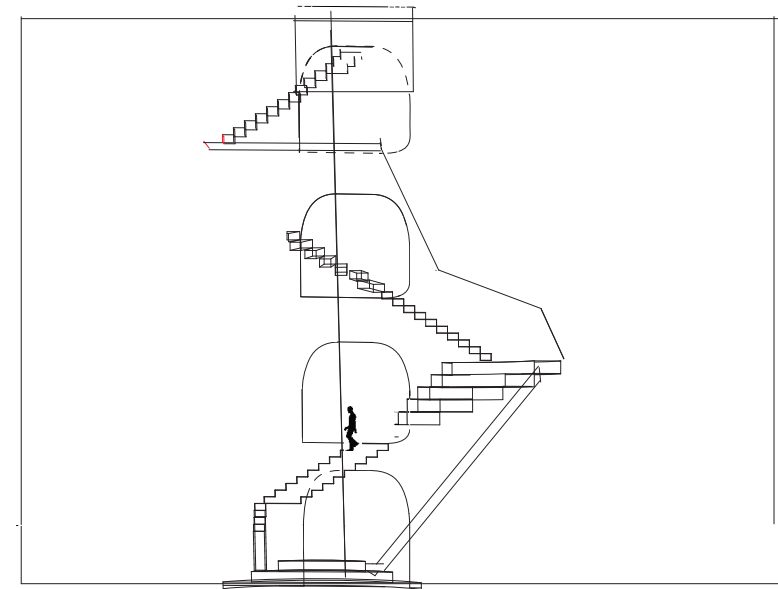

STRUCTURE

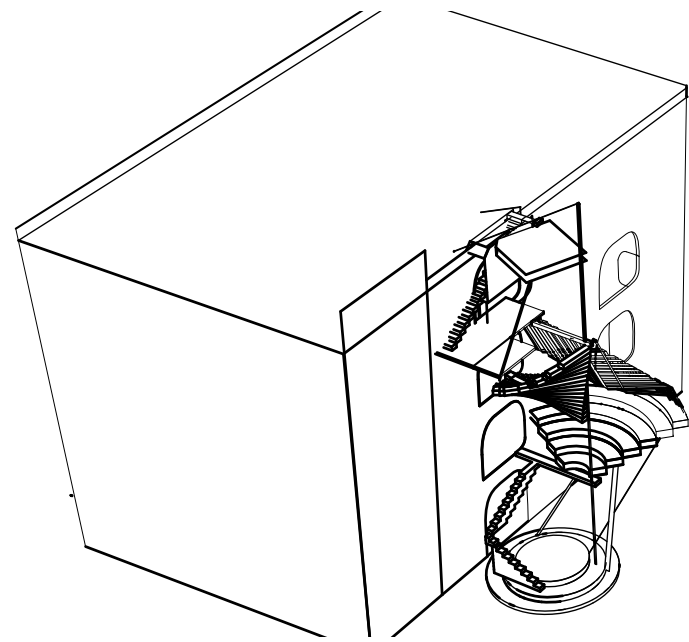

PROSPECTIVE

DAIGRAMS



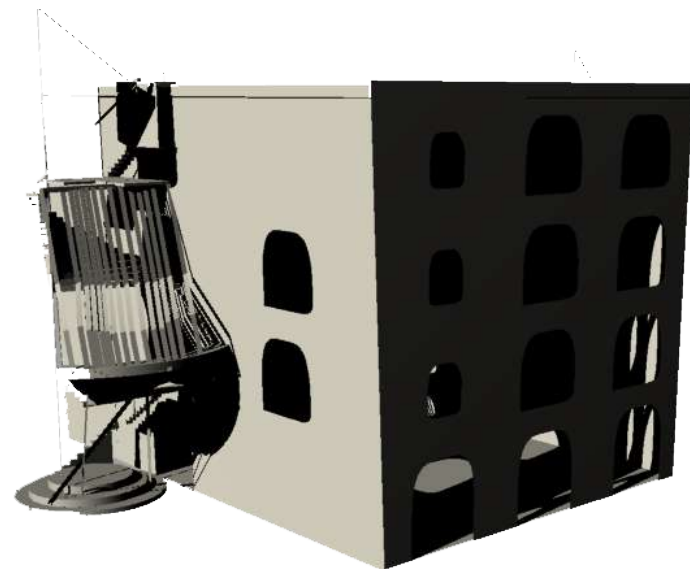
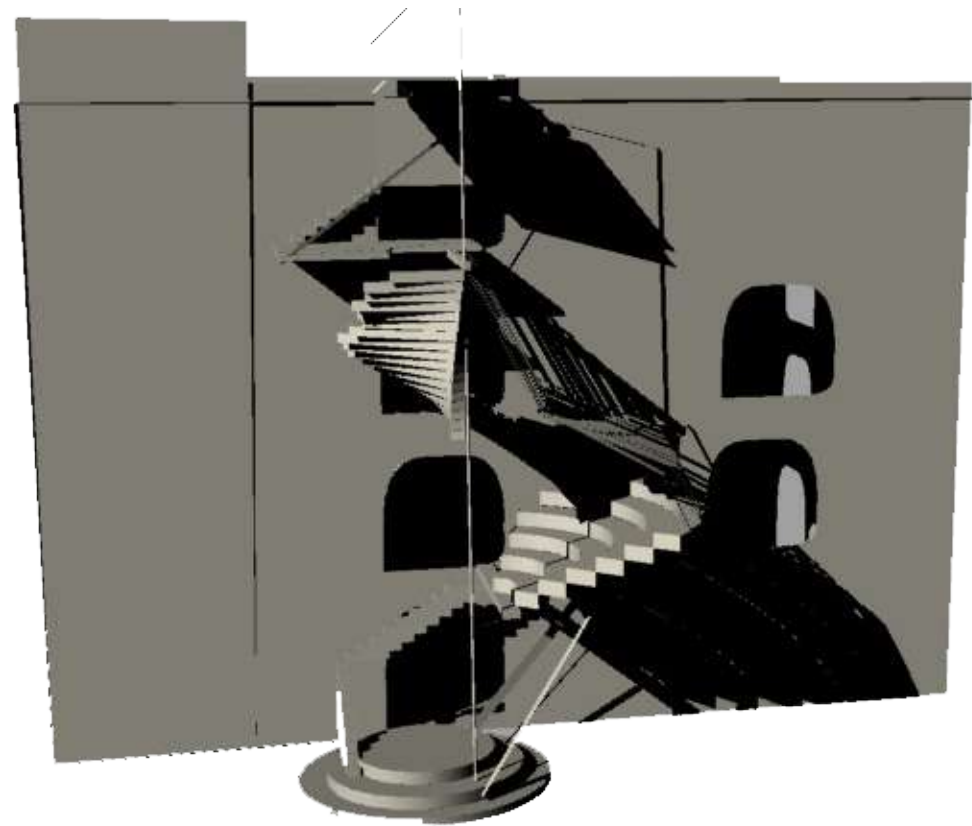

3-D RHINO MODEL

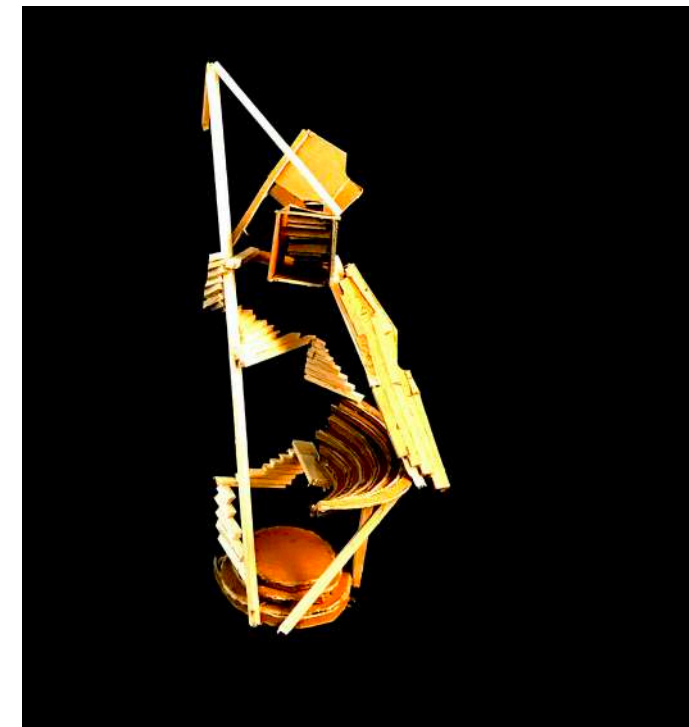
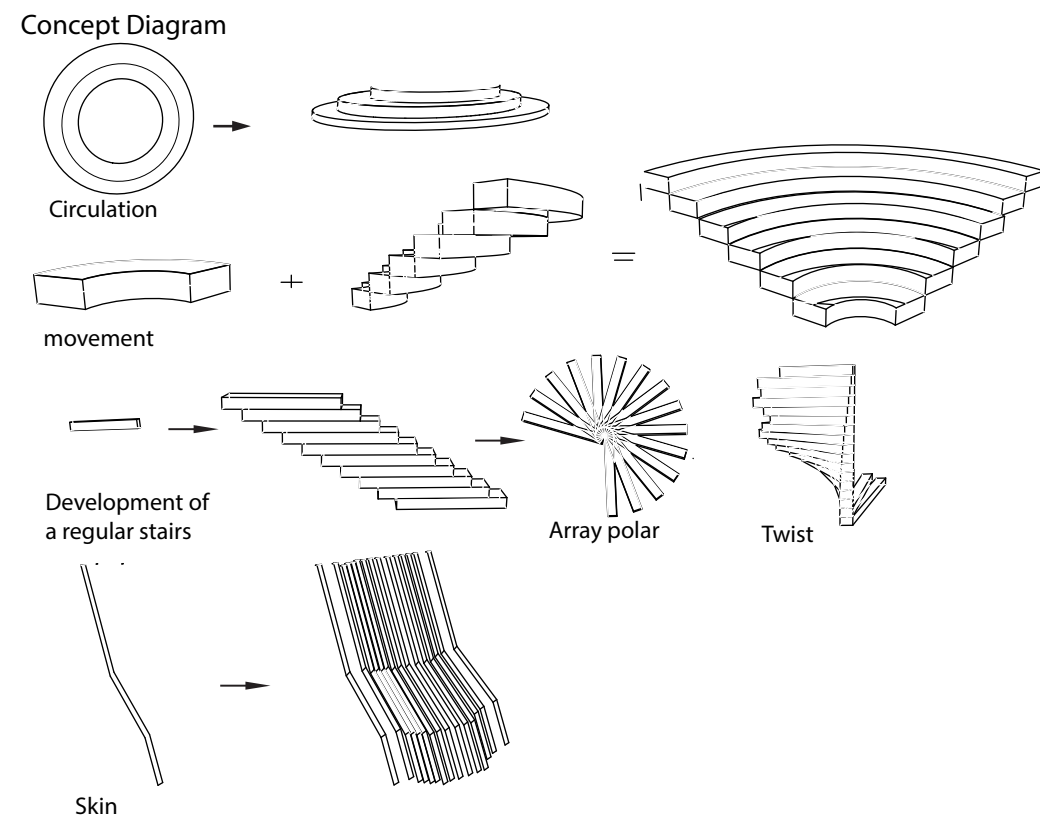

PROCESS WORK

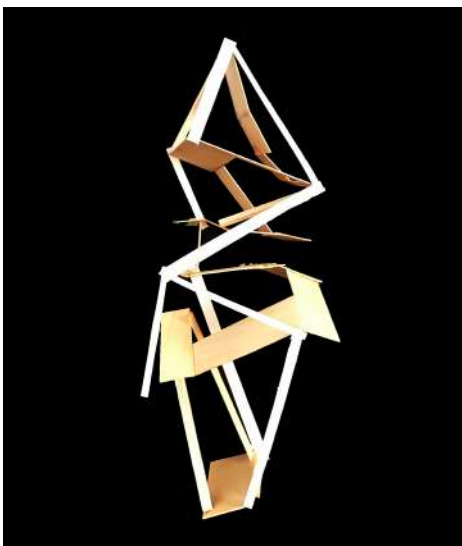
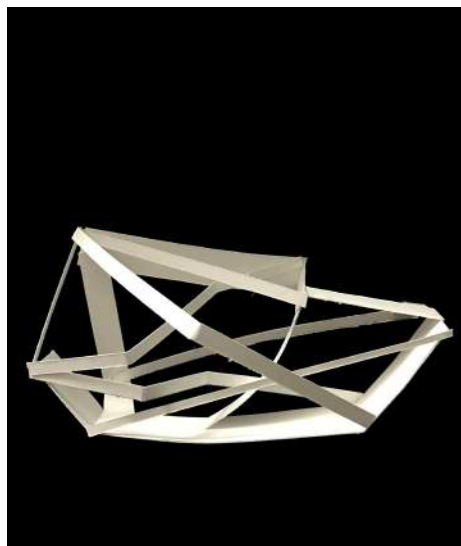
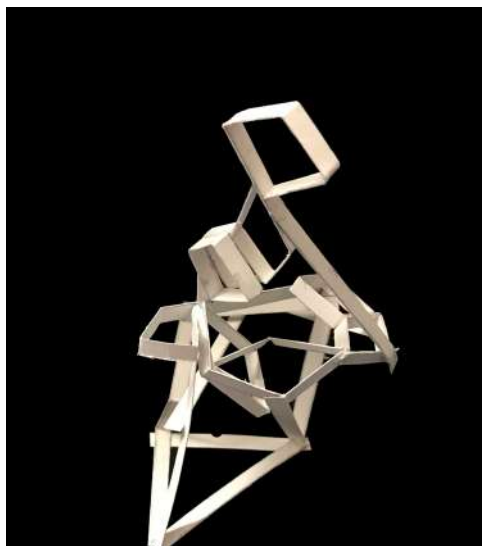
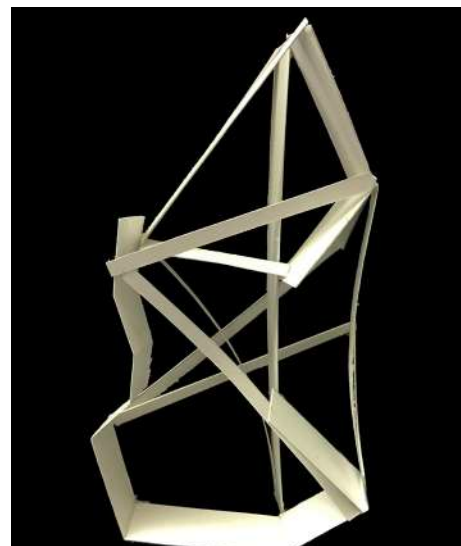
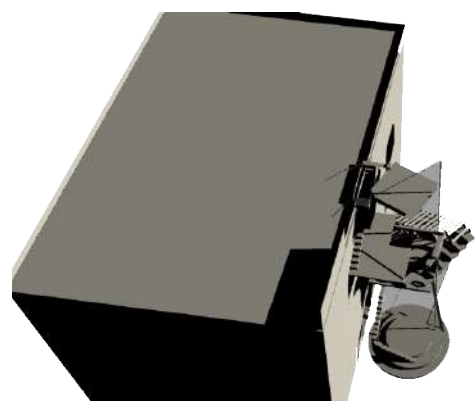
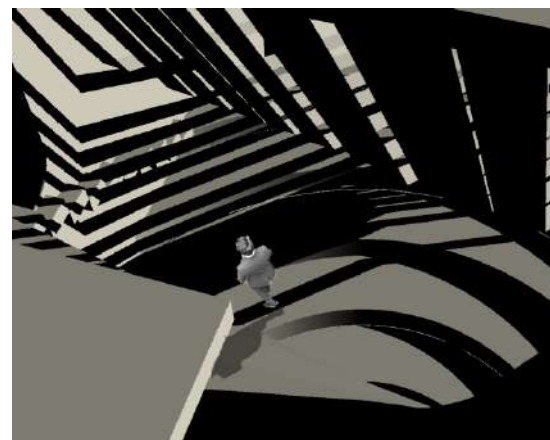

SURFACE, SPACE AND THRESHOLD

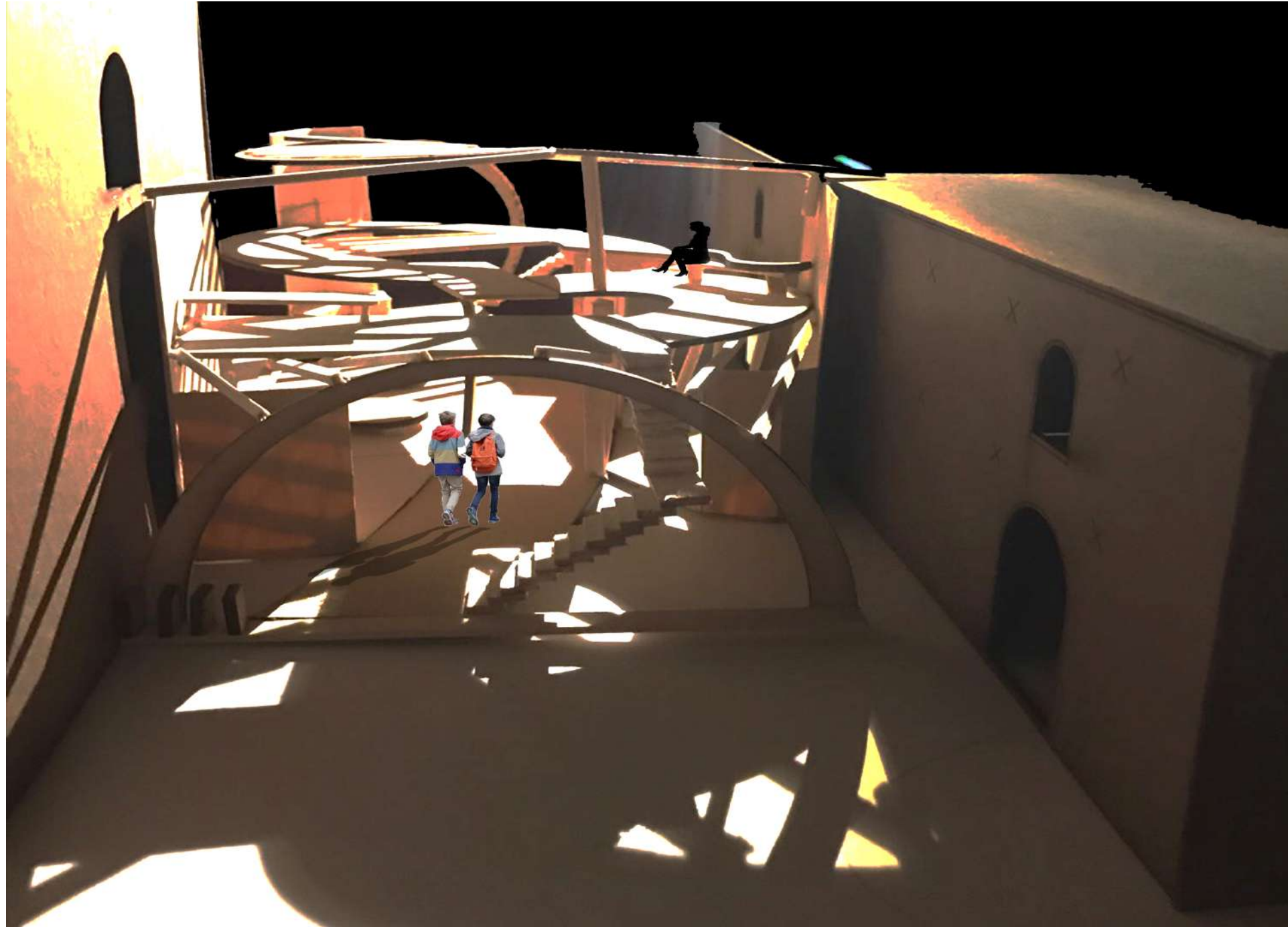

The threshold at the intersection of Old Dock Street and Water Street will serve as a link from the DUMBO neighborhood to the Brooklyn Bridge Park but also activate the existing Old Dock Street with program that connects with the community.

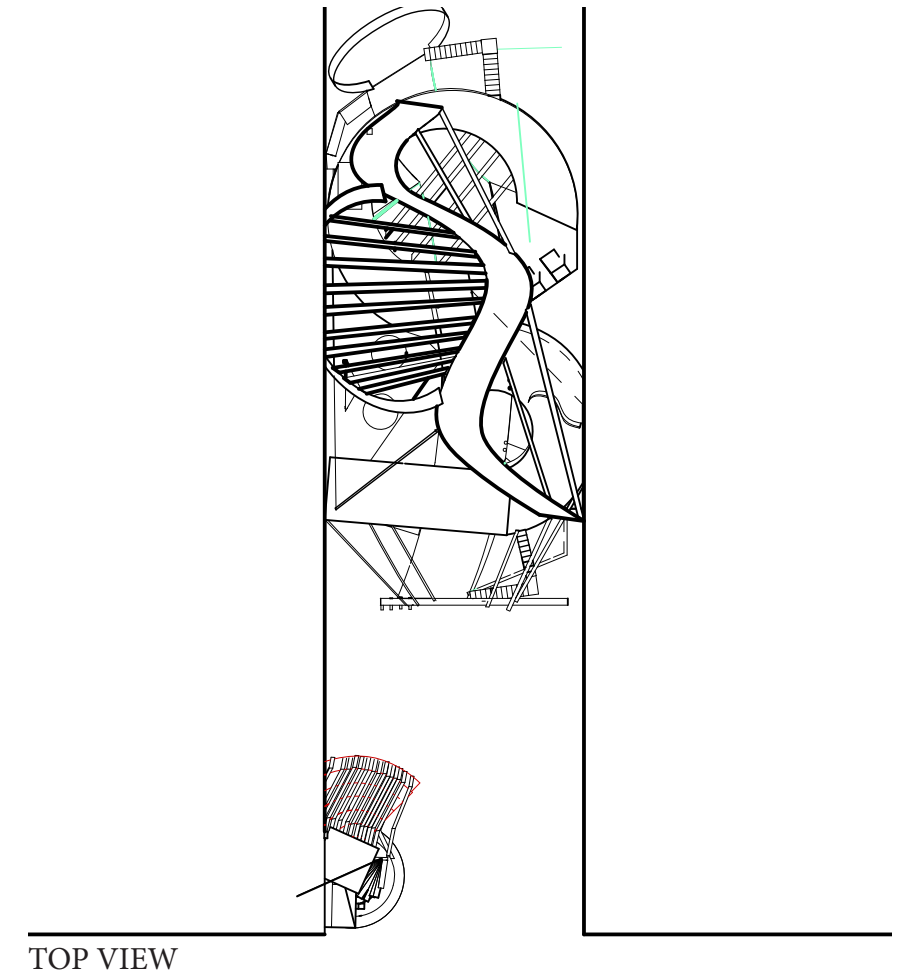
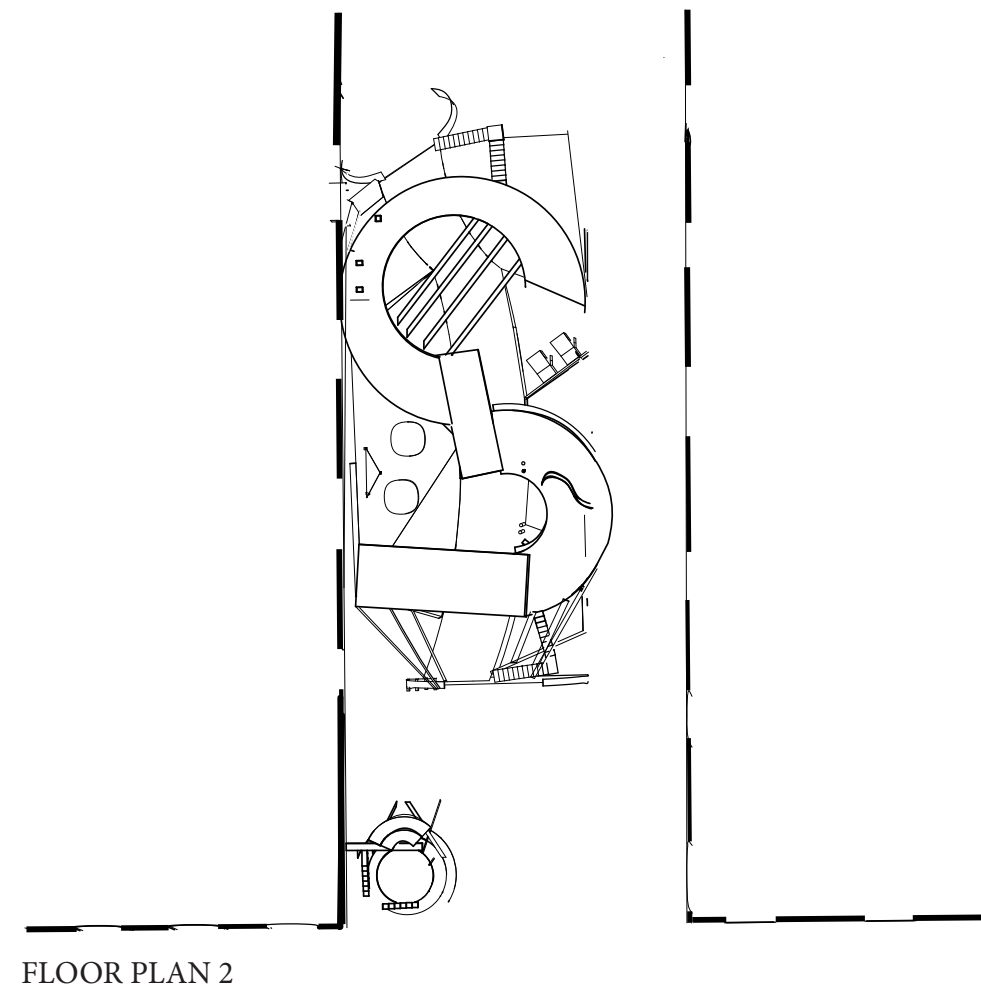
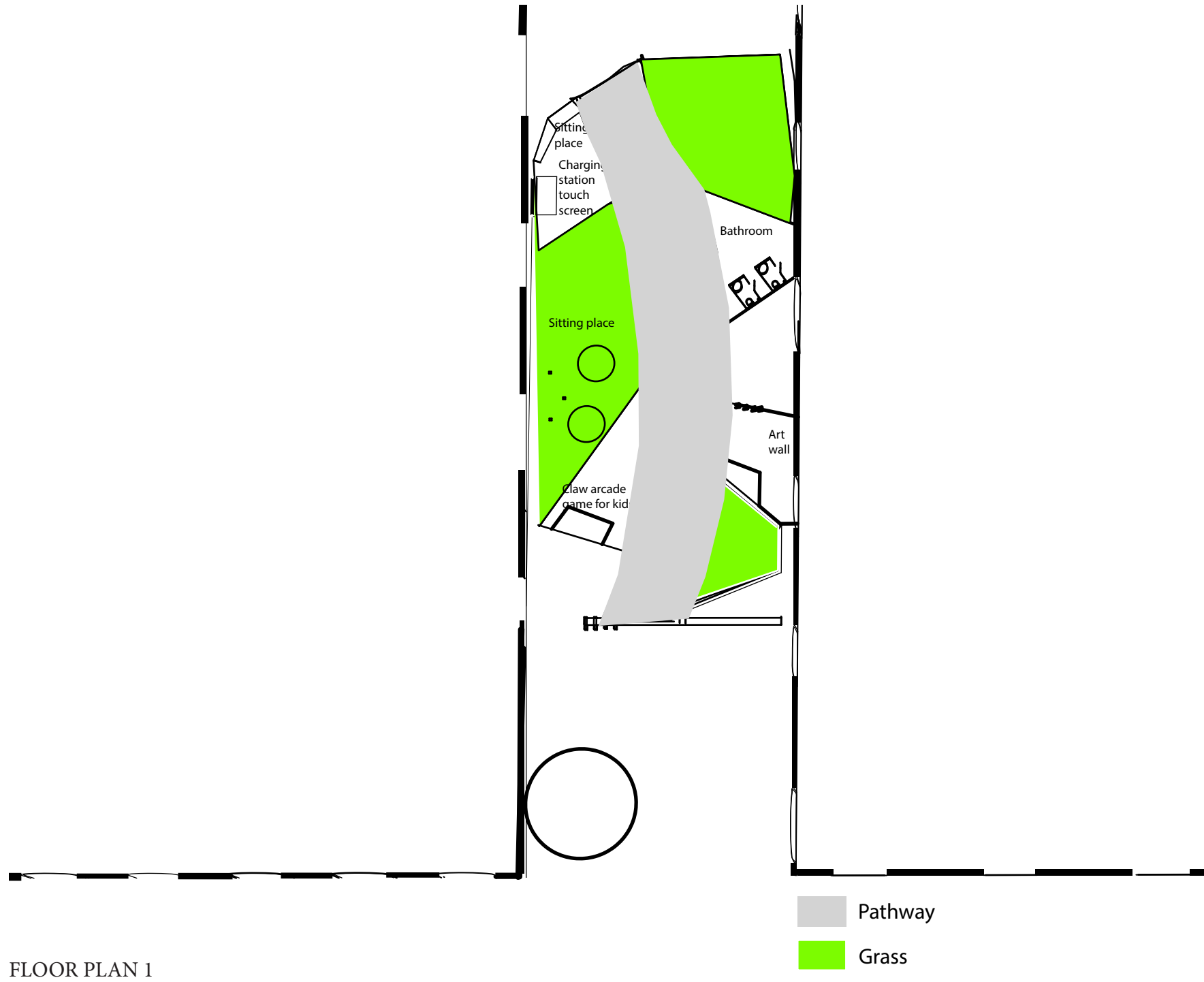

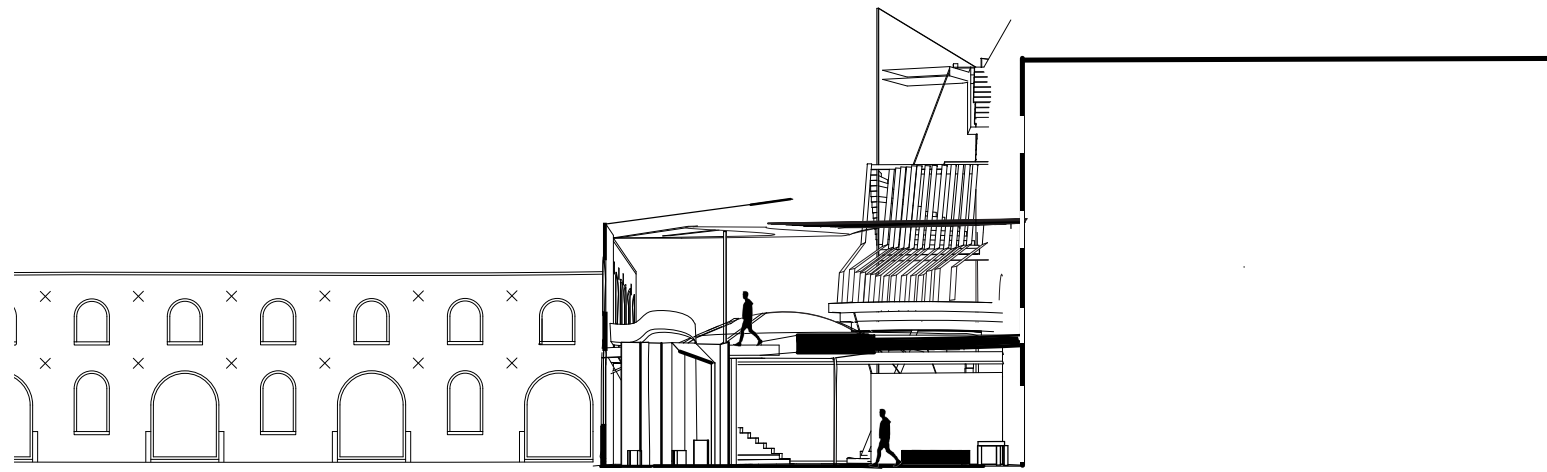

SECTION 1  
SCALE 3/16" = 1:0'

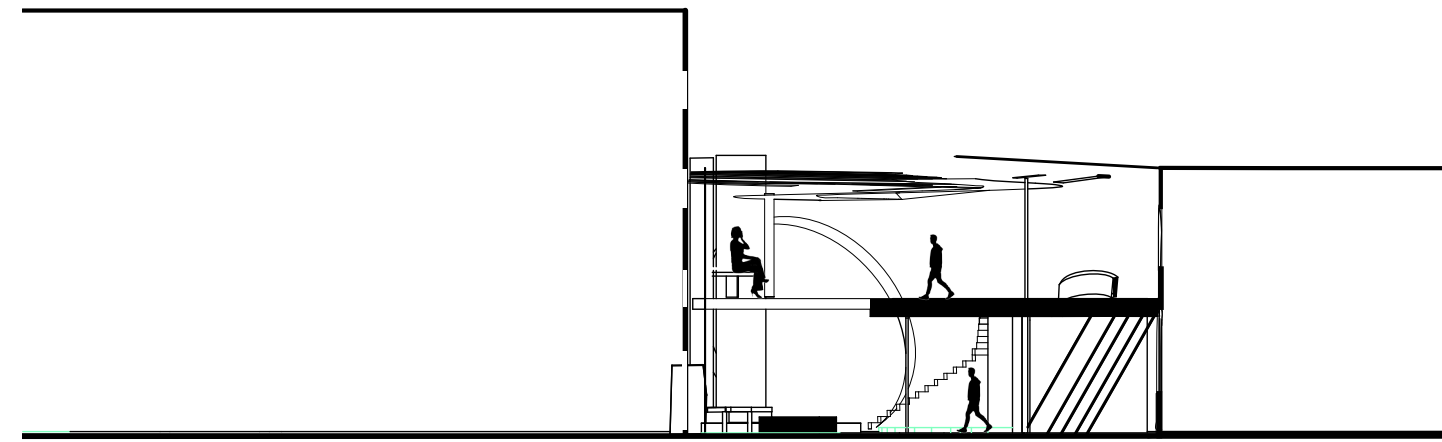

SECTION 3  
SCALE 3/16" = 1:0'

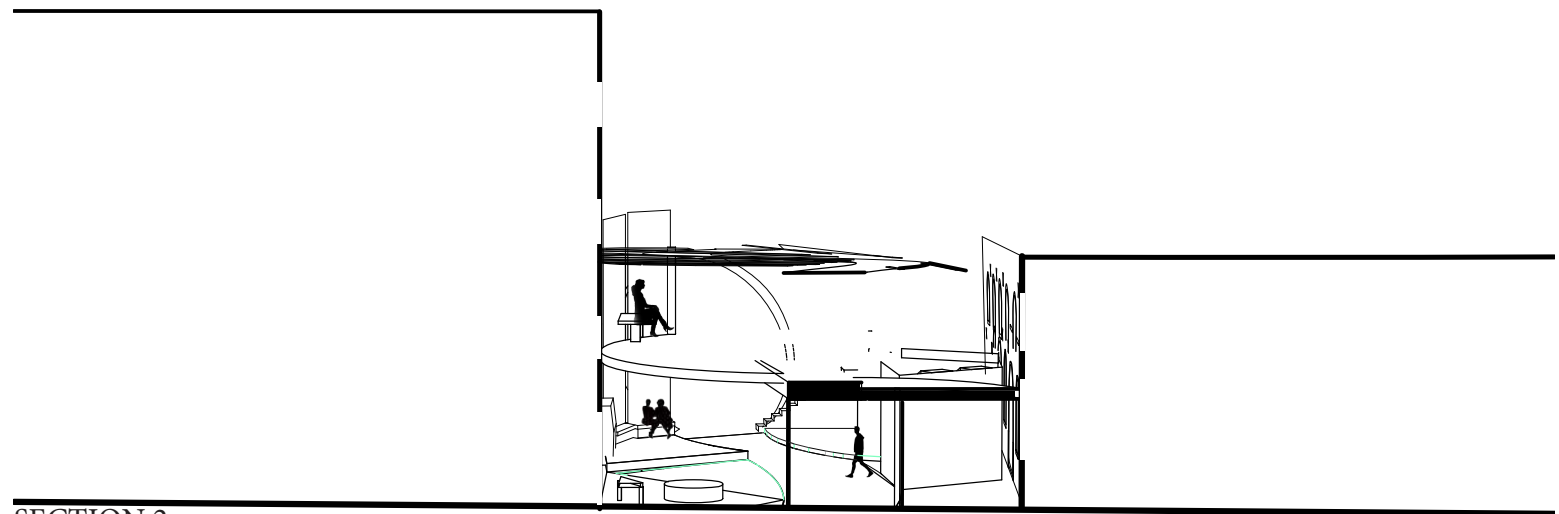

SECTION 2  
SCALE 3/16" = 1:0'

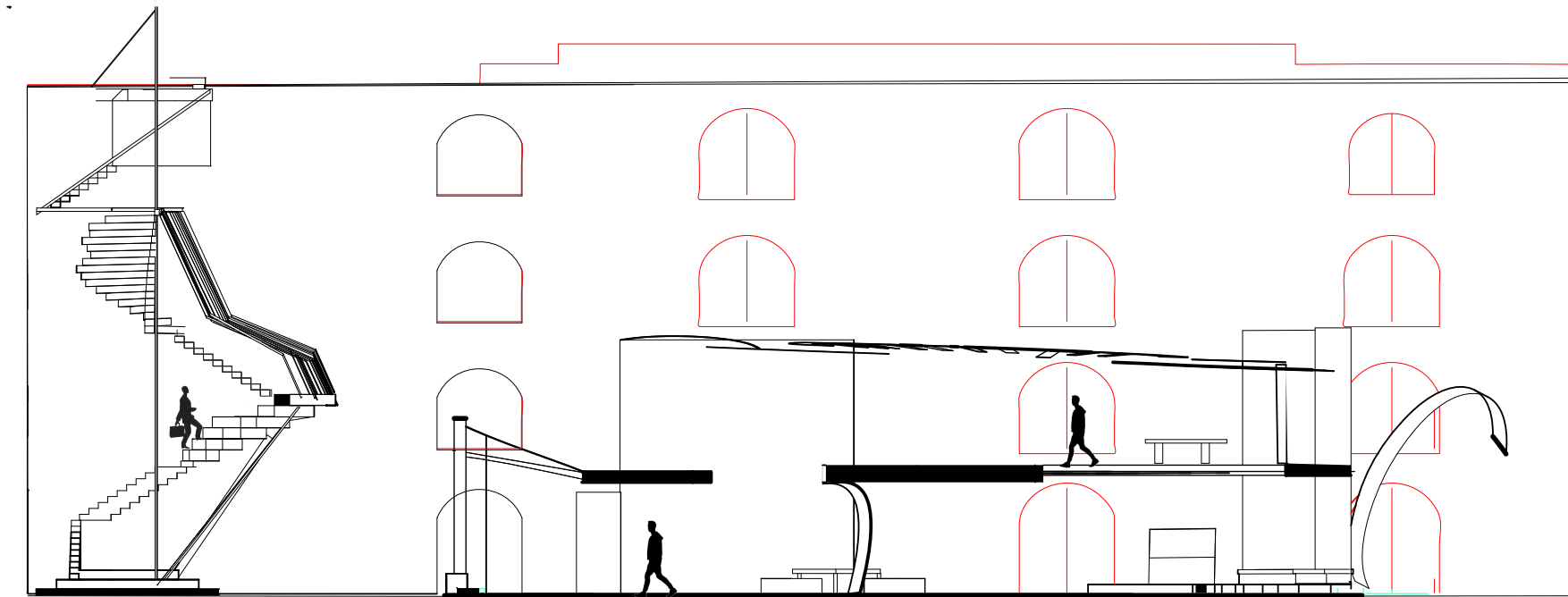

SECTION 4  
SCALE 3/16" = 1:0'

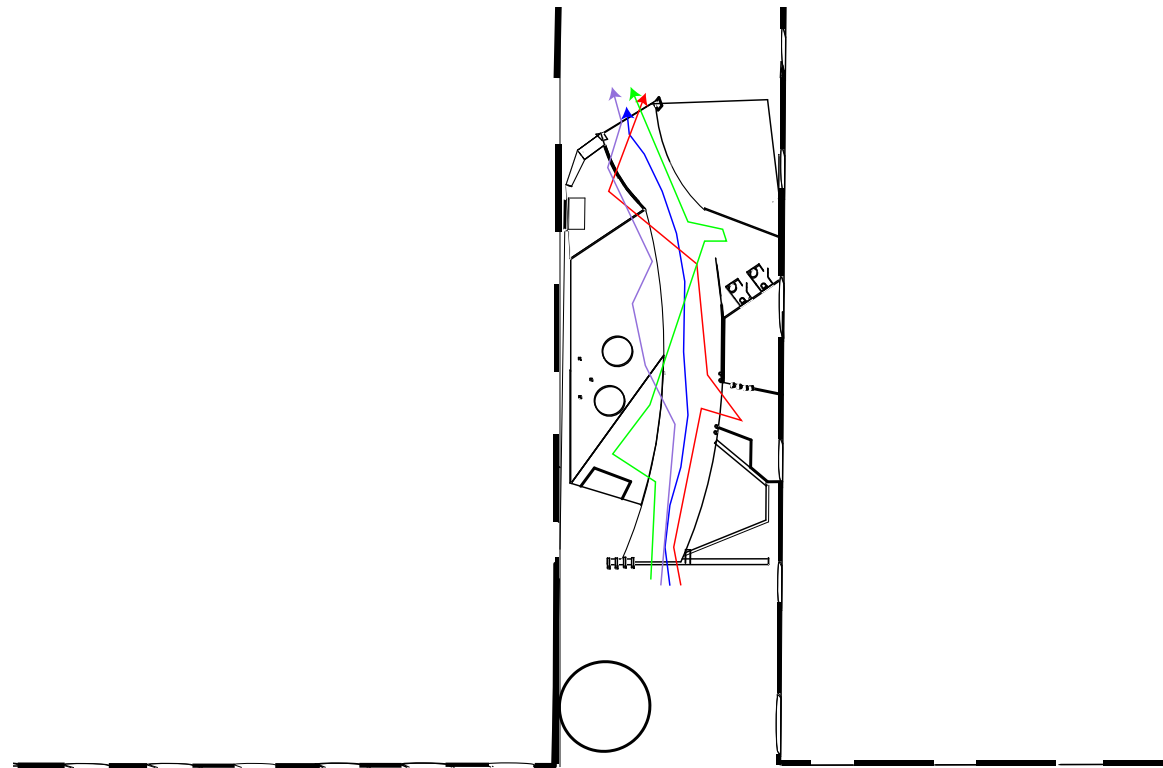

CIRCULATION

- biker
- tourist
- children
- local

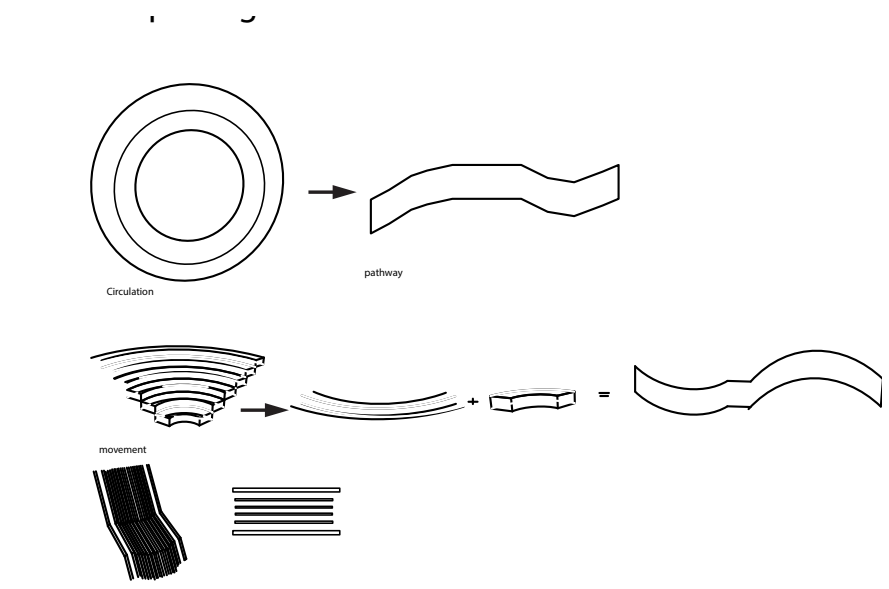

CONCEPT DAIGRAM

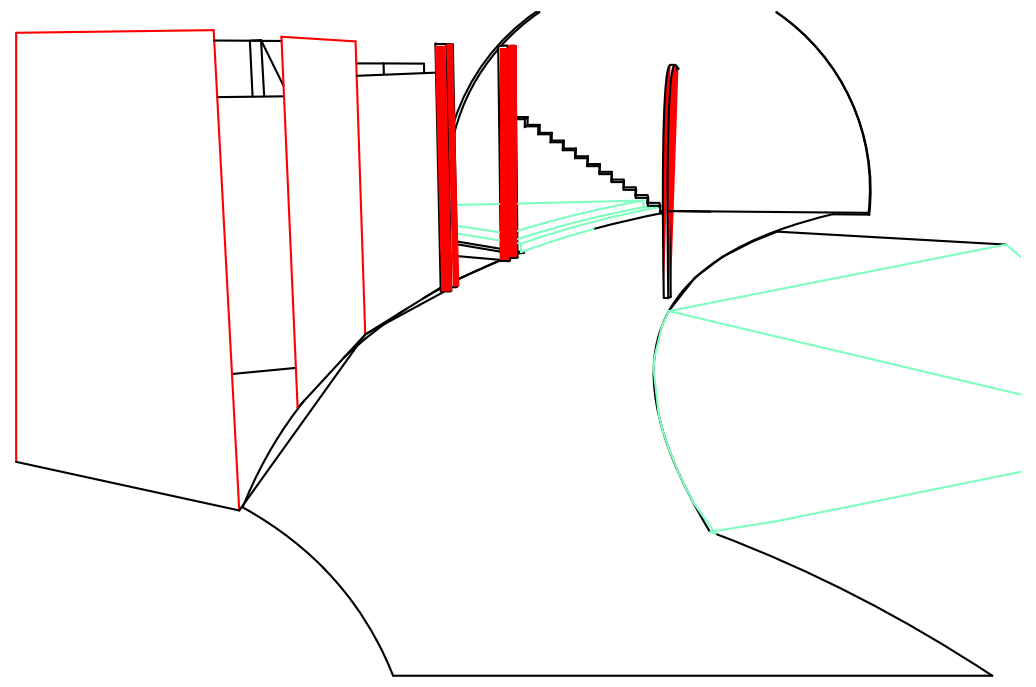

STRUCRURE

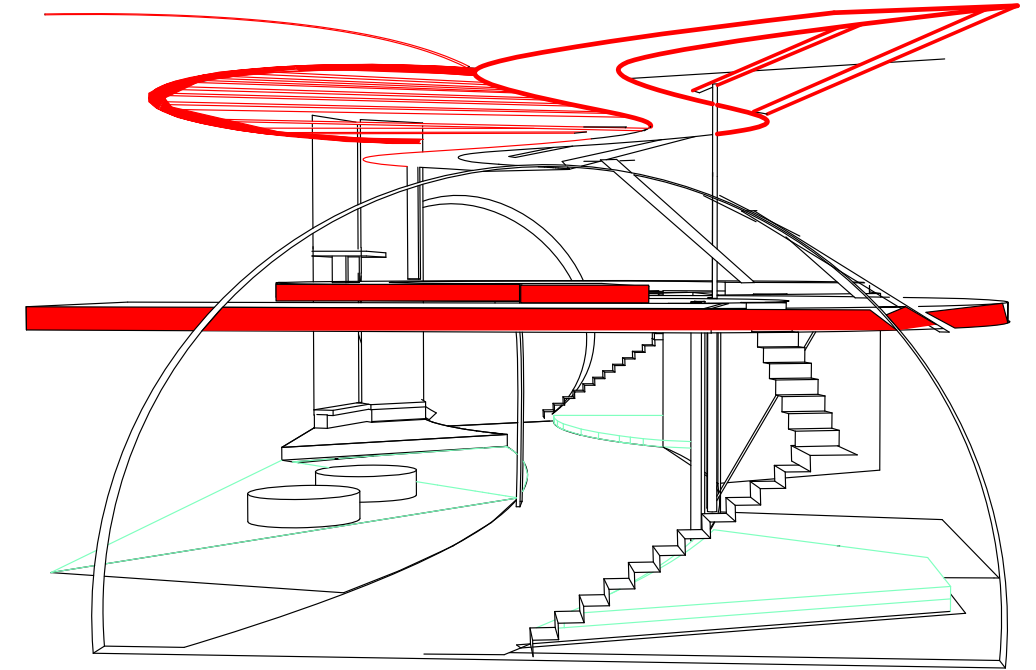

SKIN



section

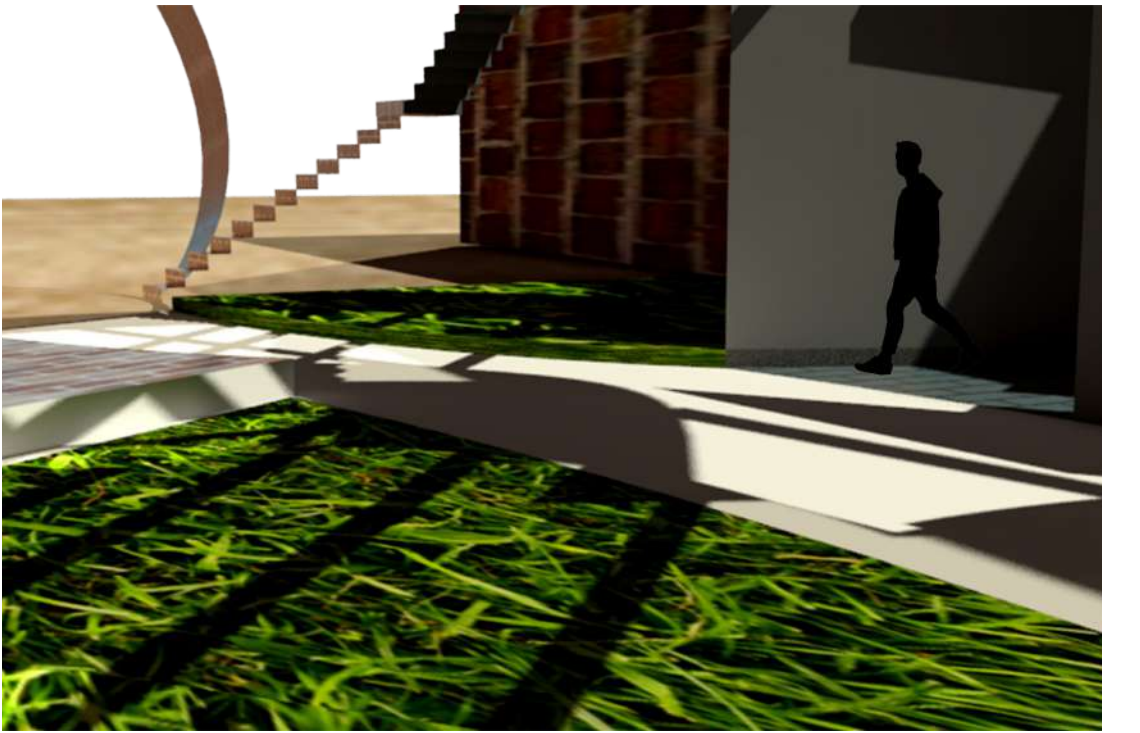



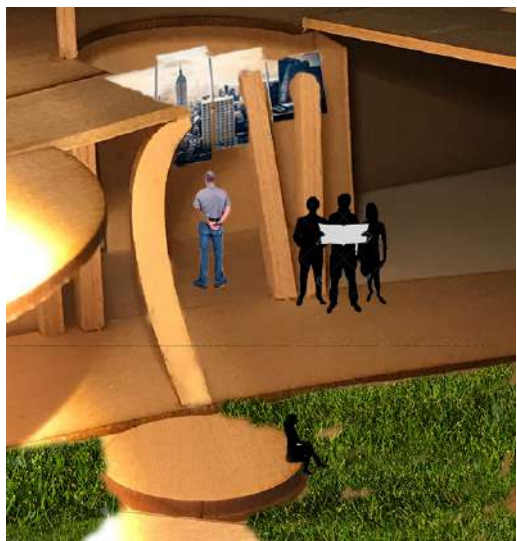
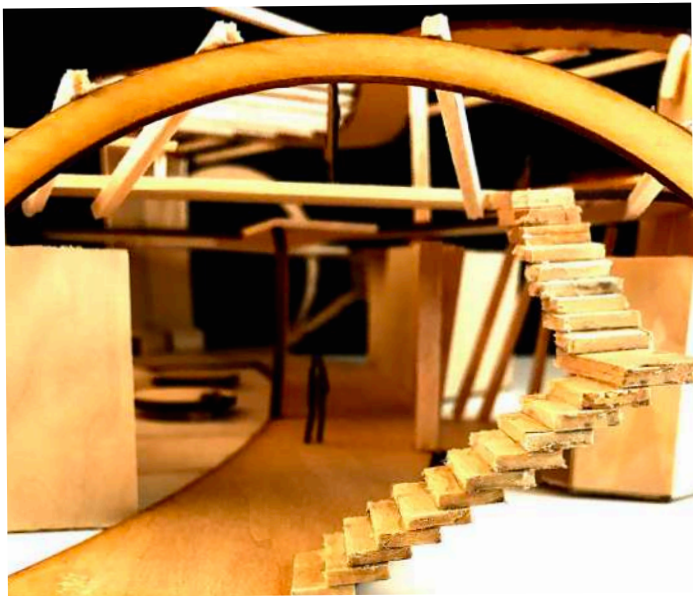
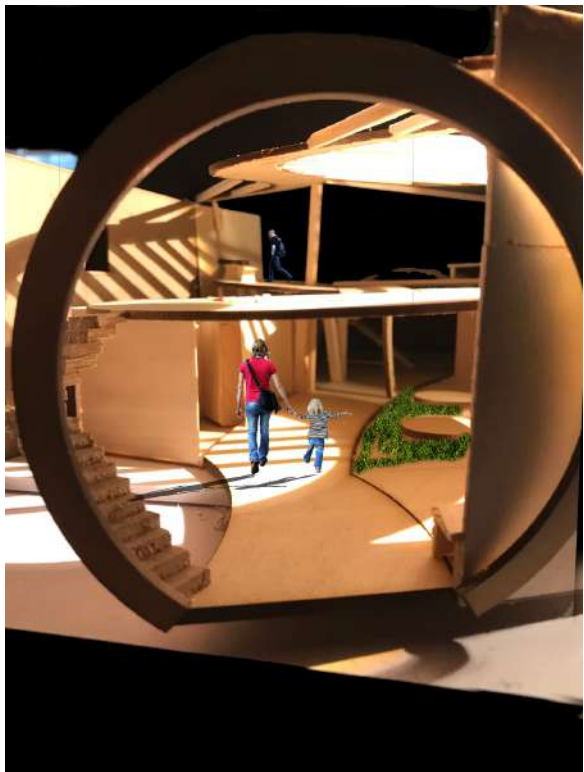

photos



PHOTOMONTAGE