

Arch 3690

Intermediate Computation and Fabrication

Tue. 11:30 pm - 1:30 pm | Fri. 11:30pm - 1:30pm

Prof. Joseph Vidich (jvidich@citytech.cuny.edu)

Prof. Charlie Able (cable@citytech.cuny.edu)

Department of Architectural Technology
New York City College of Technology
City University of New York
300 Jay Street, Brooklyn, New York 11201

ASSIGNMENT 02 OVERVIEW PRECEDENT: CONTEMPORARY MUSEUM FACADES

Often, within contemporary architecture, a particular building typology will offer its self as the ideal medium for the progression and implementation of new design techniques. In recent years, the museum has been host to many architectural innovations.

DUE: February 28th, 2014

In this assignment, you are to select (1) museum from the list below and prepare a thorough precedent study. Your research should include the following:

1. Basic facts (architect, location, year of construction, etc.)
2. Basic drawings (plans, sections, elevations, details, diagrams, etc.)
3. Organizational principles (why does the museum look and function the way it does?)
4. Relationship between exterior and interior (e.g. how does the building deal with light and temp?)
5. Facade concepts (why does the facade look the way it does - how do you interact with it?)
6. Construction techniques used in the facade (how did they make it?)
7. Digital vs. Analog techniques (what parts were CNC and what parts were done by hand?)

DO NOT limit your research to internet sources alone - often, internet articles only scratch the surface. For in-depth research, you may need to look at publications such as *el croquis*, *Mark Magazine*, *Praxis*, *Detail*, etc. Also, not all the museums in the list below relied on digital fabrication. If you select one of these buildings, you should be prepared to discuss the ability to translate the analog techniques into the digital world.

What you need to bring to the project review:

1. PDF presentation of your research, posted to the class website prior to class, and ready to be presented to the class



1. Broad Art Museum, Lansing
by Zaha Hadid



2. Broad Art Museum, Los Angeles
by Diller Scodidio + Renfro



3. de Young Museum
by Herzog & de Meuron



4. Contemporary Art Centre Cordoba
by Nieto Sobejano Arquitectos



5. Dalian International
Conference Center
by Coop Himmelb(l)au



6. Elbphilharmonie
by Herzog & de Meuron



7. Herta and Paul Amir Building
by Preston Scott Cohen



8. Janus, Rapperswil-Jona
Municipal Museum
by mlzd



9. Jewish Museum, Berlin
by Daniel Libeskind

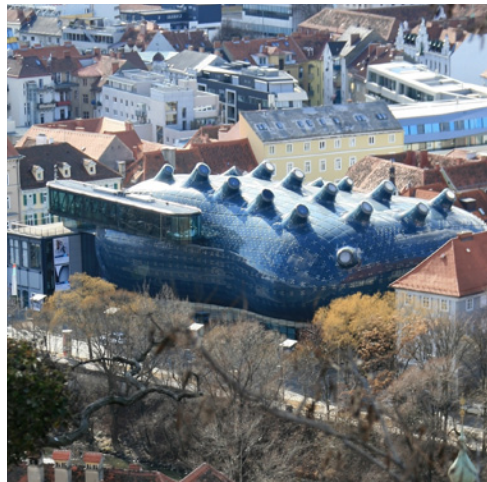

10. Kunsthaus Graz
by Peter Cook / Colin Fournier



11. Messe Basel Exhibition Hall
by Herzog & de Meuron



12. New Museum of Contemporary Art
by SAANA



13. Ningbo Historic Museum
by Wang Shu



14. Ordos Museum
by MAD Architects



15. Perot Museum of
Nature and Science
by Morphosis



16. San Telmo Museum
by Nieto Sobejano Arquitectos



17. Titanic Museum, Belfast
by CivicArts / Todd Architects

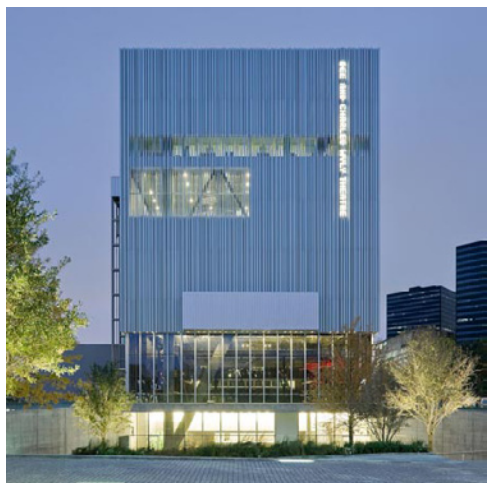

18. Wyly Theater
by REX / OMA