

Learning Places Fall 2016  
Chin/Swift

# **SITE REPORT [part 2: place]**

## **Lincoln Center- Metropolitan Opera House**



JOSUE ALBERTO

09.30.2016

### **INTRODUCTION**

Lincoln Center is known for its unique architecture located in the busy city of New York. It is a place where performance it's welcomed through the realms of architecture and space. The Lincoln Center is a performing arts theater that promotes classical performances such as ballet, contemporary dance and opera. It also promotes performances from visitors and spectators.

## PRE-VISIT REFLECTION

Before visiting Lincoln Center, I thought we were going to look at concert halls and determine how the architecture of the theatre or hall would influence the performance for both the performer and audience. I assumed that it would have been at least halfway as crowded as Times Square, full of tourist attempting to capture the essence of the theatrical atmosphere,

## SITE DOCUMENTATION (photos/sketches)

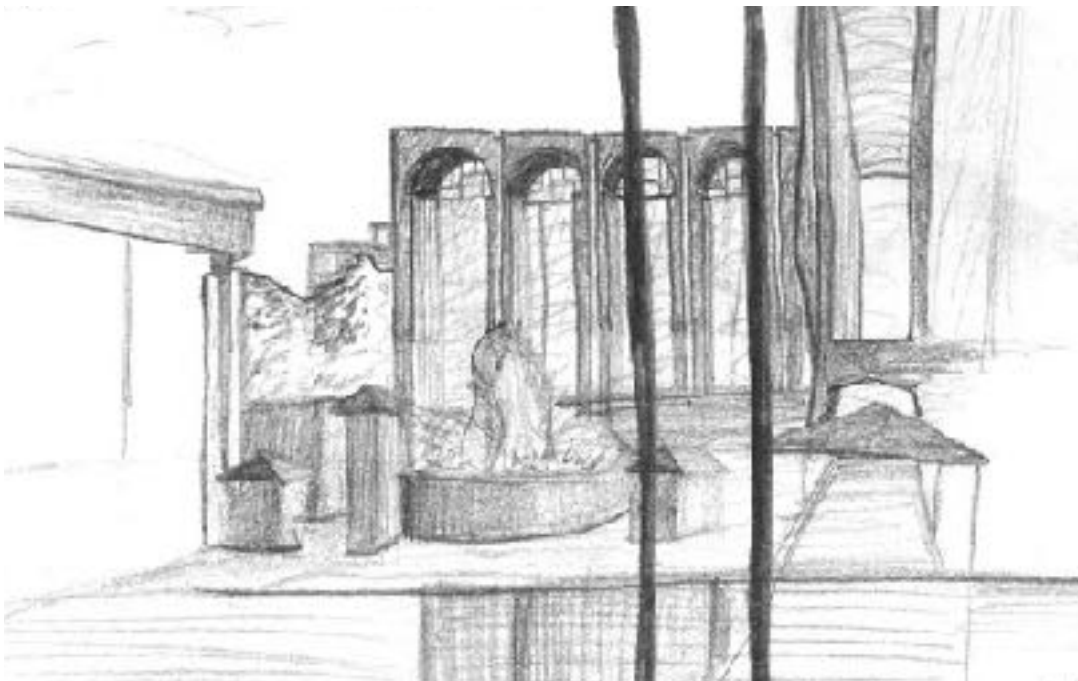

## QUALITATIVE SITE OBSERVATIONS

### 1. Neighborhood / Street Character

- a. Prestigious
- b. spacious

### 2. Vitality of Place

- a. General Description
  - i. Bleak
- b. Pedestrian Activity
  - i. none
- c. Vehicular Traffic
  - i. plentiful

### 3. Age of Buildings (provide evidence for prediction)

- a. The Metropolitan Opera House- 45 years old
- b. New York philharmonic- 54 years old
- c. The New York State theater (NYC ballet) – 52 years old (all dates from [newworldencyclopedia.org](http://newworldencyclopedia.org))

### 4. Relationship Between Buildings (urbeme)

- a. Grandiose
- b. Observant

### 5. Building Details (historical/architectural styles, morphemes)

- a. All started construction around the 50s
- b. First building to be built was the New York Philharmonic
- c. Buildings made of travertine

### 6. Building Uses

- a. Performing arts
- b. High class events

## QUANTITATIVE DATA for Area of Study

Subject	Data
Street Names	Lincoln center/ Lincoln center for the performing arts
Street Width	N/A
Pavement Type	Concrete
Building Heights	14 stories
Building Widths (Window Bays)	N/a
Building Types/Uses	Plays/operas/orchestras/ballet
Empty Lots / Gardens	Lincoln center parking/Heart Plaza
Shops / Restaurants	Retail stores, Restaurants , Broadway theaters
Industrial Shops	None
Other Data	One NYC public Library
Other Data	Many spaces for Performance

## QUESTIONS TO RESEARCH FURTHER

### QUESTIONS:

1. What are the different buildings of the Lincoln center?
2. Who were the different architects?
3. What was the history of each building?

### RESEARCH METHOD/SOURCE FOR EACH QUESTION ABOVE:

1. Question 1
  - a. <http://www.metopera.org/user-information/new-york-times-article/http://www.lincolncenter.org/i>
2. Question 2
  - a. <http://www.lincolncenter.org/visit>
  - b. <http://www.lincolncenter.org/>
3. Question 3
  - a. <http://www.lincolncenter.org/>
  - b. [https://en.wikipedia.org/wiki/Lincoln\\_Center\\_for\\_the\\_Performing\\_Arts](https://en.wikipedia.org/wiki/Lincoln_Center_for_the_Performing_Arts)

## SUMMARY / POST VISIT REFLECTION

The Lincoln center trip was great even though it raining that day. I was fascinated by the beauty of the Metropolitan Opera House, and of Lincoln Center in general. The design of each building shows the uniqueness and attractiveness of the area. I also got to know more about the area around the Lincoln Center as well as the history of the complex. However, the warm rich tones of the interior felt royal. Although the site drew the attention of the audience, I am not sure if its strong design invited people of all classes. I can certainly say that I myself did not feel like I belonged, There is a greater sense of importance and scale with the buildings, which every other one around the area, slowly becomes modern and equal in construction. The entire area almost screams performance, I guess that is what earned the area the title of "Lincoln Center for the Performing Arts".