



The Tempest

Set Design

by

Christopher Adams

Table of Contents

- Concept Development
- Research and Rendering
- Technical Drawings
- Materials
- Color Palettes
- Additional Rooms
- Budget

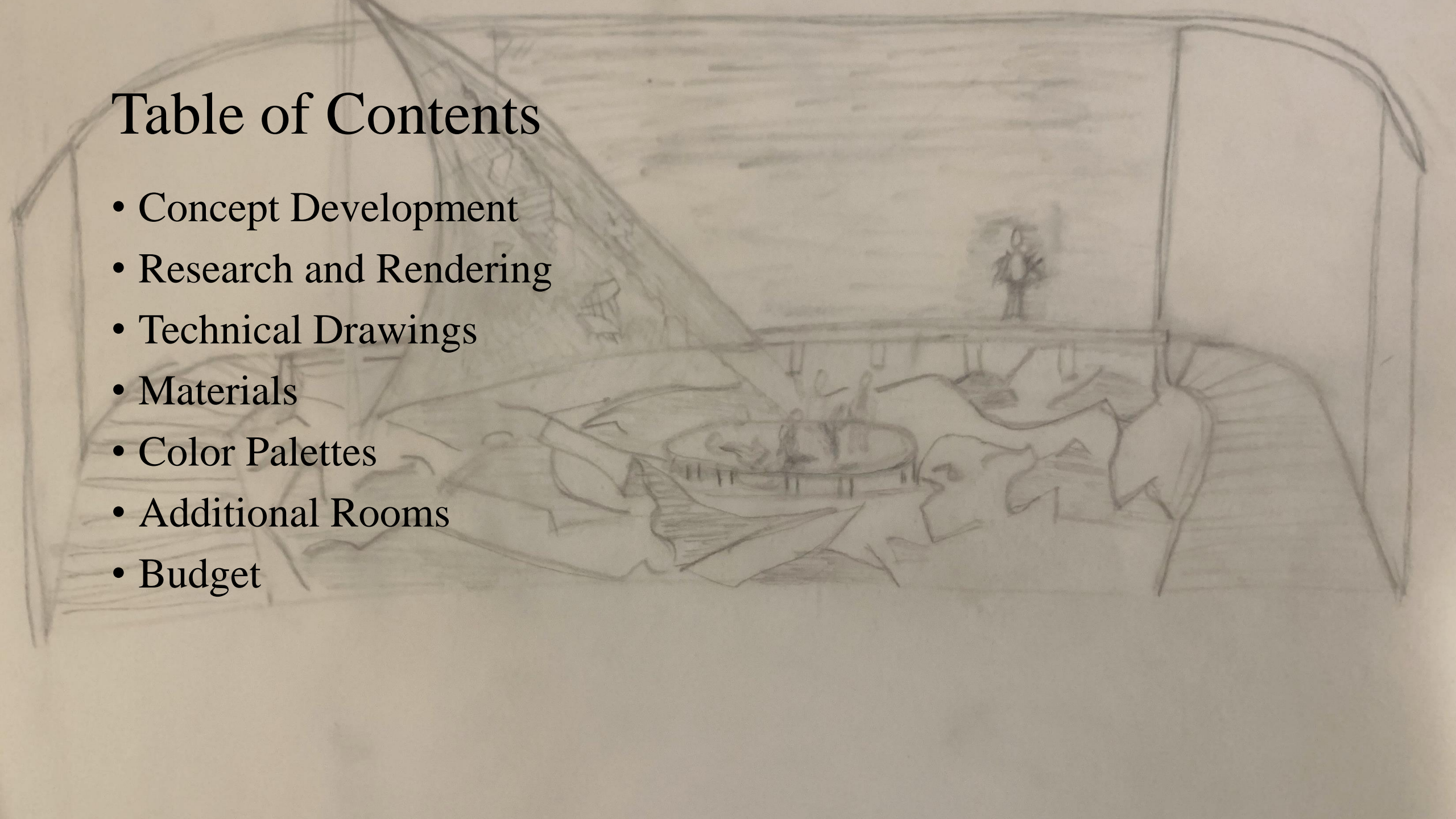

Concept Development

The goal was to develop a set design loosely based on the play *The Tempest*. The set design was inspired by immersive dance shows such as *Fuerza Bruta*, *Sleep No More*, and attractions like *The Gravesend Inn* and the *Arcadia Earth Museum*. I was interested in highlighting how an everyday material such as a TARP can be used as a focal point for a set design. The idea for the show is that audience members get choose their own adventure by following any character their choosing.



Research and Renderings

- Reading *The Tempest*.
- The Raft of the Medusa
- The NY Public Library Picture Collection

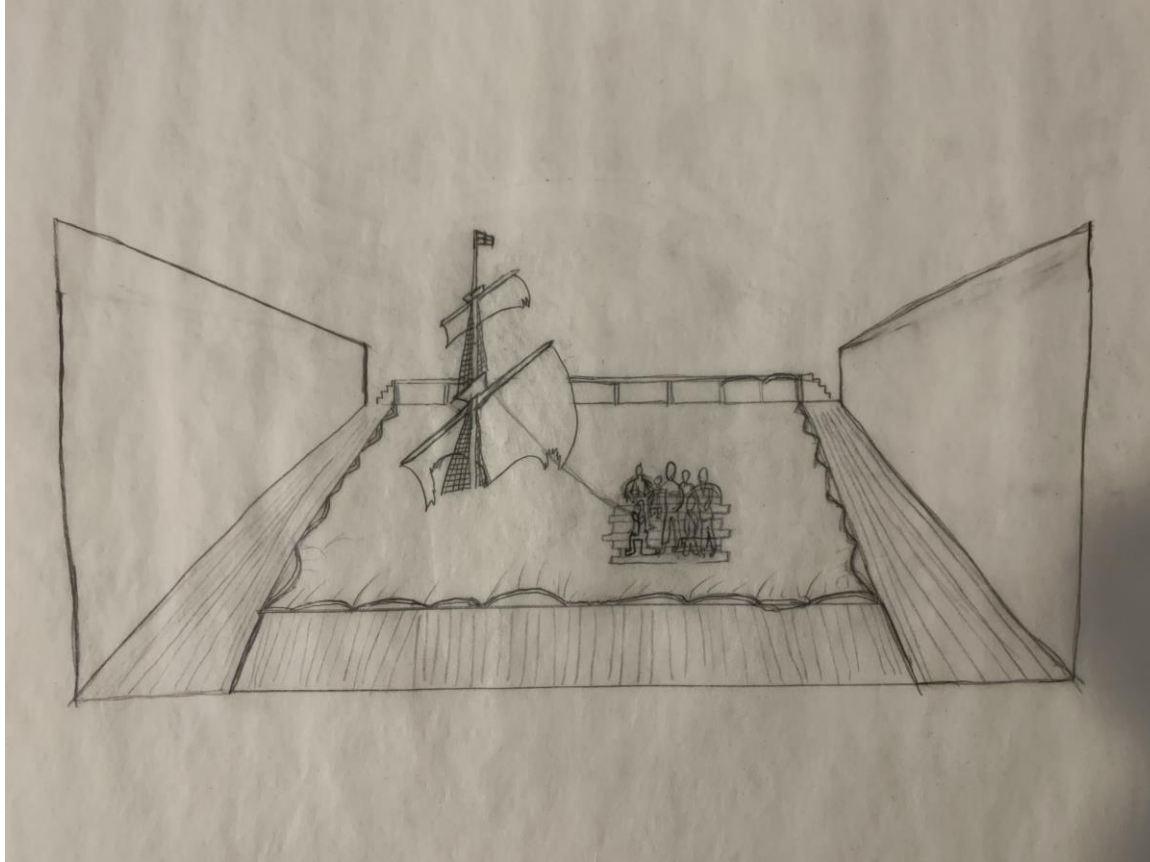

Raft of the Medusa by Théodore Géricault

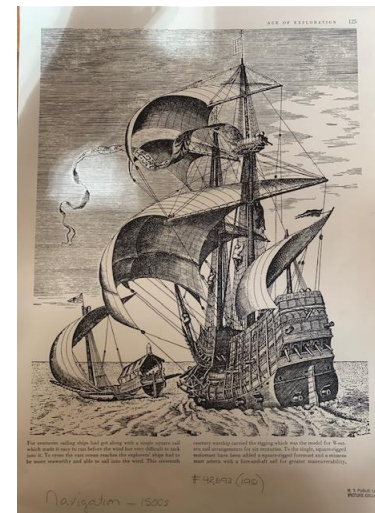

Technical Drawings

- Venue: Chelsea Factory
- Location: 547 West 26th Street
- 69'-2" Width X 48' Depth
- Set Design Dimensions 40' x 40'

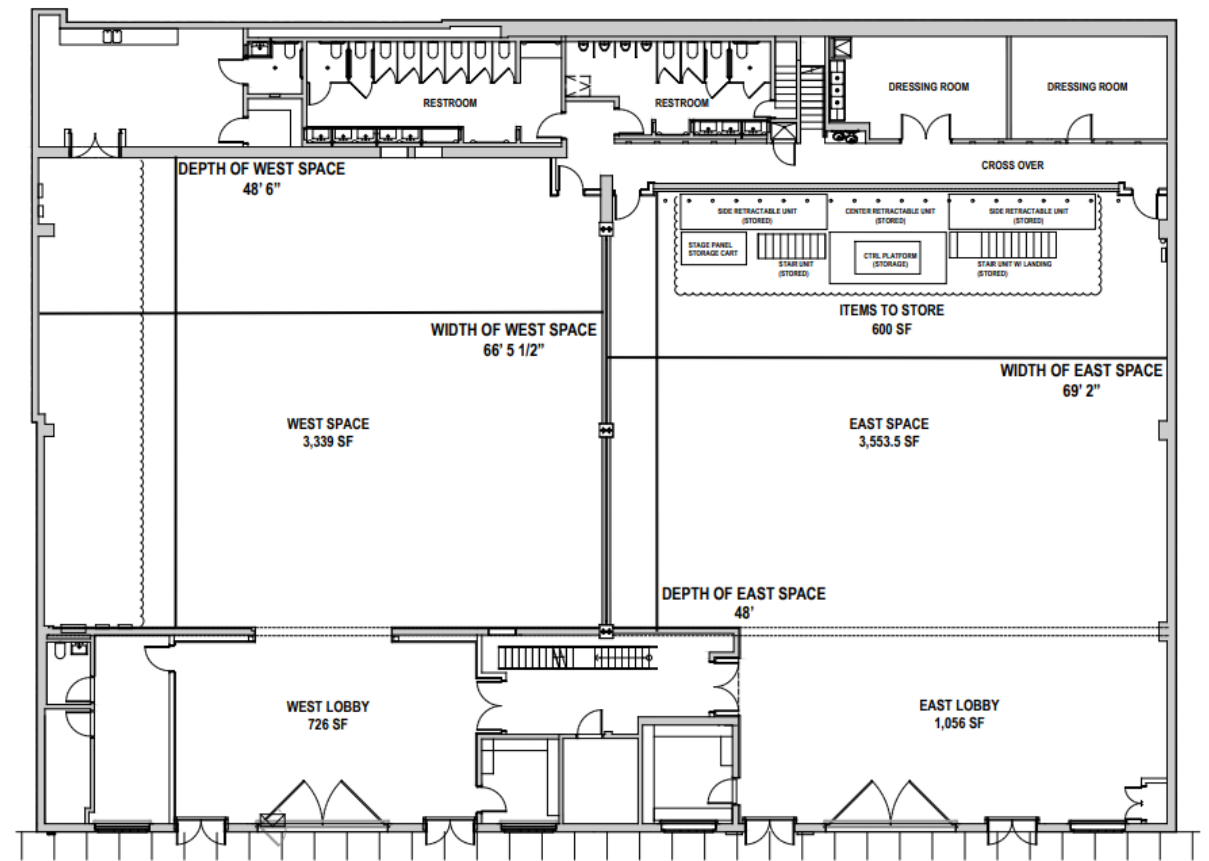

GROUND FLOOR OPTION 02 - SEPARATED SPACES



Technical Drawings

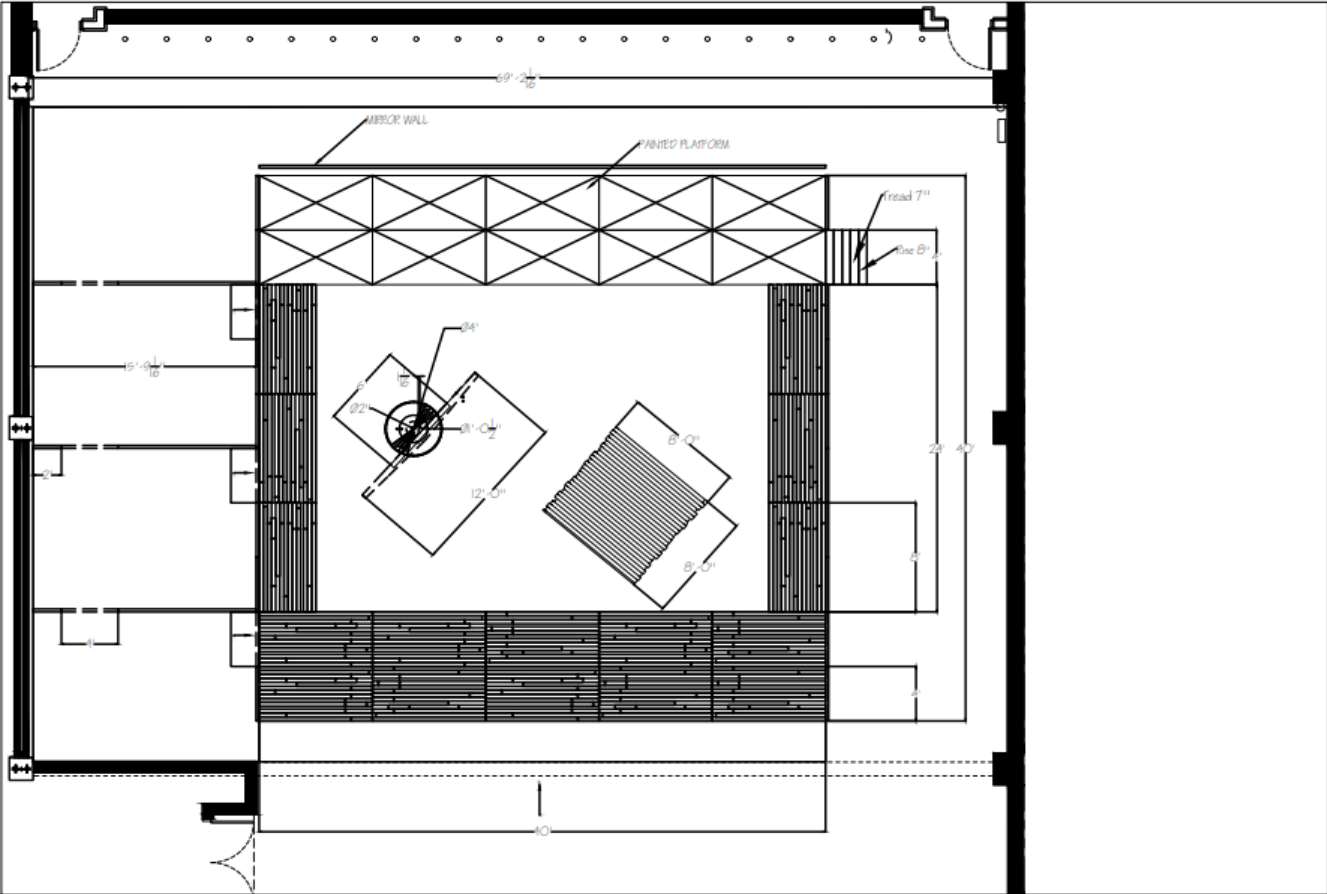

AP

THE TEMPEST GROUNDPLAN

$\frac{3}{8}'' = 1'-0''$

NYC COLLEGE OF TECHNOLOGY		PLATE NO.
ENT 4499 CULMINATION PROJECT		AP
PROJECT NAME:	THE TEMPEST	
	GROUND PLAN	
	$\frac{3}{8}'' = 1'-0''$	
DATE:	09/29/2022	OF: 1
BY/DESIGNED:	Christopher Adams	

Technical Drawings

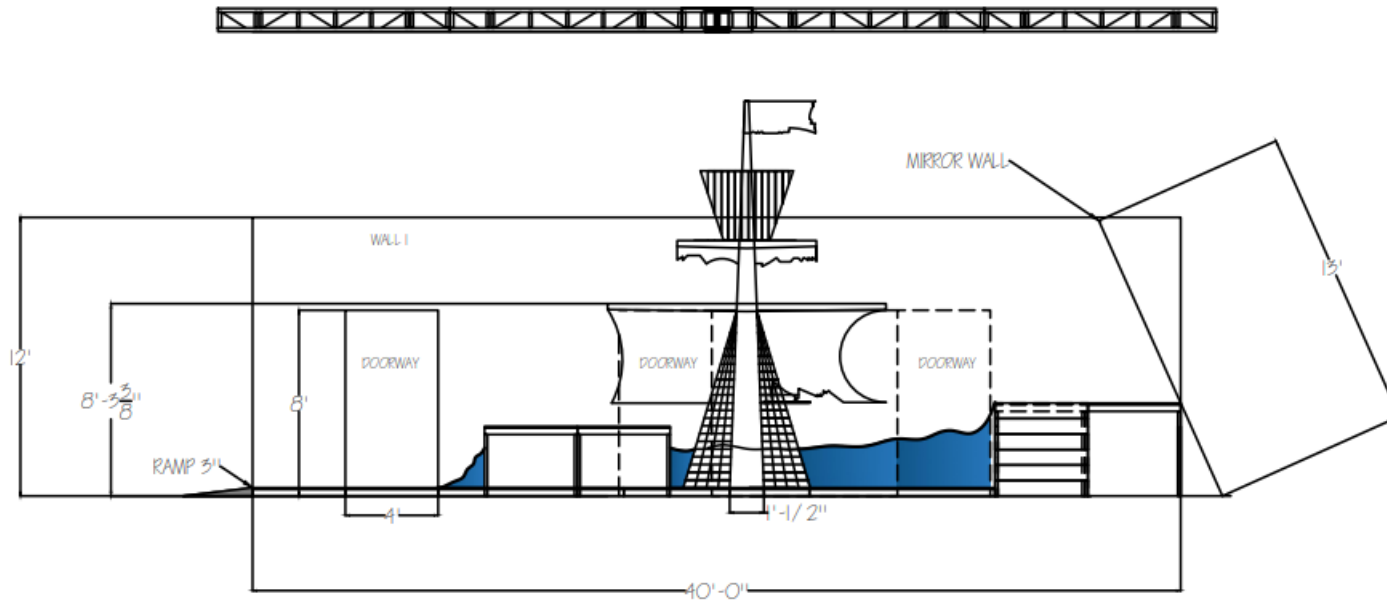

② SECTION VIEW STAGE RIGHT ELEVATION
 $\frac{3}{8}'' = 1'-0''$

NYC COLLEGE OF TECHNOLOGY	
ENT 4499 CULMINATION PROJECT	
PROJECT NAME: THE TEMPEST	PLATE NO.
SECTION VIEW RIGHT SIDE	2
$\frac{3}{8}'' = 1'-0''$	
DATE: 09/29/2025	OF: 2
SET DESIGNER: Christopher Adams	

Technical Drawings

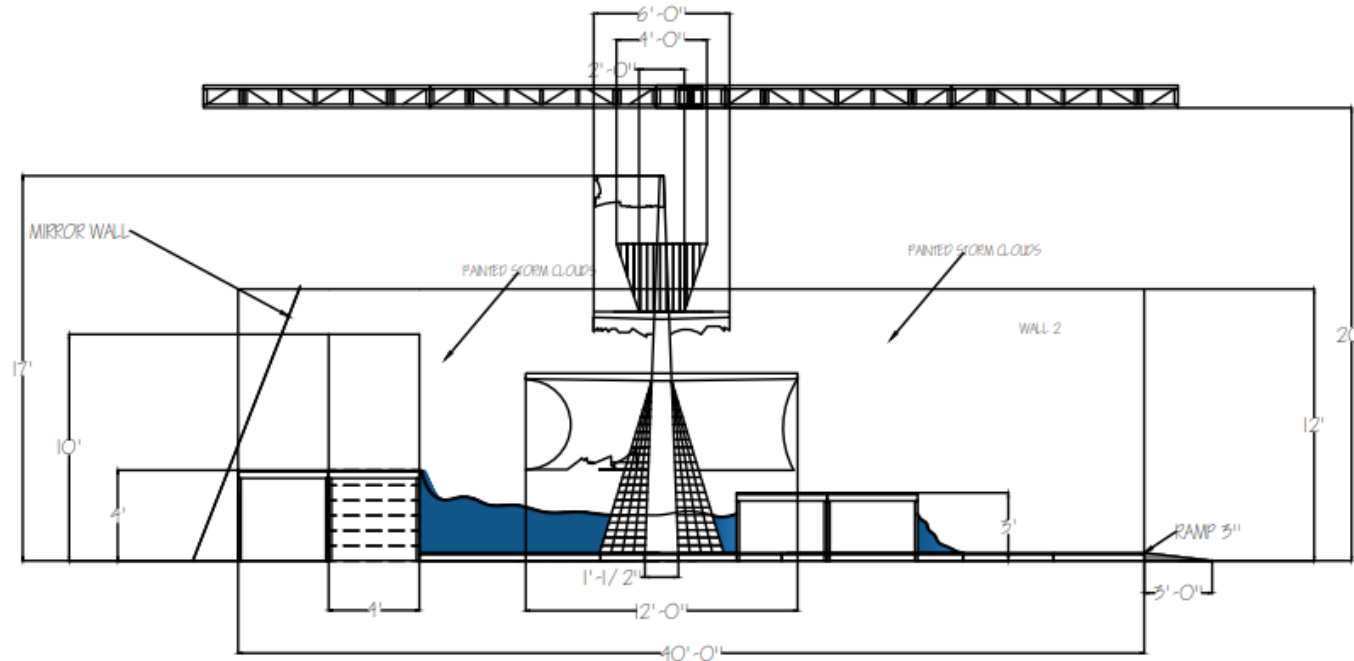

3 SECTION VIEW STAGE LEFT ELEVATION
 $\frac{3}{8}'' = 1'-0''$

NYC COLLEGE OF TECHNOLOGY	
ENT 4499 CULMINATION PROJECT	
PROJECT NAME: THE TEMPEST	PLATE NO.
SECTION VIEW LEFT SIDE	3
$\frac{3}{8}'' = 1'-0''$	
DATE: 08/25/2025	
SET DESIGNER: Christopher Adams	OF: 5

Technical Drawings

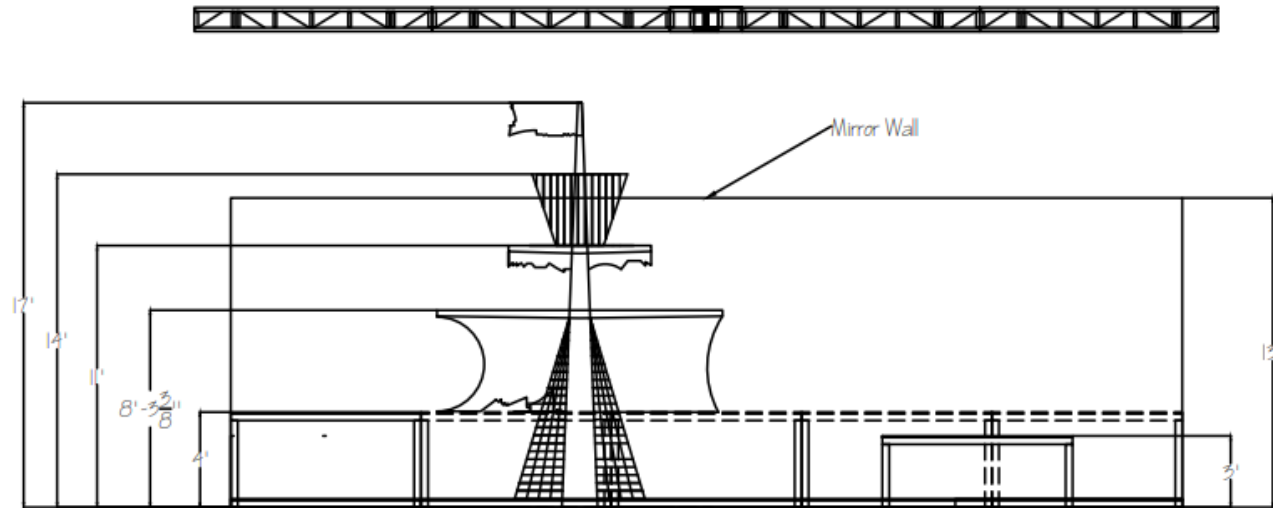

4

FRONT VIEW ELEVATION

$\frac{3}{8}$ " = 1'-0"

NYC COLLEGE OF TECHNOLOGY		PLATE NO.
ENT 4499 CULMINATION PROJECT		4
PROJECT NAME:	THE TEMPEST	
	FRONT ELEVATION	OF: 3
	$\frac{3}{8}$ " = 1'-0"	
DATE:	05/25/2023	
SET DESIGNER:	Christopher Adams	

Materials

- 12' x 10' Blue Medium Duty TARP.
- Illustration Board.
- Black Foam Core Board.
- Water Color Paint + Paint Medium
- Dowel Rods.
- Muslin
- Basswood Sheets
- Artificial Plants
- Twigs
- Teabags

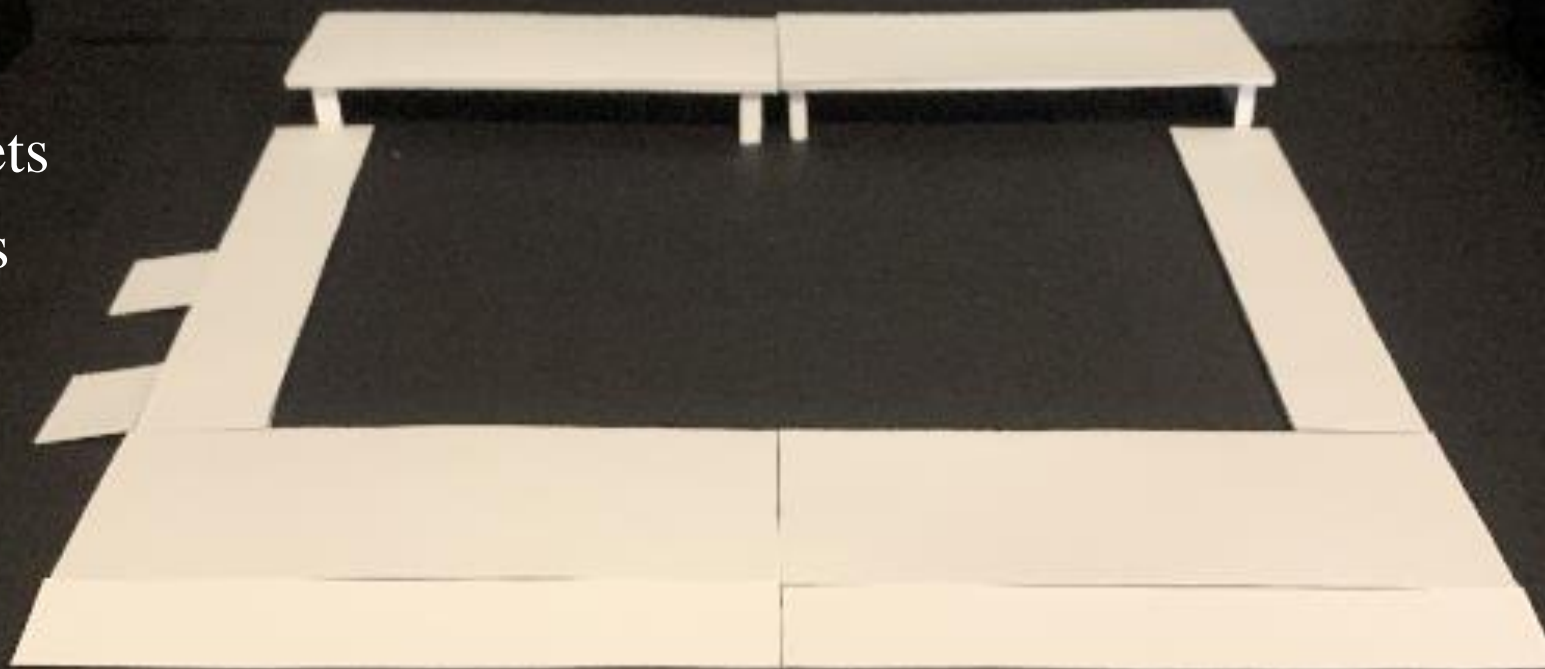

Color Palettes

Woodgraining Platform

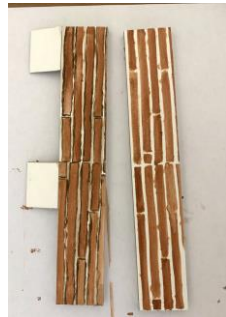
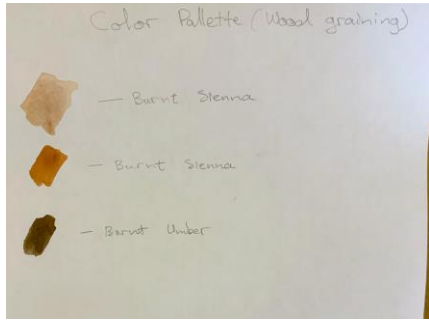

Storm Clouds



Ocean Platform



Prospero's Room

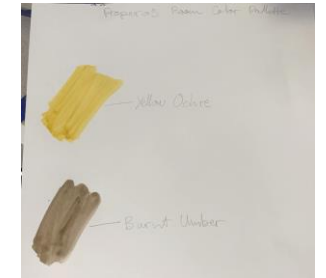

Mast Construction & Painting

For the mast construction, I relied heavily on the reference drawings from the Picture Collection. It was important for me to maintain the integrity of the images. I used tea for the discoloration of the sails which gave it a distressed appearance.

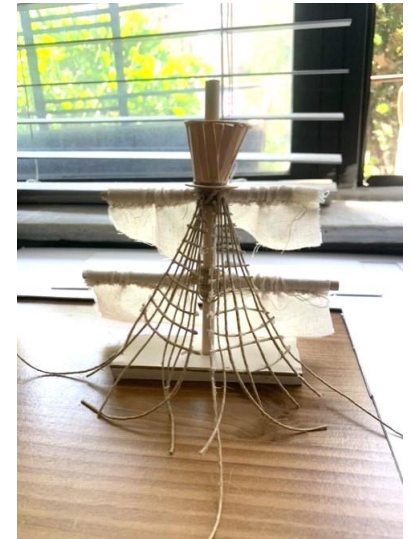

Additional Rooms

The design project was focused on one scene of the play.

However, I thought it would be helpful to add rough ideas based on scenes from the play.



Lost in a Maze



Caliban's Surroundings



Prospero's Magic Room

Budget

The Tempest Materials Budget

Prepared by Set Designer Christopher Adams

Date: 4/20/2023

Quantity	Unit	Material	Unit Cost	Extended Cost	Sources
110	Each	1x3 lumber	11.4	\$ 1,254.00	
45	Each	Lauan Sheets	12.98	\$ 584.10	
56	Each	3/4 Plywood	49.88	\$ 2,793.28	
110	Each	2x4	5.08	\$ 558.80	
3	Gallons	Blue Paint	86.5	\$ 259.50	
3	Gallons	Brown Paint	60.25	\$ 180.75	
3	Gallons	Sienna Paint	60.25	\$ 180.75	
2	Gallons	Yellow Gold Pai	76.25	\$ 152.50	
2	Gallons	Black	60	\$ 120.00	
2	Each	Blue Tarp 40x60	225	\$ 450.00	
1	Each	Set Design Mod	120	\$ 120.00	
3	Each	R&D	150	450	
				0	
				0	
				0	
				0	
				0	

Subtotal	7103.68
Tax	6304.516
Subtotal 2	13408.196
10%Contingency	1340.8196
Complete Total	\$ 14,749.02

Work Cited

Pierce, Robert B. “Understanding ‘The Tempest.’” *New Literary History*, vol. 30, no. 2, 1999, pp. 373–88. *JSTOR*, <http://www.jstor.org/stable/20057542>. Accessed 25 March 2023.

Shakespeare, William. “*The Tempest*.” Edited by Barbara A. Mowat and Paul Werstine, Simon & Schuster Paperbacks, 1994. Accessed 2 February 2023

Thank You!

