

MULLIONS _ HOW TO CREATE CUSTOM CURTAIN WALL PROFILES

October 24, 2012

ARCH 2430

1 - DRAW THE NEW MULLION PROFILE



Go to **File > New > Family > Profile-Mullion.rft**

This will open a .rft template file in a plan view with two reference planes.

Revit will use these planes to place the profile in relationship to the curtain wall.

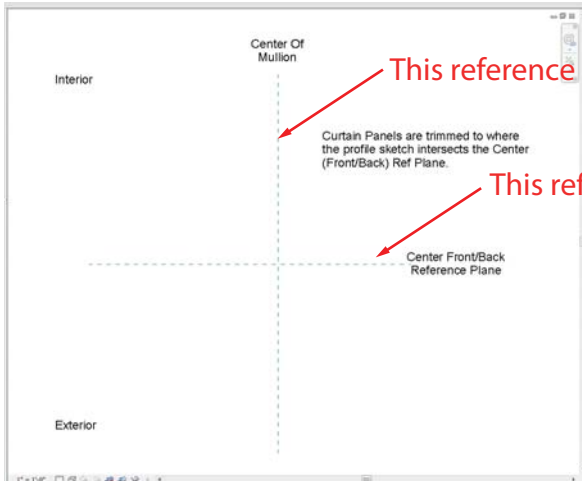

This reference plane represents a curtain wall gridline

This reference plane represents the center of the curtain wall

Click Home tab > Detail panel > Line

Sketch a closed profile loop.

example

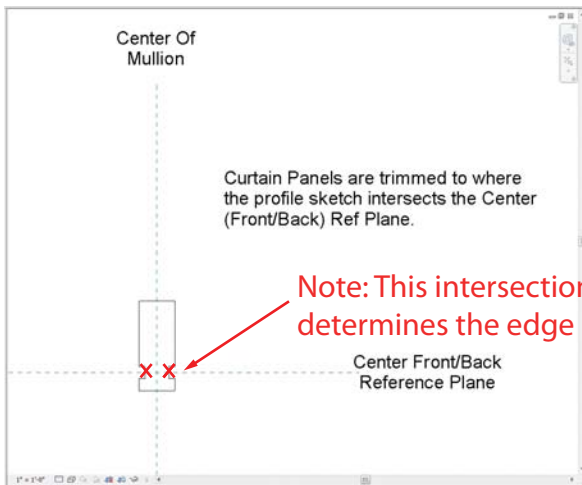
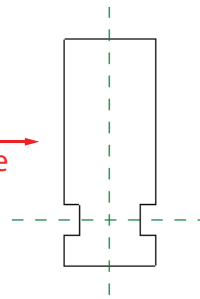

Note: This intersection of the profile lines and the reference determines the edge of the curtain panel

Save as (TestMullion.rft)

2 - INSERT THE PROFILE INTO THE PROJECT



Load into Project
Family Editor

Click Modify tab > Load into project

The new profile will be found in the Project Browser under > Families > Profiles

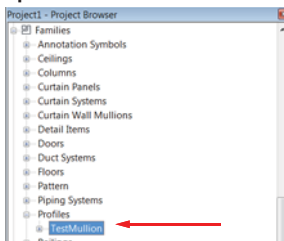

3 - CREATE A NEW MULLION USING THE PROFILE



In the Revit Project click the home tab > Build Panel > click Mullion >
In the properties palette click edit type

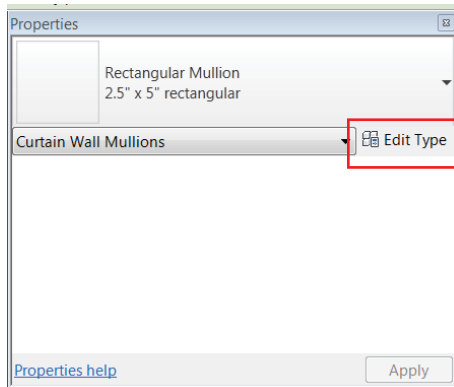

In the type properties window click Duplicate

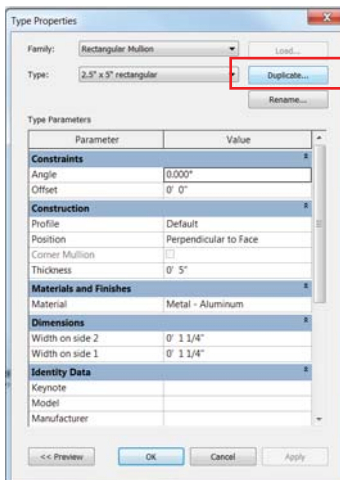

Type a new name for the Mullion. click ok.
In the type properties window under Construction > Profile >
click on the profile name to select the TestMullion.rft

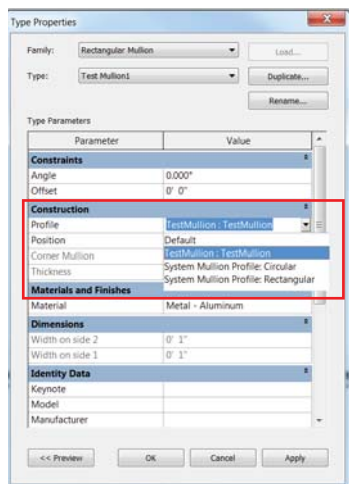

The new profile will be found in the Project Browser under > Families > Curtain Wall Mullions > Rectangular Curtain Wall Mullions

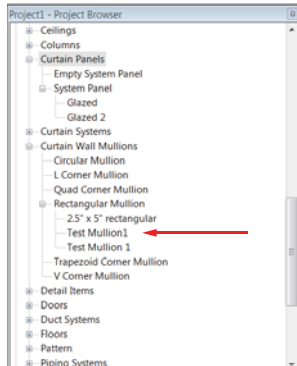

3 - APPLY THE MULLION TO THE CURTAIN WALL FAMILY

In the Revit Project click on the curtain wall > In the properties palette click edit type > Scroll down to the Vertical Mullions > Click on the Profiles name to load the Mullion

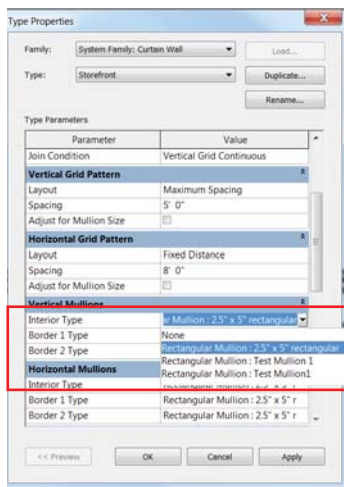

Continue to apply the Mullion Profile where applicable. click ok.



TROUBLE SHOOTING

1. Check the offset of the curtain wall panel family parameter, for this example it should be 0"
2. Verify the profile is loaded into the Revit Project
the profile will be found in the Project Browser under > Families > Profiles
3. Verify the mullion is loaded into the Revit Project
the profile will be found in the Project Browser under > Families > Curtain Wall Mullions > Rectangular Curtain Wall Mullions

MULLIONS _ MULLION TYPE PROPERTIES

October 24, 2012

ARCH 2430

Accessing the default Rectangular Mullion Type Properties
In the Revit Project click the Home Tab > Build Panel > click Mullion
Then in the properties palette click edit type



Default Rectangular Curtain Wall Mullion Plan View

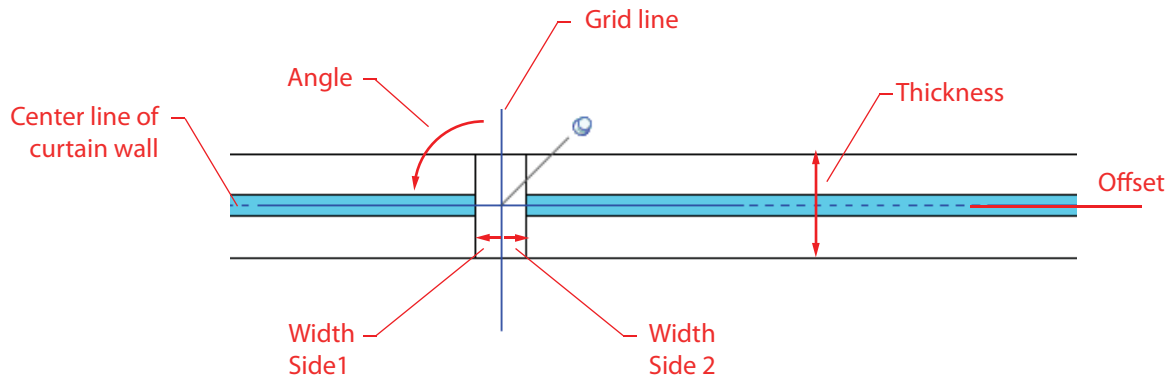

Mullion Type Properties palette

List of all types for selection or editing

Angle of mullion in the curtain wall

60° example

Width of mullion from grid line

Creates a new mullion with the same properties

Saves the mullion type as a new name

Offset of mullion in plan from center line of curtain wall

6" example

Note: Any changes to the Type Properties are GLOBAL changes. All mullions defined by this type will be updated. - When creating a new Mullion that is different from existing mullions in the model duplicate the type.

| Parameter | Value |
|-------------------------------|--------------------------|
| Constraints | |
| Angle | 0.000° |
| Offset | 0' 0" |
| Construction | |
| Profile | Default |
| Position | Perpendicular to Face |
| Corner Mullion | <input type="checkbox"/> |
| Thickness | 0' 5" |
| Materials and Finishes | |
| Material | Metal - Aluminum |
| Dimensions | |
| Width on side 2 | 0' 1 1/4" |
| Width on side 1 | 0' 1 1/4" |
| Identity Data | |
| Keynote | |
| Model | |
| Manufacturer | |