



NYCCT

Project Address:
285 JAY STREET
BROOKLYN NY, 10021

Architect:
Name
Address
Email

| Rev. # | Description | Date |
|--------|--------------|----------|
| 01 | SUBMISSION 1 | 9/29/14 |
| 02 | SUBMISSION 2 | 10/11/14 |
| | | |
| | | |
| | | |
| | | |
| | | |
| | | |
| | | |
| | | |
| | | |
| | | |
| | | |
| | | |
| | | |
| | | |
| | | |

STAIR STUDIES

Project number 01.2014
Date 10.11.14
Drawn by MARIE BARETSKY
Professor Name KING

SK-101

Scale 1/4" = 1'-0"

| | |
|--|-----------------|
| STAIR HEIGHT | 12'-0" |
| MAX. RISER HEIGHT | 7" |
| NUMBER OF RISERS | 21 |
| $144"/7" = 20.57$ | |
| RISER HEIGHT | $6\frac{7}{8}"$ |
| $144"/21 = 6\frac{7}{8}"$ | |
| TREAD WIDTH | 11" |
| $24" > 2 \times (6\frac{7}{8}) + T < 25\frac{1}{2}"$ | |
| $10\frac{1}{2}" > T < 11\frac{1}{4}"$ | |

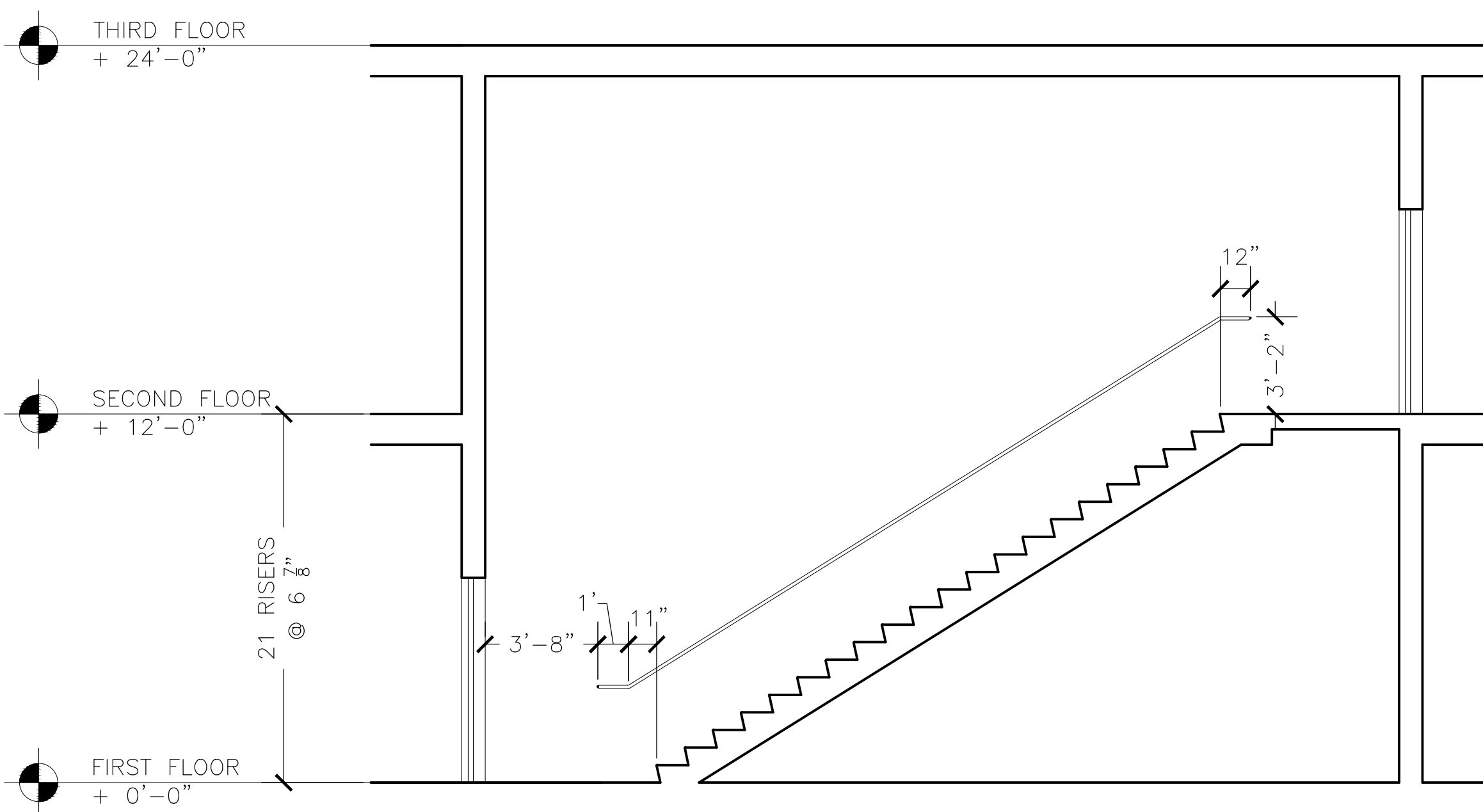

04 12'-0" "L"-SHAPE STAIR SECTION
SK-101 1/4" = 1'-0"

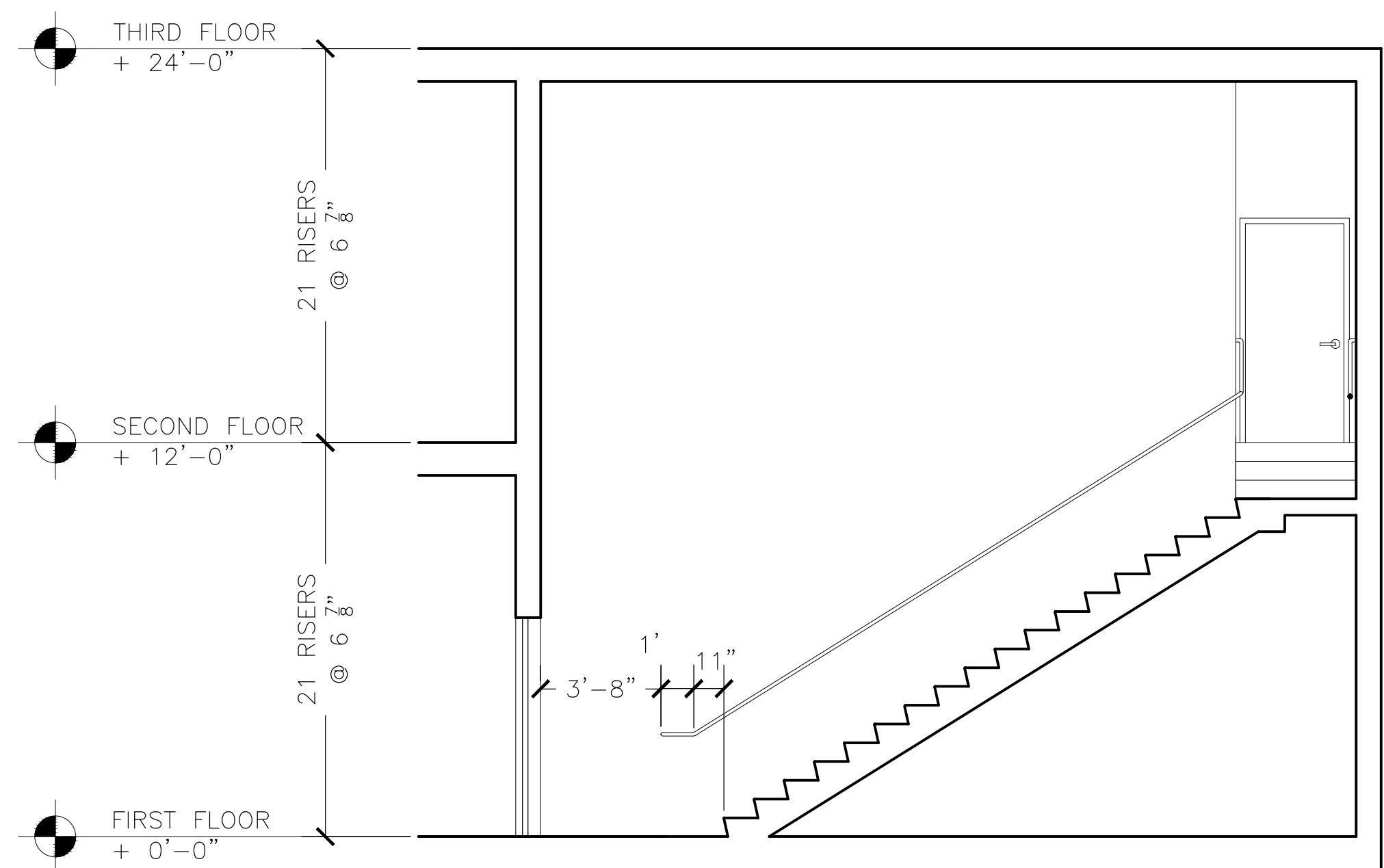

03 12'-0" "L"-SHAPE STAIR SECTION
SK-101 1/4" = 1'-0"

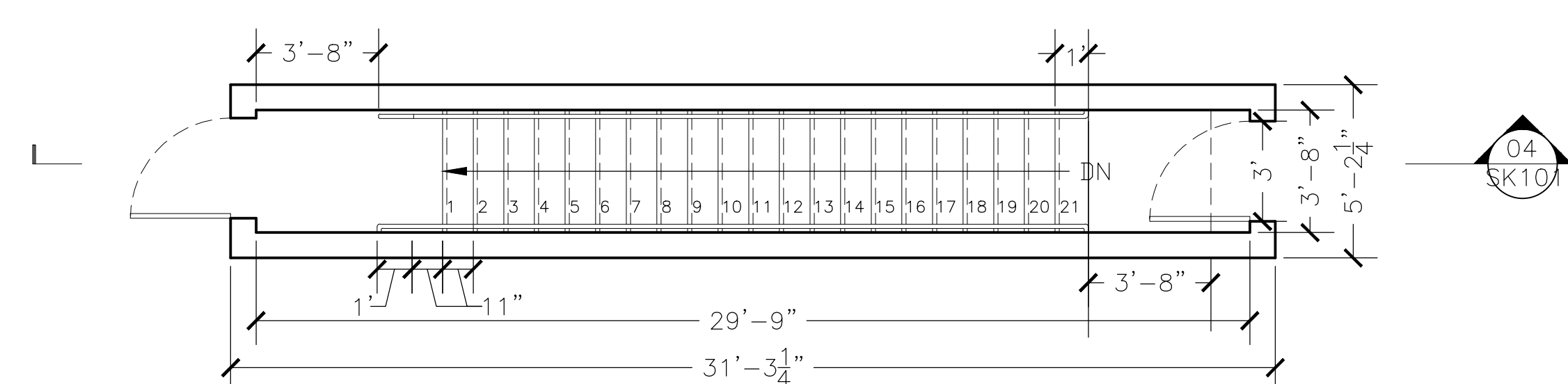

02 12'-0" STRAIGHT RUN STAIR PLAN
SK-101 1/4" = 1'-0"

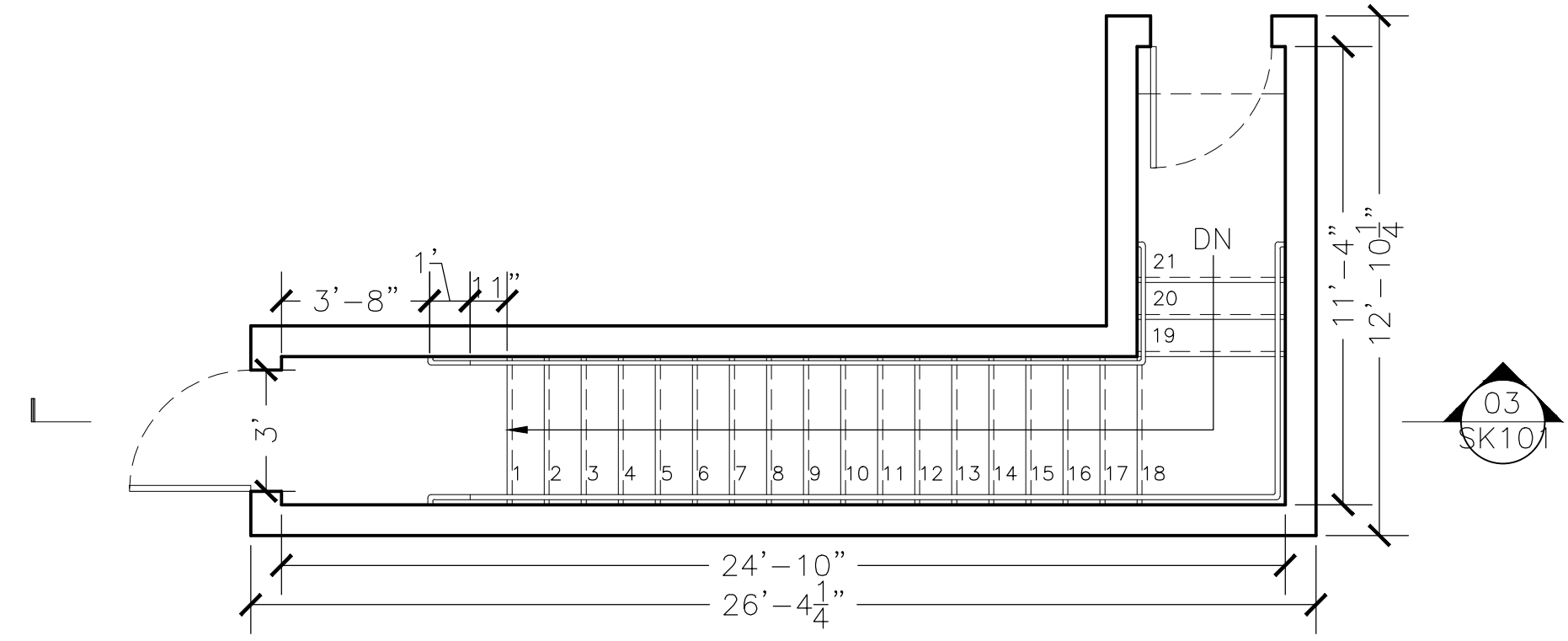

01 12'-0" "L"-SHAPE STAIR PLAN
SK-101 1/4" = 1'-0"

| | |
|-------------------|--|
| STAIR HEIGHT | 12'-0" |
| MAX. RISER HEIGHT | 7" |
| NUMBER OF RISERS | 21 $144"/7" = 20.57$ |
| RISER HEIGHT | $6\frac{7}{8}"$ $144"/21 = 6\frac{7}{8}"$ |
| TREAD WIDTH | 11" $24" > 2 \times (6\frac{7}{8}) + T < 25\frac{1}{2}"$ $10\frac{1}{2}" > T < 11\frac{3}{4}"$ |



NYCCT

Project Address:
285 JAY STREET
BROOKLYN NY, 10021

Architect:
Name
Address
Email

| Rev. # | Description | Date |
|--------|--------------|----------|
| 01 | SUBMISSION 1 | 9/29/14 |
| 02 | SUBMISSION 2 | 10/11/14 |
| | | |
| | | |
| | | |
| | | |
| | | |
| | | |
| | | |
| | | |
| | | |
| | | |
| | | |
| | | |
| | | |
| | | |
| | | |

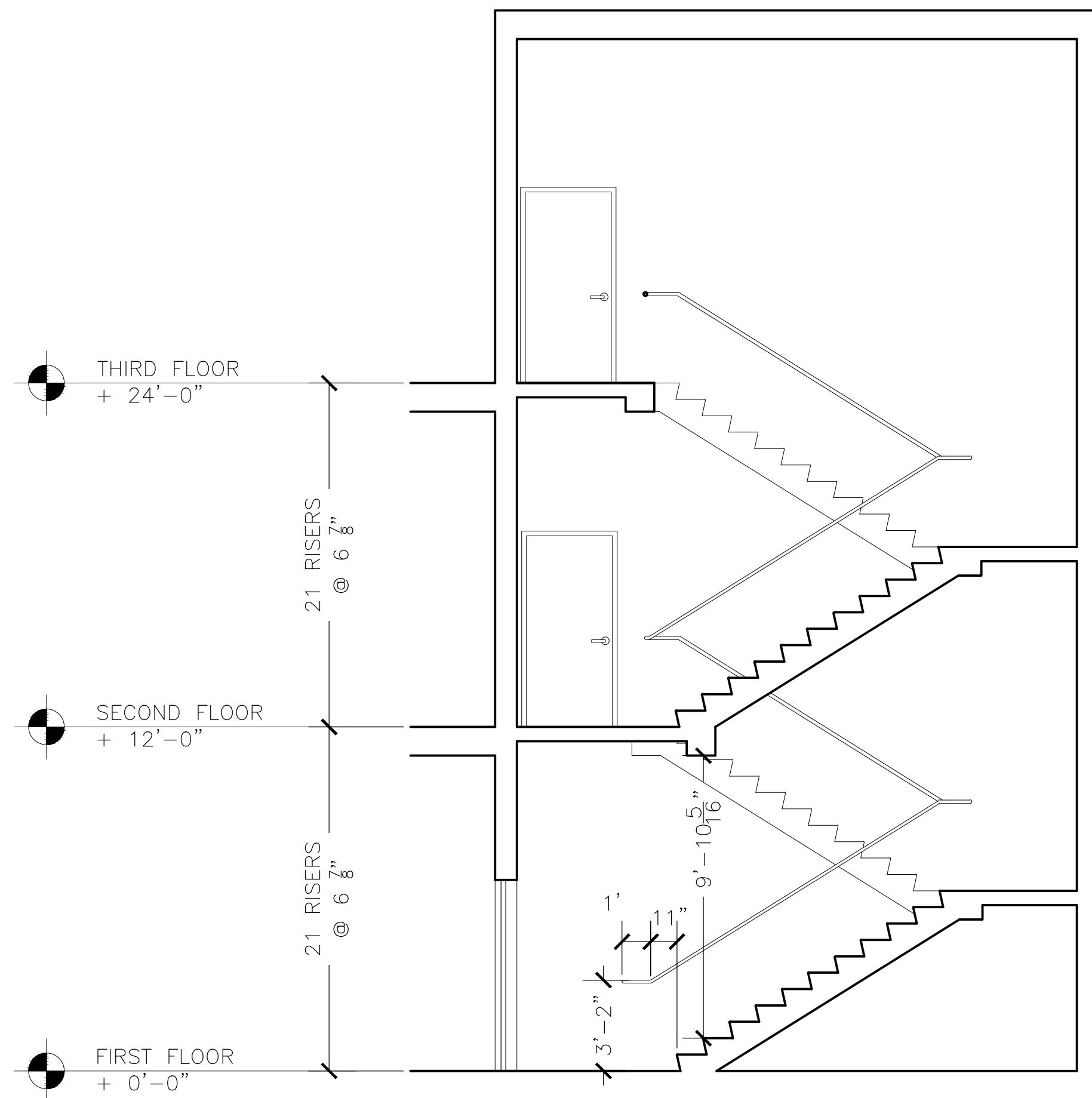

01 12'-0" "U"-SHAPE STAIR SECTION
SK-102 1/4" = 1'-0"

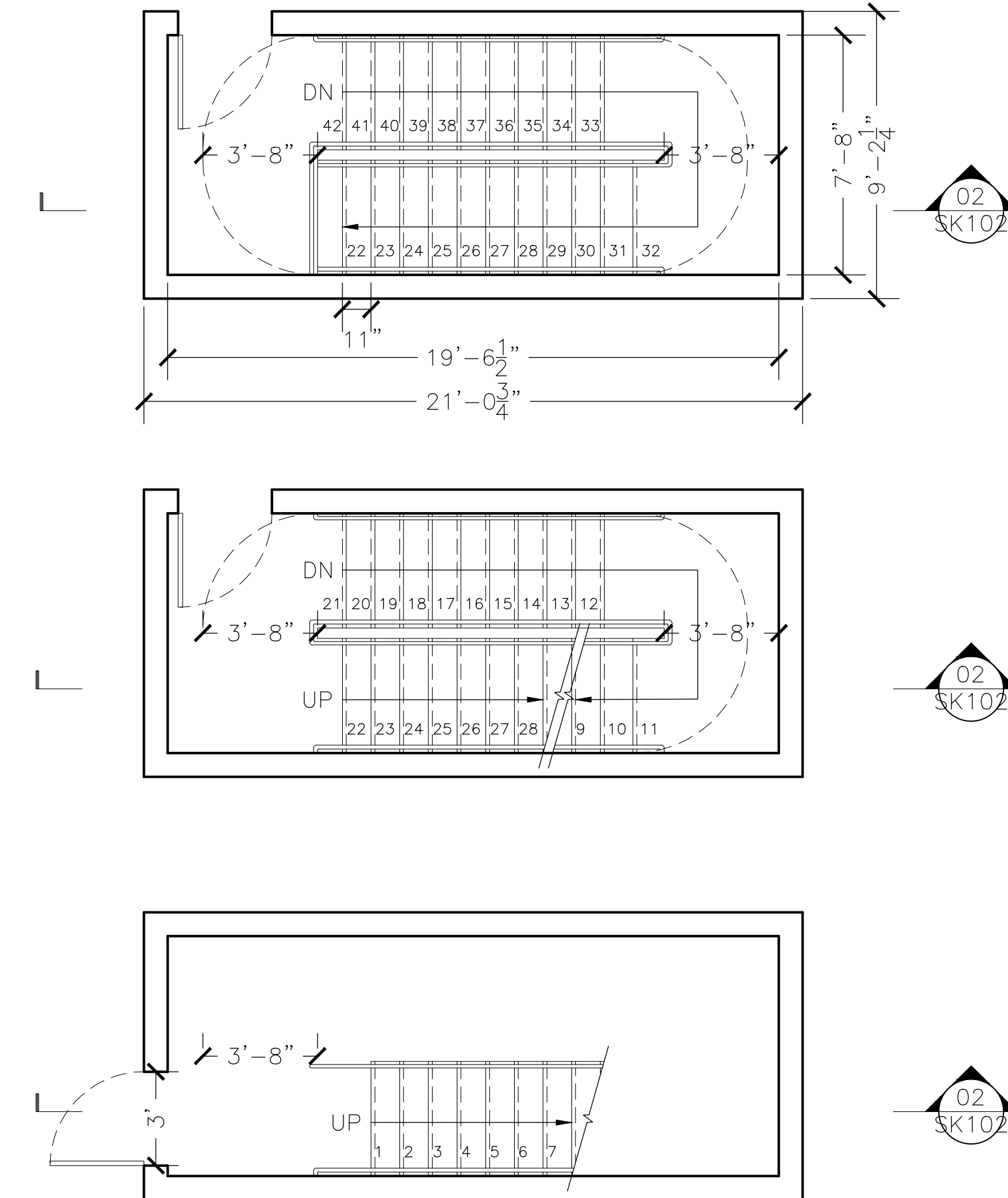

01 12'-0" "U"-SHAPE STAIR PLANS
SK-102 1/4" = 1'-0"

STAIR STUDIES

Project number 01.2014
Date 10.11.14
Drawn by MARIE BARETSKY
Professor Name KING

SK-102

Scale 1/4" = 1'-0"



NYCCT

Project Address:
285 JAY STREET
BROOKLYN NY, 10021

Architect:
Name
Address
Email

| Rev. # | Description | Date |
|--------|--------------|----------|
| 01 | SUBMISSION 1 | 9/29/14 |
| 02 | SUBMISSION 2 | 10/11/14 |

| | |
|---|--------|
| STAIR HEIGHT | 14'-0" |
| MAX. RISER HEIGHT | 7" |
| NUMBER OF RISERS | 24 |
| $168''/7'' = 24$ | |
| RISER HEIGHT | 7" |
| $168''/24 = 7''$ | |
| TREAD WIDTH | 11" |
| $24'' > 2 \times (7'') + T < 25\frac{1}{2}''$ | |
| $10'' > T < 11\frac{1}{2}''$ | |

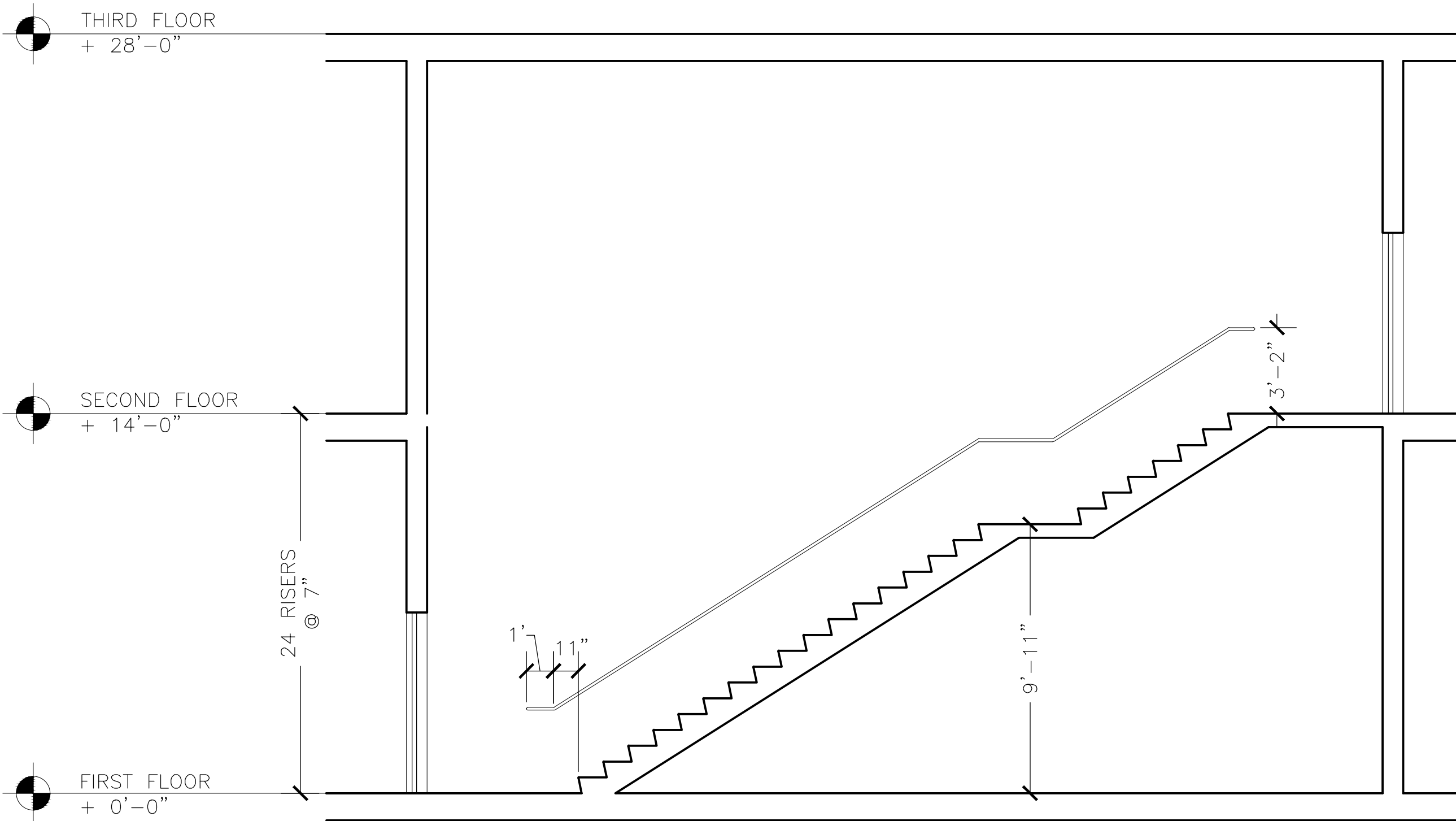

04 14'-0" STRAIGHT RUN STAIR SECTION
SK-103 1/4" = 1'-0"

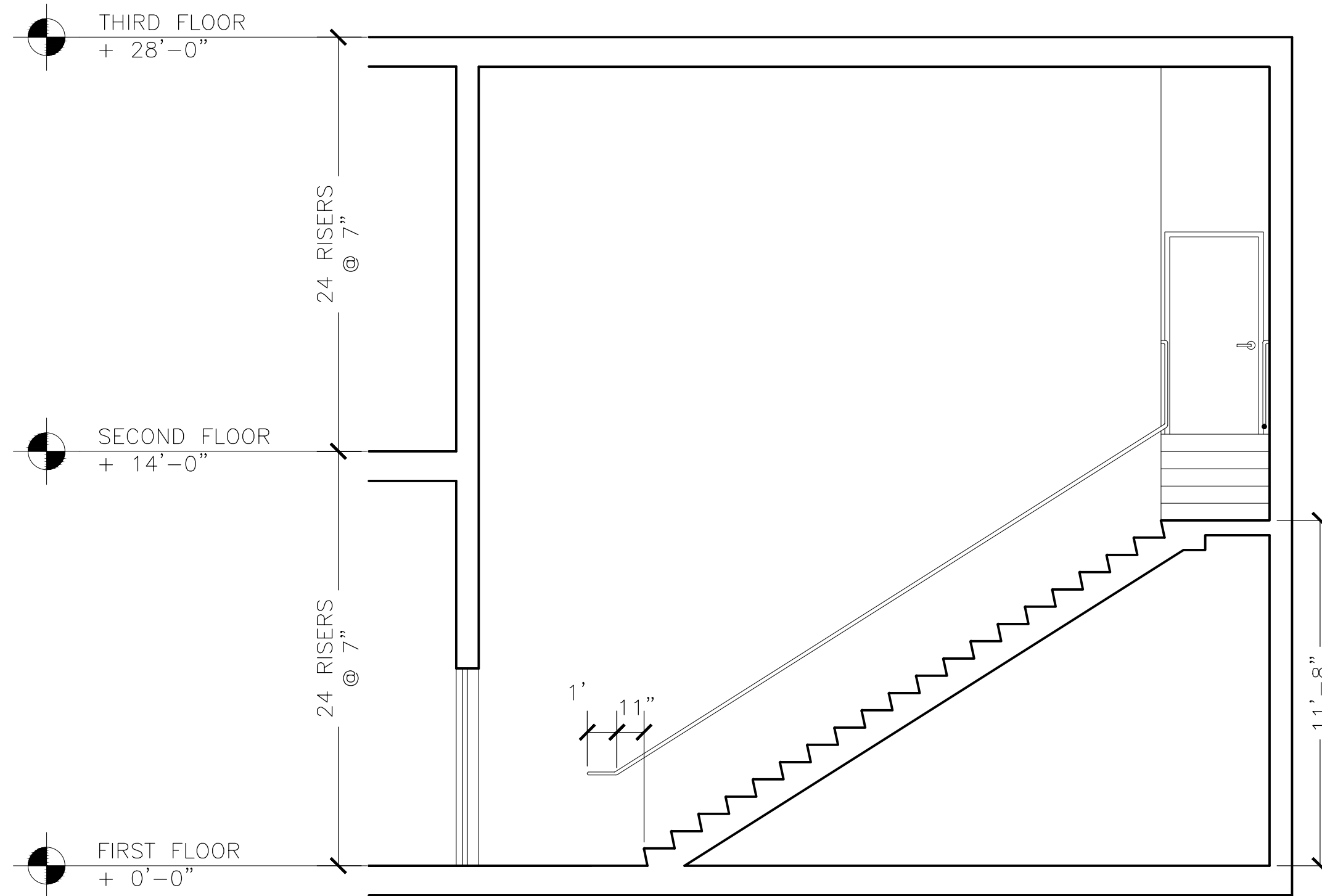

03 14'-0" L-SHAPE STAIR SECTION
SK-103 1/4" = 1'-0"

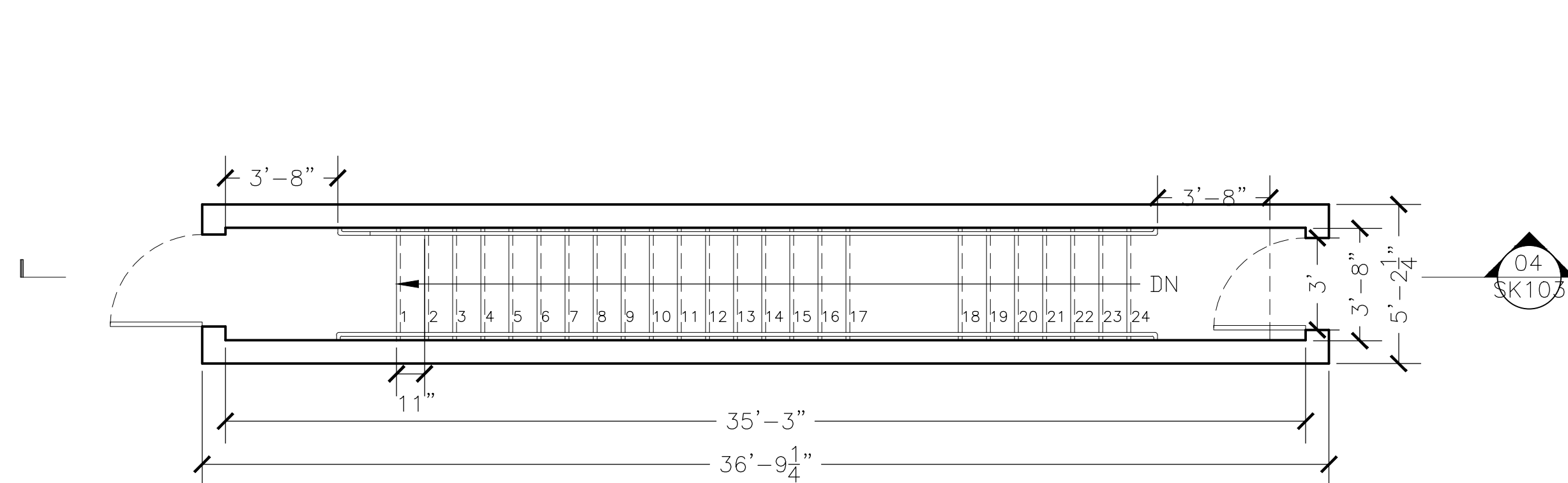

02 14'-0" STRAIGHT RUN STAIR PLAN
SK-103 1/4" = 1'-0"

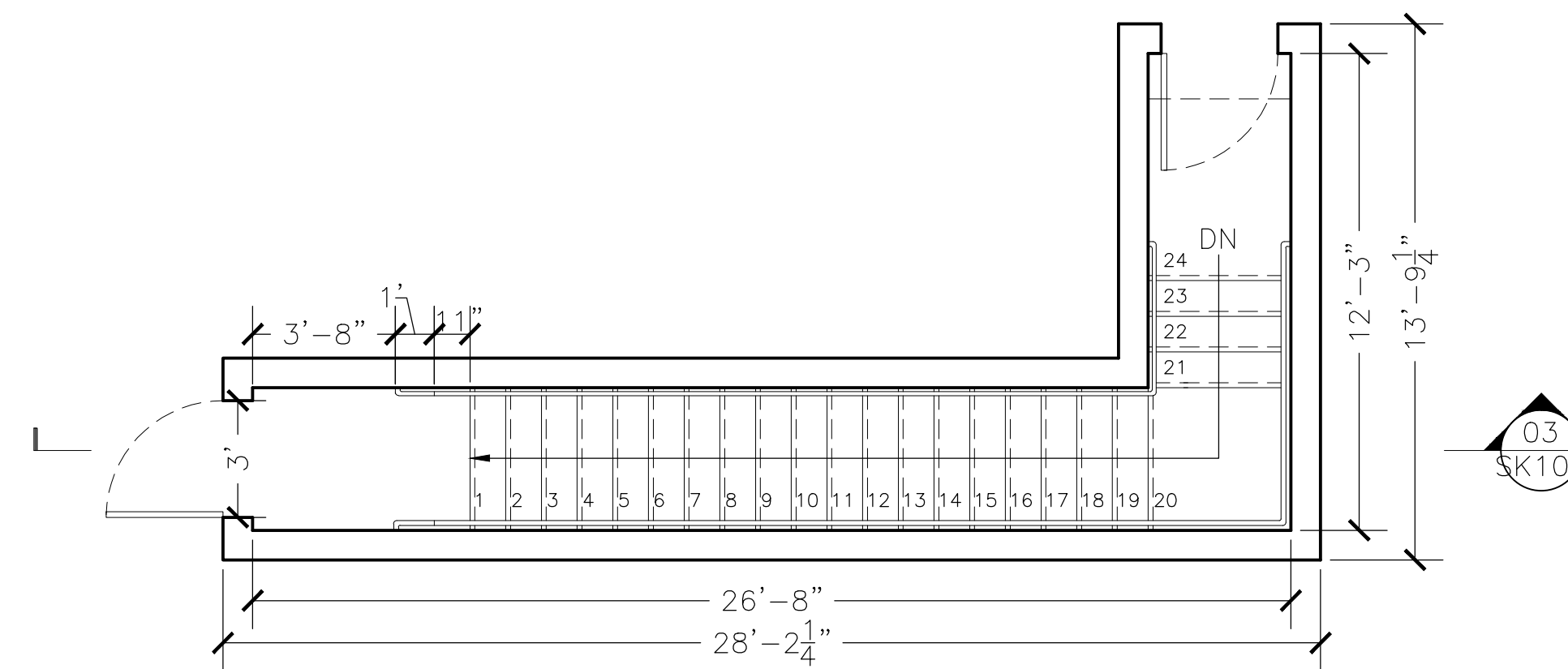

01 14'-0" L-SHAPE STAIR PLAN
SK-103 1/4" = 1'-0"

STAIR STUDIES

| | |
|----------------|----------------|
| Project number | 01.2014 |
| Date | 10.11.14 |
| Drawn by | MARIE BARETSKY |
| Professor Name | KING |

SK-103

Scale 1/4" = 1'-0"

| | |
|--|--------|
| STAIR HEIGHT | 14'-0" |
| MAX. RISER HEIGHT | 7" |
| NUMBER OF RISERS | 24 |
| $168''/7'' = 24$ | |
| RISER HEIGHT | 7" |
| $168''/24 = 7''$ | |
| TREAD WIDTH | 11" |
| $24'' > 2X(7'') + T < 25\frac{1}{2}''$ | |
| $10'' > T < 11\frac{1}{2}''$ | |



NYCCT

Project Address:
285 JAY STREET
BROOKLYN NY, 10021

Architect:
Name
Address
Email

| Rev. # | Description | Date |
|--------|--------------|----------|
| 01 | SUBMISSION 1 | 9/29/14 |
| 02 | SUBMISSION 2 | 10/11/14 |

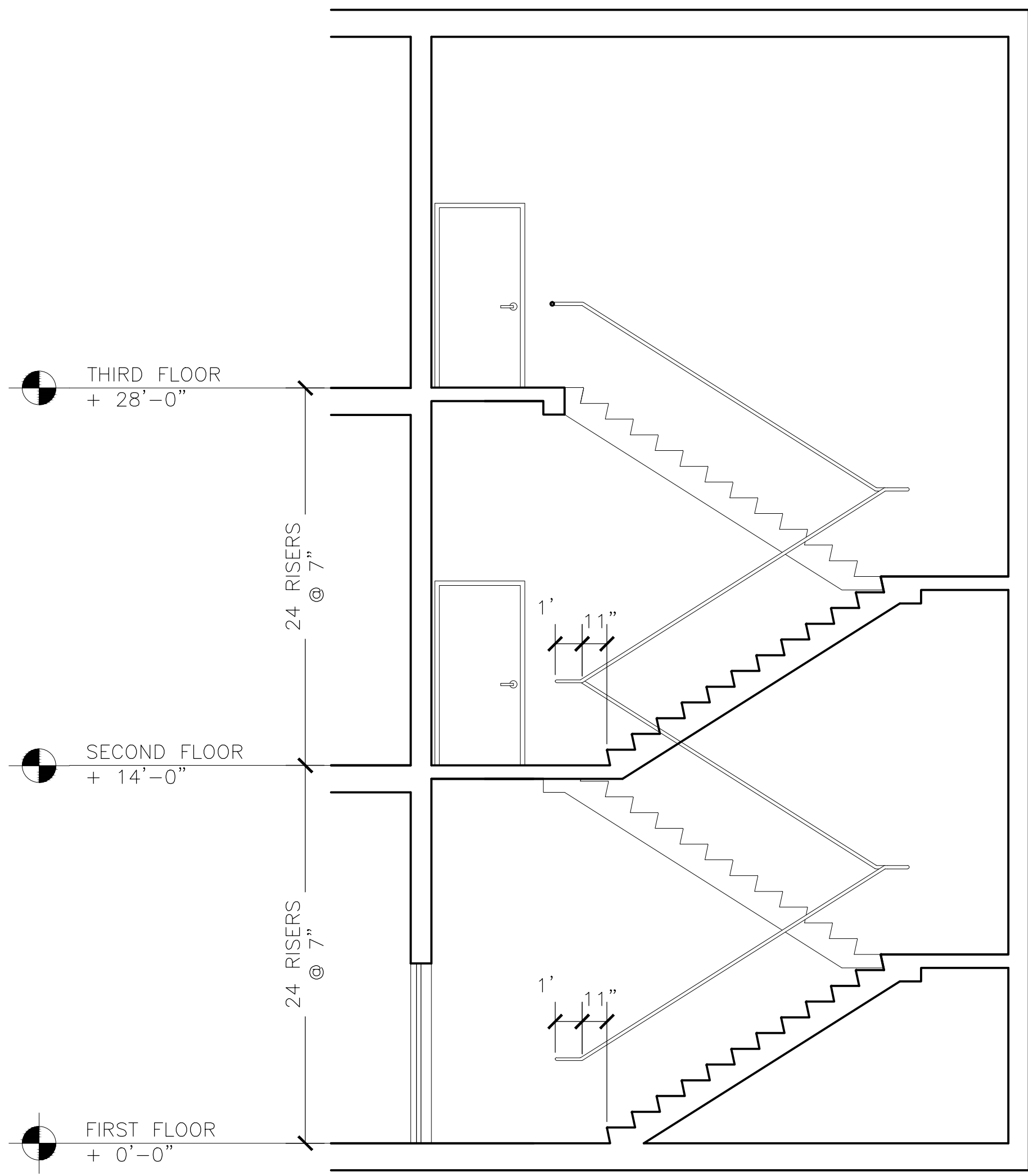

02 SK-104 14'-0" "U"-SHAPE STAIR SECTION
1/4" = 1'-0"

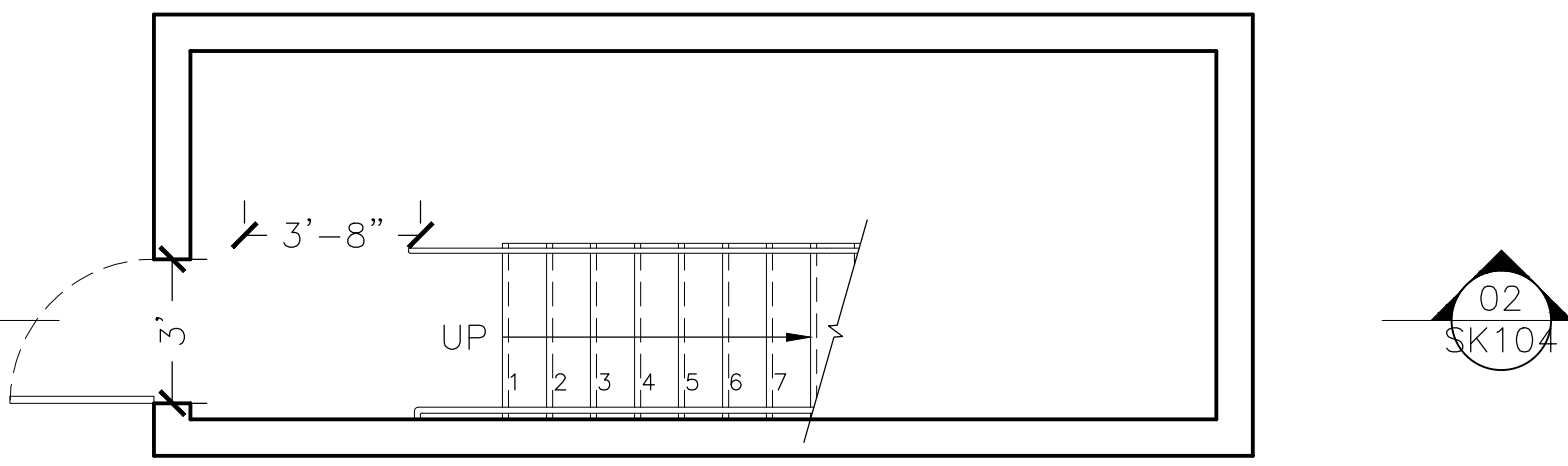
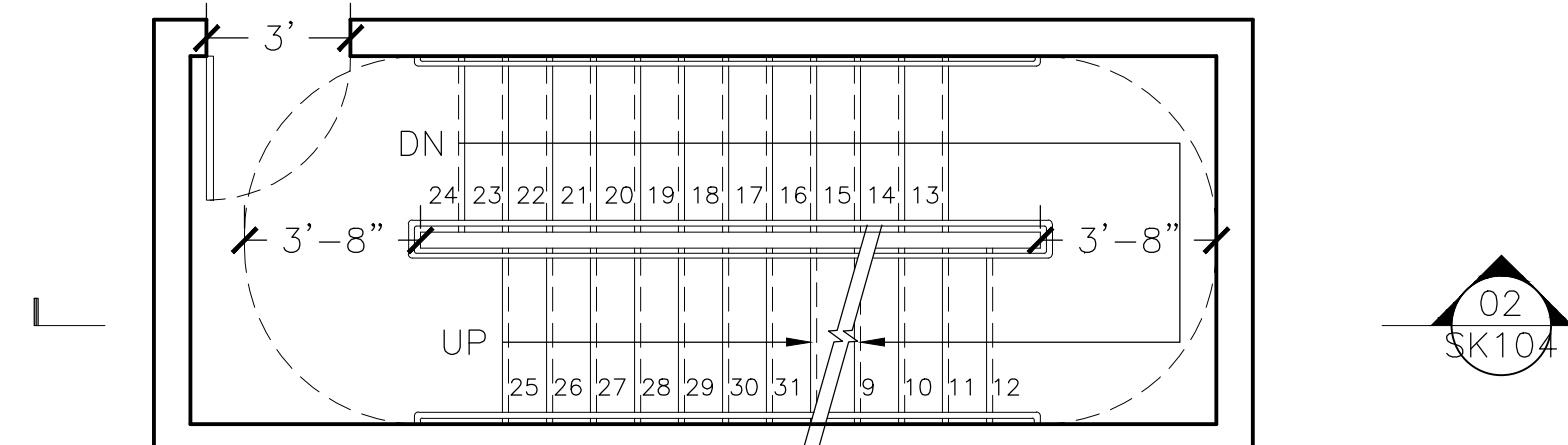
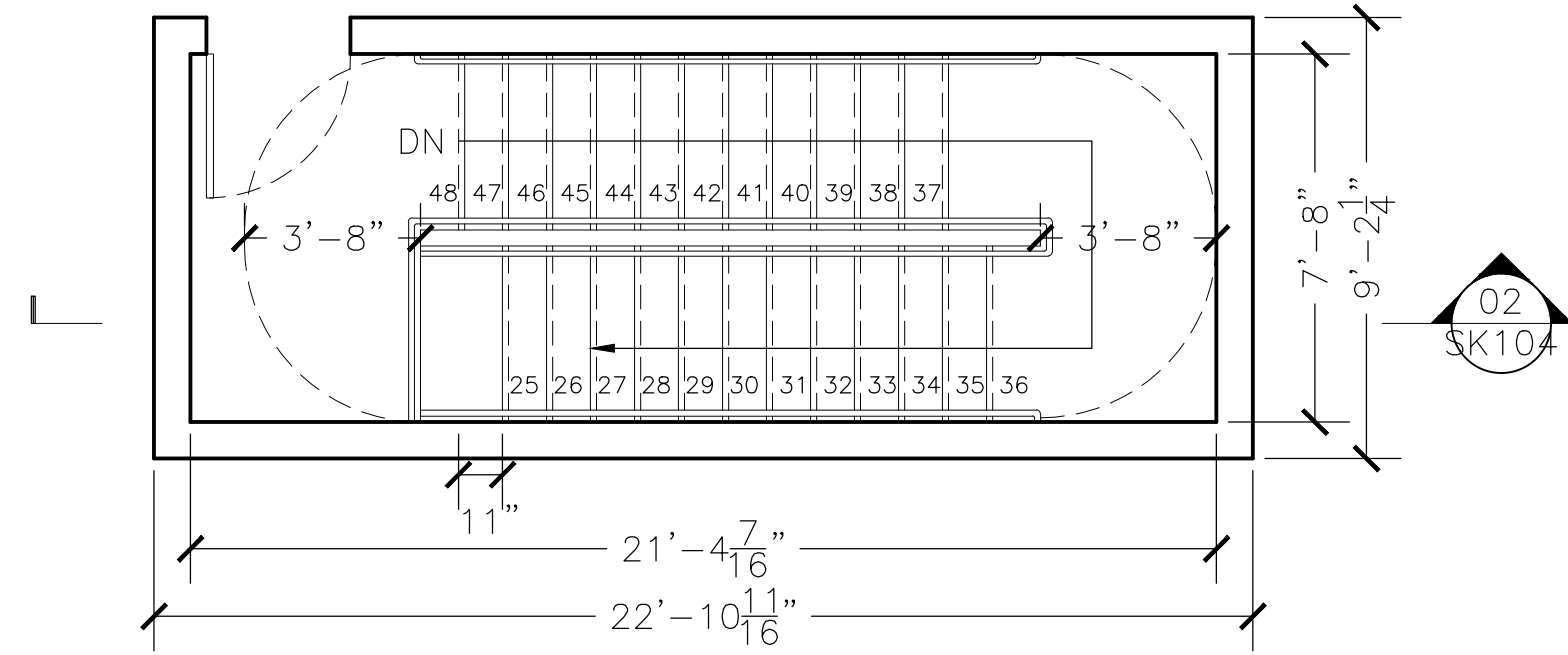

01 SK-104 14'-0" "U"-SHAPE STAIR PLANS
1/4" = 1'-0"

STAIR STUDIES

| | |
|----------------|----------------|
| Project number | 01.2014 |
| Date | 10.11.14 |
| Drawn by | MARIE BARETSKY |
| Professor Name | KING |

SK-104

Scale 1/4" = 1'-0"

| | |
|--|------------------|
| STAIR HEIGHT | 16'0" |
| MAX. RISER HEIGHT | 7" |
| NUMBER OF RISERS | 28 |
| $192''/7'' = 27.4$ | |
| RISER HEIGHT | $6\frac{7}{8}''$ |
| $192''/28 = 6\frac{7}{8}''$ | |
| TREAD WIDTH | 11" |
| $24'' > 2 \times (6\frac{7}{8}'' + T) < 25\frac{1}{2}''$ | |
| $10\frac{1}{2}'' > T < 11\frac{3}{4}''$ | |



NYCCT

Project Address:
285 JAY STREET
BROOKLYN NY, 10021

Architect:
Name
Address
Email

| Rev. # | Description | Date |
|--------|--------------|----------|
| 01 | SUBMISSION 1 | 9/29/14 |
| 02 | SUBMISSION 2 | 10/11/14 |

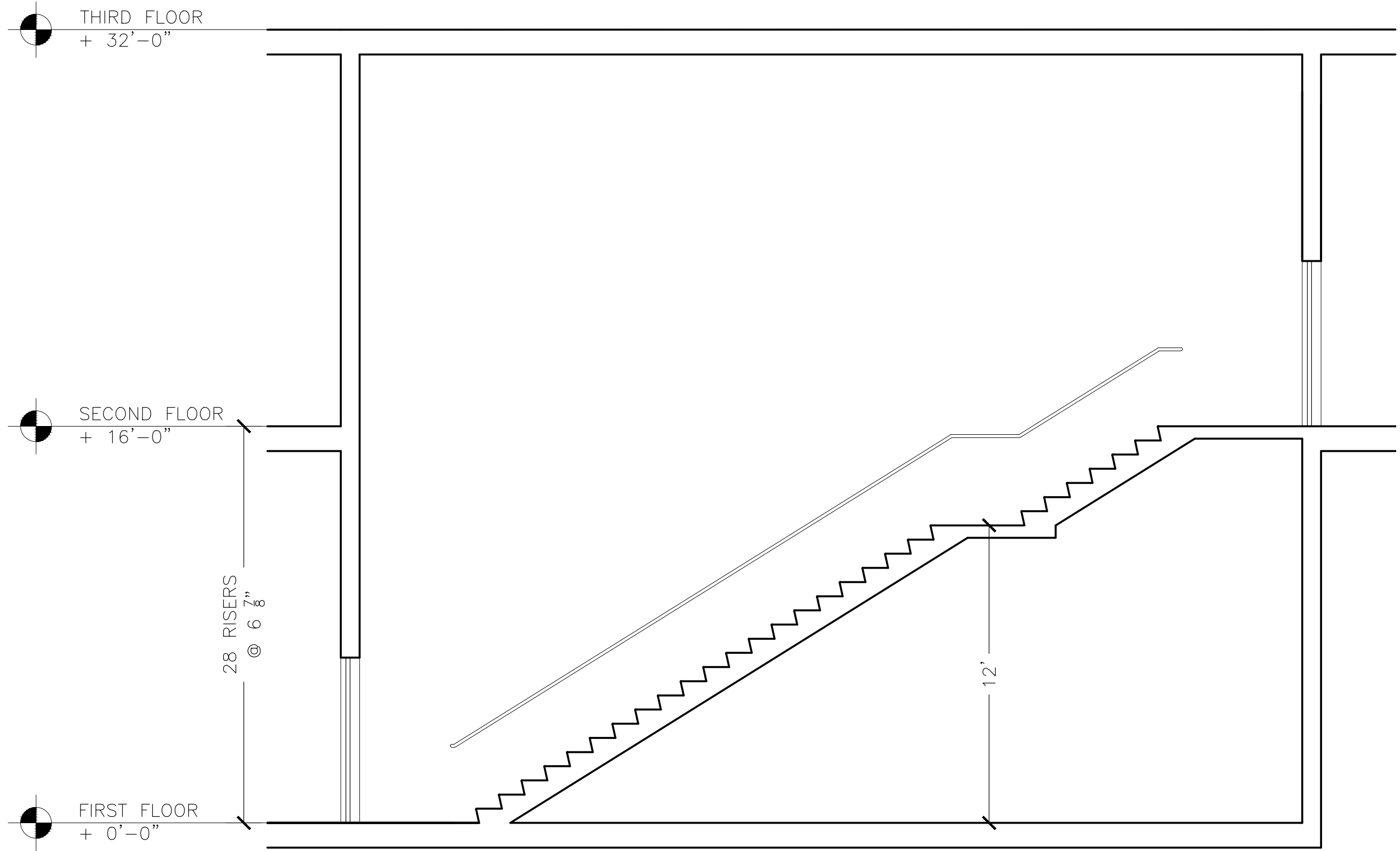

04 16'-0" STRAIGHT RUN STAIR SECTION
1/4" = 1'-0"

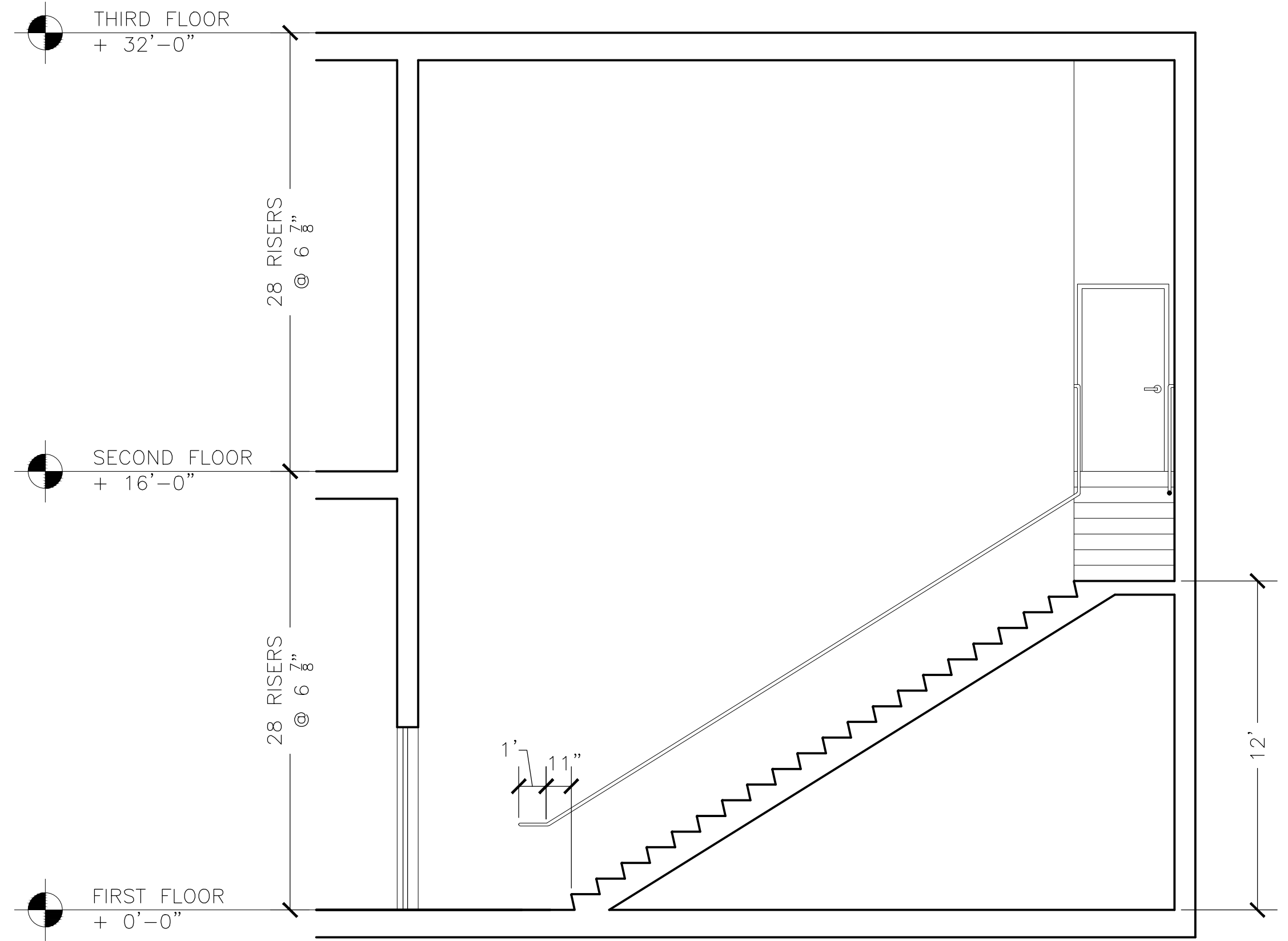

03 16'-0" L-SHAPE STAIR SECTION
1/4" = 1'-0"

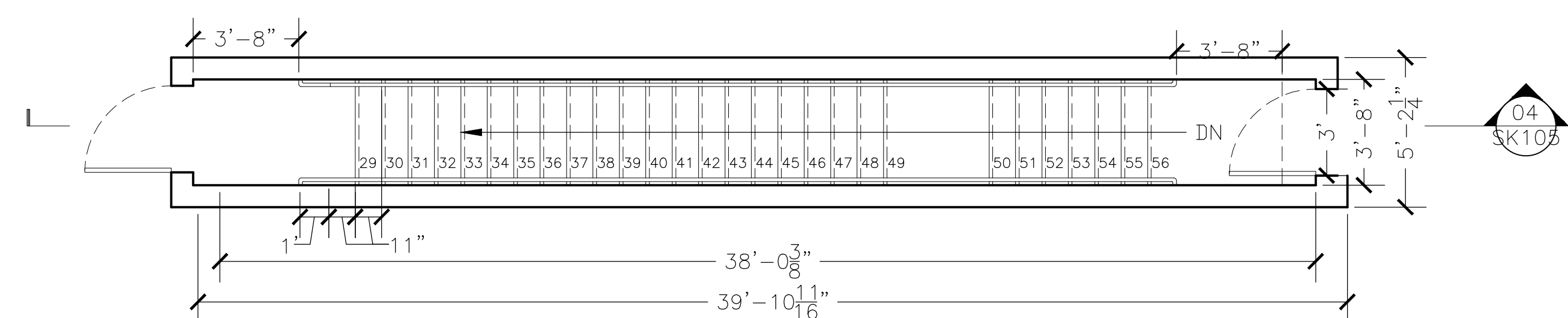

02 16'-0" STRAIGHT RUN STAIR PLAN
1/4" = 1'-0"

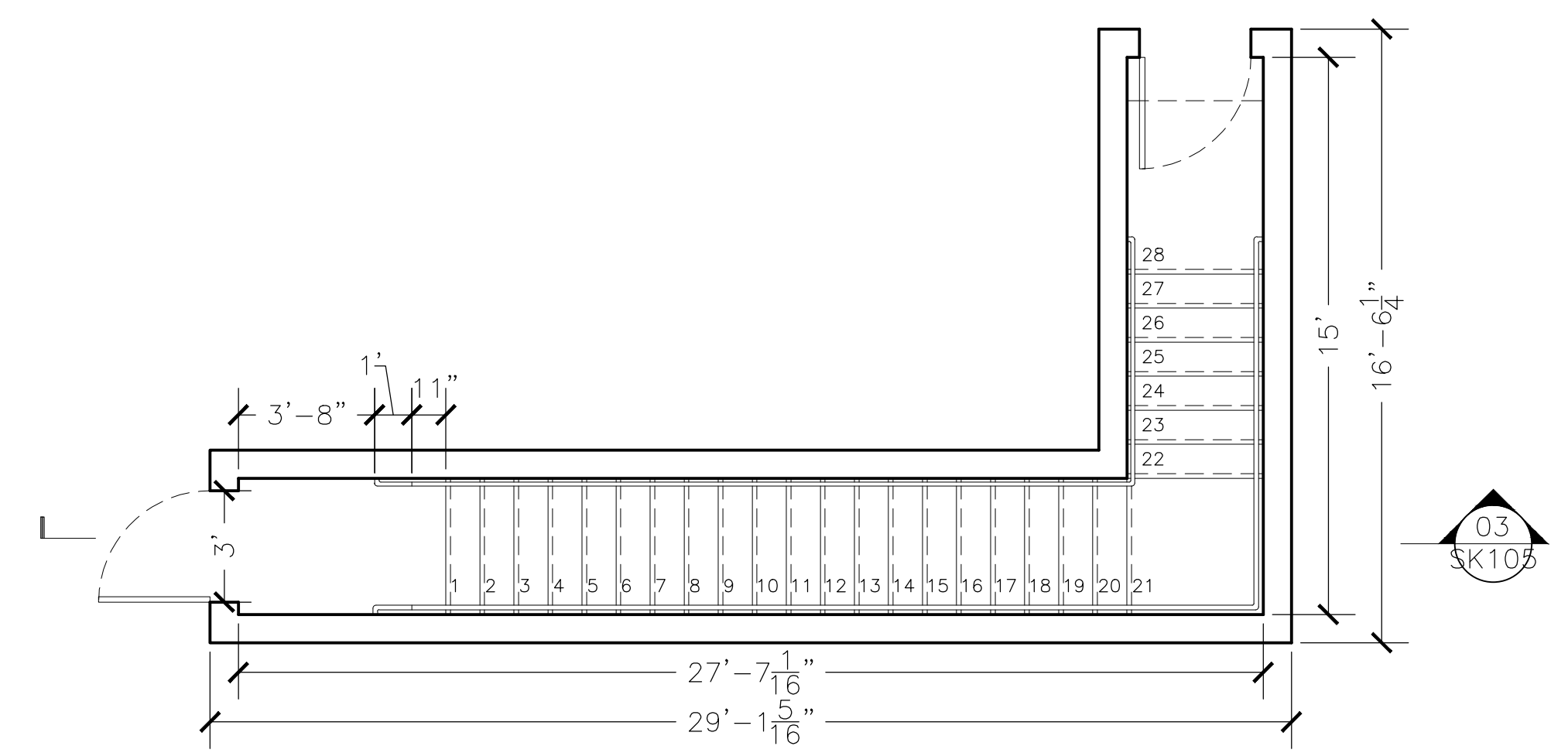

01 16'-0" L-SHAPE STAIR PLAN
1/4" = 1'-0"

STAIR STUDIES

| | |
|----------------|----------------|
| Project number | 01.2014 |
| Date | 10.11.14 |
| Drawn by | MARIE BARETSKY |
| Professor Name | KING |

SK-105

Scale 1/4" = 1'-0"



NYCCT

Project Address:
285 JAY STREET
BROOKLYN NY, 10021

Architect:
Name
Address
Email

| Rev. # | Description | Date |
|--------|--------------|----------|
| 01 | SUBMISSION 1 | 9/29/14 |
| 02 | SUBMISSION 2 | 10/11/14 |

| | |
|---|-------------------|
| STAIR HEIGHT | 16'0" |
| MAX. RISER HEIGHT | 7" |
| NUMBER OF RISERS | 28 |
| $192"/7" = 27.4$ | |
| RISER HEIGHT | 6 $\frac{7}{8}$ " |
| $192"/28 = 6\frac{7}{8}"$ | |
| TREAD WIDTH | 11" |
| $24" > 2 \times (6\frac{7}{8} ") + T < 25\frac{1}{2} "$ | |
| $10\frac{1}{2} " > T < 11\frac{3}{4} "$ | |

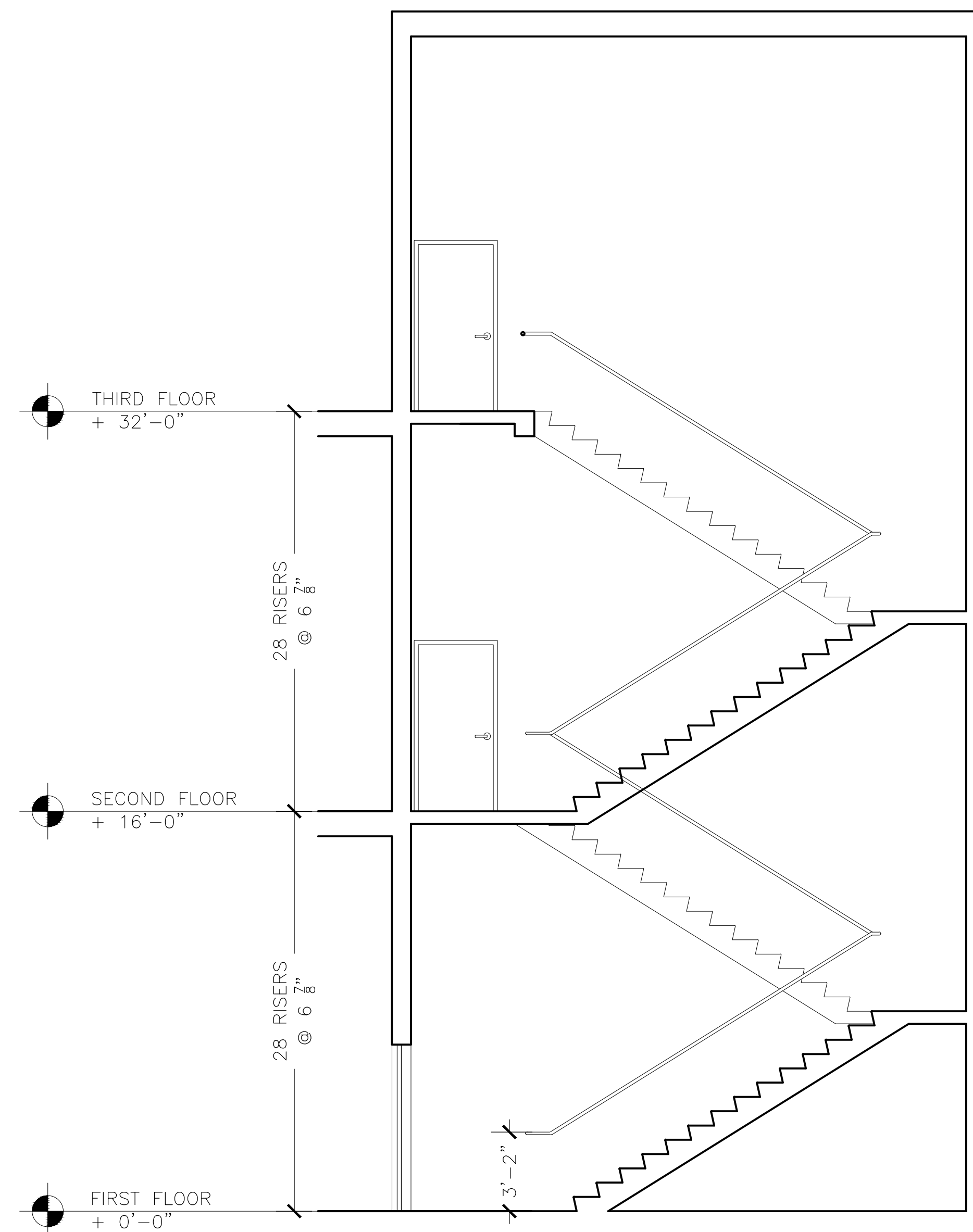

02 SK-106 16'-0" "U"-SHAPE STAIR SECTION
1/4" = 1'-0"

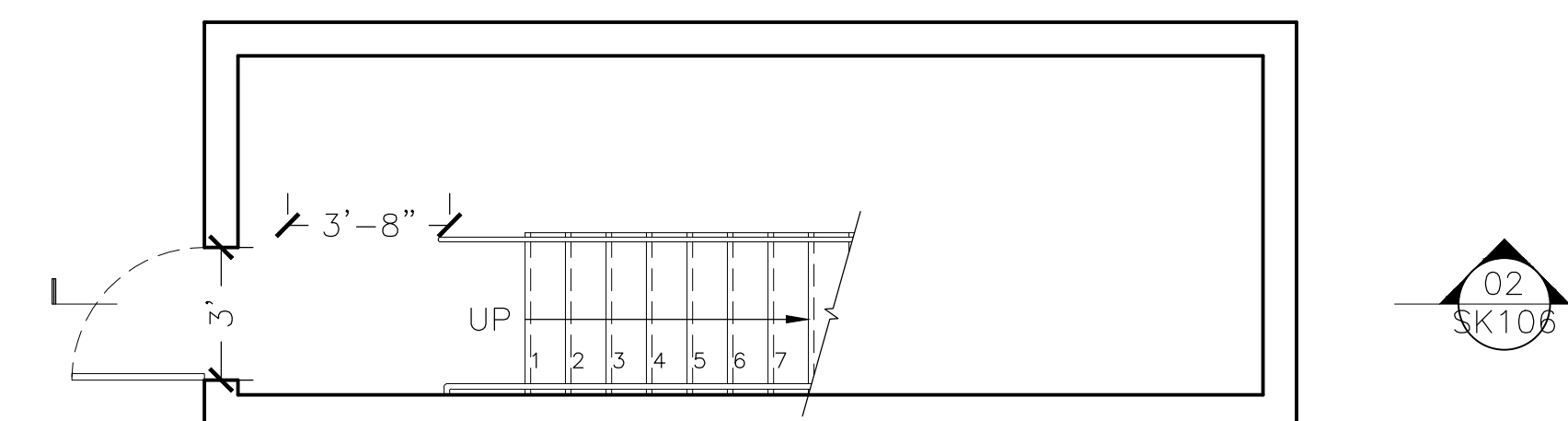
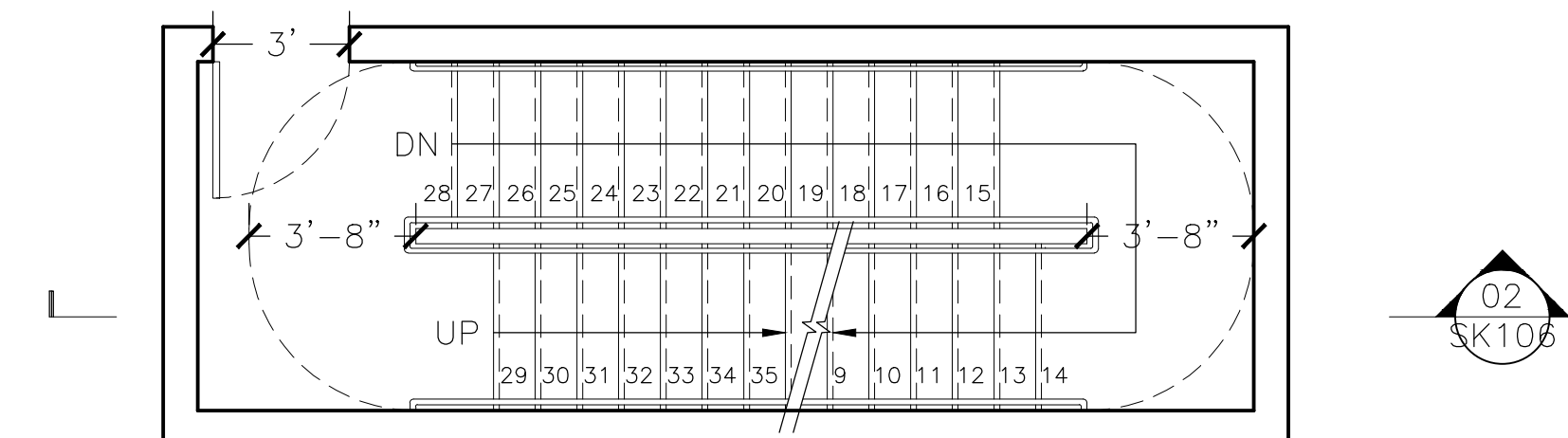
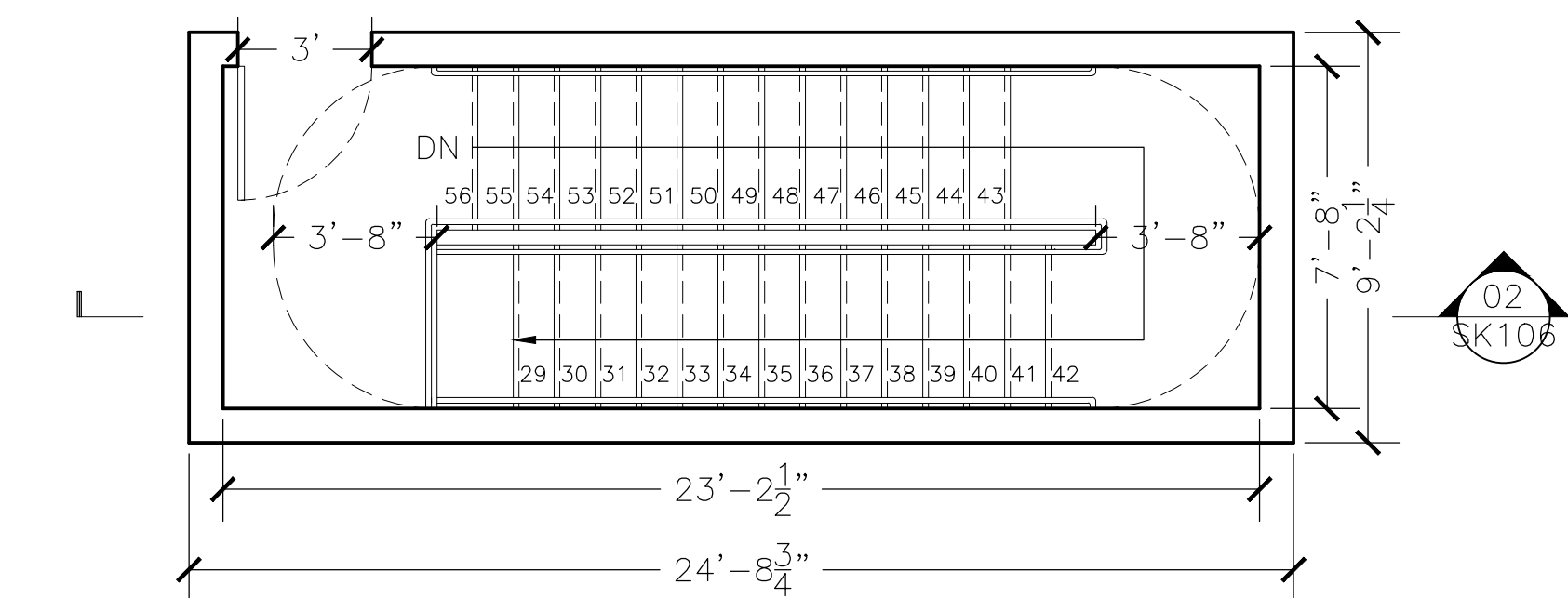

01 SK-106 16'-0" "U"-SHAPE STAIR PLANS
1/4" = 1'-0"

STAIR STUDIES

| | |
|----------------|----------------|
| Project number | 01.2014 |
| Date | 10.11.14 |
| Drawn by | MARIE BARETSKY |
| Professor Name | KING |

SK-106

Scale 1/4" = 1'-0"