

HUMAN DIMENSIONS

Note: All dimensions are ranges from several sources in inches and rounded to the nearest inch. Where a range is given, lower numbers tend to be for women and the higher numbers for men. The average of the two tends to be the standard average.

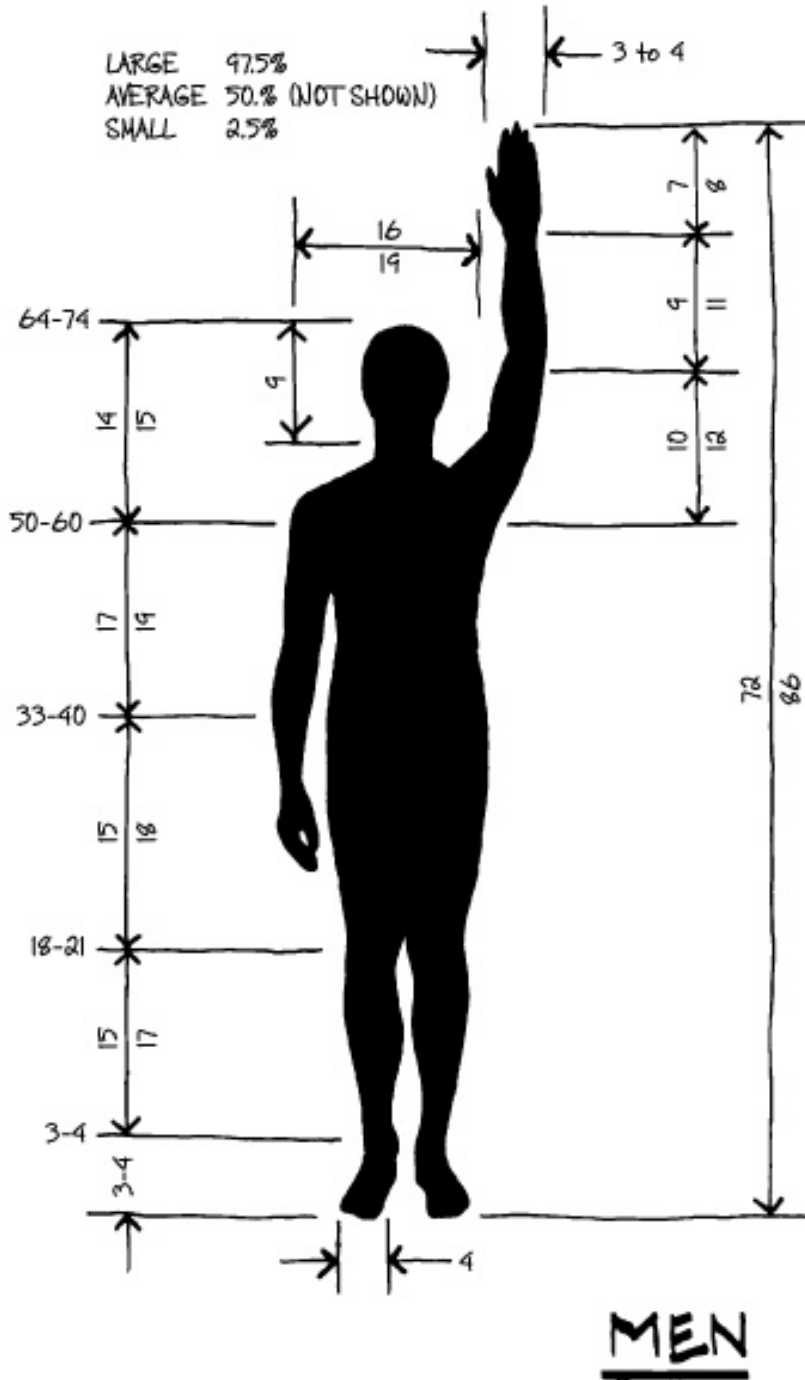

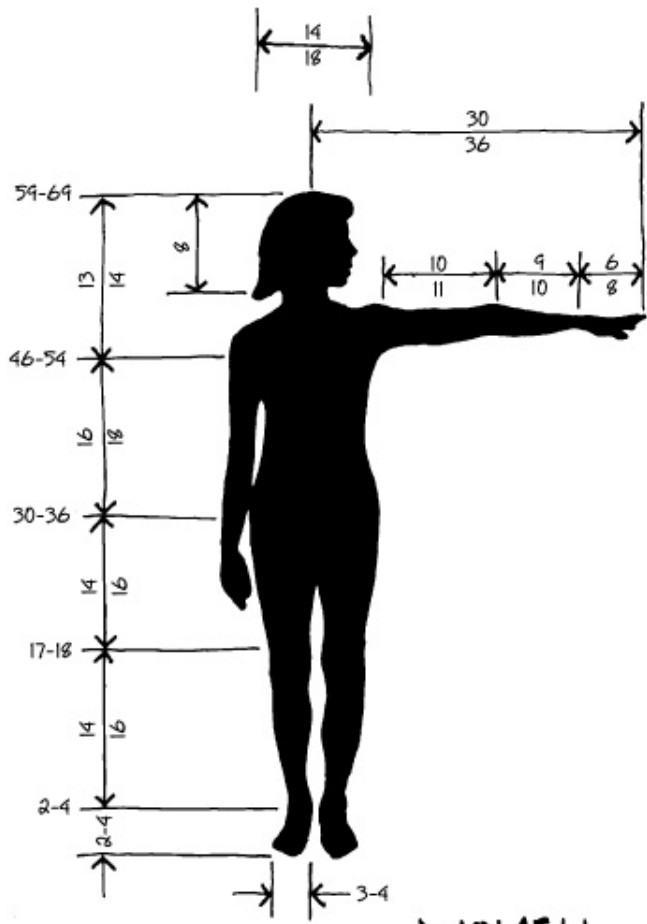

WOMEN

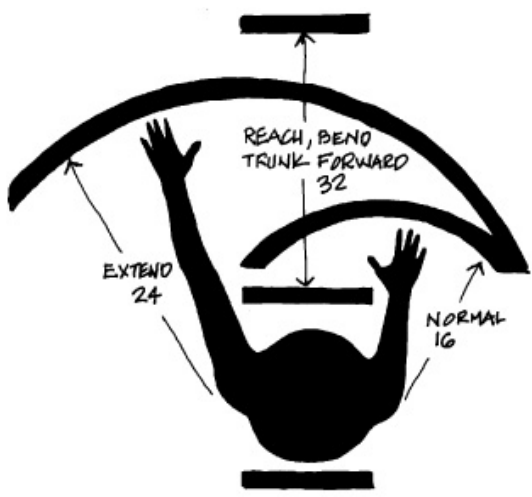

REACH

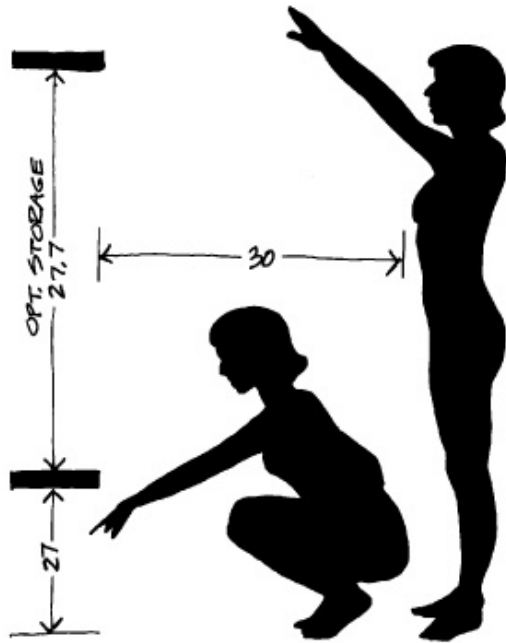

OVERHEAD/ UNDER COUNTER REACH

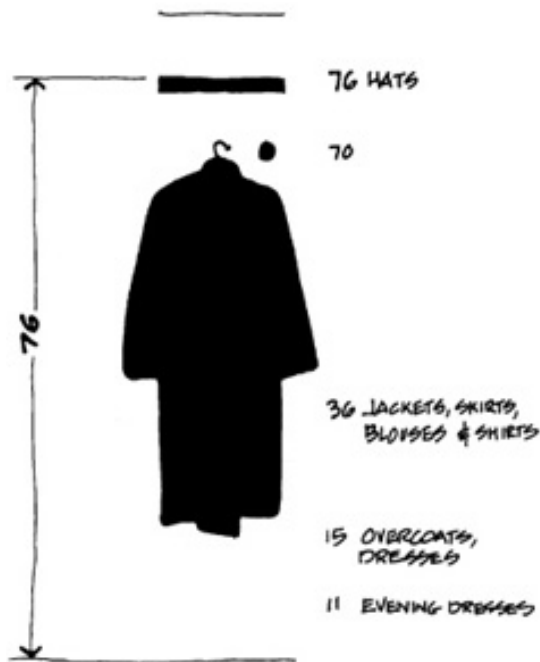

CLOSET

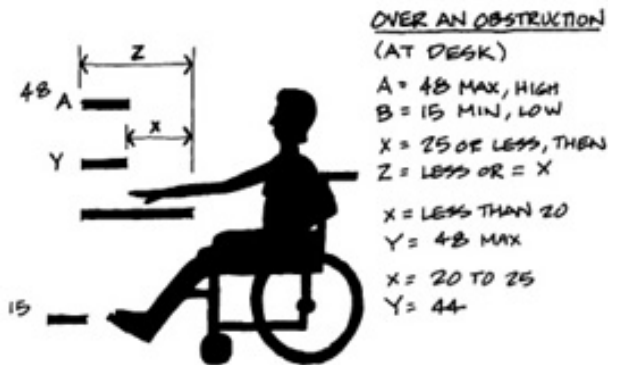
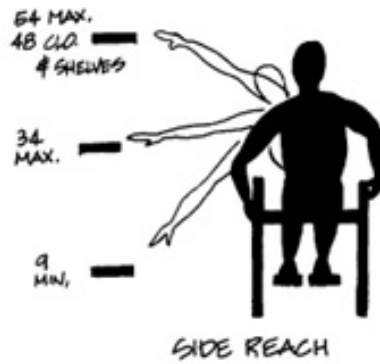

**FORWARD REACH
WHEELCHAIR (ADA)**

SPACE PLANNING

Planning considerations should include adequate floor and wall space for furniture groupings, window locations, and separation of traffic ways from centers of activity. Ideally there should be no through-traffic. If such traffic is necessary, it should be at one end, with the remaining portion of the room a dead-end space. During social activities, people tend to gather or congregate in relatively small groups.

Residential:

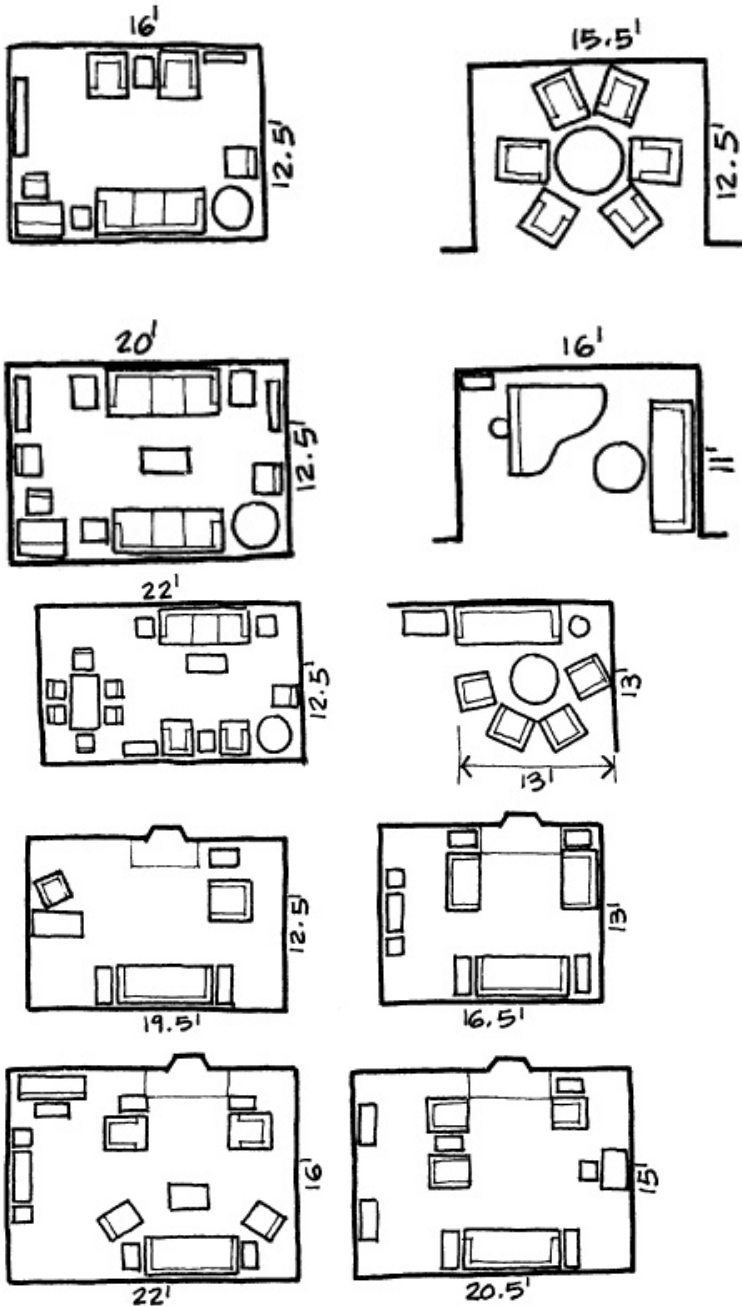

Public Waiting

The following layouts depict typical office waiting and public spaces.

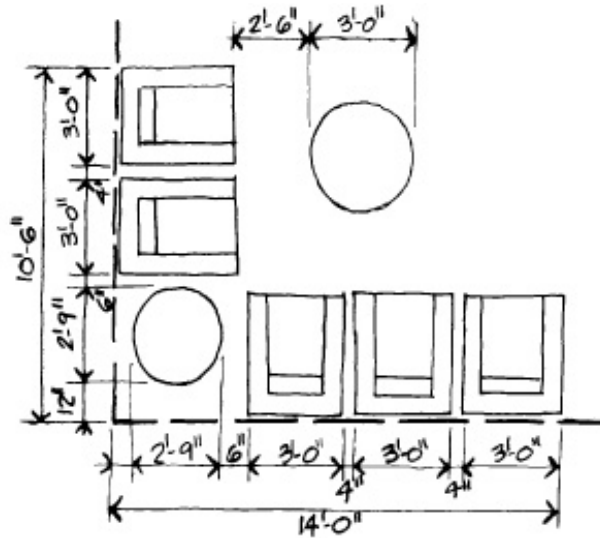
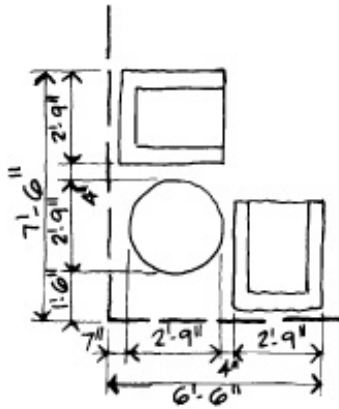

SEATING FOR FOUR

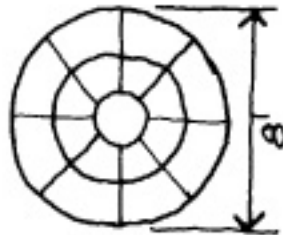

SEATING FOR EIGHT

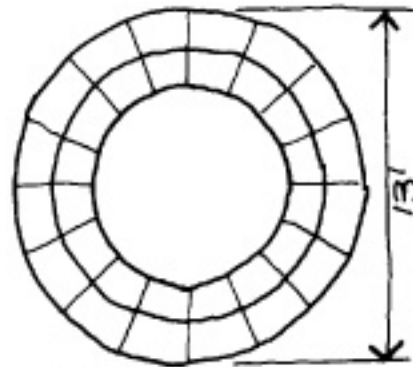

SEATING FOR 16

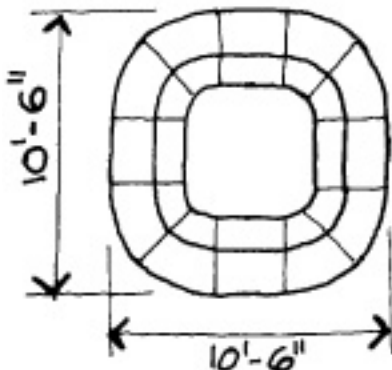

SEATING FOR 12

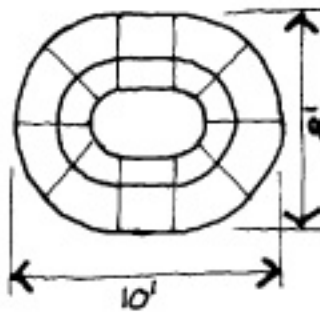

SEATING FOR 10

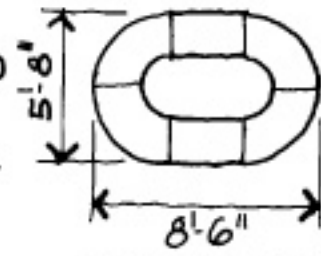

SEATING FOR 6

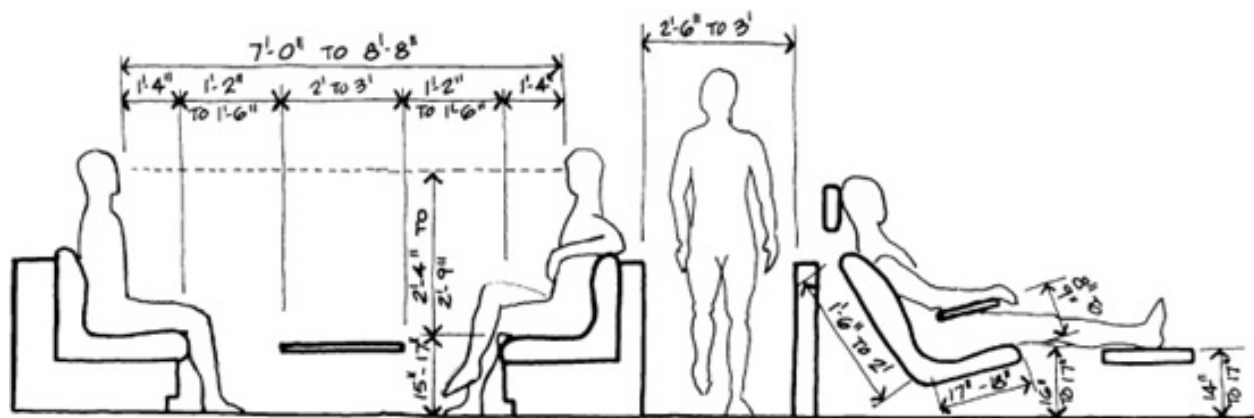
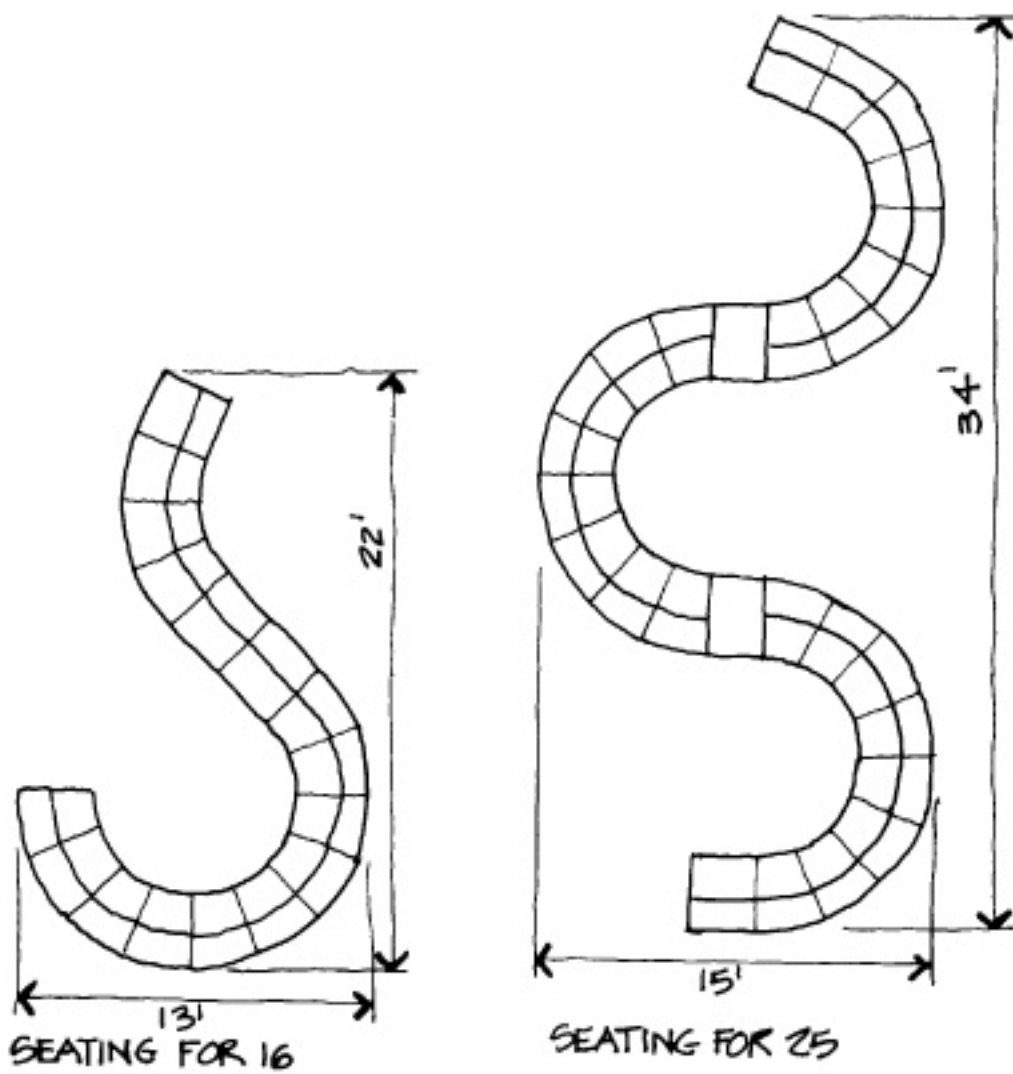

Furniture Dimensions

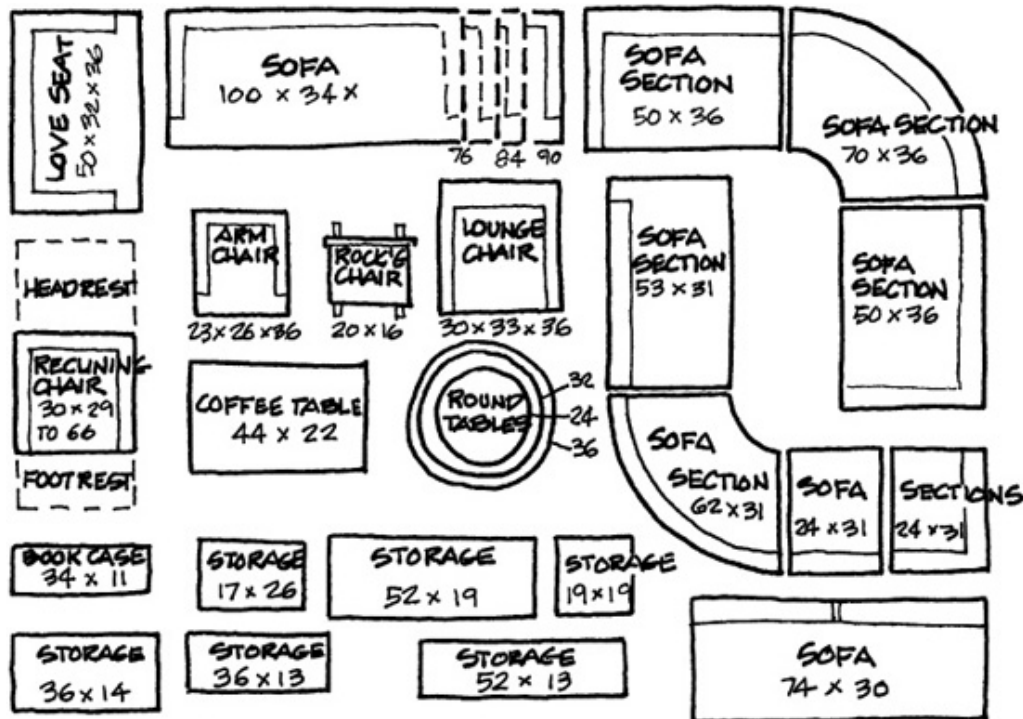
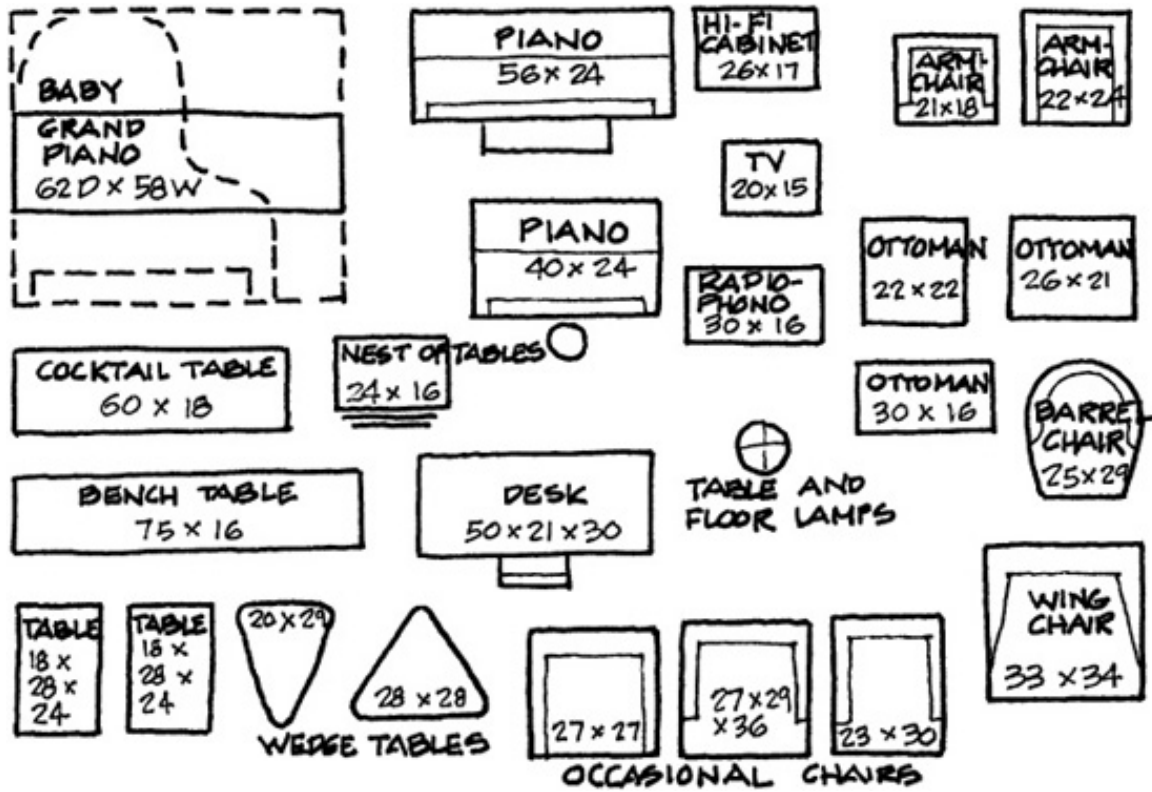

Bedrooms

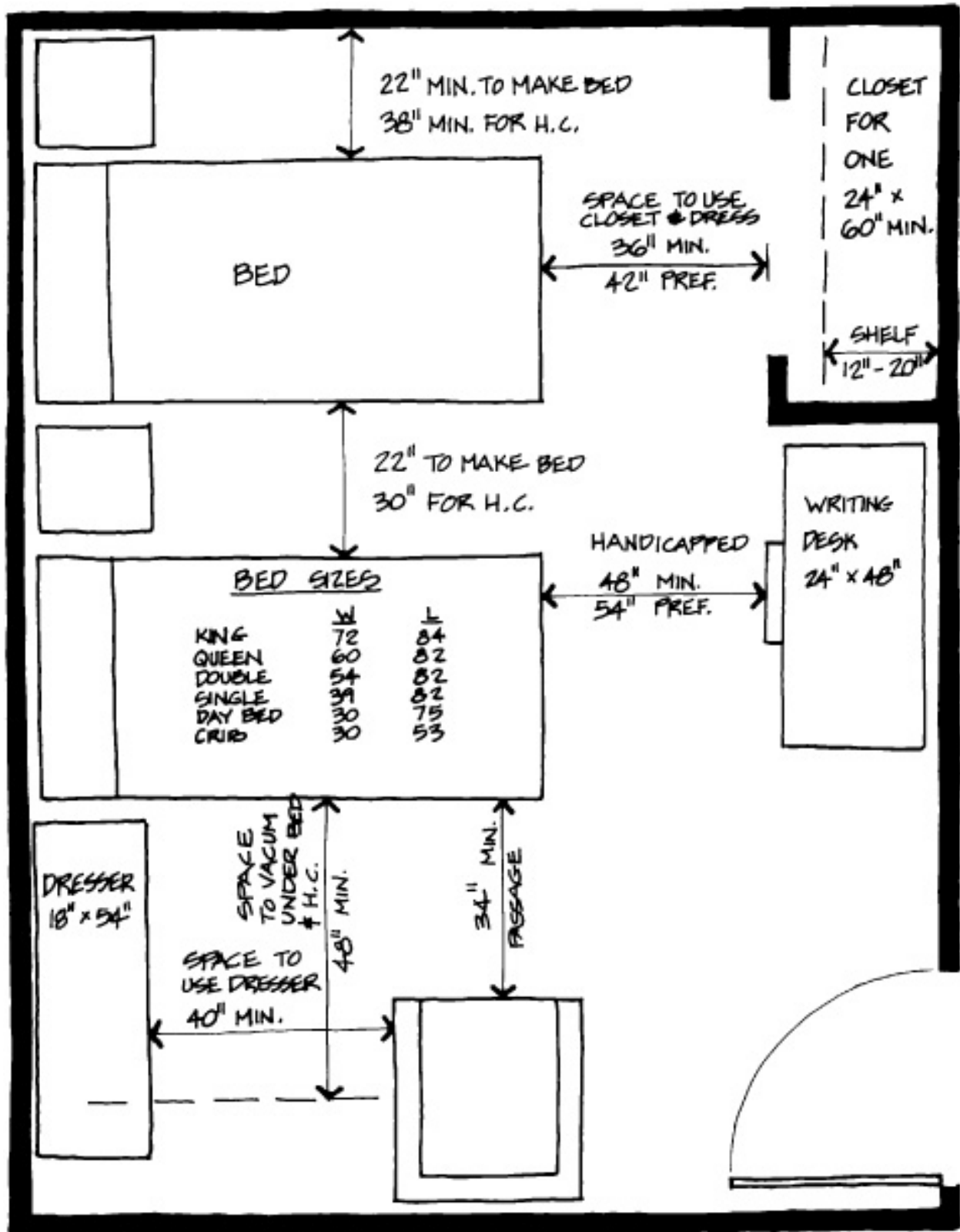

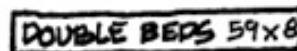
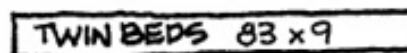
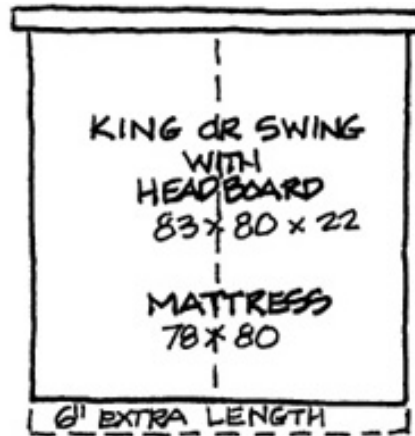
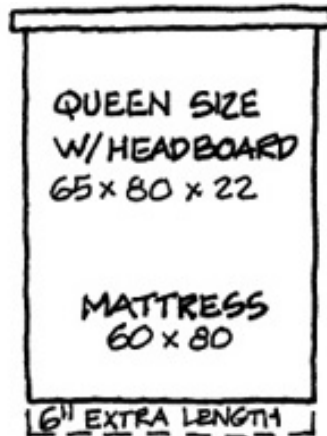
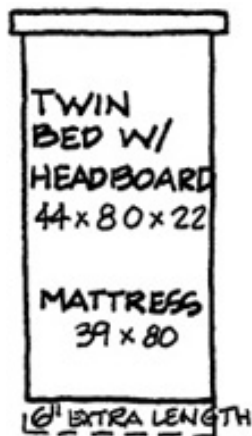
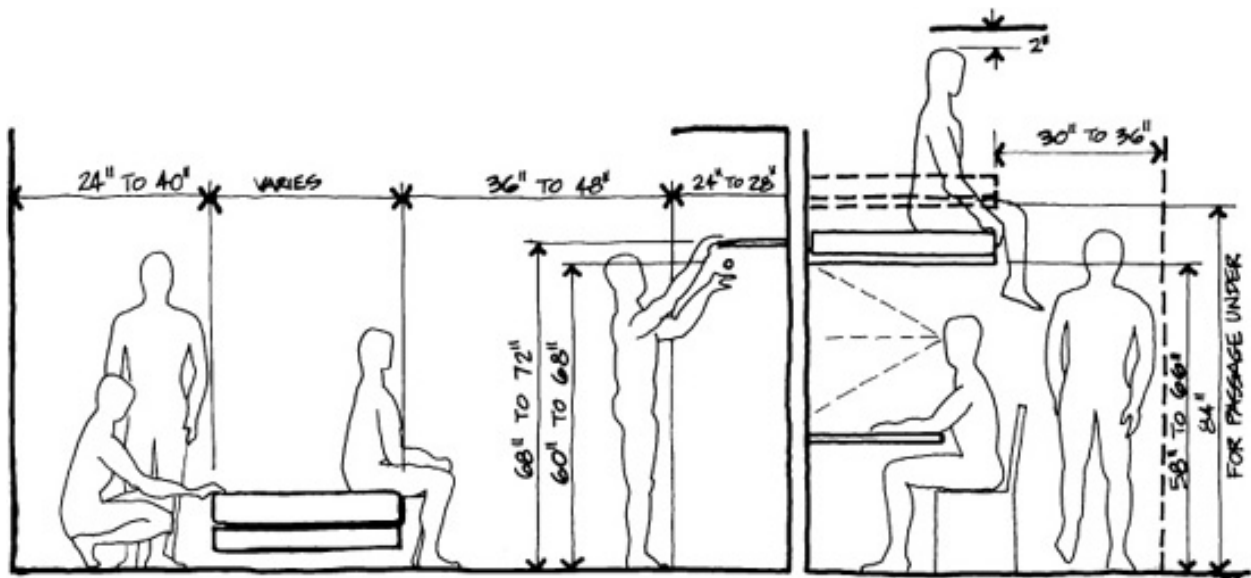

STORAGE
HEADBOARDS

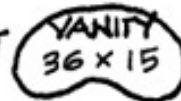
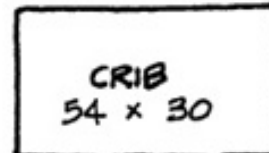
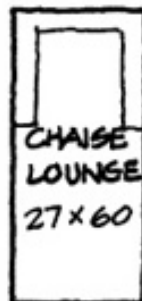

DRESSING
TABLE
48 x 20 x 30

SOFA BED
66 x 34

SOFA BED
84 x 34

CHAIR
25 x 20 x 30

16 x 16 x 30

NIGHT
TABLES

15 x 18

18 x 23 x 30

OPENS TO THIS
SIZE

OPENS TO THIS SIZE

CHEST
42 x 21 x 44
TO 56

CHEST
48 x 21 x 36

MR & MRS. CHEST
60 x 21 x 36

CHEST
66 x 21 x 36

CHEST
30 x 21
x 44 TO 56

CHEST
36 x 21 x 36

STOOL
18 x 18

STOOL
28 x 12

CHEST
66 x 17 x 36

CHEST
30 x 17 x 36

CHEST
36 x 17 x 36

CHEST
42 x 17 x 36

CHEST
48 x 17 x 36

CHEST
60 x 17 x 36

Typical Hotel Room layouts

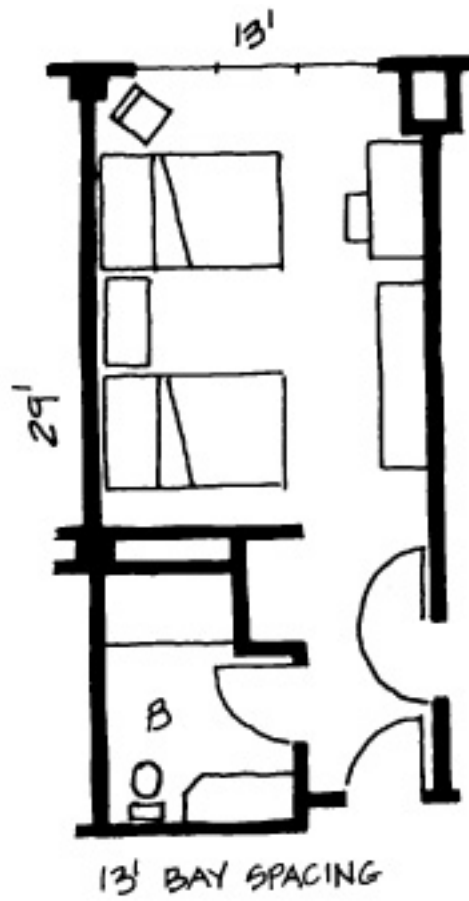
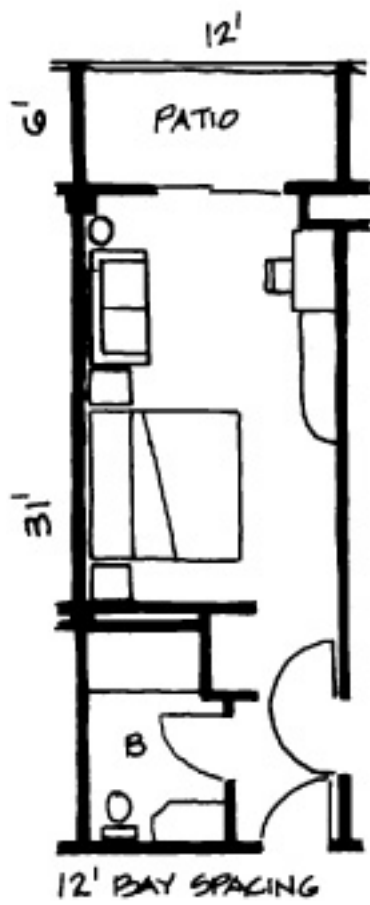

Dining Areas

Residential:

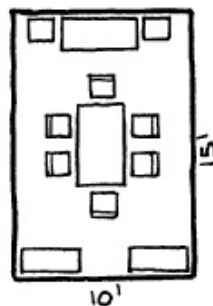
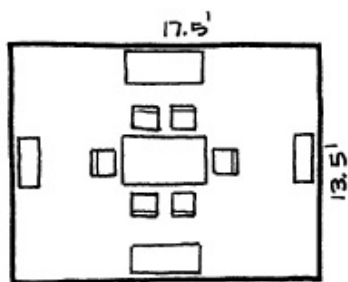
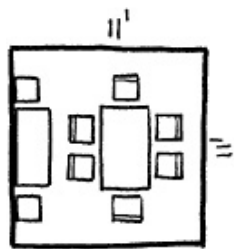

Restaurant Layout:

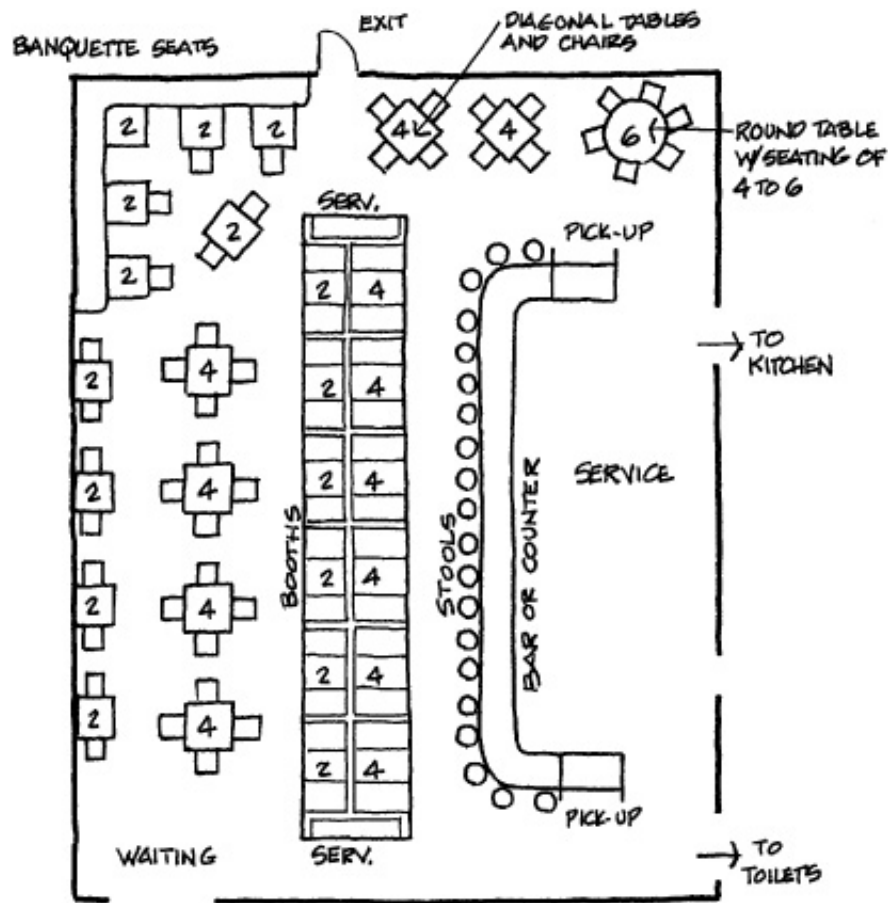

↑ ENTRY TYPICAL "FRONT OF HOUSE" LAYOUT

Estimated Dining Areas ("Front of House" Only)

Type	Dining Space (SF/Seat)
Table	10 to 20
Counter	15 to 20
Booth	10 to 15
Cafeteria	10 to 15
Banquet	10 to 15

Estimated Areas for Total Restaurant Building

Type of Operation	Area (SF/Seat)
Table Service	25 to 35
Counter Service	20 to 25
Booth Service	20 to 30
Cafeteria Service	20 to 30

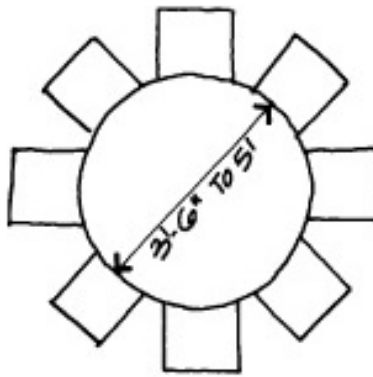
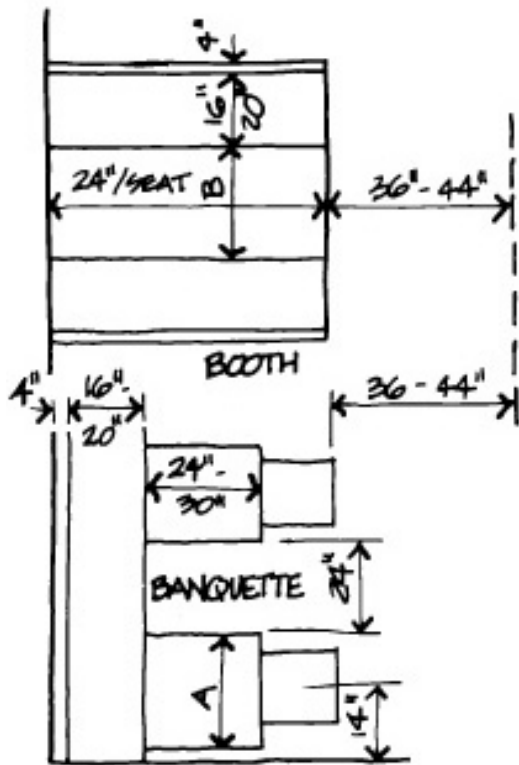

ROUND TABLE

DIMENSIONS (INCHES)

MARK	MIN.	AVE.	AMPLE	OTHER
A	24		30*	* OR W/ ARMCHAIR
B	24	30	36	
C	36		44*	* FOR SERV. BEHIND
D	30	34	42	18 WINDLOW AIR 18 COCKTAIL
	48		60	5-6 SEATS ROUND TABLE
E	66	70	78	
F	55	59	67	

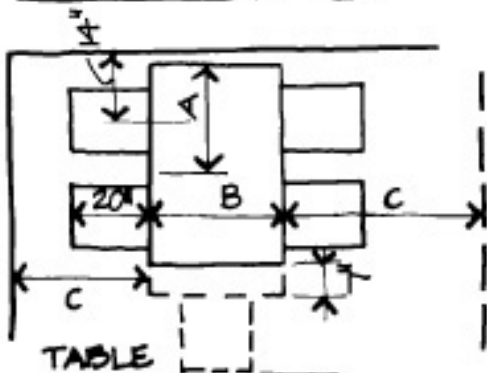

TABLE

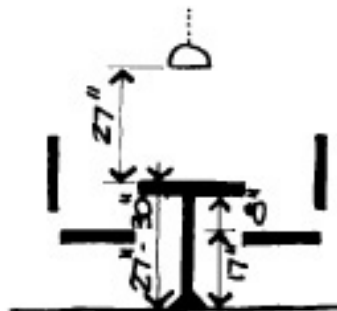

TABLE



COUNTER/BAR

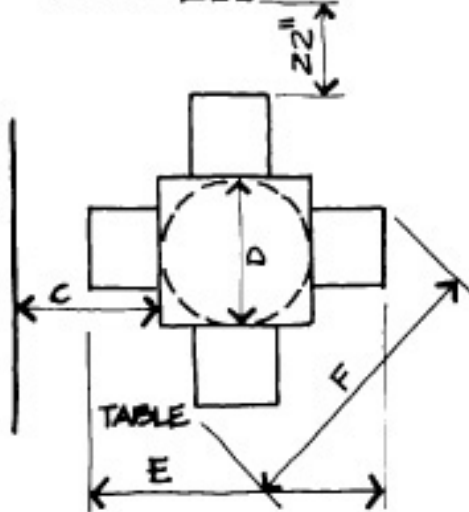

BANQUETTE



BANQUETTE

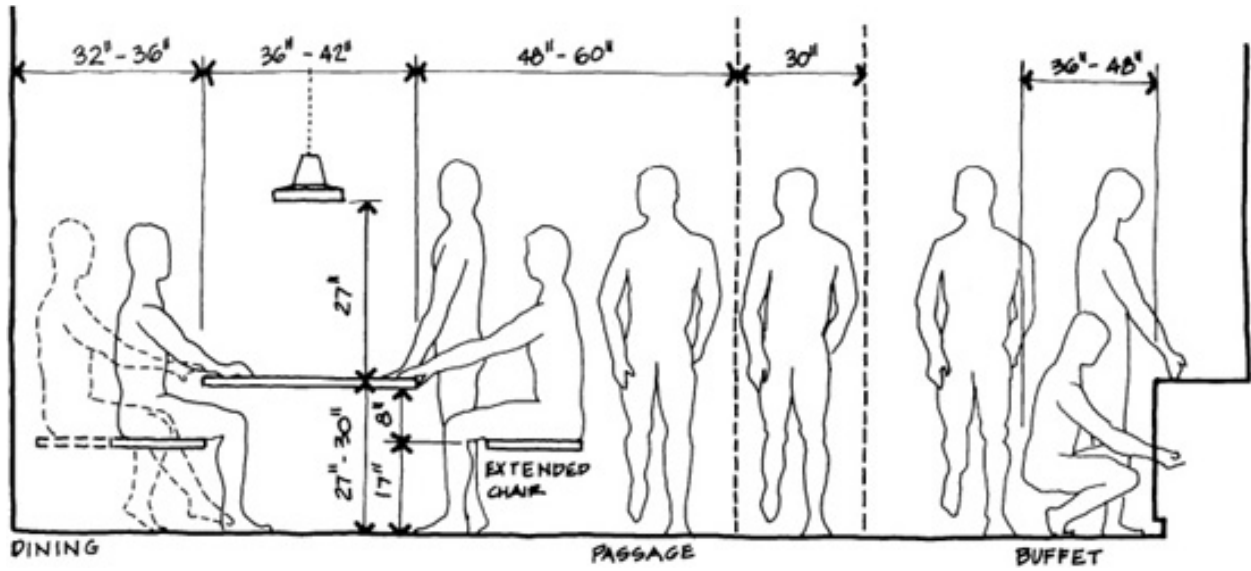

All these information came from:

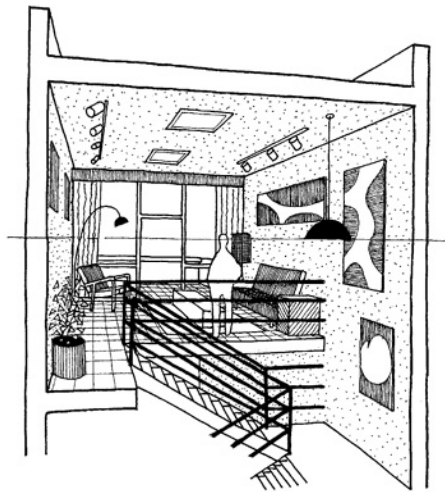

**INTERIOR DESIGNER'S
PORTABLE HANDBOOK**

FIRST-STEP RULES OF THUMB FOR THE DESIGN OF INTERIORS

Third Edition

PAT GUTHRIE
ARCHITECT



New York Chicago San Francisco Lisbon London Madrid Mexico City
Milan New Delhi San Juan Seoul Singapore Sydney Toronto