

Site Strategy:

After you have developed a comprehensive site analysis, this information can be synthesized into one drawing demonstrating the most important findings that will shape your design.

This should be an overlay of many elements with a clear legend

Attached are many examples.

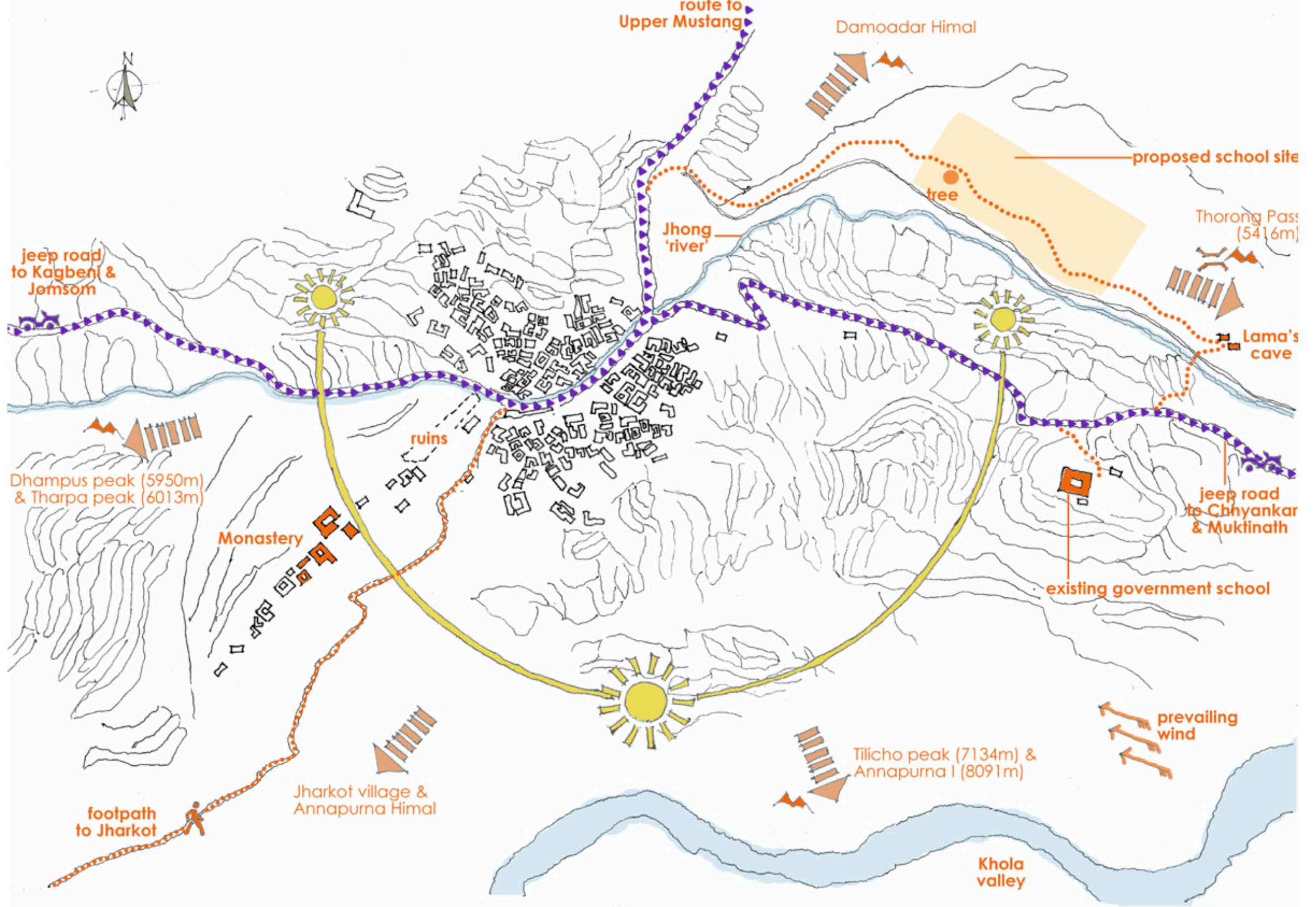

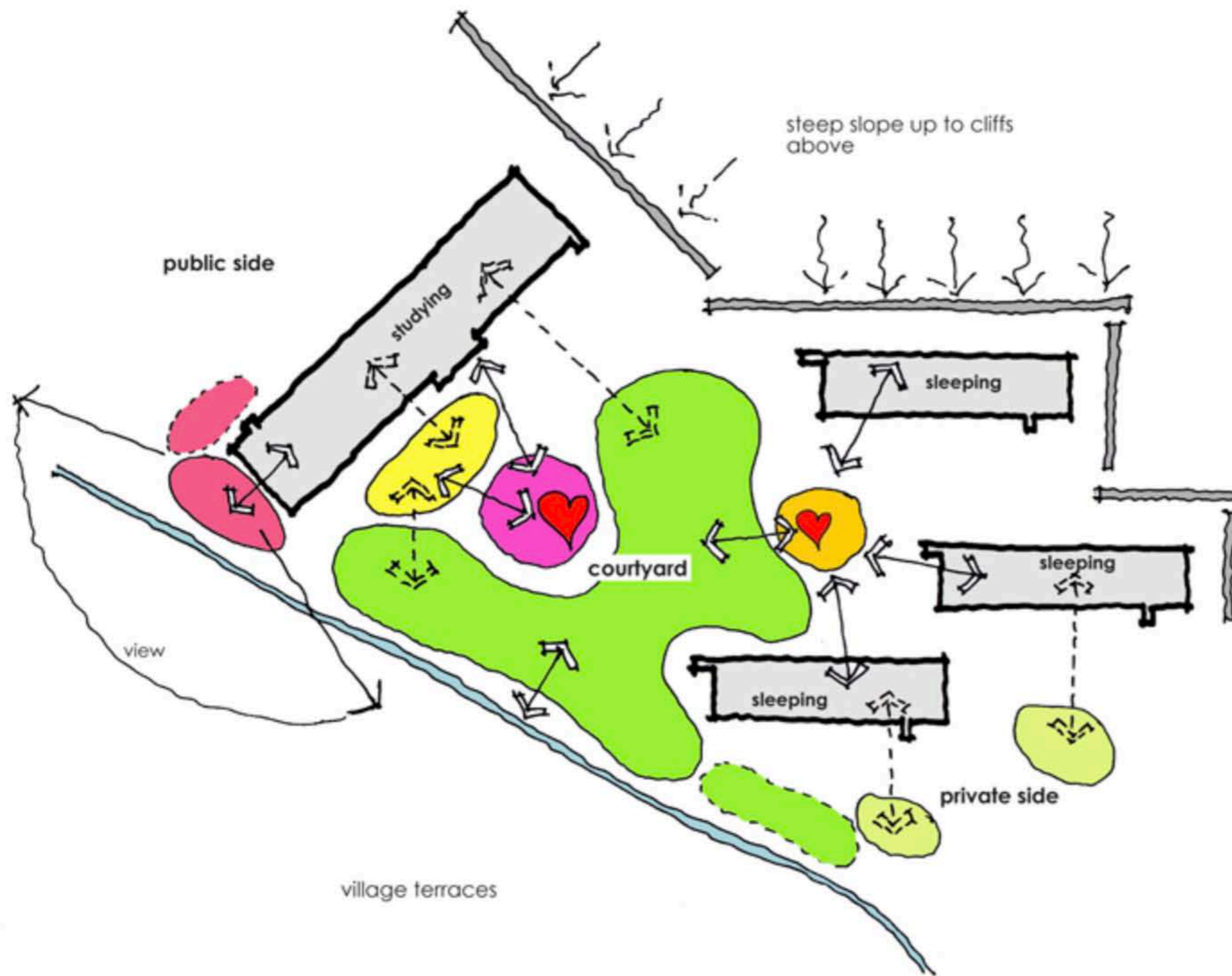

1 porch

public entrance and community meeting space with unlimited view
inviting entrance to the main study block including the office and the treatment area



2 stage

lively public space at the centre of the site
gathering space for events and performances, part of outdoor learning



3 learning

different size outdoor seating with visual connection to main study areas and stage



4 social gathering

partly shaded central meeting place at the heart of the sleeping accommodation, central communal area to socialise



5 relaxing

partly shaded private space
low maintenance growing area - orchard, informal outdoor learning



6 growing

following the local terraces pattern, vegetable 'garden' to produce own food
learning activity space, visual link to the study areas
recycling the waste from the toilets and the compost from the kitchen



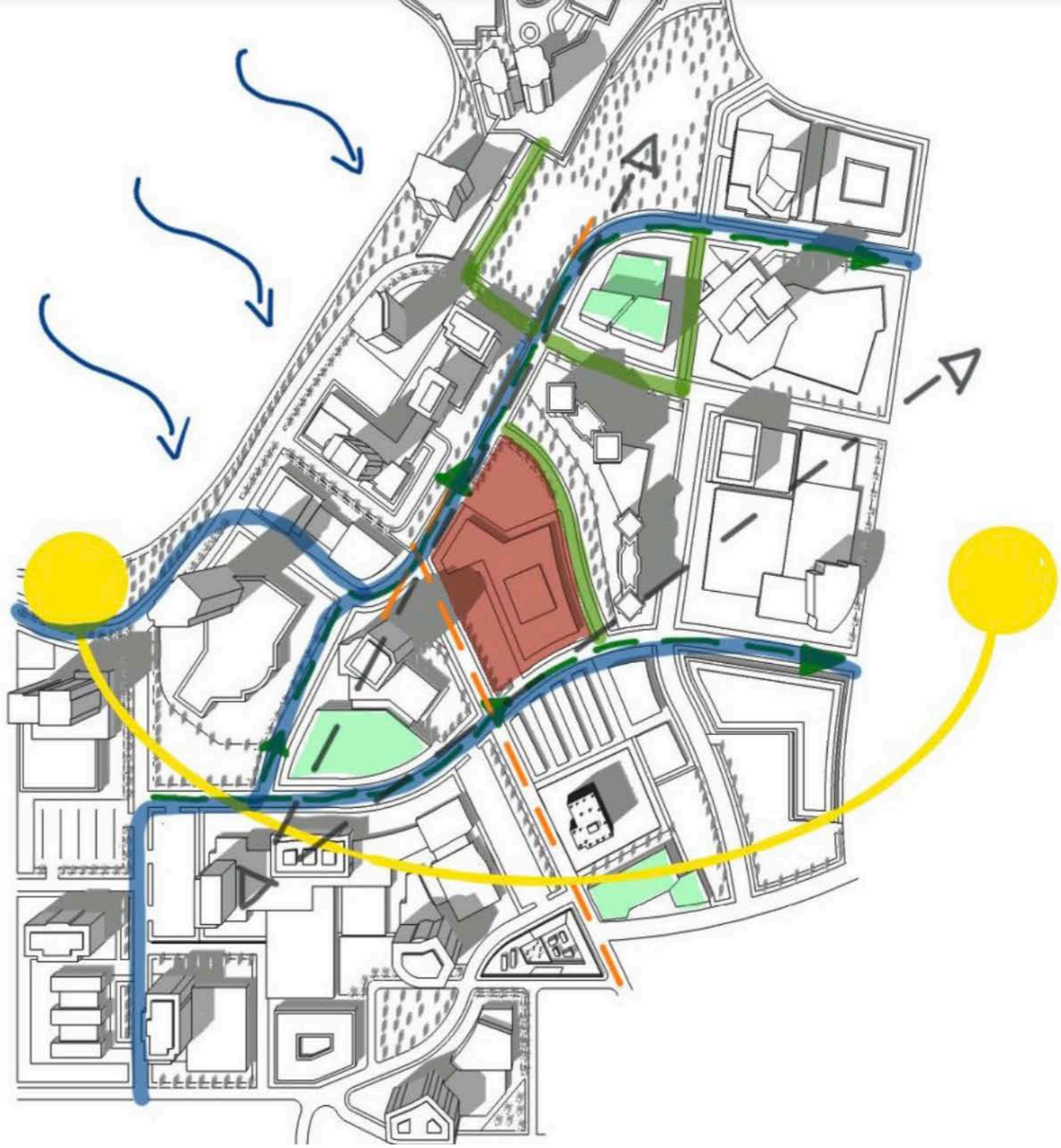

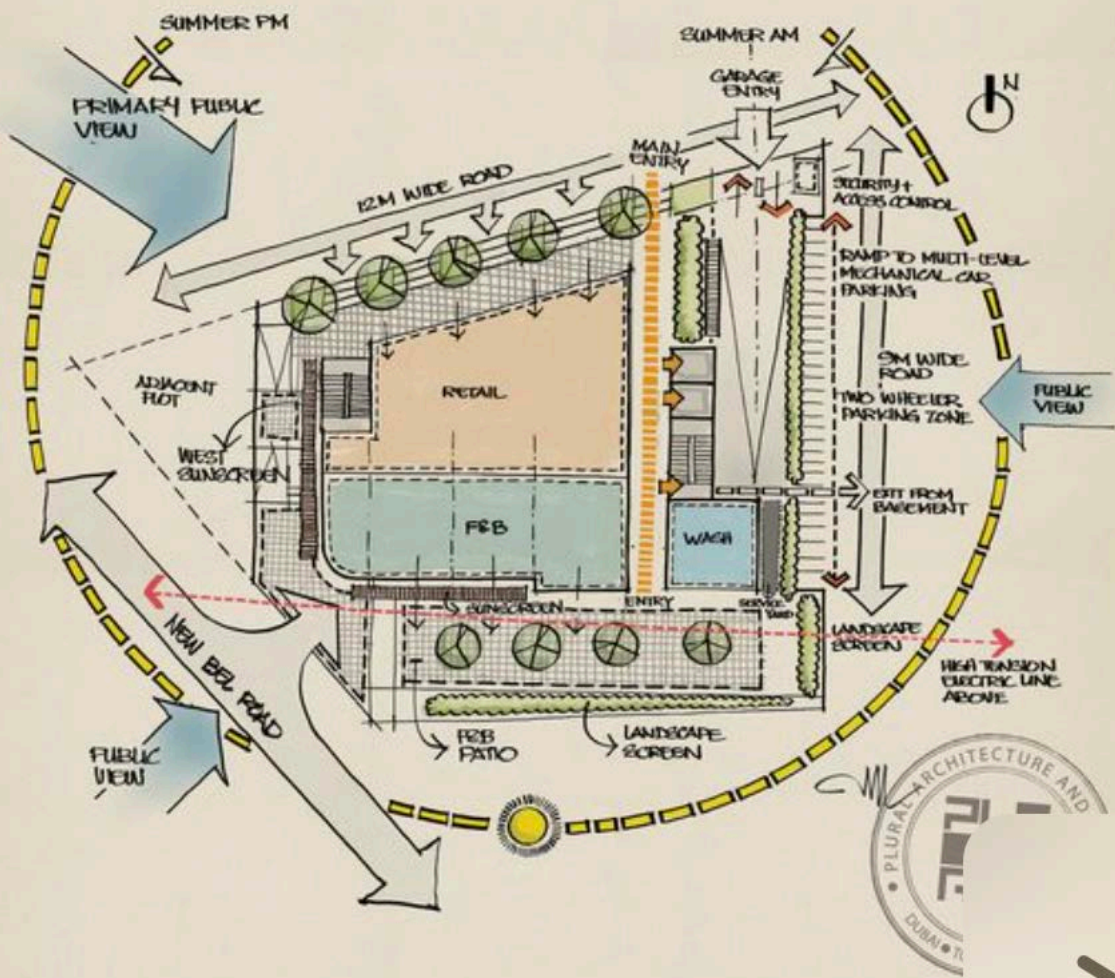

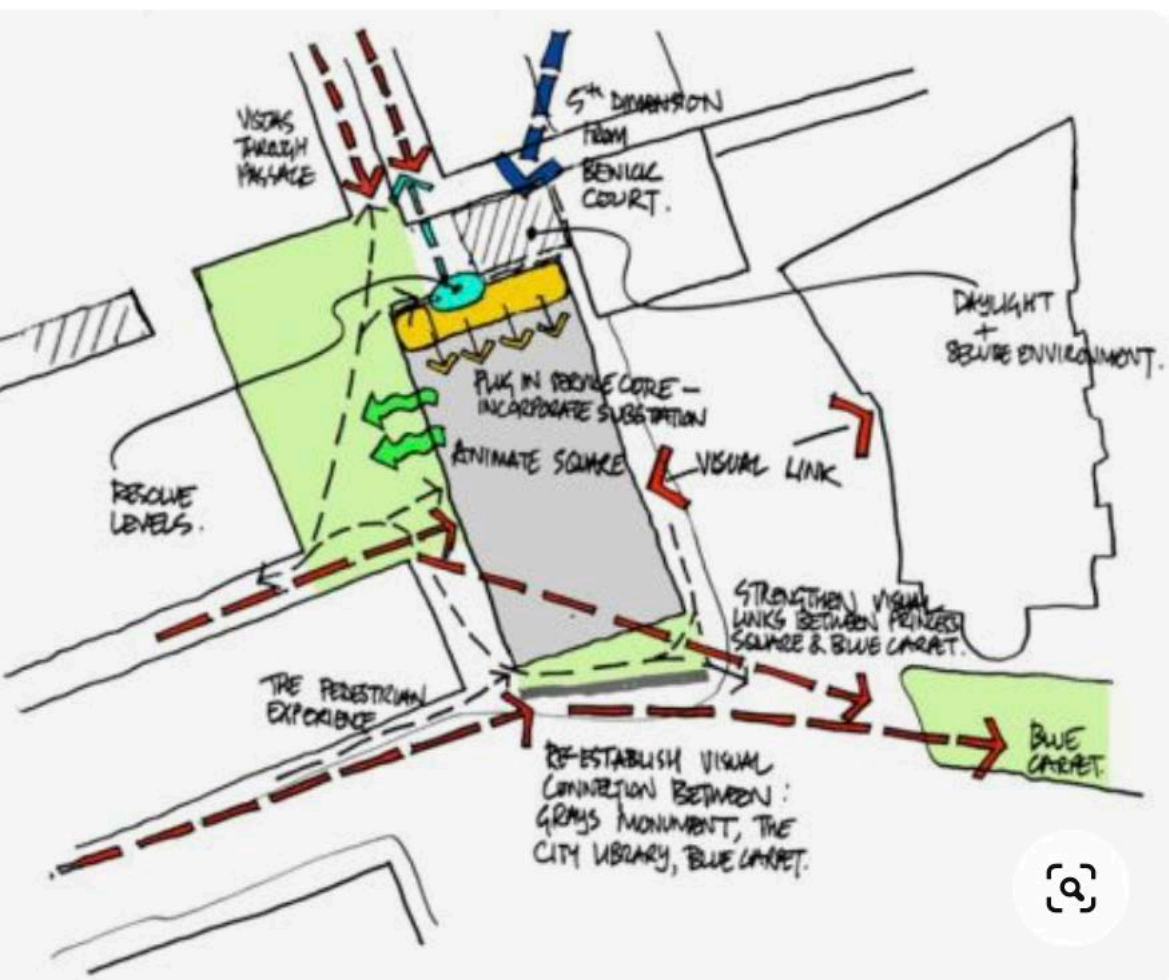

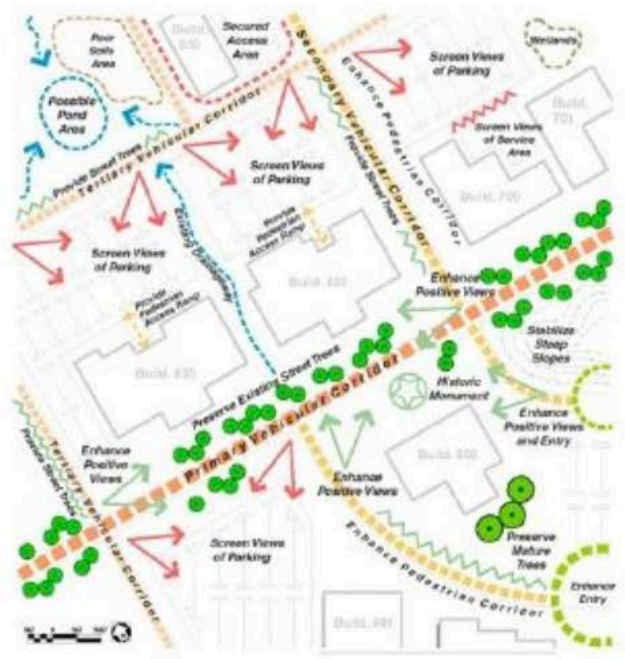
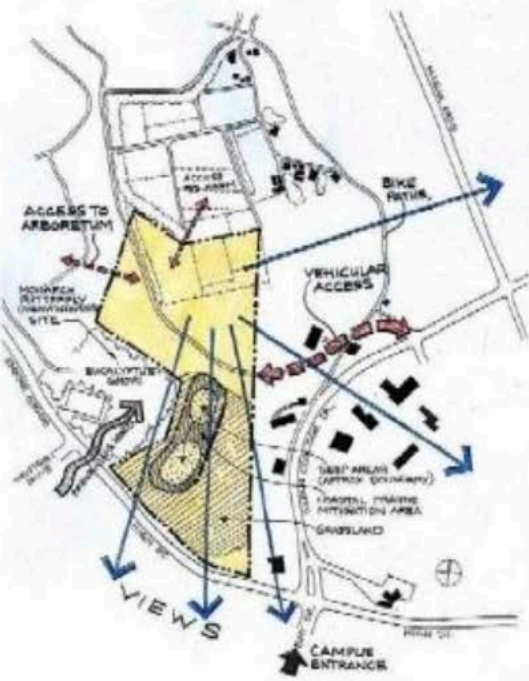

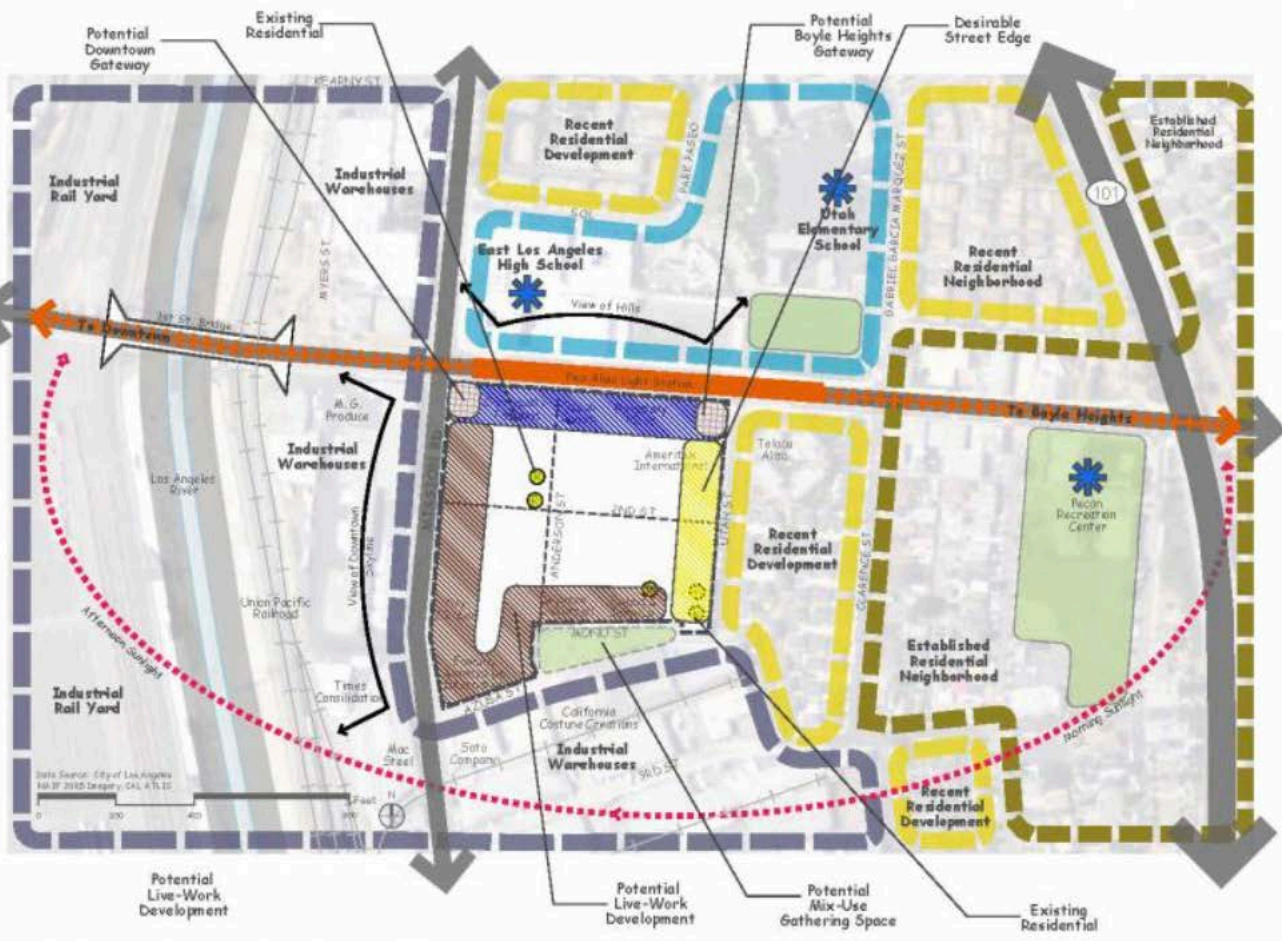

site analysis

The site analysis illustrates many of the environmental factors influencing the form of the LLC. Buildings are elongated in the east-west direction to maximize exposure to the winter sun and clustered together to protect outdoor gathering spaces from winter and spring winds.

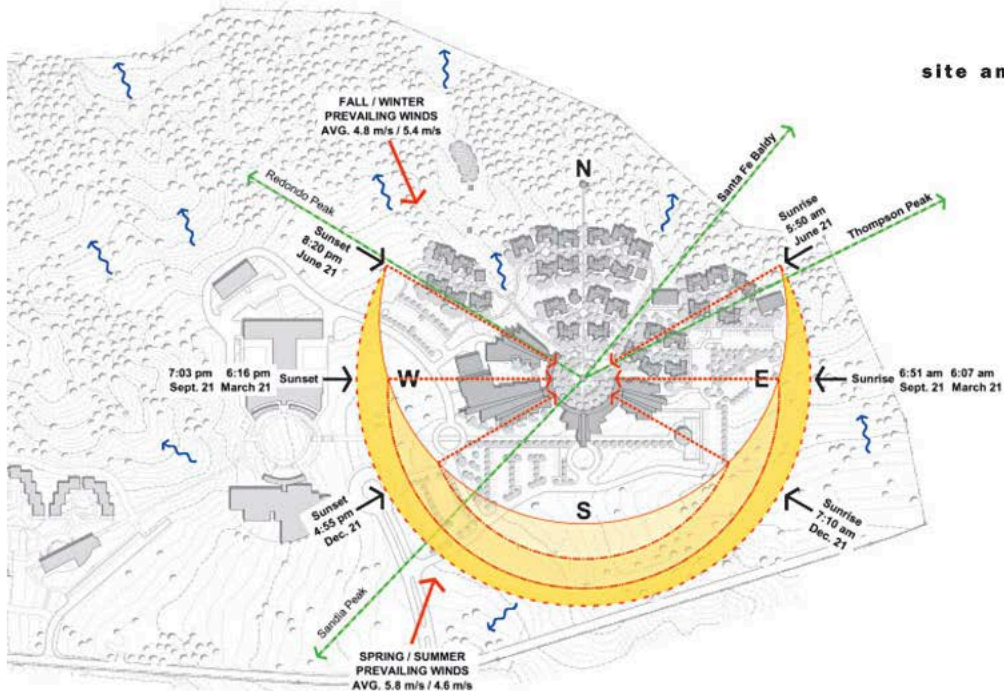

LEGEND

- Existing IAIA Campus Buildings
- Proposed LLC Buildings
- Water Surface Flow
- View Line
- Sunrise / Sunset Direction
- Winter Equinox Sun Path
- Autumnal, Vernal Equinox Sun Path
- Summer Solstice Sun Path



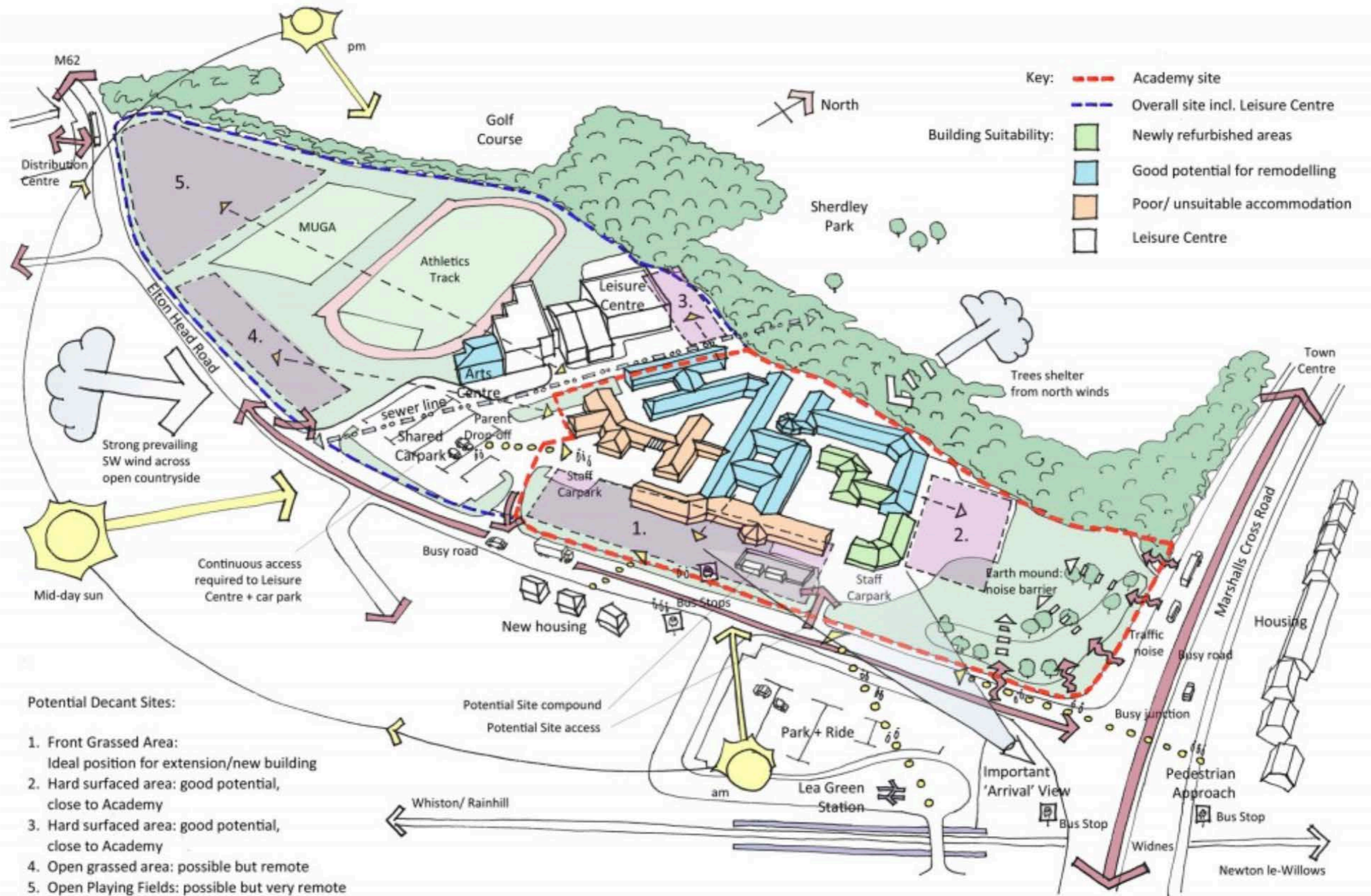

ISLAND STATION -- SITE ANALYSIS

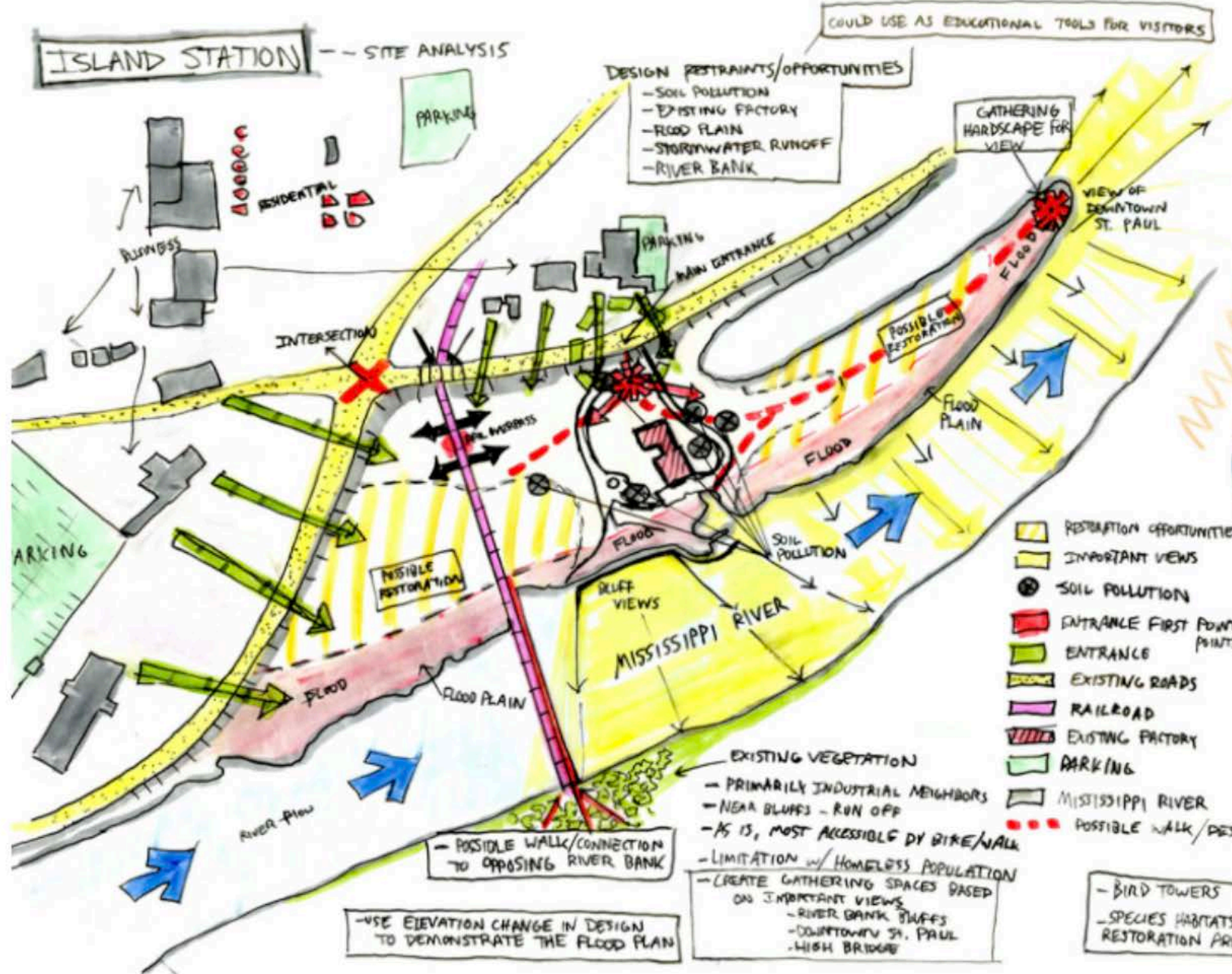

COULD USE AS EDUCATIONAL TOOLS FOR VISITORS

DESIGN RESTRAINTS/OPPORTUNITIES

- SOIL POLLUTION
- EXISTING FACTORY
- FLOOD PLAIN
- STORMWATER RUNOFF
- RIVER BANK

RELATIONSHIP DIAGRAM



- PLANTINGS USED TO SHOW AND EDUCATE ON SOIL POLLUTION

- RESTORE BUILDING AND CREATE URBAN STYLE GARDENS.
- INSTALL A SKY DECK/VIEWING PLATFORM AT ROOFTOP

- USE ELEVATION CHANGE IN DESIGN TO DEMONSTRATE THE FLOOD PLAN

EXISTING VEGETATION
- PRIMARILY INDUSTRIAL NEIGHBORS
- NEAR BLUFFS - RUN OFF
- AS IS, MOST ACCESSIBLE BY BIKE/WALK
- LIMITATION w/ HOMELESS POPULATION
- CREATE GATHERING SPACES BASED ON IMPORTANT VIEWS
- RIVER BANK BLUFFS
- DOWNTOWN ST. PAUL
- HIGH BRIDGE

- BIRD TOWERS
- SPECIES HABITATS IN RESTORATION AREAS

ERIC ALWARD

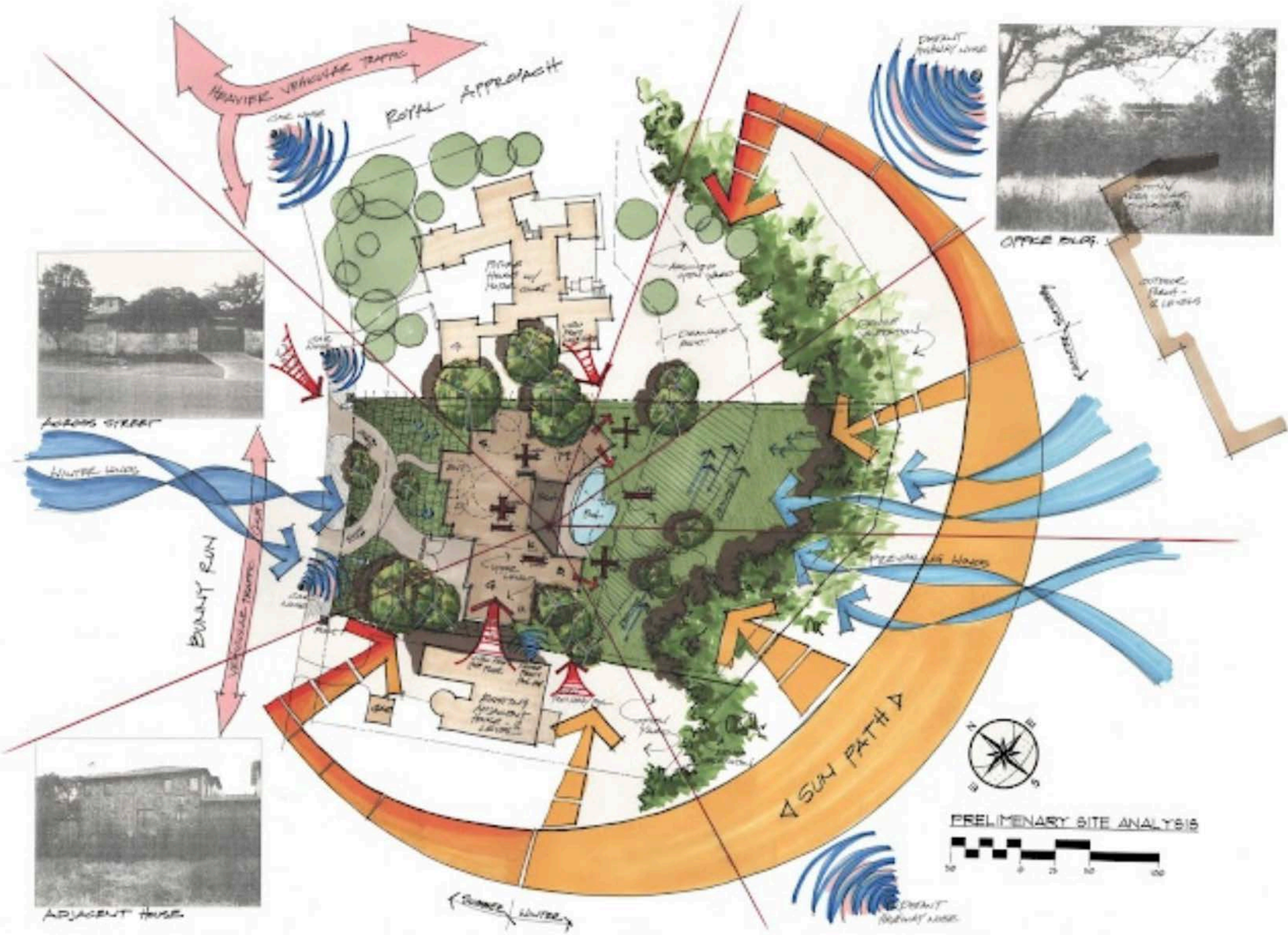



ISSUES & CONSTRAINTS

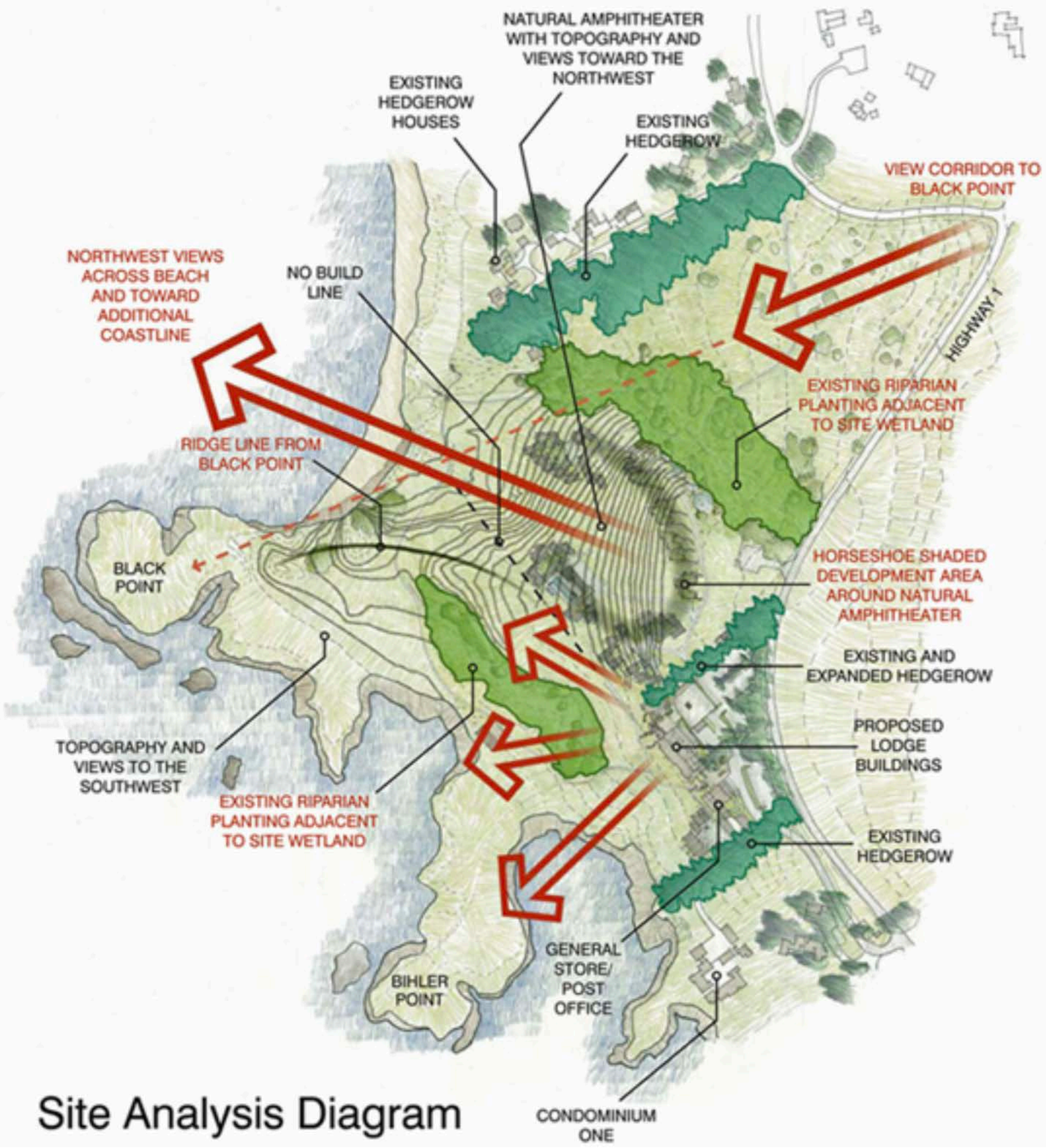

Site Analysis Diagram

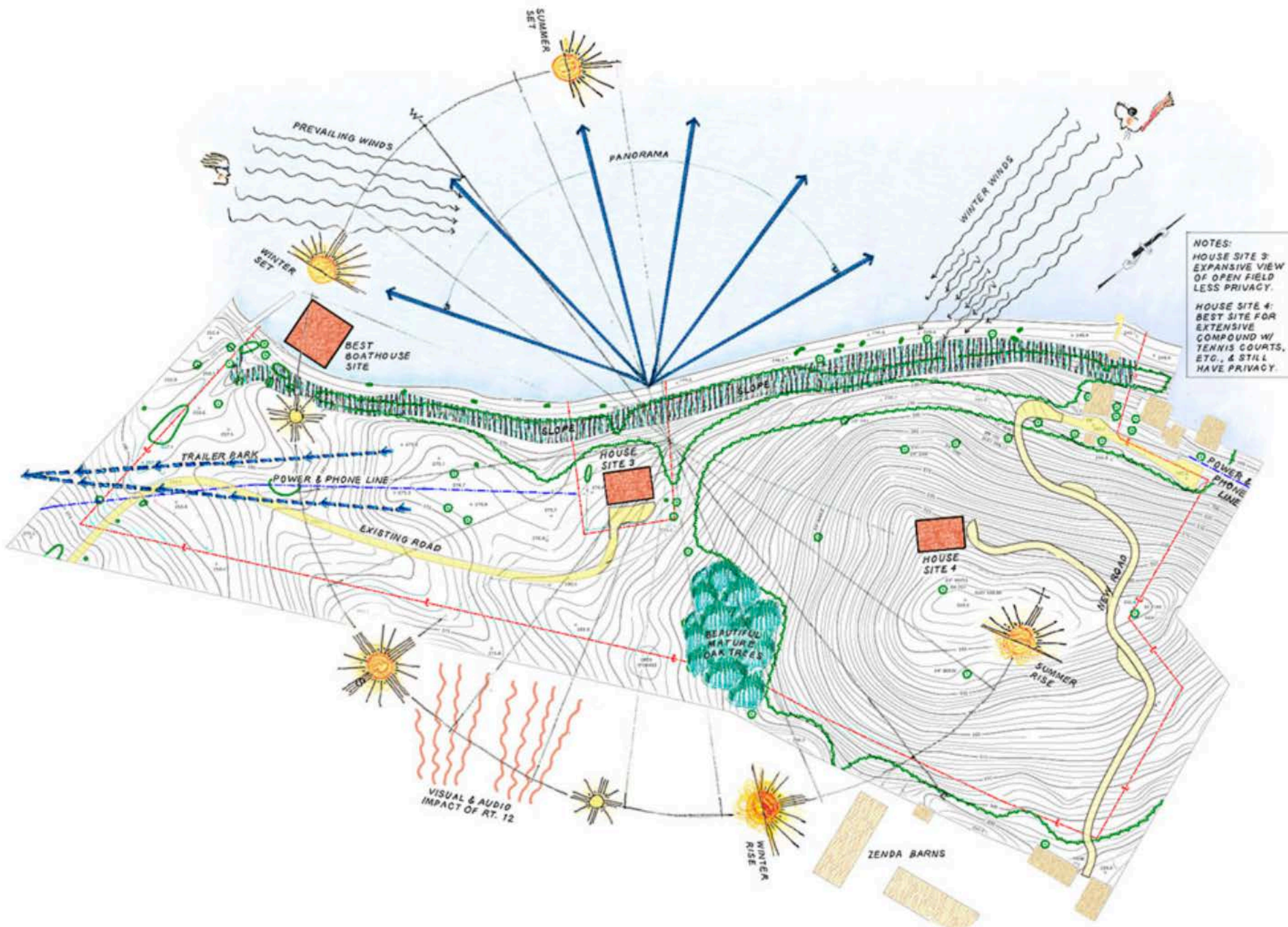

NOTES:
 HOUSE SITE 3:
 EXPANSIVE VIEW
 OF OPEN FIELD
 LESS PRIVACY.
 HOUSE SITE 4:
 BEST SITE FOR
 EXTENSIVE
 COMPOUND W/
 TENNIS COURTS,
 ETC., & STILL
 HAVE PRIVACY.

