

Building Technology III

New York City College of Technology

Course Day 22

Revit *Elevators & Elevator Doors*



Professor Paul C. King, RA, AIA, ARA
Prof.Paul.King@Gmail.com

<http://professorpaulking.wordpress.com/>
<http://students.autodesk.com/>

Autodesk Seek

- Manufacturer Families
- Elevator Door
- Elevator Electric
- Match Manufacturer Specifications Select Size
- Name Group Elevator Linework
- Place Elevator

Elevator : Autodesk Seek – Manufacturer Family

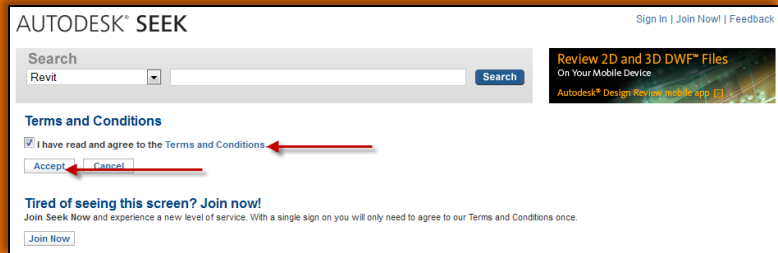
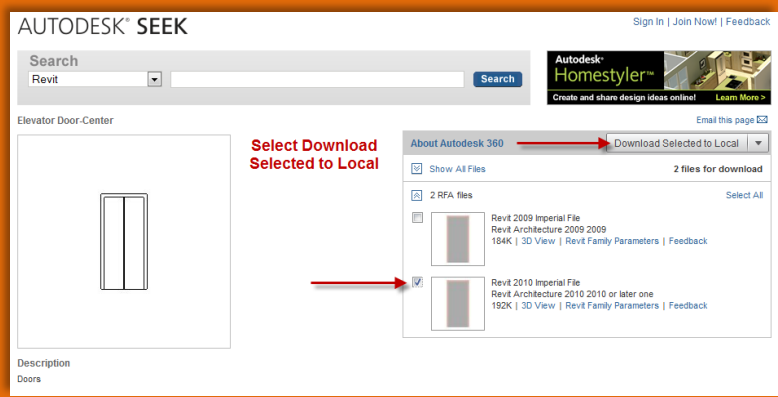
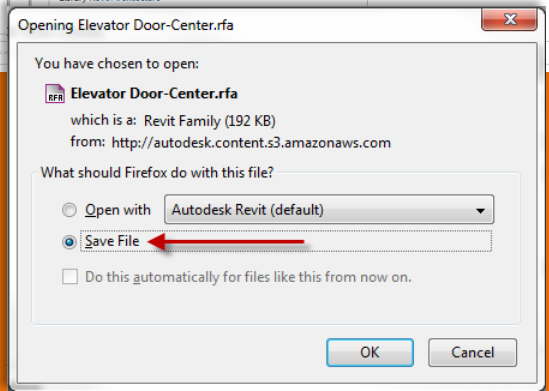
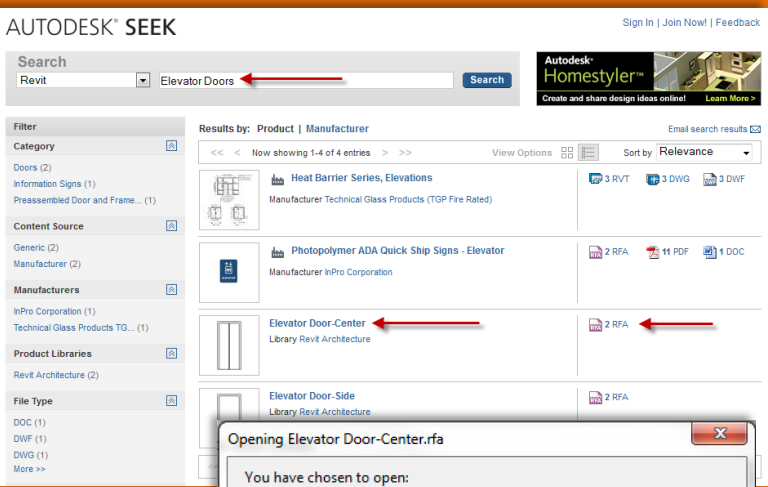
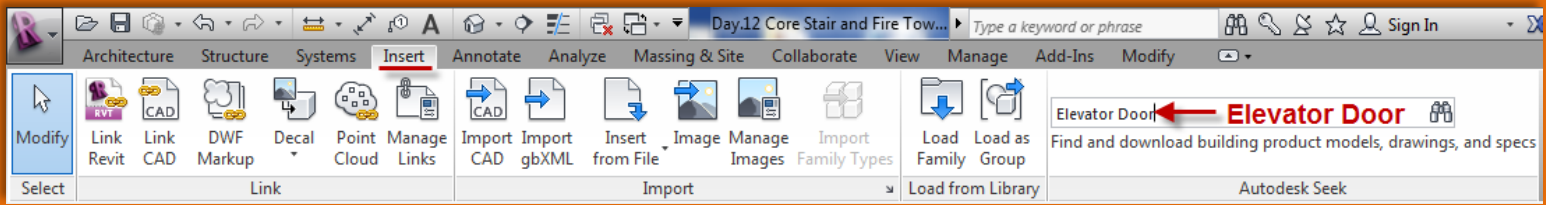

- Seek.Autodesk.com
- Search: Elevator Door

Day 22

Autodesk Seek

- Manufacturer Families
- Elevator Door
- Elevator Electric
- Match Manufacturer Specifications Select Size
- Name Group Elevator Linework
- Place Elevator

Elevator : Autodesk Seek – Manufacturer Family

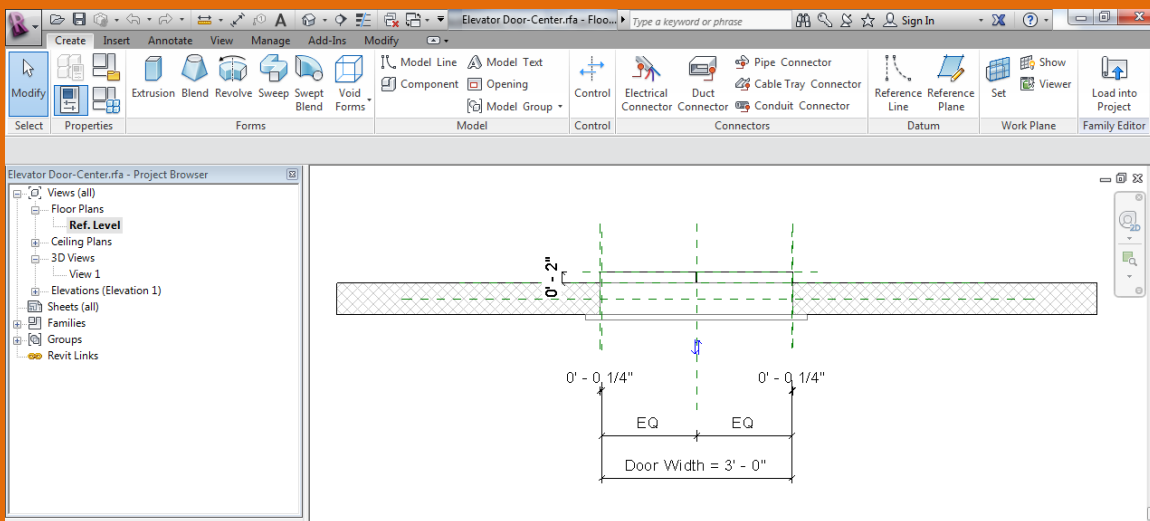
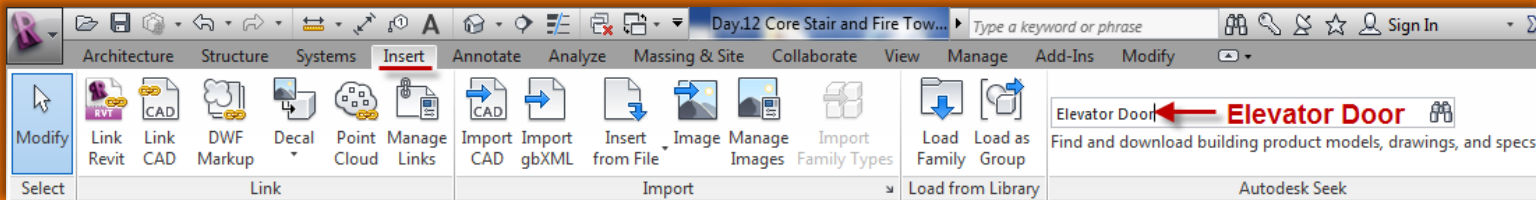

- Repeat the Process to get the line work for the Elevator
- We will be combining the two to create our own elevator – doors with Elevator Cab

Autodesk Seek

- Manufacturer Families
- Elevator Door
- Elevator Electric
- Match Manufacturer Specifications Select Size
- Name Group Elevator Linework
- Place Elevator

Elevator : Autodesk Seek – Manufacturer Family

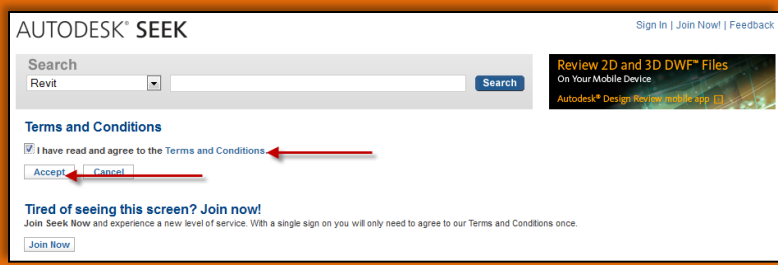
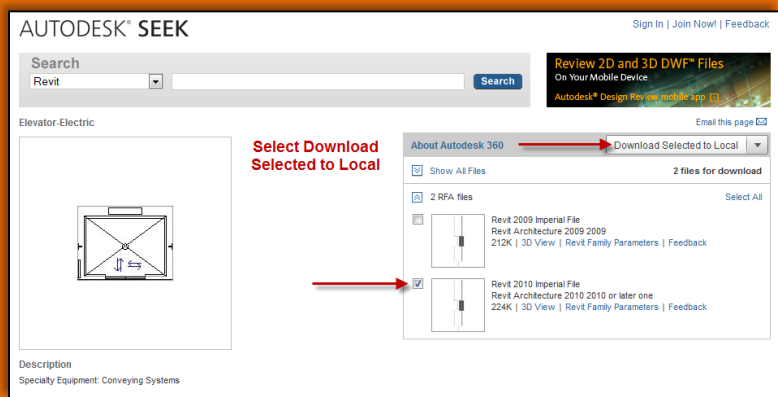
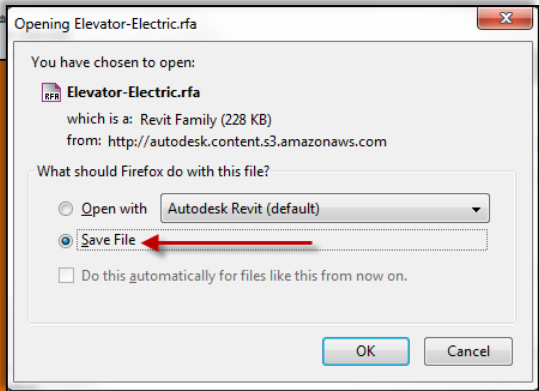
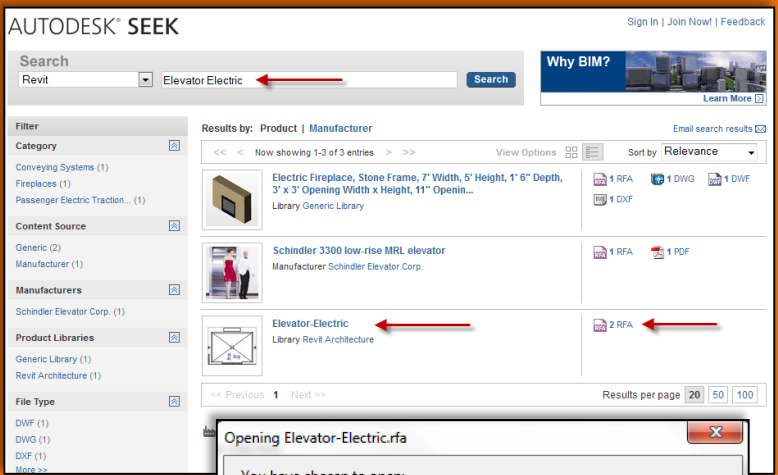
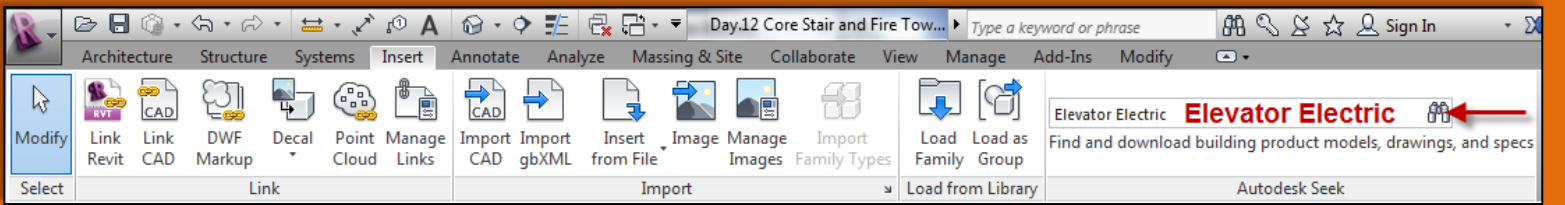

- Seek.Autodesk.com
- Search: Elevator Electric

Autodesk Seek

- Manufacturer Families
- Elevator Door
- Elevator Electric
- Match Manufacturer Specifications Select Size
- Name Group Elevator Linework
- Place Elevator

Elevator : Autodesk Seek – Elevator Electric

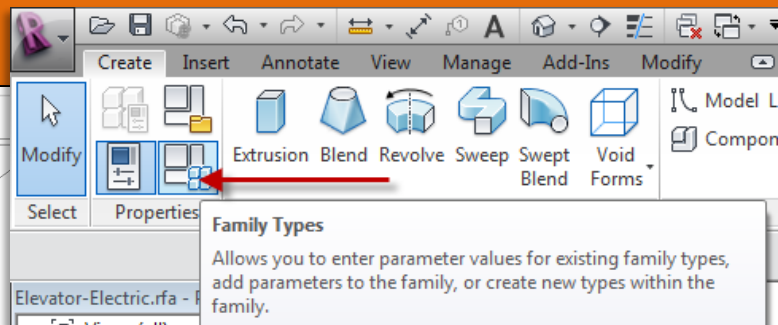
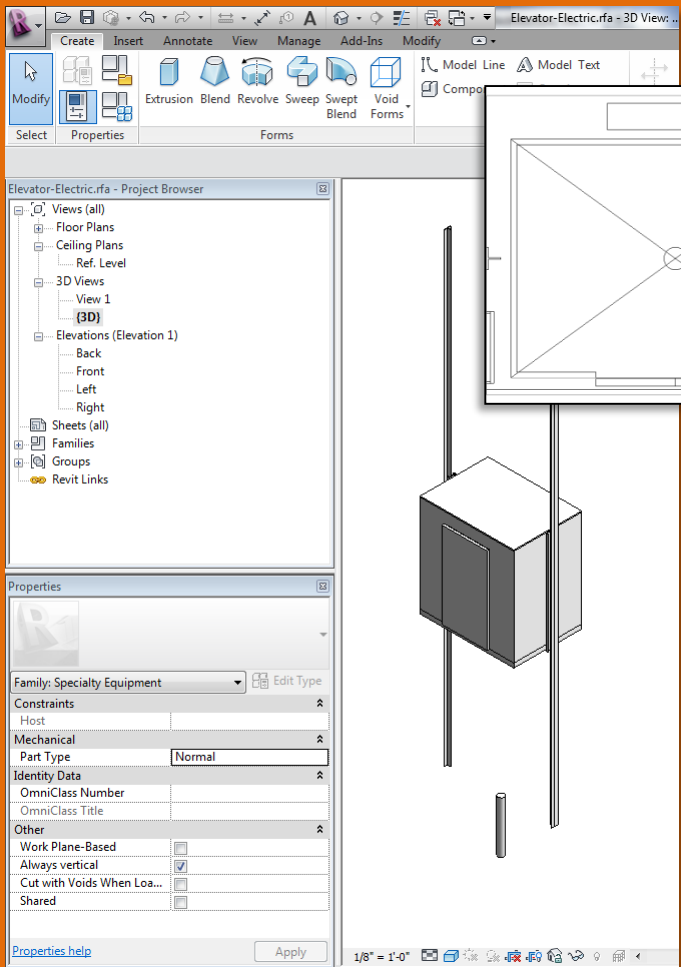

• Match Manufacturers Specs

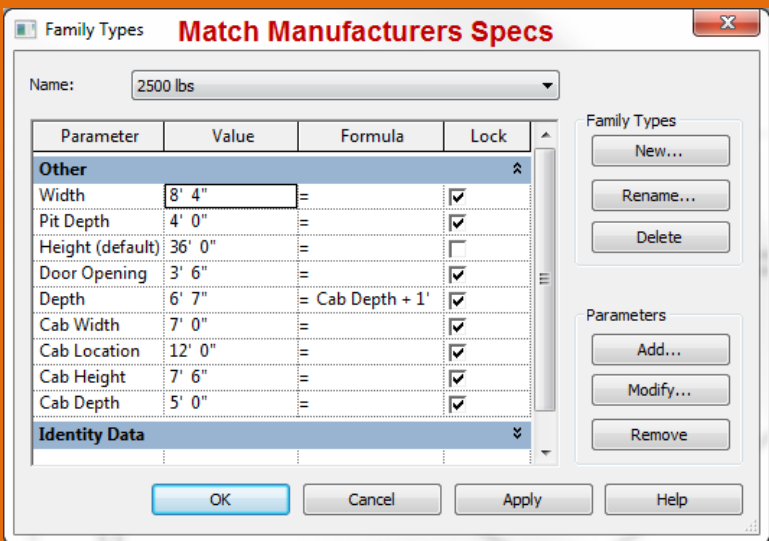

Elevator : Autodesk Seek – Elevator Electric

Day 22

Autodesk Seek

- Manufacturer Families
- Elevator Door
- Elevator Electric
- Match Manufacturer Specifications Select Size
- Name Group Elevator Linework
- Place Elevator

The collage illustrates the workflow for creating an elevator linework group in Revit:

- Selection:** A floor plan view shows an elevator shaft. A red arrow points to the shaft with the text "Select Elevator then Filter".
- Filtering:** A "Filter" dialog box is shown with "Elevator" selected in the "Category" list. Under "Lines", "Lines (<Invisible Lines>)" and "Lines (Elevator)" are checked. The "Count" for "Lines (Elevator)" is 31. The "Total Selected Items" is 35. Red text "Select only 2D Linework" points to the "Lines (Elevator)" checkbox.
- Grouping:** A "Create Model Group" dialog box is shown with the "Name" field set to "Elevator Linework". A red arrow points to the name field with the text "Name Group". The "Open in Group Editor" checkbox is unchecked.
- Ribbon Tabs:** The "Modify | Lines" ribbon tab is shown with the "Create Group" button highlighted. The "Modify | Model Groups" ribbon tab is also shown.
- Clipboard:** A screenshot shows the "Clipboard" panel with the "Paste" button highlighted. A red arrow points to the "Paste" button with the text "Paste from Clipboard".
- Project Browser:** A screenshot of the Project Browser shows a list of views. The view "4 Elevator Door-Center.rfa - Floor Plan: Ref. Level" is selected, indicated by a red arrow.

Elevator : Autodesk Seek – Elevator Door Center

Day 22

Autodesk Seek

- Manufacturer Families
- Elevator Door
- Elevator Electric
- Match Manufacturer Specifications Select Size
- Name Group Elevator Linework
- Place Elevator

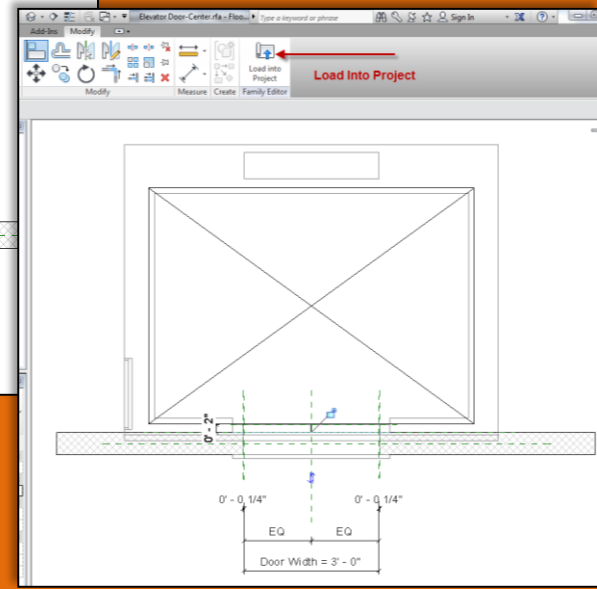
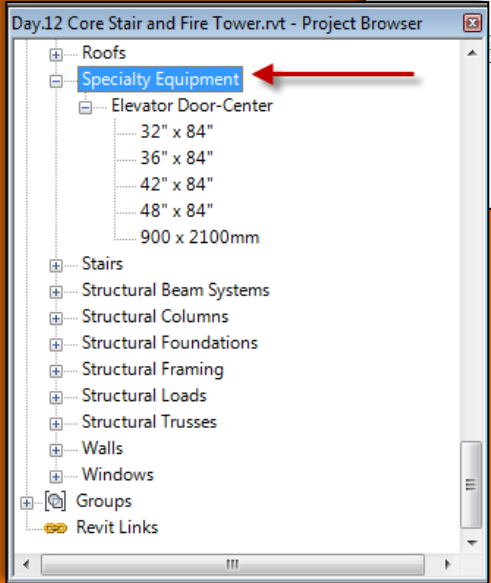
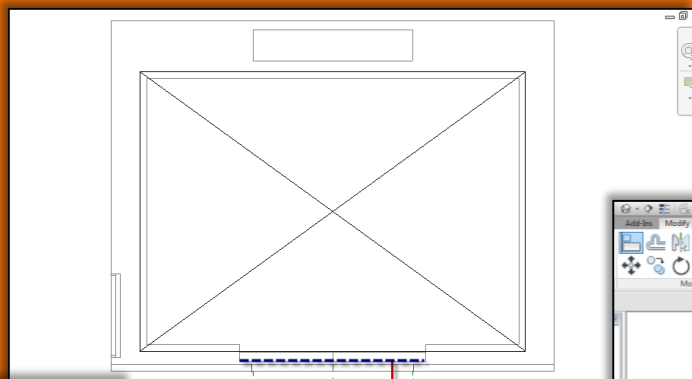
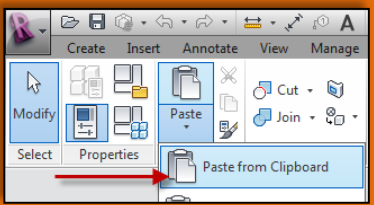

Day 22

Autodesk Seek

- **Manufacturer Families**
- **Elevator Door**
- **Elevator Electric**
- **Match Manufacturer Specifications Select Size**
- **Name Group Elevator Linework**
- **Place Elevator**

Day 22 - Wrap Up

- **Locating Elevator Families**
- **Autodesk Seek Search**
 - **Elevator Door**
 - **Elevator Electric**
- **Match Manufacturer Specifications**
 - **Select Size**
- **Place Elevator**