

2.04. Building need to have many factors in order to be constructed.

Those factors affect the ^{living} environment of people and how it affect the others. Resistance to weathering is one of the factor that provide a safety to the people. Most of the factor focus on quality, safety and relationship of building to its site.

2.05

There are several building codes

- Companion codes - limited of floor in a build to fit the surrounding
- Model codes - ~~make~~ change to meet the local requirement with group of people
- International Building Codes - include many factors, elevator, building materials, energy
- Federal Requirement - need the building to allow disabilities to get inside with design

2.06

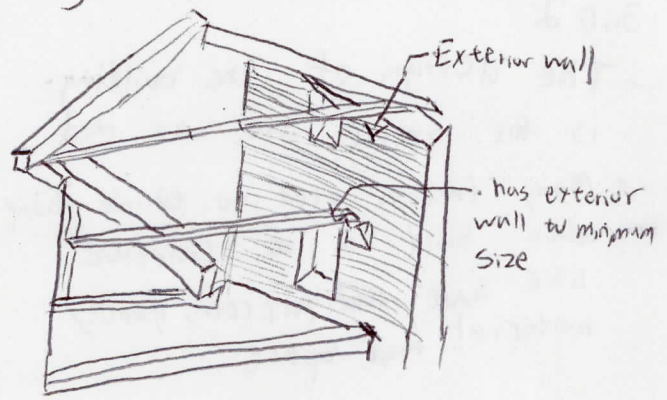
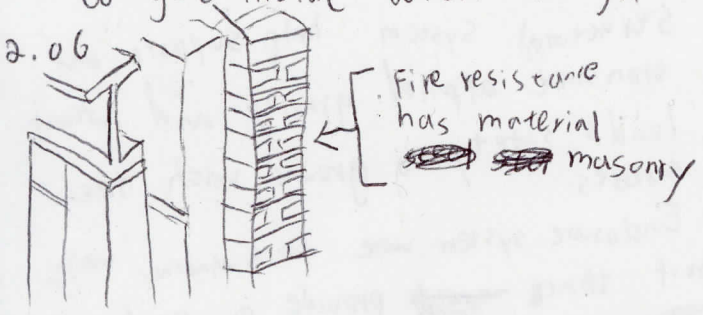

Different types of construction depends on major element, structural frame, bearing wall, floors, etc...

2.07. The IBC has set rule to the height of building size of the building

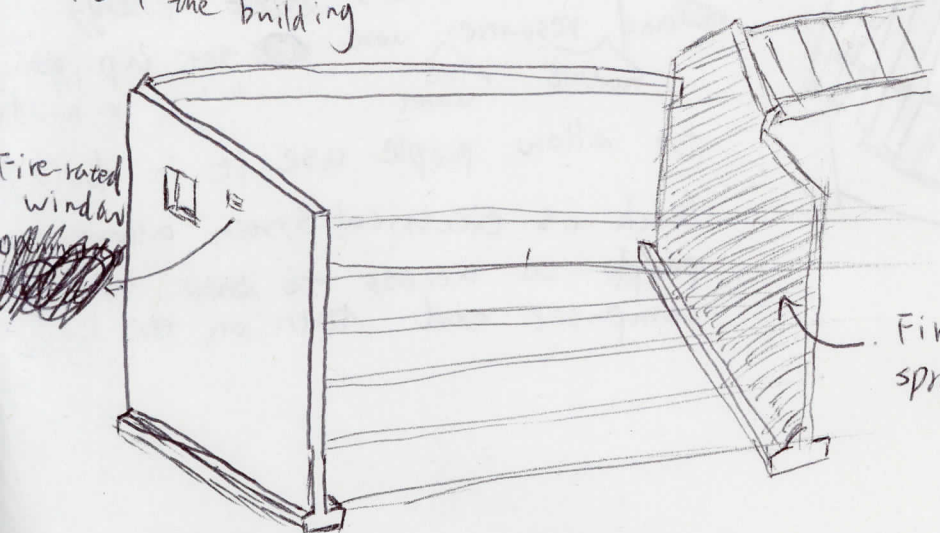

- base on the
- The bigger the building the more space get occupy
- Occupancy separations has the purpose to prevent the fire spread to other building