

Structure + envelop  
Spans + roofs

Seal of the house

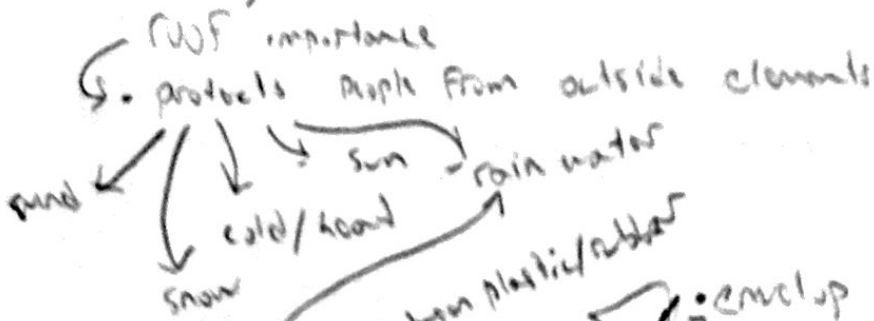

- waterproof
  - glass
  - rubber
  - plastic
- crisis between plastic/rubber
- Membrane ← EPDM
- goes on roof
- ↓
- Syth

envelop not structural  
modern times walls were masonry

• Envelop is the roof/walls/ground to protect the users

Passive

• Being comfortable in a interior environment.

insulation

- keeping heat/cold out

• Structure of roof

Span = distance between support points  
→ bigger spaces

Truss

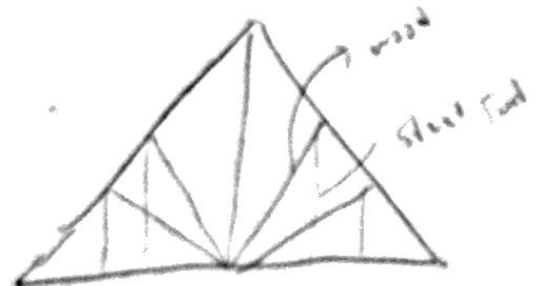

using smaller members to make bigger

• Ordering system

• Raft is the ceiling

Pear pit: vertical rail going around the Raft.

- Trusses → when 3D
- ins/cold/ll
- Space frame
- Glass
- Rafters