

Drawing 1: Looking Through—Space to Space

As we move through the world we experience spaces in sequence as they unfold over time in relationship to our movement. The sequential experience often includes the perception of several spaces at once. We see both the space we are in and the space we are approaching—we are looking from one space into another.

The other spaces we see are often framed by nearer elements such as a door, window, columns, walls, etc. The frame establishes a foreground that draws you into the space.

The goal of this drawing is to capture the experience of looking through a frame into a space and/or from one space into another.

Subject: Architectural Space.

Media: Prismacolor pencils, pens and/or Art Stix.

Material: White paper.

Graphic Language: The drawing should be predominantly tonal.

Value Patterns: Broad Range (white to black and everything in between).

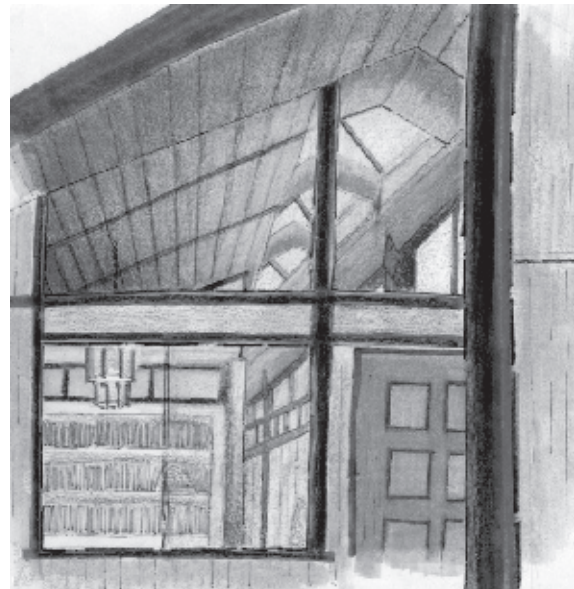

Drawings: Left to Right & Top to Bottom
Nick Arambarri, Angela Fraser-Shapiro
Phan Dung