

Y-CONTAINER HOUSE

PRESENTED BY CHRISTOPHER JALECO

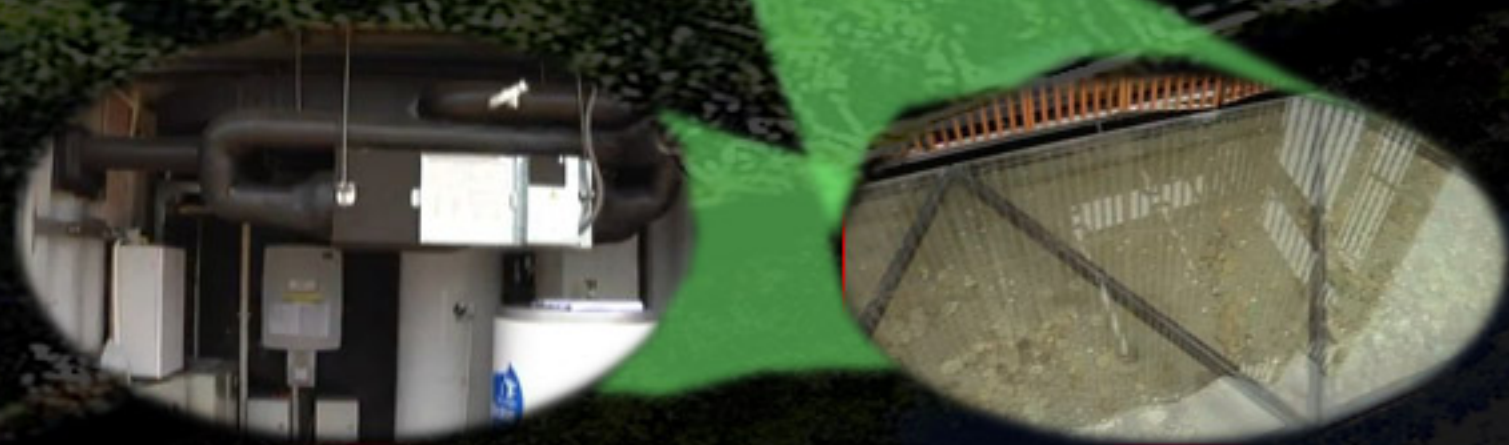

THE Y-CONTAINER HOUSE IS ORIENTED AT AN ANGLE OF 120 DEGREES WHERE THEY MEET AT THE TRIANGLE POINT AT THE CENTER WHICH KEEPS FRESH AIR CIRCULATING WHEN WINDOWS AND DOORS ARE CLOSED. THE LINING OUTSIDE THE HOUSE ARE A SERIES OF PLANTS WHICH PROVIDES FRESH OXYGEN AND FRESH VEGETABLES. THIS SPACE SERVES BOTH COMFORT AND SPACE.

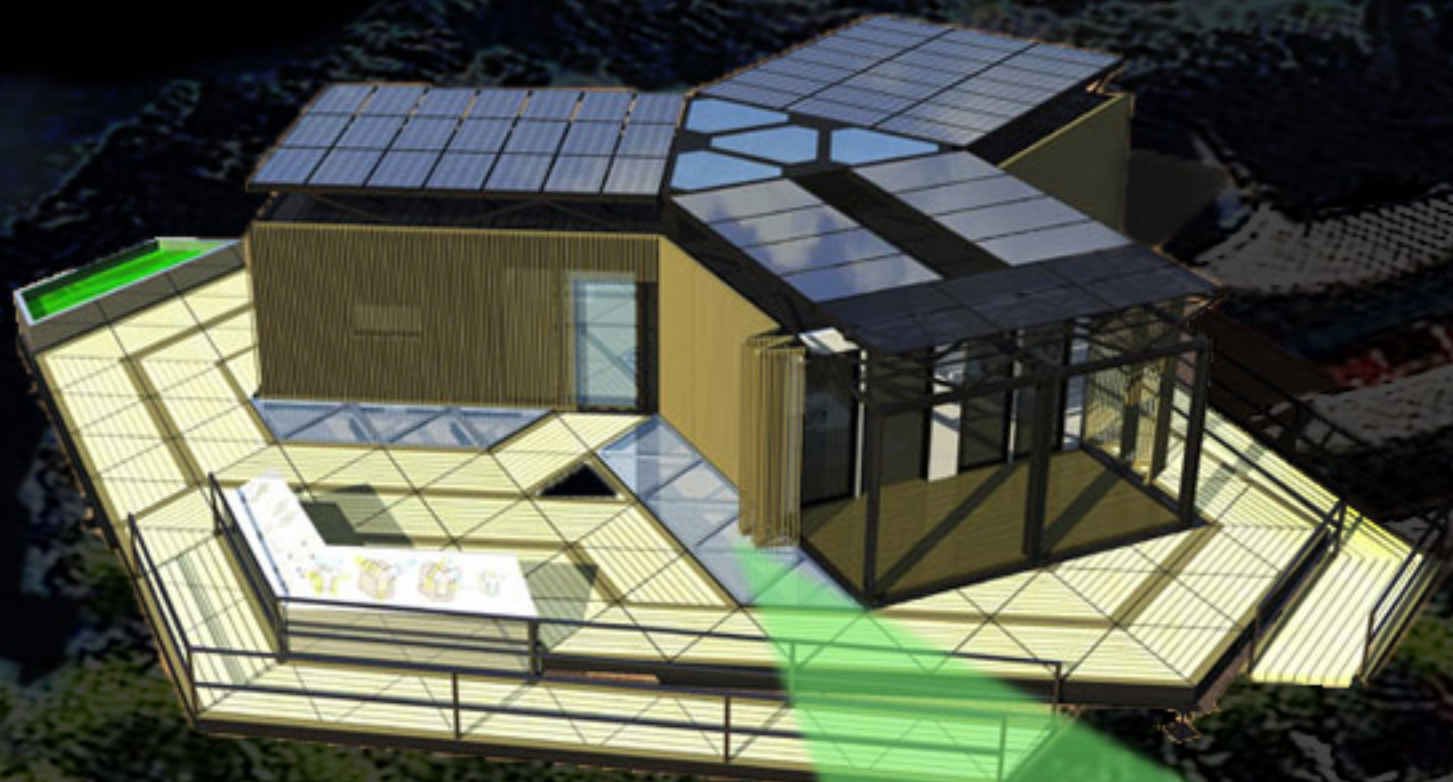

THE EXTERIOR PLATFOR HAS A RAINWATER COLLECT SYSTEM WHICH IS LATER RECYCLE IN THE GRAYWATER TANKS FOR CONVENIENT USE SUCH AS TAKING SHOWERS OR BATHS.

